

DUCATI MONSTER 937 '21

REF 20716N

R19 CRASH PAD

INSTRUCTIONS TO ASSEMBLE

Remove the fasteners that subject the chassis to the engine. Mount the protectors on each own side as the figure below shows. Tight the set, and place the caps. All the screws replaced, should be tightened to the torque specified in the oem maintenance manual for your motorcycle. if no torque specifications are provided in the oem maintenance manual, may be used 54Nm for all M10 screws.

Medium strength liquid thread-locker (i.e. "Loctite") should be used to secure all screws, bolts and nuts. All screws, bolts and nuts should be checked after driving the first 50 km to ensure that all are tightened to the proper torque.

FOR TO ASSEMBLE THE CRASH PADS, IF YOU ARE NOT A TRAINED MECHANIC, PLEASE CONTACT A SPECIALIST. MOTOPLASTIC, S.A. TAKES NO RESPONSIBILITY FOR DAMAGES CAUSED BY IMPROPER INSTALLATION. THE USE OF CRASH PADS DO NOT GUARANTEE A FULL PROTECTION IN CASE OF ACCIDENT. MOTOPLASTIC-PUIG DECLINE ANY RESPONSIBILITY IN CASE OF MOTORCYCLE DAMAGE.

Accessory verified in the basic configuration of the motorcycle. For models with extra factory settings. We cannot assure its compatibility, except for prior consultation. We decline any eventual claim.

ID.	DESCRIPTION	QTY.	REF.:
1	Covers set		TAPAPROTECR19-D/I
2	M12/125x170 DIN912 screw	1	M2TM12125170A9B
3	M10/150X140 DIN 912 screw	1	TORNIAD912-0354
4	M12 DIN433 washer	1	ARANM12DIN433ZB
5	M10 DIN125/A washer	1	M2AM10DIN125AZB
6	M12 Right Nylon Protector	1	PROTECNLR19-165
7	M12 Left Nylon Protector	1	PROTECNLR19-145
8	Right aluminum black spacer (100mm)	1	CASQU316-0-1616
9	Left aluminum black spacer (102mm)	1	CASQU495-0-1795
10	M12/125x54 especial screw	1	CASQU307-0-1607

DUCATI MONSTER 937 '21

REF
20716N

MOUNTING INSTRUCTIONS

1

ASSEMBLY

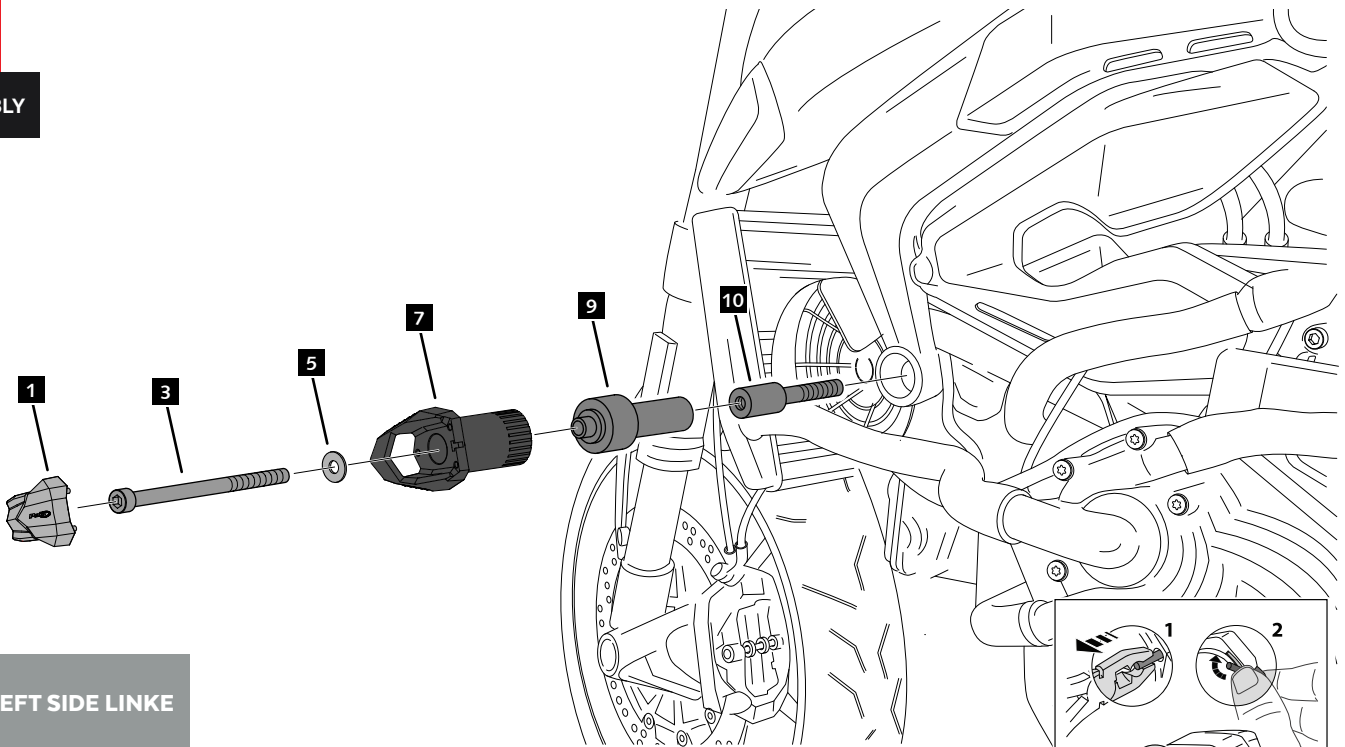

2

ASSEMBLY

