

# DUCATI PANNIGALE 1299 '15-'17 / 1199 '12-'15

## M O U N T I N G I N S T R U C T I O N S

REF 20138N

LEFT PLUG-OIL COVER



1 Person



1 hour



EASY



| ID. | PART  | DESCRIPTION         | QTY. | REF.:            |
|-----|---|---------------------|------|------------------|
| 1   |  | Left plug-oil cap   | 1    | CONJUNTO--20138N |
| 2   |  | DIN6921 M6x30 screw | 4    | -                |

# DUCATI PANNIGALE 1299 '15-'17 / 1199 '12-'15

## MOUNTING INSTRUCTIONS

**1**

DISASSEMBLY

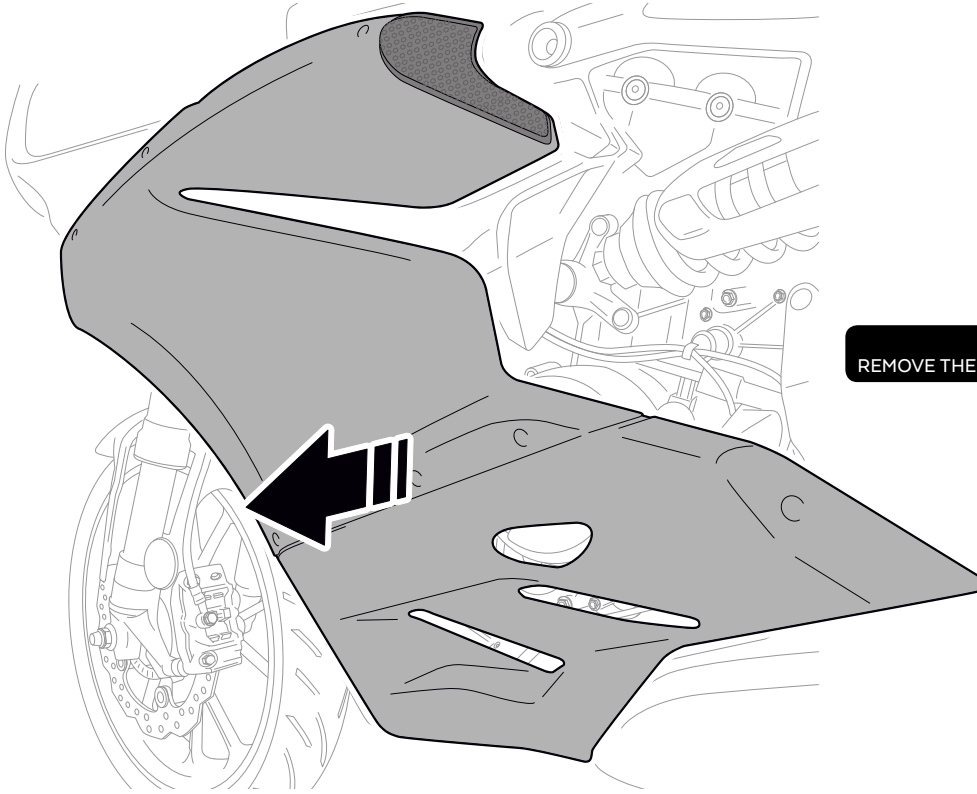

REMOVE THE COVER

**2**

DISASSEMBLY

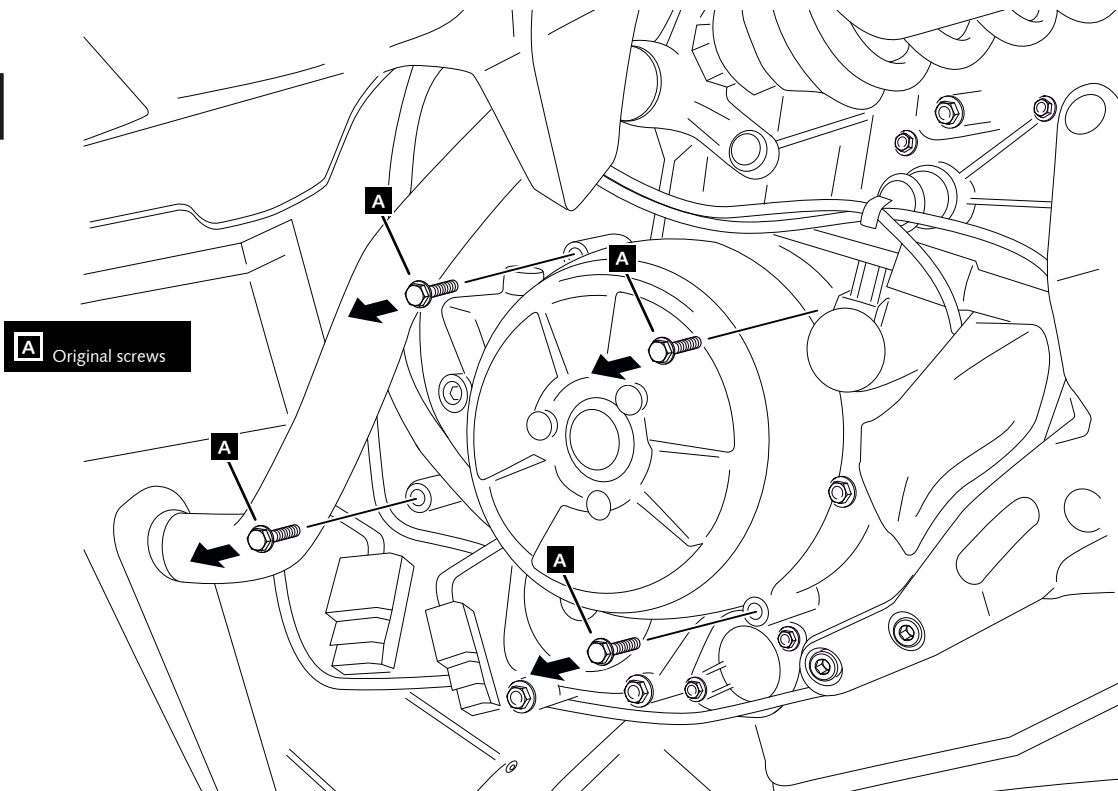

**A** Original screws

# DUCATI PANNIGALE 1299 '15-'17 / 1199 '12-'15

## MOUNTING INSTRUCTIONS

**3**

ASSEMBLY

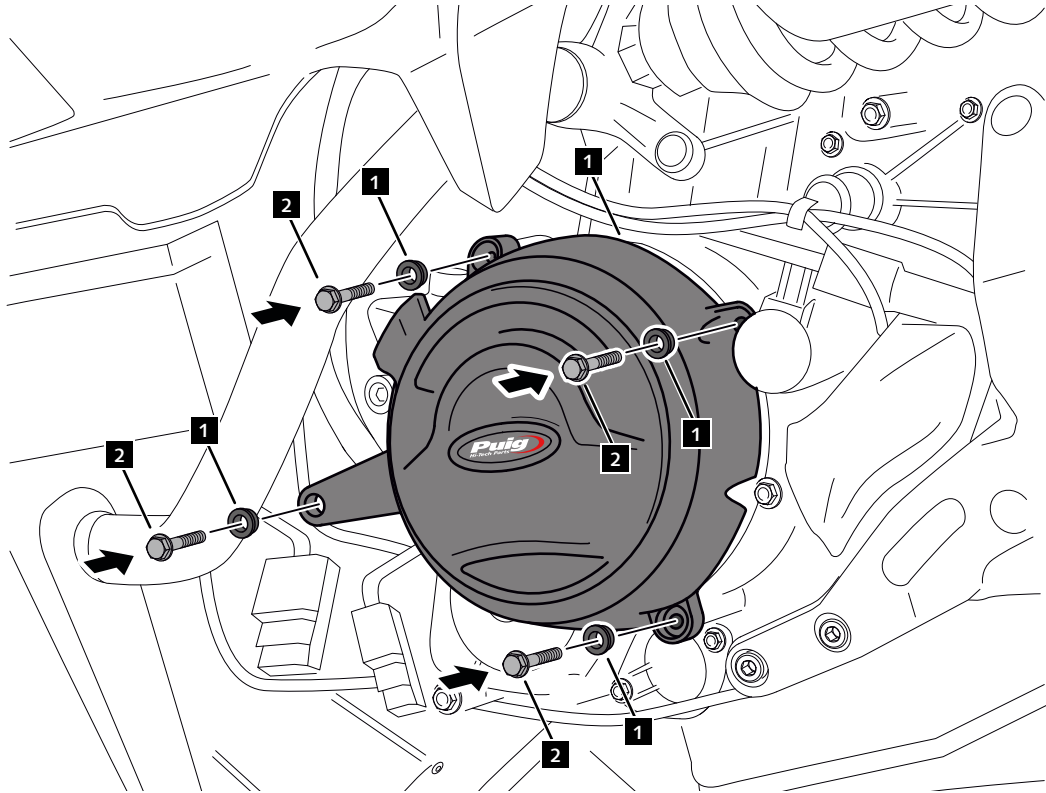

**4**

ASSEMBLY

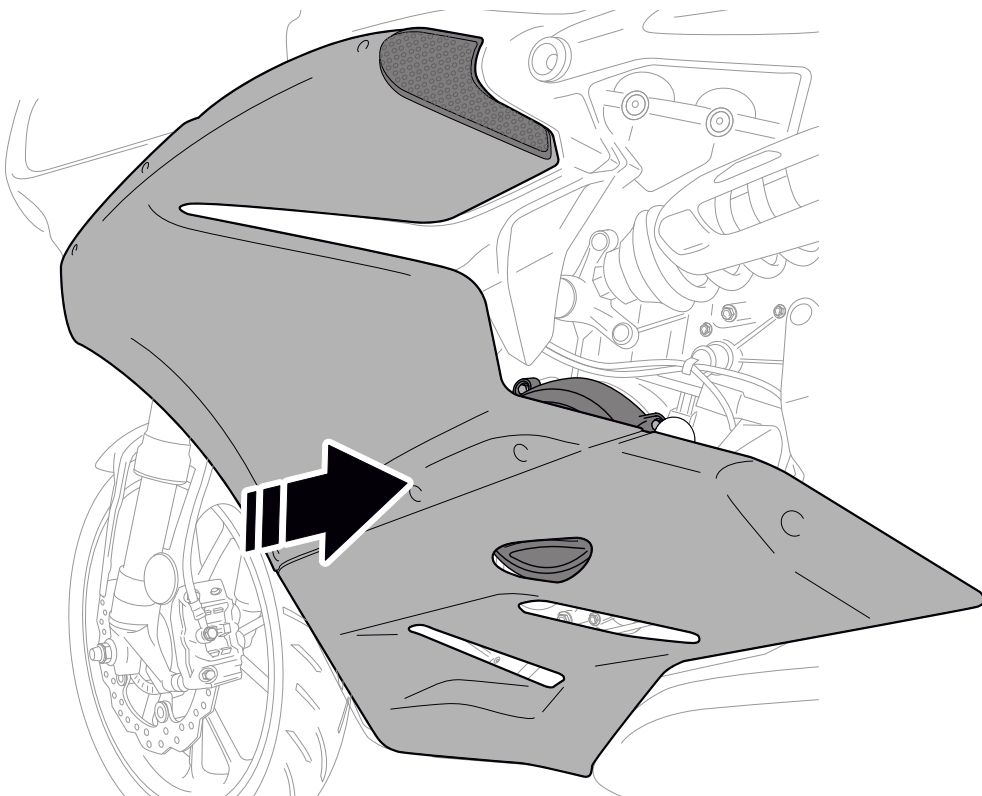

# DUCATI PANNIGALE 1299 '15-'17 / 1199 '12-'15

## M O U N T I N G   I N S T R U C T I O N S

REF 20138N

RIGHT PLUG-OIL COVER



1 Person



1 hour



EASY



| ID. | PART  | DESCRIPTION         | QTY. | REF.:            |
|-----|---|---------------------|------|------------------|
| 1   |  | Right plug-oil cap  | 1    | CONJUNTO--20138N |
| 2   |  | M6x30 DIN6921 screw | 4    | -                |

# DUCATI PANNIGALE 1299 '15-'17 / 1199 '12-'15

## MOUNTING INSTRUCTIONS

**1**

**DISASSEMBLY**

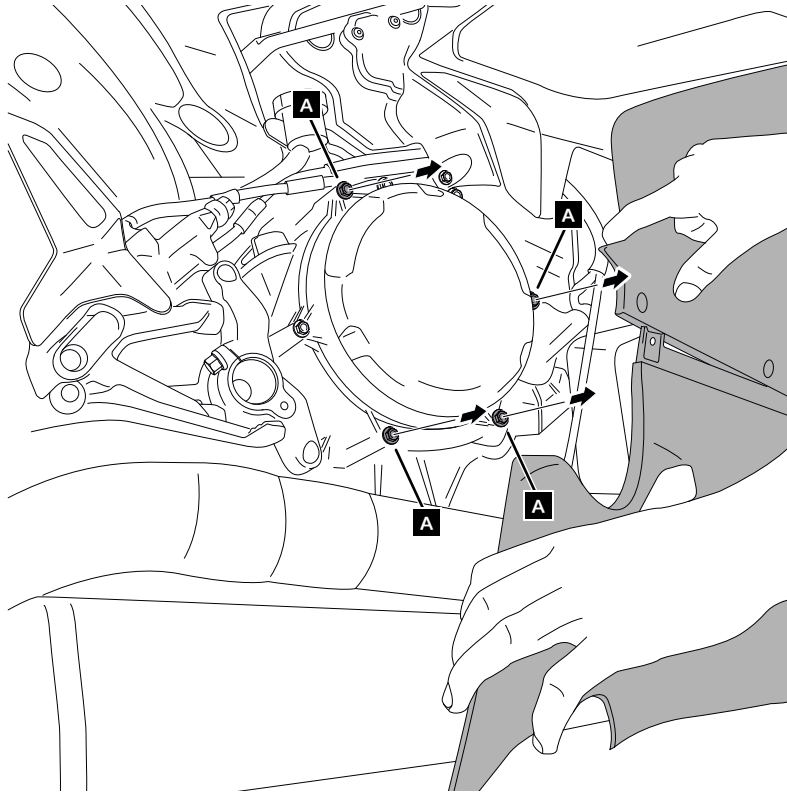

**A** Original screws

**2**

**ASSEMBLY**

