



PREVENTION

- Use water and neutral soap to clean the windshield.
- Check the tightening of the fasteners periodically.
- Park the scooter facing the sun, avoiding the sun-reflection effect that may damage some parts.
- Park if possible on even surfaces.

Thanks for your attention.

ID.	DESCRIPTION	QTY.
1	Windshield	1
2	Exterior cap	2
3	Ball bearing exterior support	2
4	Ball bearing interior support	2
5	M5x20 DIN912 allen screw Inox	4
6	M5 DIN982 lock nut Inox	4
7	M5x13 phillips screw	4
8	Rod with central ball bearing Ø9x200	2
9	Final bar cap	2
10	M8x40 DIN912 screw	2
11	Rod guide support	2
12	Coupling angle	2
13	Angle ref.:581	2
14	Mirror support Ø8xØ8	2
15	M8x30 screw	2
16	M8 nut	2
17	M6 nut cover	4
18	M8 nut cover	4
19	Ø8xØ14x6/12 spacer	2
20	M8 DIN6923 nut	2
21	M8 DIN912 screw cap	2
22	Adapter hex. thread ext.left M8 to thread int.M8	2
23	Adapter hex. thread ext.M10 to thread int.M8	2
24	Adapter hex. thread ext.left M10 to thread int.M8	2
25	Adapter hex. thread int.left M8 to thread ext.M8	2
26	Adapter hex. thread int.M10 to thread ext.M8	2
27	Adapter hex. thread int.left M10 to thread ext.M8	2

Puig puts everything within reach.

WINDSHIELD CITY ADAPTABLE A
UNIVERSAL

Mod.: SPORT
Ref.: **0661H**
Mod.: TOURING
Ref.: **0572H**

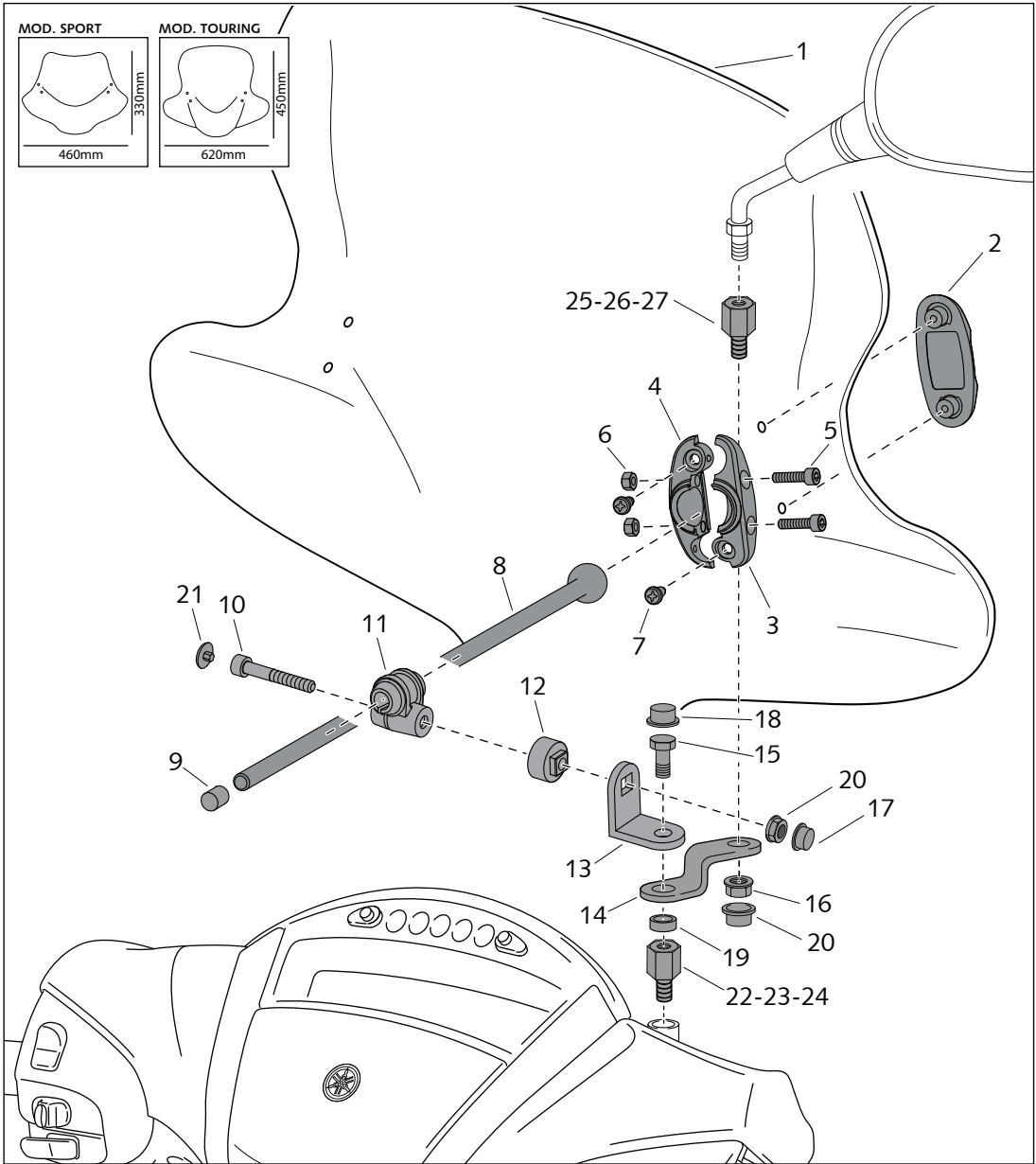

Check out the collection of motorcycle windshields & fairings we offer.