

KTM 790 DUKE

REF 0072

HANDSGUARD FOR



1 Person



35 min



INTERMEDIATE



FIX



N° 10

TORX



T30

ALLEN



N° 5

N° 3

ID.	PART	DESCRIPTION	QTY.	REF.:
1		Right handguard	1	0072JM3
2		Ø14 right handlebar anchoring part (Supplied mounted with handguard)	1	0072JM3
3		Left handguard	1	0072JM3
4		Ø14 left handlebar anchoring part (Supplied mounted with handguard)	1	0072JM3
5		right metal support (R)	1	SOPOR-2P-4-0072
6		left metal support (L)	1	SOPOR-2P-4-0072
7		Ø4,5 x Ø11 x 2mm Rubber washer (Supplied already mounted with 1-2-3-4)	4	ARAND-EPDM--722
8		Ø4,5 x Ø14 x 4mm Rubber washer	2	ARAND-GD13D5X4-
9		M5x11 Ø11 ISO 7380 Allen screw	6	TORNI-AI----520
10		M5x1 nylon washer	6	ARNV00000000245
11		M5 special nut (Supplied already mounted with 1-2-3-4)	4	TUERC-D6923-255
12		Ø15 x Ø28 x 1mm Rubber washer	4	ARAND-----740
13		Ø15x Ø28 x 2,5 metal washer	2	ARANDPD125--741
14		M6x12 special screw hexagonal lenght 20 (M6x12) Black	1	TORNI-EM6---802
15		M5 ISO 7380 Allen screw cap	6	TAPON-----85
16		Stickers set	1	ADHESI-----234

KTM 790 DUKE

- MOUNTING INSTRUCTIONS

RIGHT SIDE

1

DISASSEMBLY

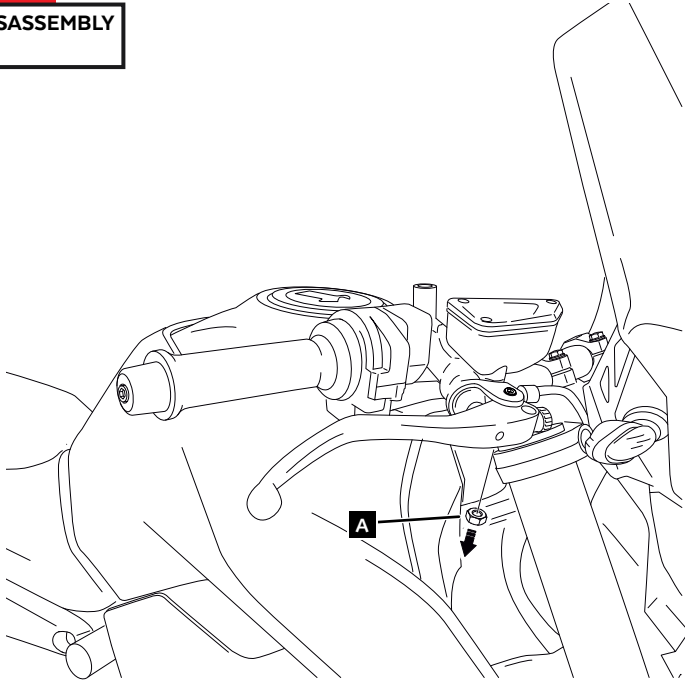

2

ASSEMBLY

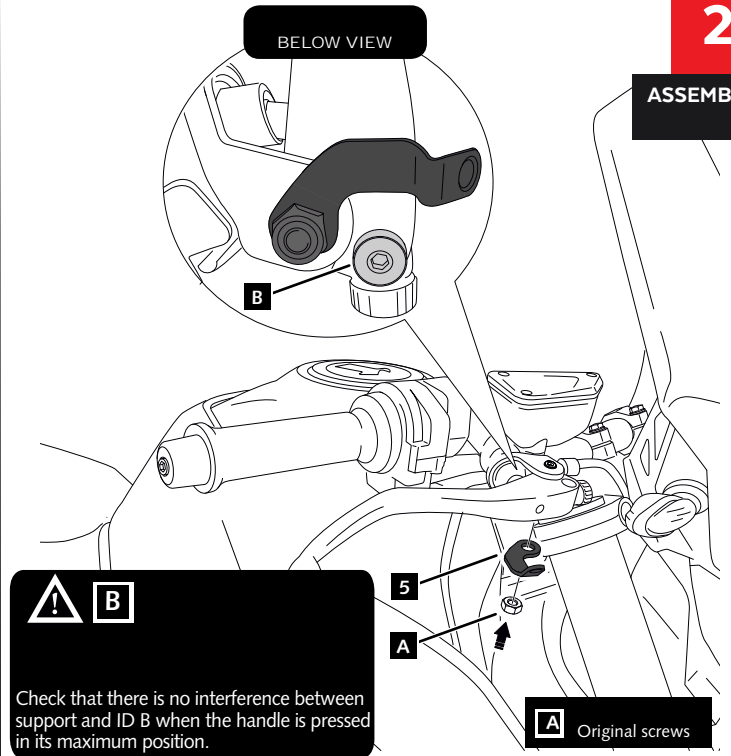

3

DISASSEMBLY

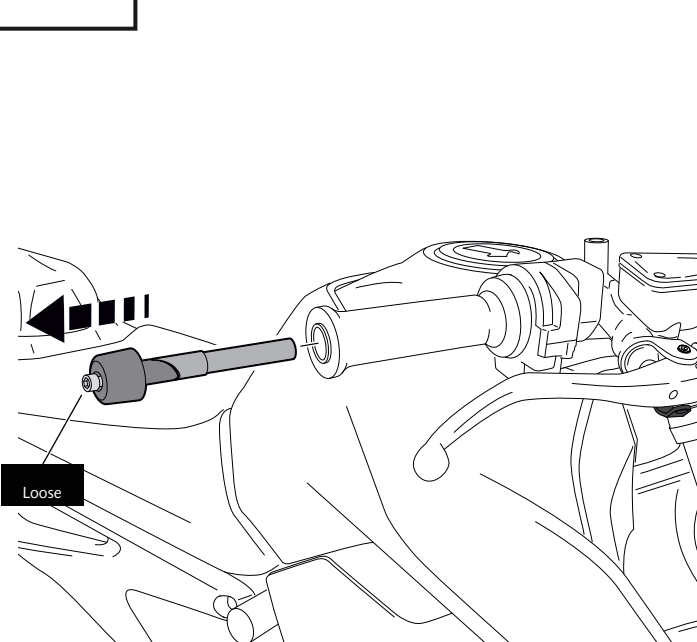

4

ASSEMBLY

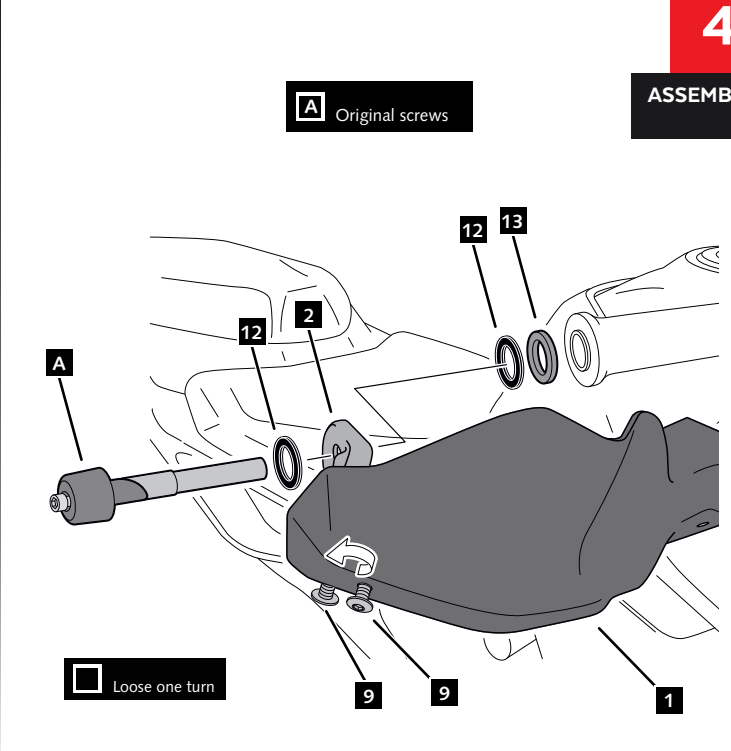

KTM 790 DUKE

MOUNTING INSTRUCTIONS

RIGHT SIDE

5

ASSEMBLY

IF THE HANDGUARDS TOUCHES THE TANK, MOVE UP THE POSITION OF THE LEVERS

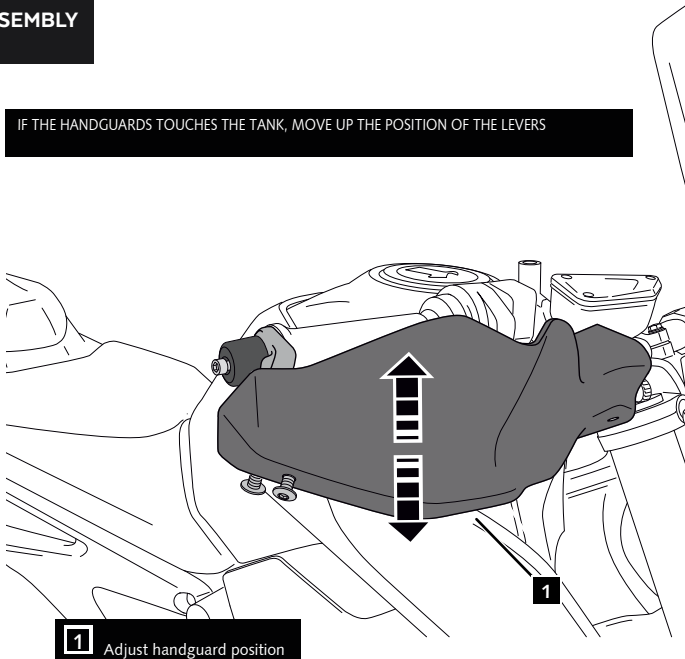

6

ASSEMBLY

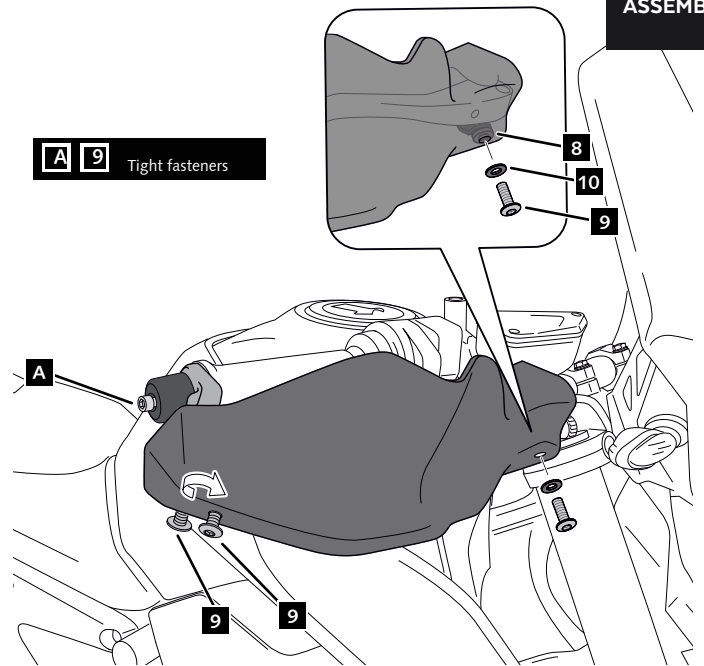

7

ASSEMBLY

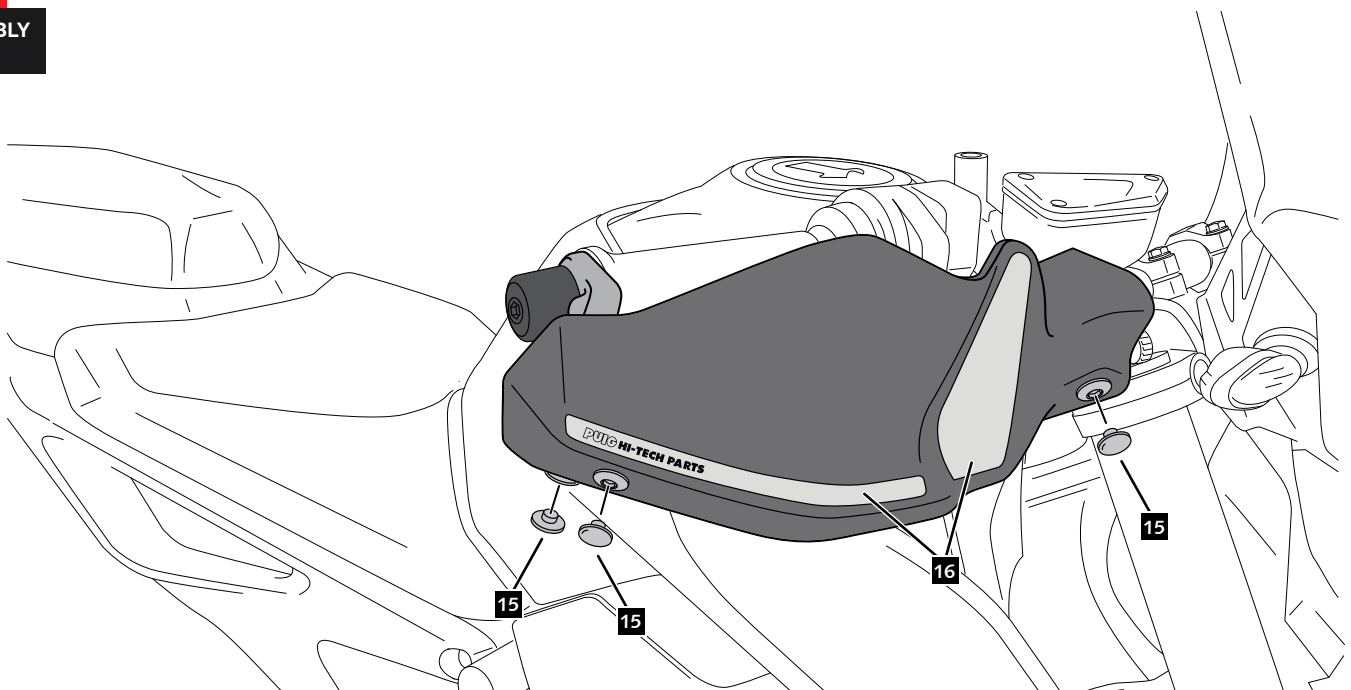

KTM 790 DUKE

MOUNTING INSTRUCTIONS

LEFT SIDE

1

DISASSEMBLY

A Original screws

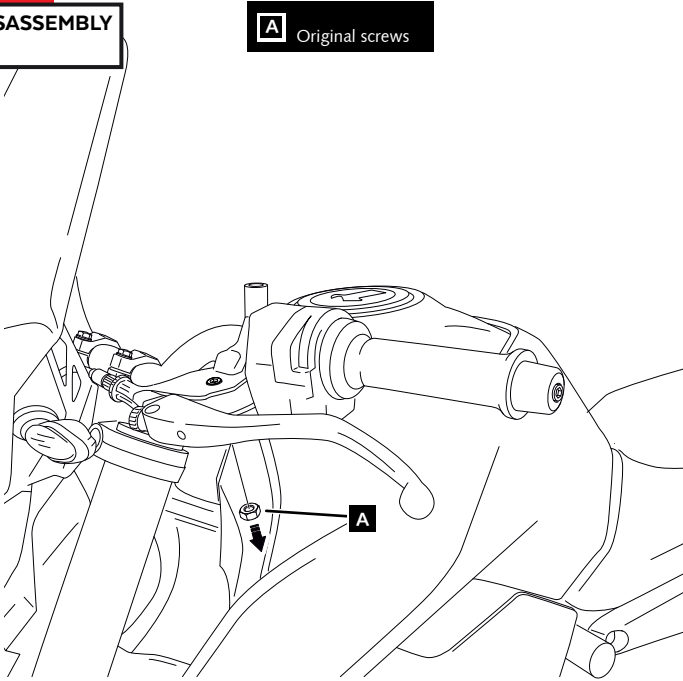

2

ASSEMBLY

A Original screws

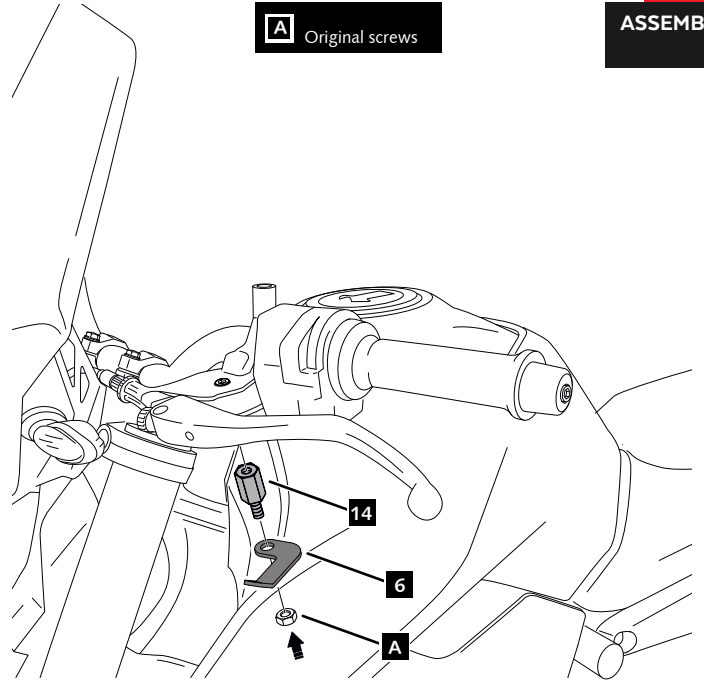

3

DISASSEMBLY

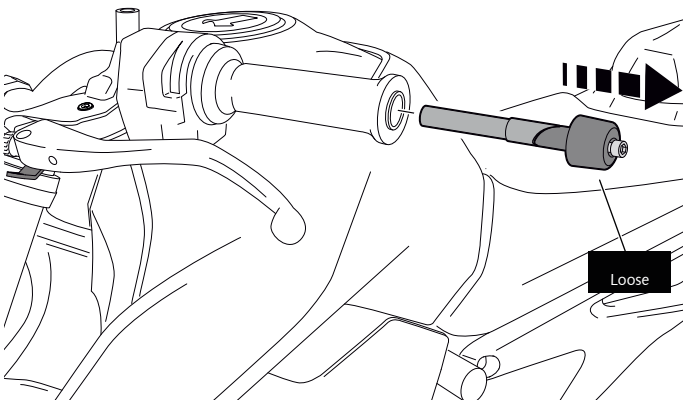

4

ASSEMBLY

A Original screws

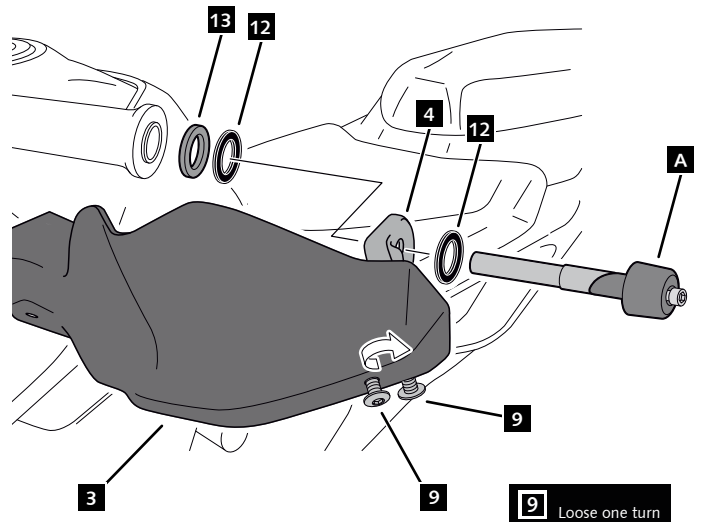

KTM 790 DUKE

MOUNTING INSTRUCTIONS

LEFT SIDE

4

ASSEMBLY

IF THE HANDGUARDS TOUCHES THE TANK, MOVE UP THE POSITION OF THE LEVERS

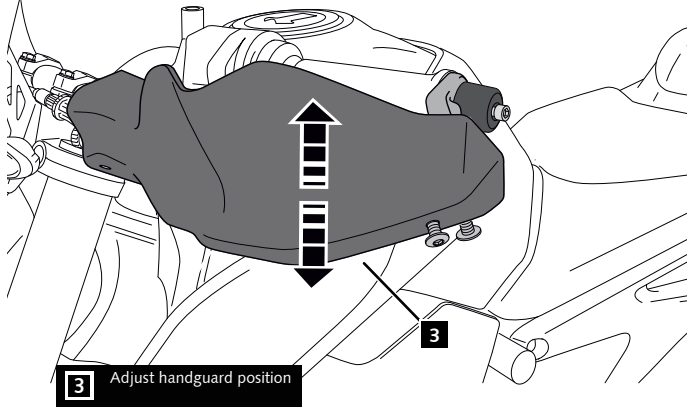

5

ASSEMBLY

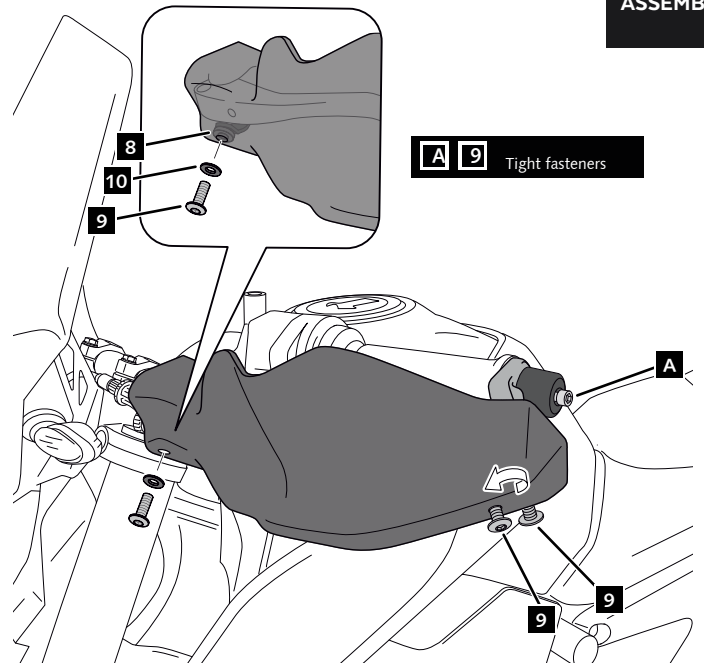

6

ASSEMBLY

