

USER'S MANUAL
QUICK INSTALLATION GUIDE

PATV85
BLUETOOTH®
ALL-TERRAIN SOUND SYSTEM



PATV85 0716

all specifications subject to change without notice
© Planet Audio

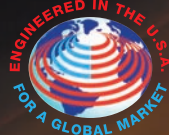
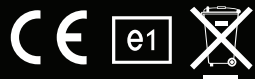

USER'S MANUAL
QUICK INSTALLATION GUIDE



Planet Audio®

PATV85

BLUETOOTH® | ALL-TERRAIN SOUND SYSTEM
FEATURING LED ILLUMINATION AND 8" MARINE SPEAKERS
AND 1.5" WATERPROOF TWEETERS

TABLE OF CONTENTS

BEFORE YOU START -----	2
<i>IMPORTANT SAFETY PRECAUTIONS</i>	
<i>INSTALLATION PRECAUTIONS</i>	
WIRE DIAGRAM -----	3
SPEAKER MOUNTING SUGGESTIONS -----	3
BEFORE INSTALLING THIS PRODUCT -----	4
<i>TECHNICAL SUPPORT</i>	
SUGGESTED MOUNTING METHODS -----	5
<i>SURFACE MOUNT</i>	
<i>HANDLEBAR MOUNT</i>	
GETTING STARTED -----	6
BLUETOOTH OPERATION -----	7
<i>PAIRING & DISCOVERING A NEW BLUETOOTH CONNECTION</i>	
<i>RECONNECTION</i>	
STREAMING MUSIC -----	9
<i>MULTIFUNCTION CONTROLLER BLUETOOTH OPERATION</i>	
<i>VOLUME CONTROL</i>	
AUX-INPUT -----	10
<i>AUX-IN OPERATION</i>	
<i>VOLUME CONTROL</i>	
INFORMATION TO THE USER -----	11
TROUBLE SHOOTING GUIDE -----	12
SPECIFICATIONS -----	12

iPod / iPhone are trademarks of Apple Inc. registered in the U.S. and other countries.
PLANET AUDIO is not affiliated with Apple Inc.

All rights reserved. No part of this publication may be reproduced, distributed, or transmitted in any form or by any means, including photocopying, recording, or other electronic or mechanical methods, without the prior written permission of PLANET AUDIO.

Thank you for purchasing this



PATV85 Bluetooth All-Terrain Sound System

Please read through these instructions carefully so you will know how to operate your model properly.

After you have finished reading the instructions, keep this document in a safe place for future reference.

THIS PACKAGE CONTAINS

1 - PATV85 All-Terrain Speaker System

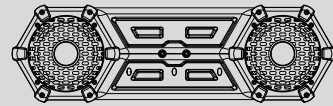

1 - Bluetooth Multi-Function Controller



1 - Handlebar Mounting Kit



1 - Quick Connect Power Extension Adaptor



4 - Hi-strength Nylon Mounting Straps

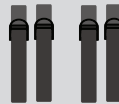

1 - User Manual

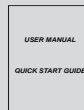

1 - Warranty Card



All trademarks and trade names are those of their respective owners.



BEFORE YOU START

IMPORTANT SAFETY PRECAUTIONS

- BE SURE TO OBSERVE THE FOLLOWING GUIDELINES:
 - Do not turn up the volume so high that you can't hear what's around you.
 - Use caution or temporarily discontinue use in potentially hazardous situations.
- Do not operate mobile video equipment while driving a motorized vehicle – safe driving and safety consideration of others should always be your highest priority.
- Set your volume control at a low setting, then slowly increase the sound until you can hear it comfortably without distortion, or ear discomfort.
- In the event you should notice smoke, strange noises or odor from this product, or any other abnormal signs, immediately turn off the power and consult your dealer or the nearest authorized **PLANET AUDIO** Service Center. Using this product in this condition may result in permanent damage to the system.

INSTALLATION PRECAUTIONS

WARNING - Always consult with a professional installer

- Do not attempt to install or service this product by yourself. Installation or servicing of this product by persons without professional training and experience in electronic equipment and motorized vehicle accessories may be dangerous and could expose you to the risk of electric shock, injury or other hazards
- Refer any repairs to a qualified **PLANET AUDIO** Service Center
- The **PATV85** should be powered directly to a vehicles battery
- When wiring directly to the vehicles battery, be sure to disconnect the batteries negative terminal wire before starting any wiring procedures,if extending the main power wire, it is suggested that an optional fuse and fuse holder (not included) with minimum rating of **20 Amperes** be in-line with the positive battery terminal
- The ground cable length should not exceed 18-inches (See wiring diagram pg 3)
- The **PATV85** has a weather resistant design, it should not be submerged in or under water under any circumstances
- Use only the installation parts provided with the **PATV85**



CAUTION!! Using other mounting methods may void this warranty



WIRE DIAGRAM

USB CHARGING
INSIDE COMPARTMENT

ALWAYS
CLOSE AND
LOCK DOOR
BEFORE USE

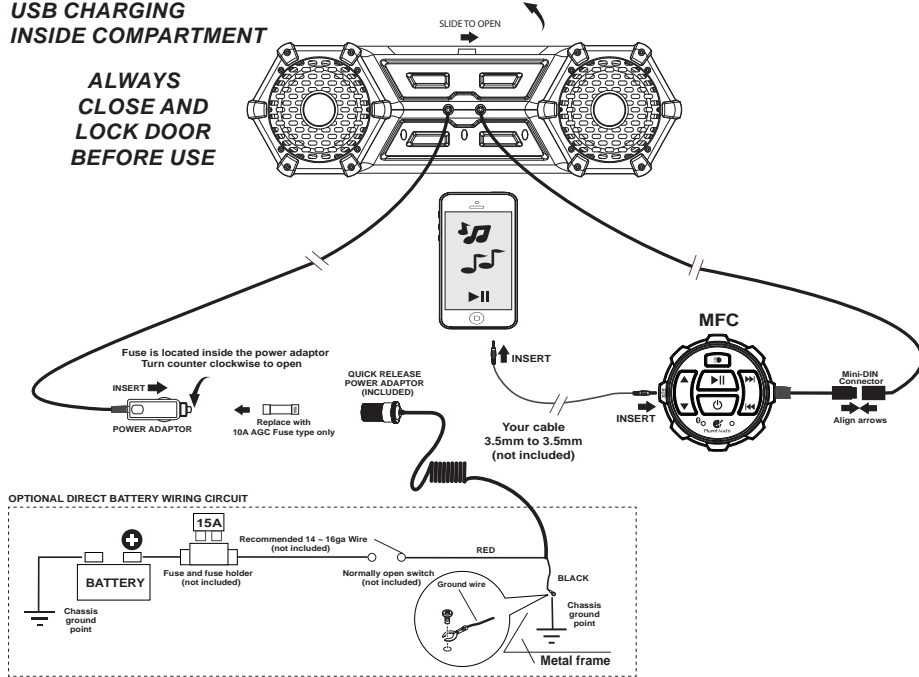

SPEAKER MOUNTING SUGGESTIONS

Route straps
around the speaker body to vehicle frame

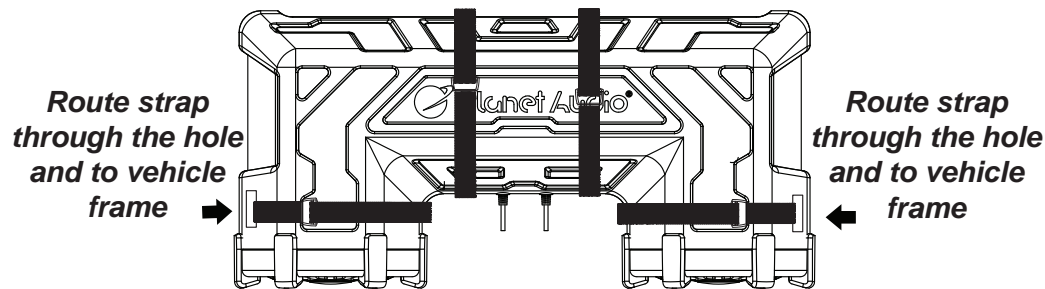

CAUTION!!

Mounting straps should be double checked to be sure they are pulled tight and secure before each use of the vehicle.

3

BEFORE INSTALLING THIS PRODUCT

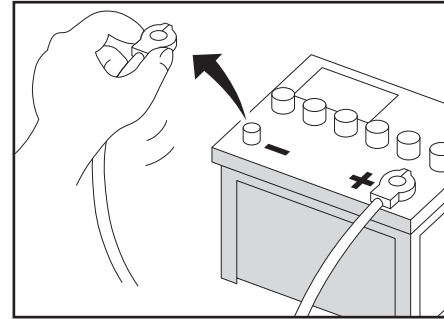

To avoid potential shorts in the electrical system, be sure to disconnect the (-) battery cable before installation. Use this unit with a 12-volt battery and negative grounding only. Failure to do so may result in a fire or malfunction.



When replacing the fuse, be sure to only use a fuse of the rating specified on this product.

To avoid short-circuiting, cover any disconnected leads with insulating tape. It is especially important to insulate any unused wires, which if left uncovered may cause a short circuit. When connecting other devices to this product, refer to the manual for the product to be connected. The black cable is ground, make sure to connect the ground wire first.

Ensure that the ground cable is properly connected to metal parts of the vehicles body frame or direct to the battery if your vehicle does not have a grounded chassis frame. The ground cable of this units power amp and a second powered system must be connected to the frame separately with different screws. If the screw for the ground wire loosens or falls out, it could result in fire or malfunction.

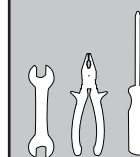

TOOLS NEEDED:

- Wrench and/or Pliers
- #2 Phillips screwdriver
- Crimp tool
- Electrical tape

4

SUGGESTED MOUNTING METHODS

The **MFC** can be mounted in two different configurations:

1 SURFACE MOUNT

To surface mount use double sided tape or velcro. (not included)

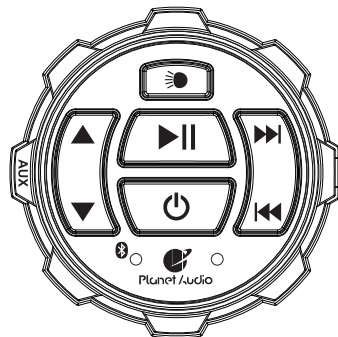

2 HANDLEBAR MOUNT

Use the provided handlebar clamp kit, try the best method for your application, securely tighten all components.

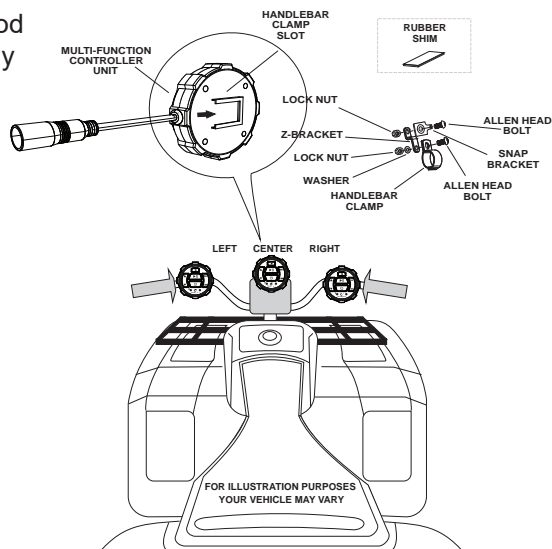

 **Tips:**

To release the **PATV85 MFC** controller from the mounting clamp, a small jewellers screwdriver into the release tab.

GETTING STARTED

GETTING TO KNOW YOUR PATV85 MULTIFUNCTION CONTROLLER (MFC)

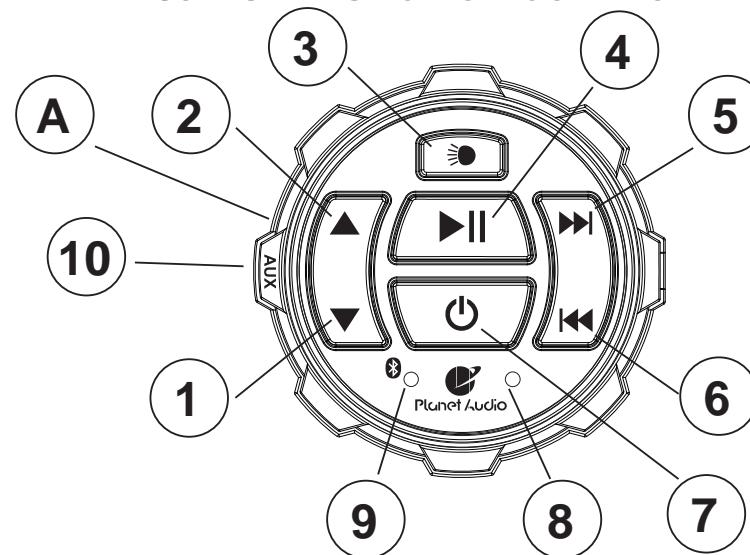

- A** MFC - MULTIFUNCTION CONTROLLER
- 1** VOLUME DOWN
- 2** VOLUME UP
- 3** LED DRIVING LAMP - ON/OFF
- 4** PLAY/PAUSE
- 5** NEXT TRACK
- 6** PREVIOUS TRACK
- 7** SYSTEM POWER - ON/OFF
- 8** POWER / SOURCE - RED = AUX-IN MODE / BLUE = BT MODE
- 9** BLUETOOTH PAIRING INDICATOR - BLUE COLOR
- 10** 3.5mm AUX INPUT

BLUETOOTH OPERATION

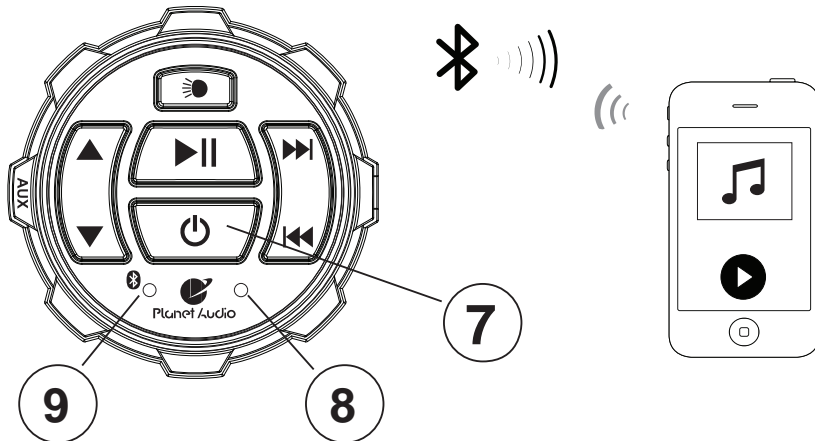

PAIRING & DISCOVERING A NEW BLUETOOTH CONNECTION

- 1) Power on the **MFC** by pressing and holding down the **7 Power** button for 3 seconds, the **9 BLUE** and **8 RED LEDs** will start to alternately flash, signalling that the **MFC** is now ready for **Bluetooth** pairing

NOTE: You have 2 minutes before you must restart this procedure over again

- 2) Now that the **MFC** is in pairing mode:

ANDROID users:

- a. Go into the **Settings Menu** of your device
- b. Enter the **Bluetooth Menu** and press **SCAN**
- c. "**Planet Audio**" will now be display under **AVAILABLE DEVICES**
- d. If prompted, enter passcode: "**0000**"

iOS users:

- a. Go into the **Settings Menu** of your **iOS** device
- b. Enter the **Bluetooth Menu**
- c. "**Planet Audio**" will now be displayed
- d. If prompted, enter passcode: "**0000**"

- 3) If **Planet Audio** is not seen, repeat the above steps to refresh the "**Device List**"

- 4) When the connection is successful the **BLUE LED** will be **ON**, you are now ready to stream music from your devices favorite media player to the **MFC**

BLUETOOTH OPERATION

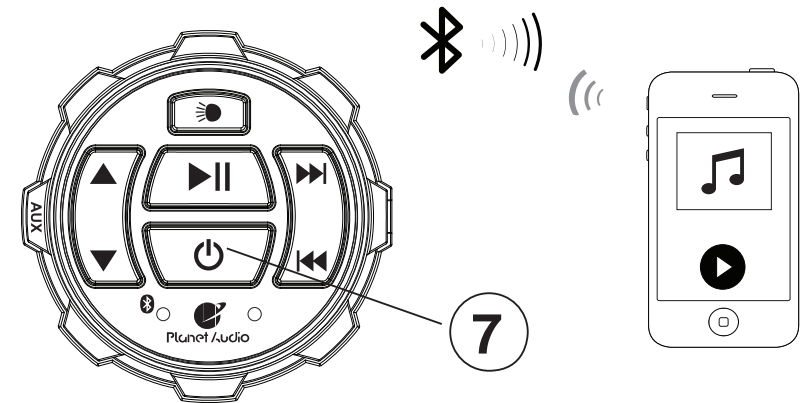

RECONNECTION

- 1) Power on the **MFC** and your last paired device **Bluetooth**
- 2) The unit will now automatically reconnect, the **BLUE LED** will be **ON**
- 3) If your device was previously paired with the **MFC**, but it wasn't the last paired device:
 - a. Ensure no other devices are currently paired
 - b. Enter the **Bluetooth Menu** on your device being paired
 - c. "**Planet Audio**" will display under **AVAILABLE DEVICES**
 - d. Choose "**Planet Audio**" to reconnect
- 4) If the device is out of range from the **MFC**, it will disconnect automatically:
 - a. Once device is back in range, it will automatically reconnect to the last device
 - b. The **BLUE LED** will be **ON**



Tips:

To avoid battery exhaustion be sure to run the vehicles engine while using this product. Using this product without running the engine can drain the battery

STREAMING MUSIC

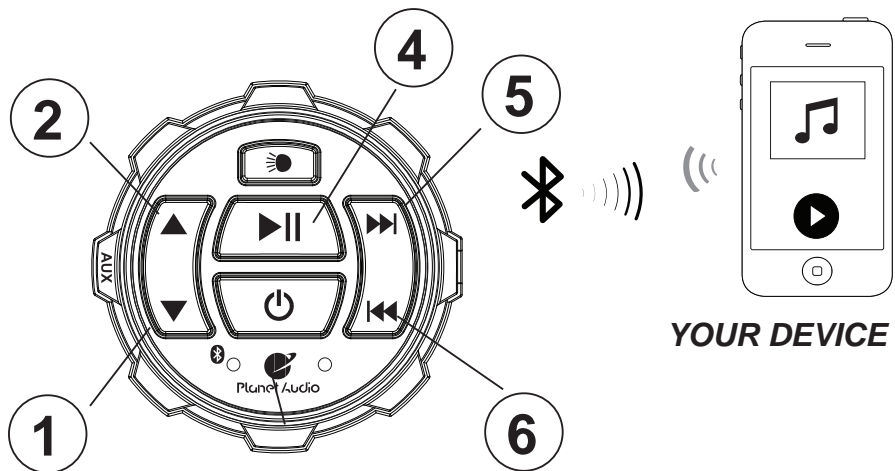

MULTIFUNCTION CONTROLLER BLUETOOTH OPERATION

- 1) Press the **4 PLAY/PAUSE** once to start playing music or press the **PLAY** button from your device touch screen, press again to **PAUSE**
- 2) To skip songs or advance, press the **NEXT TRACK 5**
- 3) To select the previous song, press the **PREVIOUS TRACK 6**

VOLUME CONTROL

- 1) To raise the **VOLUME press UP 2** button
- 2) To lower the **VOLUME press DOWN 1** button

 **Tips:** Turn the **BLUETOOTH** volume level on your device to it's 100% level

AUX-INPUT

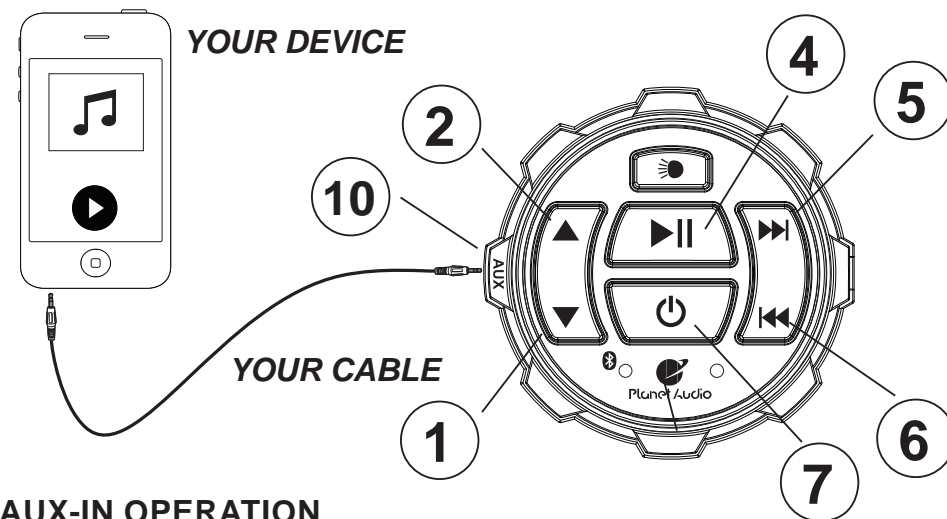

AUX-IN OPERATION

PATV85 can play audio from any device that has a 3.5mm headphone audio jack.

- 1) Power on the **PATV85** by pressing and holding down the **MFC POWER 7** button for 2 seconds
- 2) Connect the 3.5mm **AUX-IN** on the **MFU** to a 3.5mm adaptor **10** (3.5mm adaptor is not included)
- 3) The controller **LED** lighting will automatically change to **RED**, indicating the system is in **AUX-IN** mode
- 4) **Bluetooth** devices will remain paired even in **AUX-IN MODE**
- 5) Route the audio wires back to a convenient stowage place, secure your device

VOLUME CONTROL

- 1) To raise the **VOLUME press UP 2** button
- 2) To lower the **VOLUME press DOWN 1** button
- 3) To **MUTE / UN-MUTE** the **VOLUME press PLAY/PAUSE 4** button

 **Tips:** Turn the **HEADPHONE** volume level on your device to it's 100% level

INFORMATION TO THE USER

FCC COMPLIANCE STATEMENT

This device complies with part 15 of the FCC Rules. Operation is subject to the following two conditions:

- (1) this device may not cause interference, and
- (2) this device must accept any interference, including interference that may cause undesired operation of this device.

This transmitter must not be co-located or operated in conjunction with any other antenna or transmitter. The Bluetooth antenna cannot be removed (or replaced) by user. This equipment complies with FCC/ IC radiation exposure limits set forth for an uncontrolled environment and meets the FCC radio frequency (RF) Exposure Guidelines and RSS-102 of the IC radio frequency (RF) Exposure rules. This equipment has very low levels of RF energy that it deemed to comply without maximum permissive exposure evaluation (MPE). But it is desirable that it should be installed and operated keeping the radiator at least 20 cm or more away from person's body (excluding extremities: hands, wrists, feet and ankles). Alteration or modifications carried out without appropriate authorization may invalidate the user's right to operate the equipment.

NOTE: This equipment has been tested and found to comply with the limits for a Class B digital device, pursuant to Part 15 of the FCC Rules. These limits are designed to provide reasonable protection against harmful interference in a residential installation. This equipment generates, uses and can radiate radio frequency energy and, if not installed and used in accordance with the instructions, may cause harmful interference to radio communications. However, there is no guarantee that interference will not occur in a particular installation. If this equipment does cause harmful interference to radio or television reception, which can be determined by turning the equipment off and on, the user is encouraged to try to correct the interference by one or more of the following measures:

- Relocate or reorient the receiving antenna.
- Increase the separation between the equipment and receiver.
- Connect the equipment into an outlet on a circuit different from that to which the receiver is connected.
- Consult the dealer or an experienced radio/TV technician for help.



CAUTION!!
ADJUSTMENT OR ALTERATIONS OF THIS DEVICE MAY RESULT
IN HAZARDOUS RADIATION EXPOSURE.

11



TROUBLE SHOOTING GUIDE

TROUBLE	CAUSE	SOLUTION
Unit will not turn on	The fuse is blown	Check / replace the fuse
	Bad accessory power connection	Check accessory power port for proper operational voltage
No sound is heard	Blown speaker	Replace faulty speaker
	Volume is low / muted	Press the volume level up
	Device is paused or muted	Check your devices playing / volume status
Cannot pair Bluetooth	The Bluetooth function of your device is not enabled	Refer to the user manual of the your device for how to enable the Bluetooth function
	The MFC memory is full	Turn off the last paired device BLUETOOTH
The audio quality is poor after connection with a Bluetooth enabled device	The Bluetooth reception is poor	Move the device closer to the audio system or remove any obstacle between the device and the systems antenna
Unit has become unresponsive	Power glitch or interference	Disconnect power for 10 seconds to reset

SPECIFICATIONS

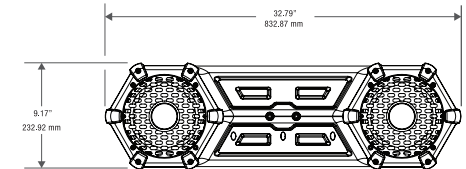
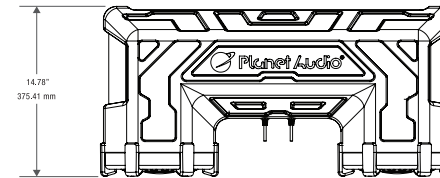

BLUETOOTH

- Version: 3.0 w/ EDR
- A2DP
- Range: 33ft (10m) Class 2

SPEAKERS

- Dimensions: 8"
- Impedance: 4Ω + 4Ω
- Cone Type: PP CARBON + RUBBER SURROUND
- Tweeter Size: 1" PEI SOFT DOME

AMPLIFIER

- Maximum Output Power: 700 Watts
- Input impedance: 10kΩ
- Frequency Response: 45Hz-25kHz

CHASSIS

- Weight: 20.5lbs / 9.31Kg
- Unit Dimensions cm HxDxW: 23.3 x 37.5 x 83.3
- Unit Dimensions Inches HxDxW: 9.17 x 14.78 x 32.79
- Controller Dimensions HxDxW: 1.00"x3.22"x3.22" / 25.2mm x 80.1mm x 80.1mm
- Controller cable length: 6ft / 2m
- MFC Quick Connect DIN Harness

GENERAL

- Operational Power: 14.4VDC (10.8V ~ 16V allowable)
- Grounding System: Negative type
- MAX Current Draw: 9.7A
- Replacement Fuse: 10A AGC TYPE
- USB MAX Current: 1A
- Color: Black
- Storage Temperature: 5°F to 113°F / -15°C to 45°C
- Operation Temperature: 14°F to 140°F / -10°C to 60°C

SPECIFICATIONS SUBJECT TO CHANGE WITHOUT NOTICE

Learn more about motorcycle sound systems we have.