

ADDITIONAL INSTRUCTIONS : HOW TO CORRECTLY POSITION THE HELMET SIDE MAGLOCK

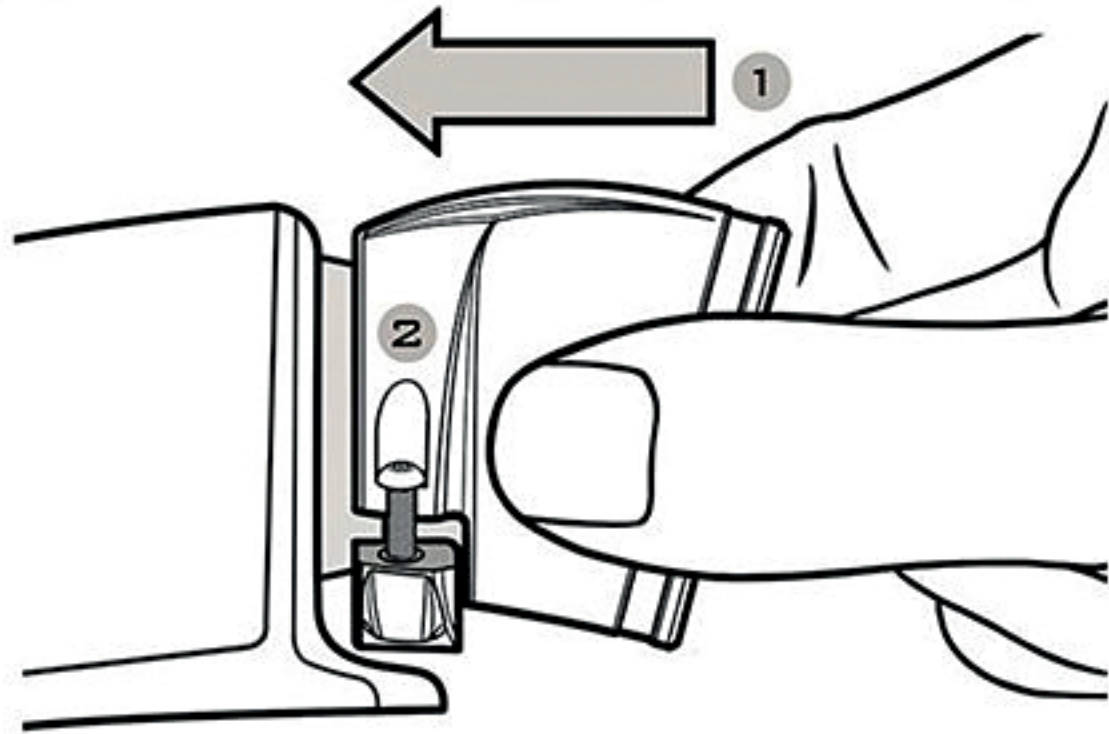

- 1** With the CLAMP screws loosened, push the HELMET SIDE MAGLOCK on to the BARB as far as possible.
- 2** PARTIALLY tighten the screws equally so the CLAMP is lightly gripping the BARB.

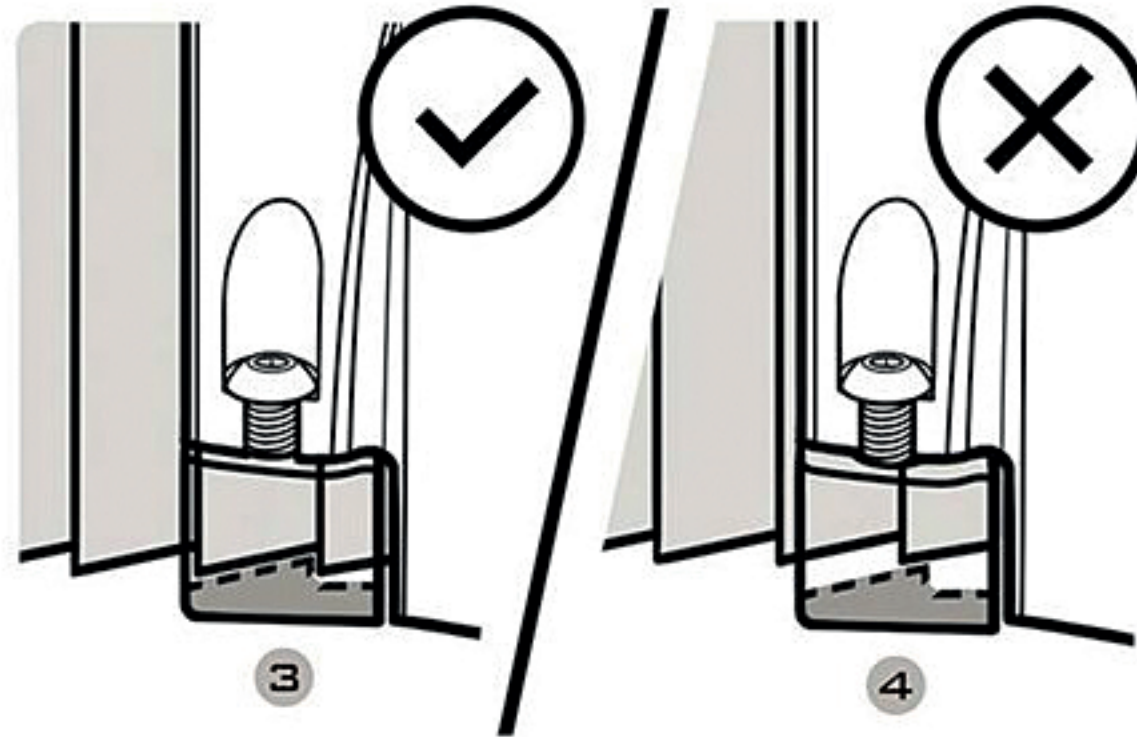

- 3** The HELMET SIDE is in the correct position when the CLAMP's raised lip rests in a valley on the BARB.
- 4** DO NOT install the HELMET SIDE with the CLAMP's raised lip positioned on the edge of the BARB.

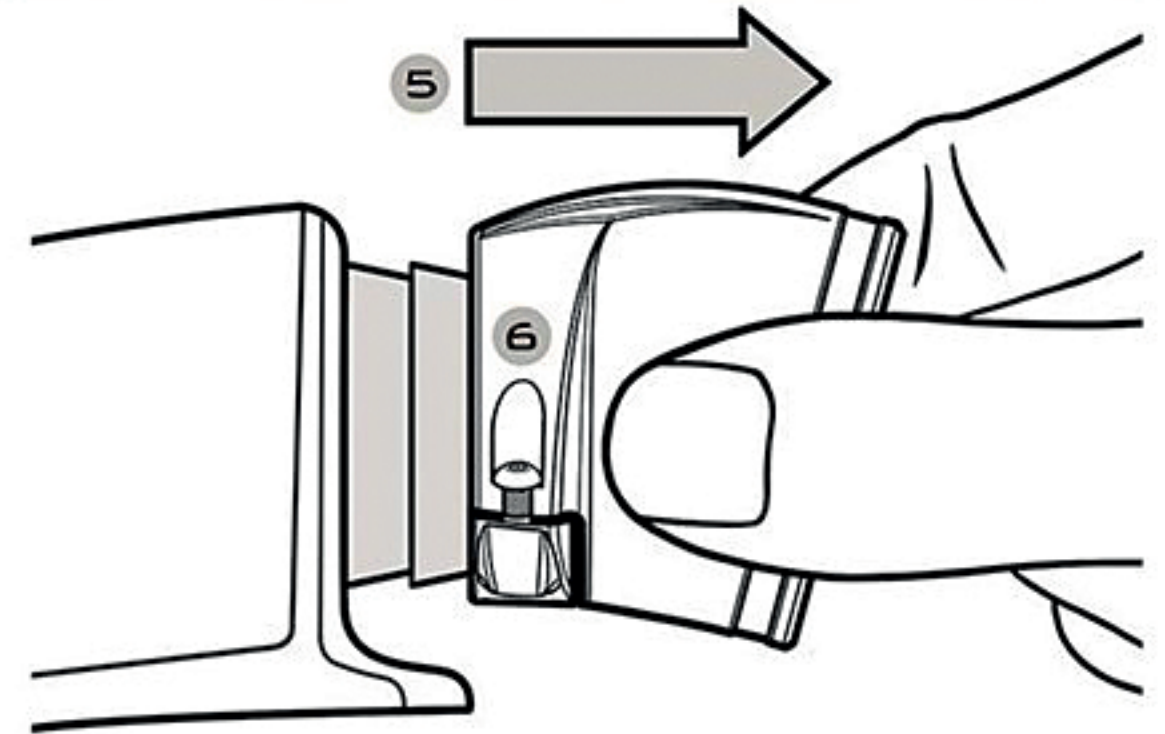

- 5** Pull the HELMET SIDE until the CLAMP grips a BARB edge, which keeps it from sliding off.
- 6** FULLY tighten the screws equally.