

Our high quality helmet is made with the most advanced European technology. The helmets are technologically advanced for the motorcycle rider's protections, wick are made for motorcycle riding only. This helmet specifications is subject to change without notice.



HELMETS FOR LIFE

X440



INSTRUCTION MANUAL

Please read this manual very carefully before wearing your helmet and keep it in a safe place. For a correct use and your safety, please pay attention to following instructions. The main function of helmet is to protect your head in case of impact. This helmet is made to absorb some of the energy of a blow by partial destruction of it's component parts and, even though damage may not be apparent, any helmet which has suffered an impact in an accident or received a similarly severe blow or other abuse should be replaced. To maintain the full efficiency of this helmet, there must be no alteration to the structure of the helmet or it's component parts.



Do not expose the helmet to any type of liquid solvent;



Always use the helmet in the proper position, using the buckle to adjust to the head;



The helmet should be handled with care. Leaving it drops can damage the painting as well as reduce their characteristics of protection;



Keep the helmet in a safe place (not hang on the mirror of motorcycle or other support that can damage the lining). Do not carry your helmet on the bike or in the arm while driving;

Light colors with matte finish require extra care as they are naturally more exposed to dust, fumes, compounds or other types of impurities.

HOW TO PLACE THE INTERCOM?

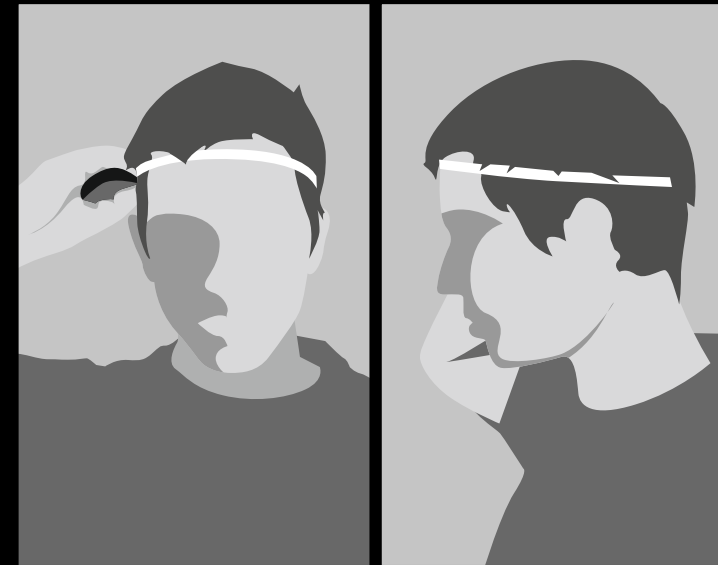

The size selection of the helmet is crucial to ensure the safety of the user. Never should use a helmet that is too small or too large in relation to the size of the head. To purchase a helmet is important that you try it: make sure the helmet fits perfectly to the head, there should be no gap between the helmet and the head; make some movements of rotation (left and right) with the helmet on the head (closed) this should not shake; it's important that the helmet is comfortable and involving the entire head.

HOW TO REMOVE THE VISOR?

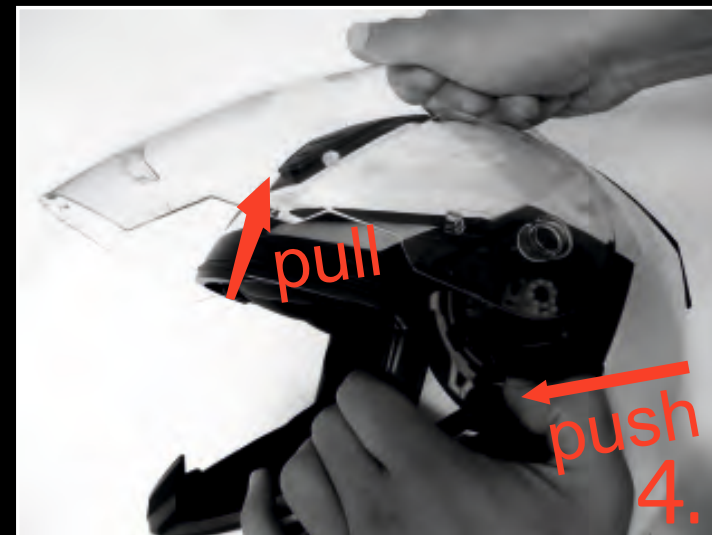

The lining of the helmet has the following characteristics:

- CoolMax fabrics (keep the interior cool, dry and comfortable)
- Anti-allergy

This lining can be removed and washable, as shown in the picture. If for some reason this lining is damaged it can be easily replaced.

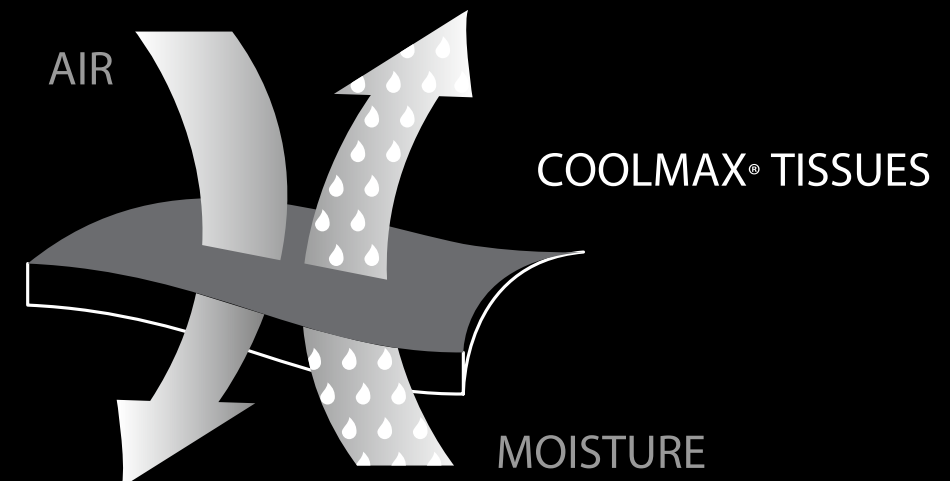

HOW TO PLACE THE INNER LINING?

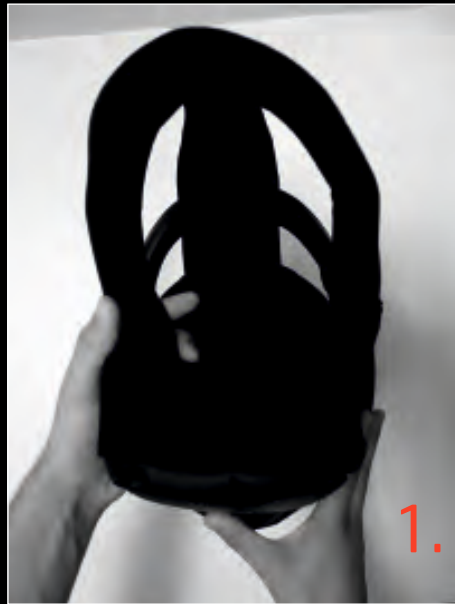

HOW TO PLACE THE VISOR?

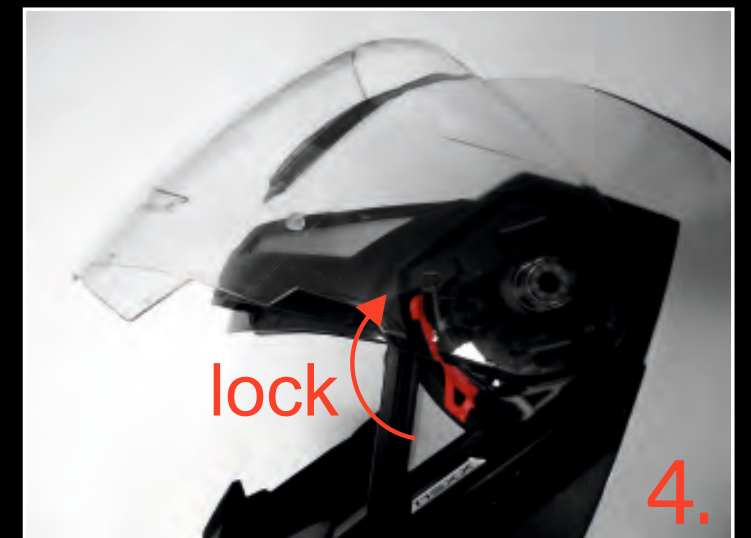

HOW TO CLEAN THE VISOR?

To clear the Visor without affecting its characteristics should be used only soapy water (preferably distilled) and a soft cloth. If the helmet is deeply dirty (ex. insect remains) can add a little liquid from the dish to water. Remove the Visor from the helmet before carrying a deeper cleaning. Never use objects to clean the helmet that may damage/scratch the visor. Always store the helmet in a dry place and protected from light, preferably in the bag provided by NEXX HELMETS.

HOW TO REMOVE THE INNER LINING

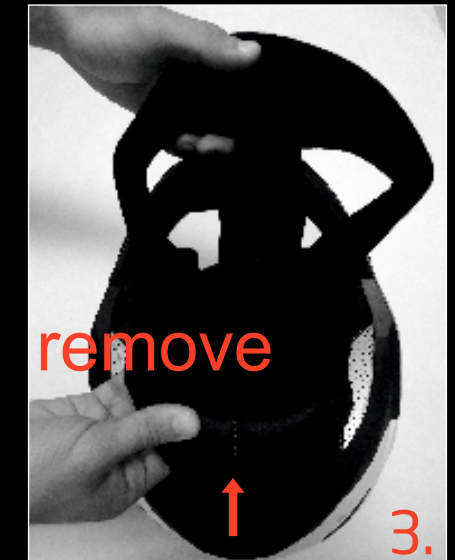

MULTI COMBINATIONS

1.



2.



3.



4.



5.



6.

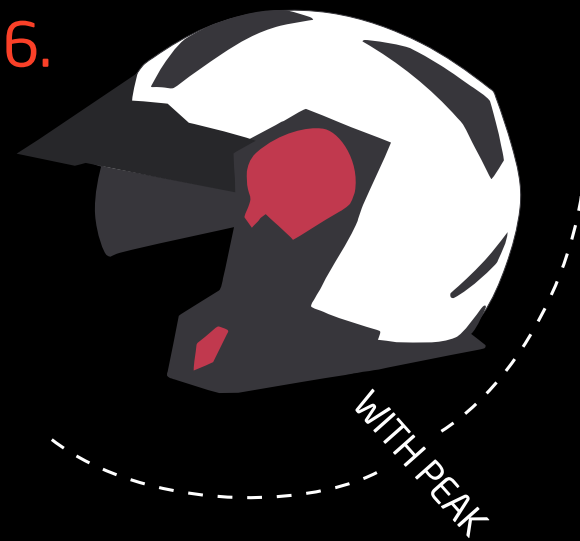

HOW TO USE THE INNER SUNVISOR?



open sunvisor



close sunvisor

HOW TO REMOVE THE INNER SUNVISOR?

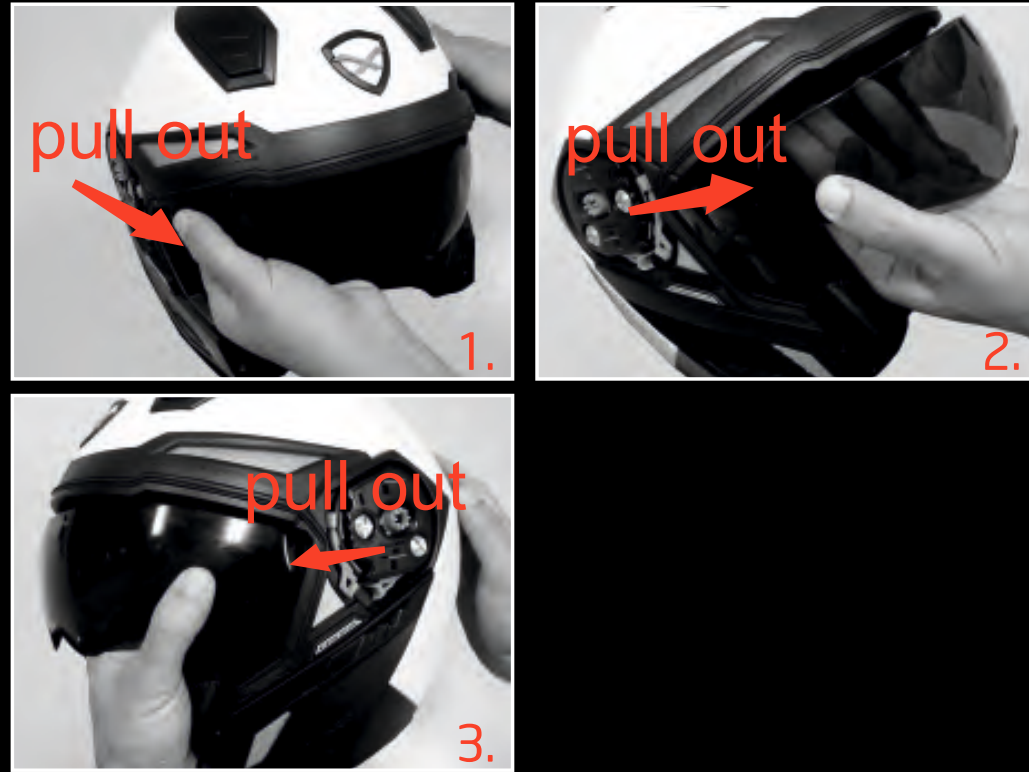

HOW TO PLACE THE INNER SUNVISOR?

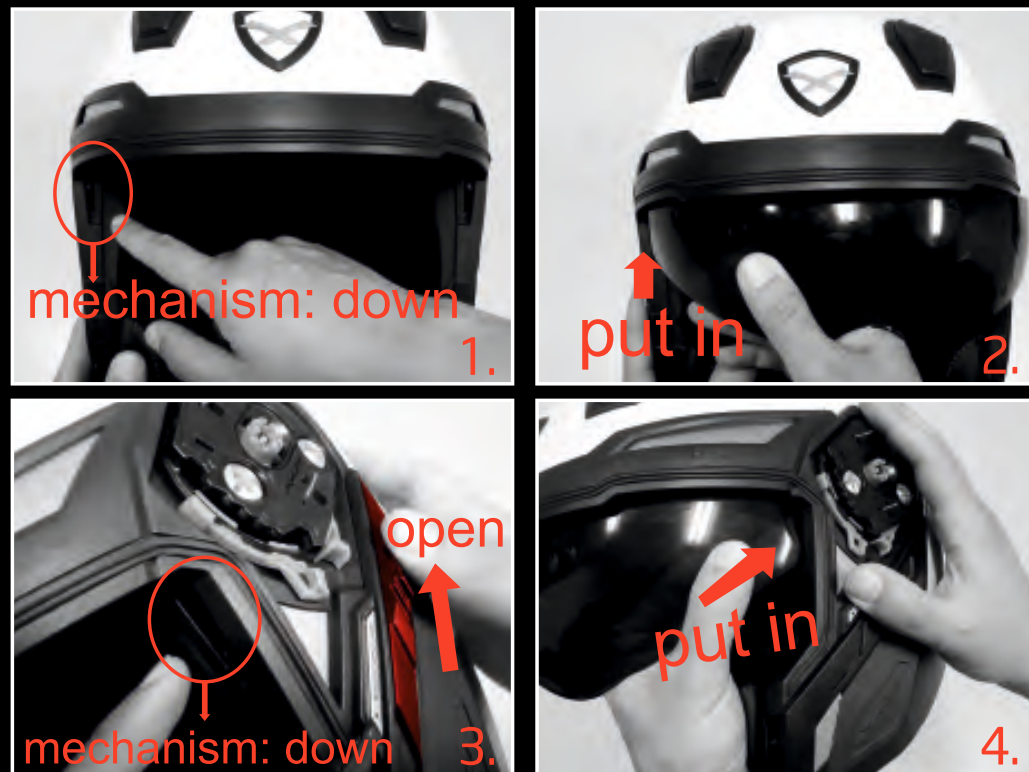

HOW TO REMOVE THE CHIN PROTECTION?

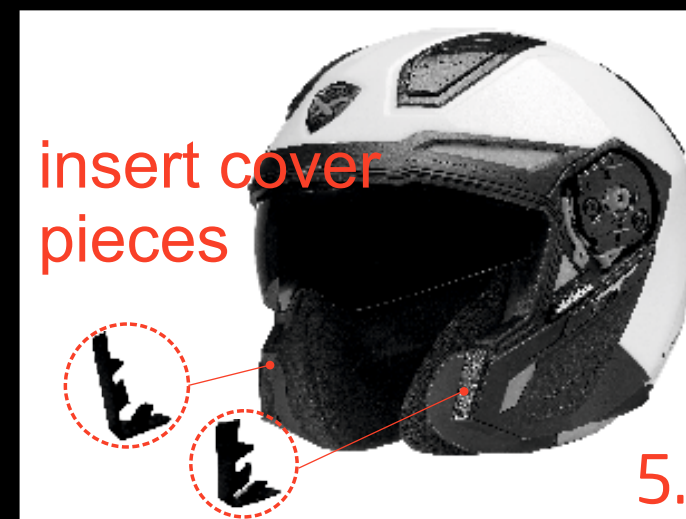
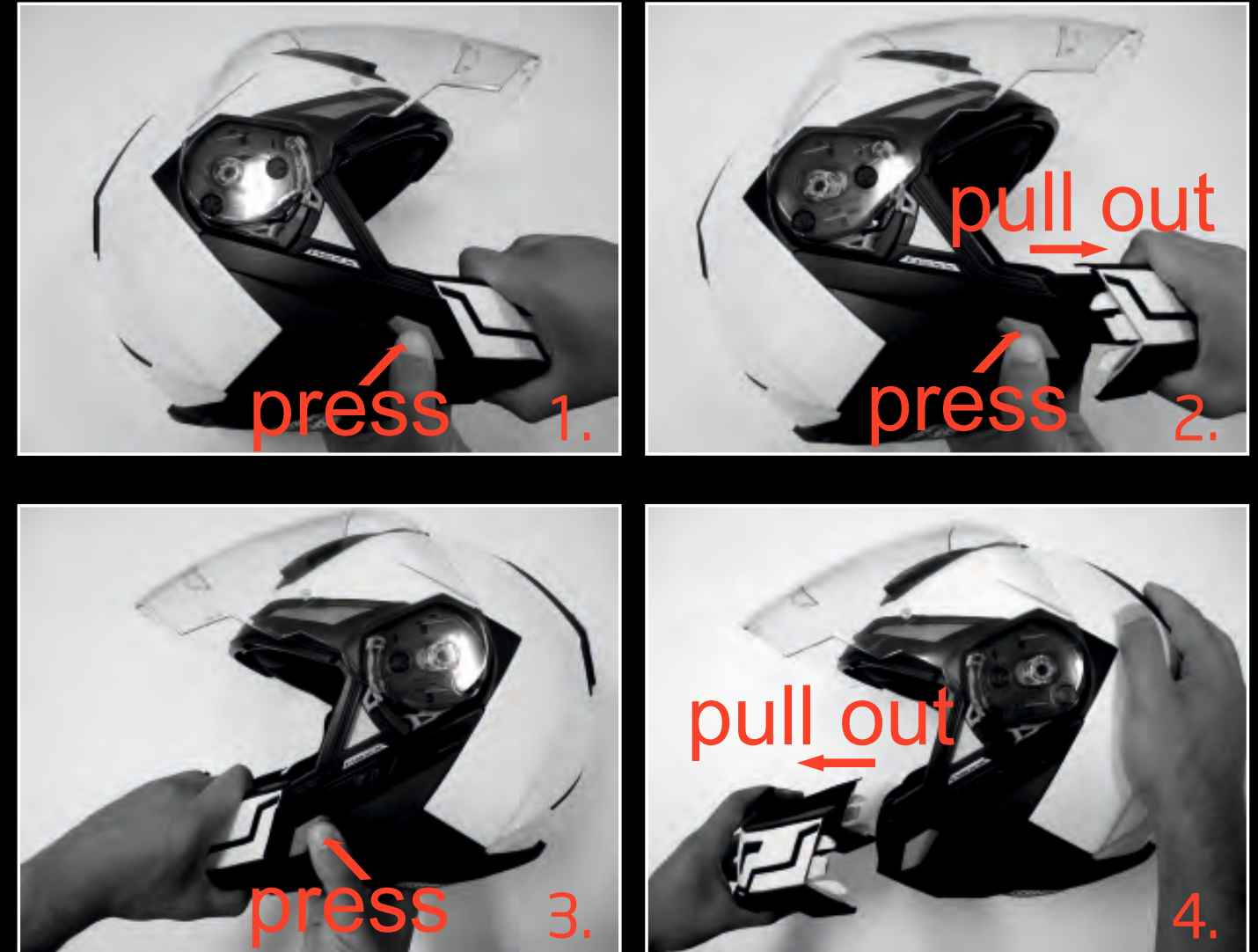

HOW TO REMOVE THE PEAK?



HOW TO PLACE THE PINLOCK?

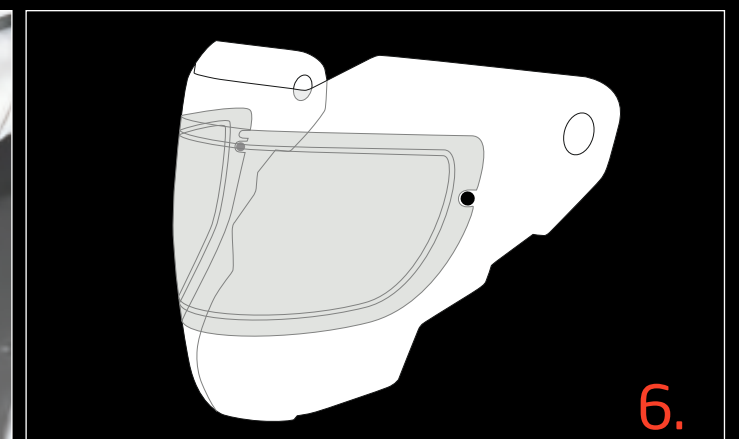

VENTILATIONS



HOW TO PUT IN THE PEAK?

