

# NEW RAGE CYCLES

## INSTALLATION INSTRUCTIONS

### DUCATI PANIGALE V4

#### FENDER ELIMINATOR

- 1** Disassemble lower section of stock tail section by removing (4) torx screws (pictures 1/2)
- 2** Unplug (3) OEM connectors (picture 3)
- 3** Remove (2) 4mm allen bolts and remove entire tail section. There is a metal tab underneath so be sure to slide down and out for easier removal (picture 4)
- 4** Now is when you decide whether to mount your license plate in the standard or tucked mounting locations
- 5** If mounting in standard location, take NRC plate, (2) M6x16 bolts, (2) star nuts, (1) black spacer, and mount to lens bracket. The black block spacers sandwiches in between the license plate and the lens bracket. Use the (2) caps in the lower holes to close up. (pictures 5/6)

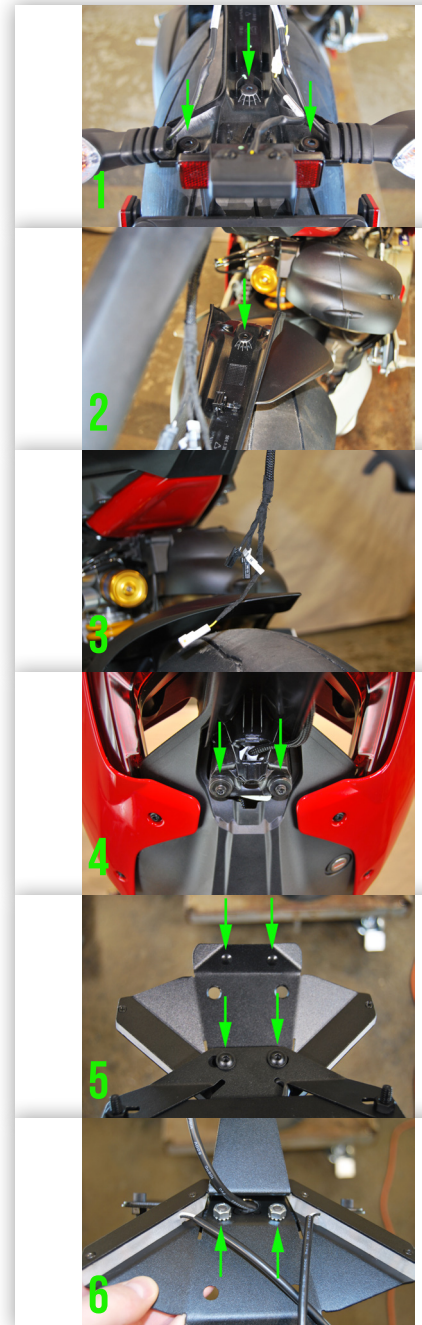

# NEW RAGE CYCLES

## INSTALLATION INSTRUCTIONS

### FENDER ELIMINATOR

- 6 Take (2) nylon shims and (2) M5x16 flat head bolts and prepare to mount onto bike, plugging in connectors first. Recommended Blue Loctite on M5 bolts (pictures 7/8/9)
- 7 If mounting in the tucked location, take NRC plate with (2) M6x10 bolts and (2) star nuts and mount license plate to lens bracket. The black block spacer is not used in this tucked position. Use the (3) caps in open holes on lens bracket to close up (pictures 10/11)
- 8 Mount onto bike just as stated above

