

NEW RAGE CYCLES

INSTALLATION INSTRUCTIONS

TRIUMPH STREET TWIN

FENDER ELIMINATOR

- 1 Remove seat from bike
- 2 Remove four stock bolts holding stock fender (picture 1)
- 3 Unplug stock connector attached to ECU (picture 2)
- 4 With new belly pan, bolt on using supplied M6 bolts and nuts leaving loose on front holes (picture 3)
- 5 With new license plate bracket, bolt to belly pan with supplied M6 bolts and nuts (picture 4)
- 6 Take new tail light, and sandwich in between belly pan and license plate bracket and bolt onto bike using stock bolts and supplied nuts (picture 5/6)
- 7 Plug new tail light back into stock connector

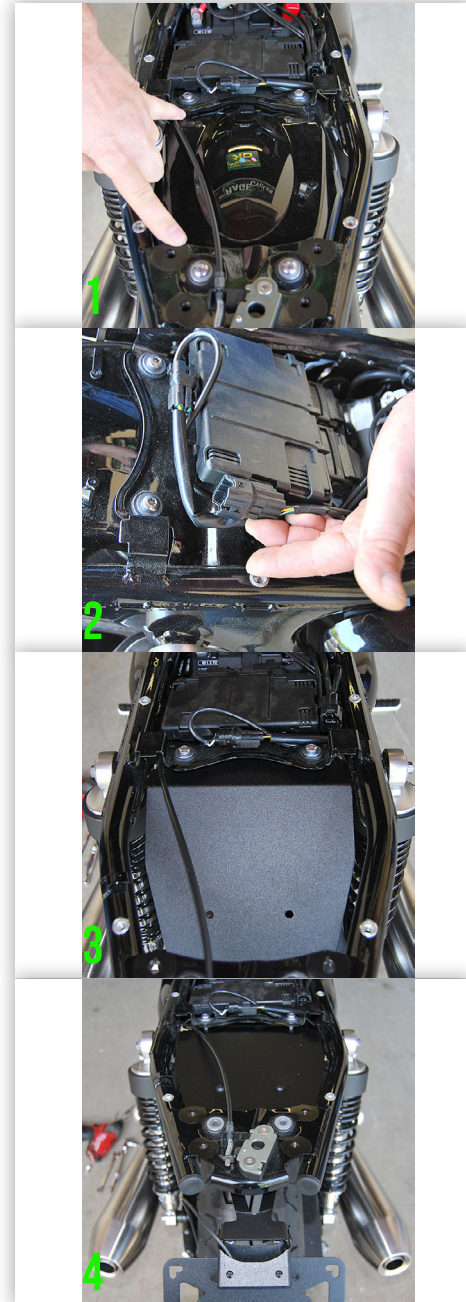

NEW RAGE CYCLES

INSTALLATION INSTRUCTIONS

FENDER ELIMINATOR

- 8 Tighten all bolts previously left loose
- 9 Put seat back on

