

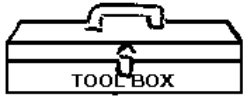

By National Cycle

PARTS LIST

Index	Part No.	Description	Qty.
1	90-970100-000	Highway Bar, Left	1
2	90-970101-000	Highway Bar, Right	1
BAG 380			
3	51-515720-000	Screw, M8 x 20	4
4	51-513105-000	Screw, M10-1.25 x 105	3
5	37-371590-000	Frame Bracket	2
6	51-513050-000	"U" Bolt	2
7	42-431010-000	Whizlock Nut, Chrome	4
8	49-490311-200	Washer, Flat	4



- Ball End Hex Key, 6mm
- Hex Key, 8mm
- 10mm and 14mm Socket Wrench 14mm
- Wrench, 1/2"
- Handle with 3/8" Drive
- Torque Wrench
- Service Manual

INSTALLATION TO VTX 1800 C

1. Ensure that the motorcycle is on flat level ground.
2. It is recommended that the motorcycle sit for at least one hour prior to installation to allow the engine to cool.
3. Remove the three radiator mounting bolts and allow the radiator to hang from the hoses (10mm Socket).

Install Frame Bracket

Note: to facilitate installation of the Whizlock Nuts to the "U" Bolt, loosely pre-assemble the Frame Bracket to the "U" Bolt with threaded ends of "U" facing outward.

4. From the front, place the "U" Bolt on the frame down tube near the top of the engine. **Figure 1.** Loosely install Frame Bracket with Flat Washers and Whizlock Nuts (1/2" Wrench.) **Orient assembly so Whizlock Nuts face engine.** Do not tighten. **Figure 2.**

INSTALLATION AND OWNER'S MANUAL

P4009

for **HONDA® VTX1800 C**

NOTE: Right and Left side of Motorcycle is determined while sitting on the bike.

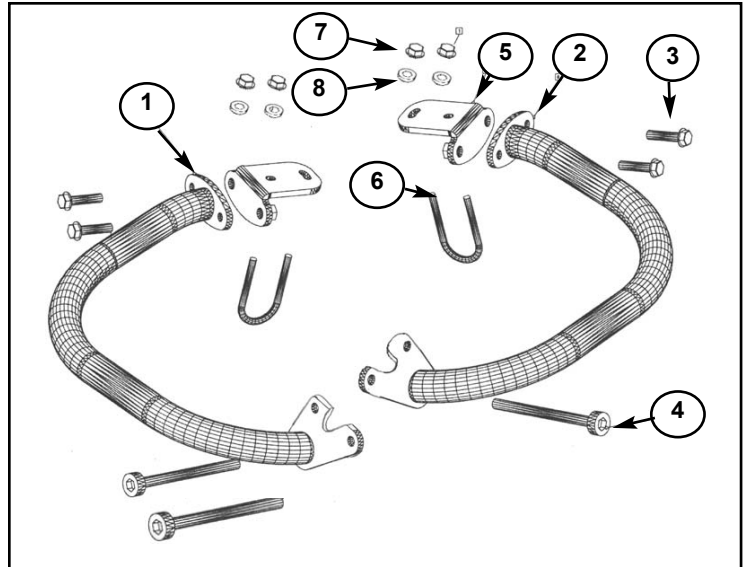

Parts List

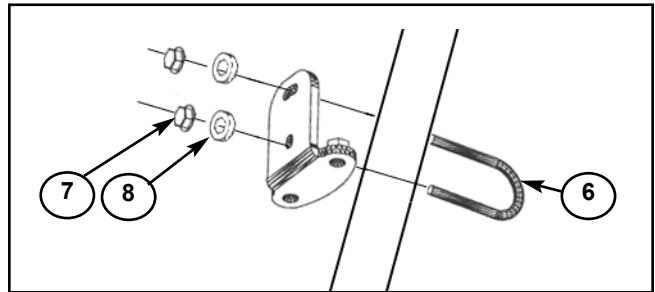

Figure 1

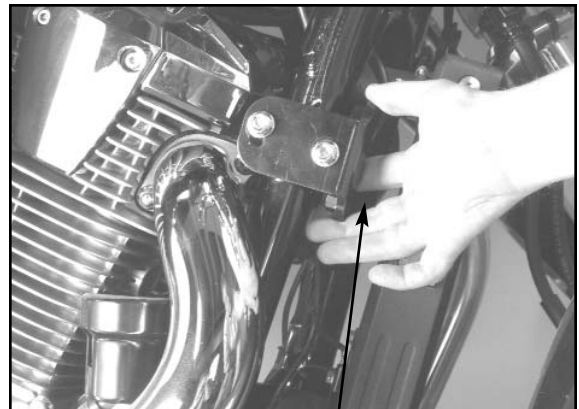

Figure 2

Once your frame bracket is loosely assembled, rotate bracket so whizlock nuts face engine.

5. Remove the two lower frame mounting bolts on the right side of the frame down tube (14mm Socket.) The upper, short bolt will be reused, the lower bolt will not but the nut will. Refer to **figure 3** for position.

6. Install the Highway Bar to the lower frame mounting point using the stock bolt in the bottom location (14mm Socket and Wrench) and a M10-1.25 x 105 Bolt in the top location (8mm Hex Key.) Do not fully tighten at this time. **Figure 3.**

7. Align the holes at the upper mount point of the Highway Bar with the holes in the Frame Bracket. Install with supplied M8 x 20 Bolts (6mm Hex Key.) Adjust "U" Bolt Assembly as needed. Do not fully tighten M8 x 20 Bolts.

8. For **LEFT SIDE of motorcycle**, repeat procedure 1-4 on Left side of motorcycle. **Step 5, you will not re-use stock bolt on left side of motorcycle. Step 6, Use the M10-1.25 x 105 Bolts in both hole locations.** Proceed with installation.

Tighten Fasteners

Lower Mount Point

9. Tighten all 4 Bolts (left and right side) at the lower mount point to specified torque in your service manual (14mm Socket.)

Upper Mount Point

10. Tighten all M8 x 20 Bolts (left and right side) at the upper mount point to 14 ft.lbs (6mm Ball End Hex Key.)

11. Tighten the 4 Whizlock Nuts firmly (1/2" wrench, open ended.)

12. Reinstall the three radiator mounting bolts and tighten to specified torque (10mm Socket).

MAINTENANCE / CAUTION

The high quality chrome finish of your National Cycle Chrome Highway Bar can be maintained with any quality chrome cleaner and / or polish applied with a soft cloth.

Check hardware for tightness regularly. Never ride with loose mounting hardware. Check to be sure your Highway Bar does not contact any part of the motorcycle at a full turn left and right. Correct any problem before using the motorcycle.

Upper Mount Point,
M8 x 20 Bolts.

Lower Mount Point

Lower Mount Point,
Top Location
M10-1.25 x 105 Bolt

Lower Mount Point,
Bottom Location
Stock Bolt.

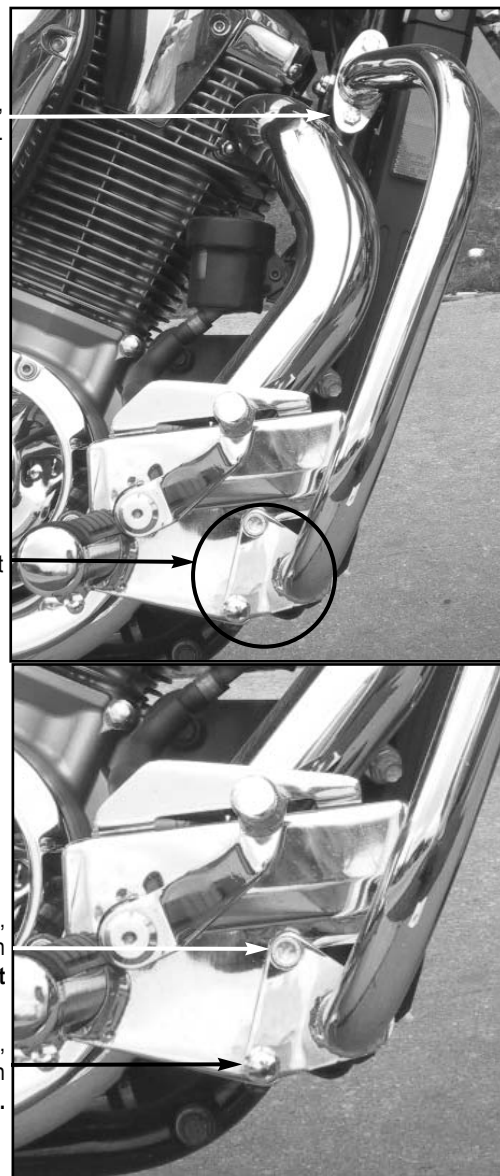

Figure 3