

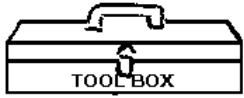

By National Cycle

PARTS LIST

Index	Part No.	Description	Qty.
1	90-970102-000	Highway Bar, Left	1
2	90-970103-000	Highway Bar, Right	1
BAG 385			
3	51-515720-000	Screw, M8 x 20	4
4	37-371590-000	Frame Bracket	2
5	51-513052-000	"U" Bolt	2
6	42-431010-000	Whizlock Nut, Chrome	4



- Hex Key, 6mm
- 10mm and 14mm Socket
- Wrench 14mm
- Wrench, 1/2"
- Handle with 3/8" Drive
- Torque Wrench
- Service Manual

INSTALLATION AND OWNER'S MANUAL

P4003

for HONDA® VT 750 CD ACE

NOTE: Right and Left side of Motorcycle is determined while sitting on the bike.

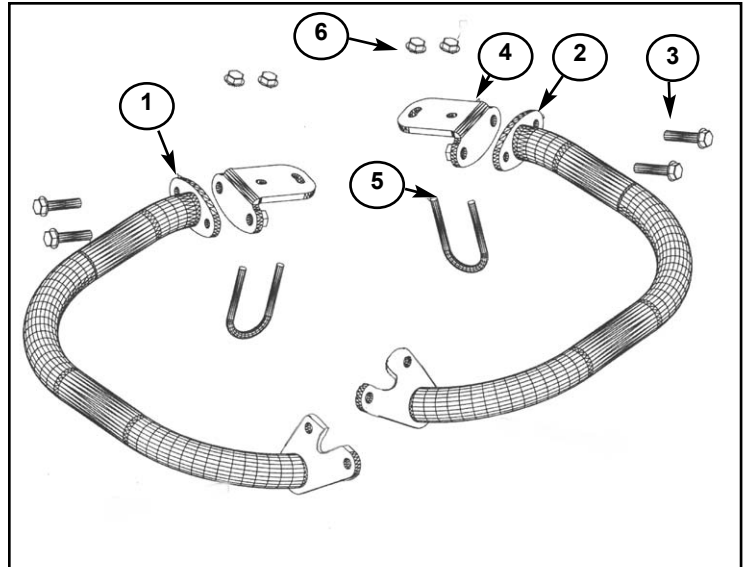

Parts List

INSTALLATION TO VT 750 CD ACE

1. Ensure that the motorcycle is on flat level ground.
2. It is recommended that the motorcycle sit for at least one hour prior to installation to allow the engine to cool.
3. Remove the top radiator mounting bolt to provide access to the frame down tube. (10mm Socket).

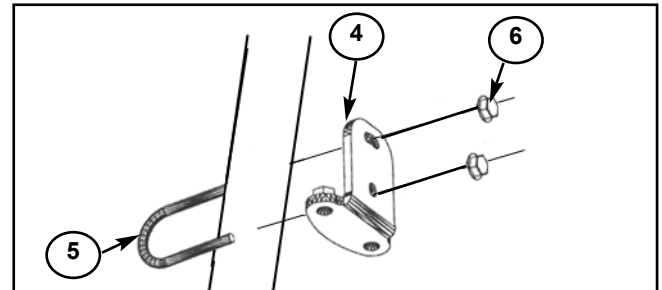

Figure 1

Install Frame Bracket

4. Start on the right side of the motorcycle and place the "U" Bolt on the frame down tube near the top of the engine. **Figure 1.**
5. **Loosely** install Frame Bracket with Whizlock Nuts (1/2" Wrench.) Orient assembly so Whizlock Nuts face radiator. **Figure 2.**

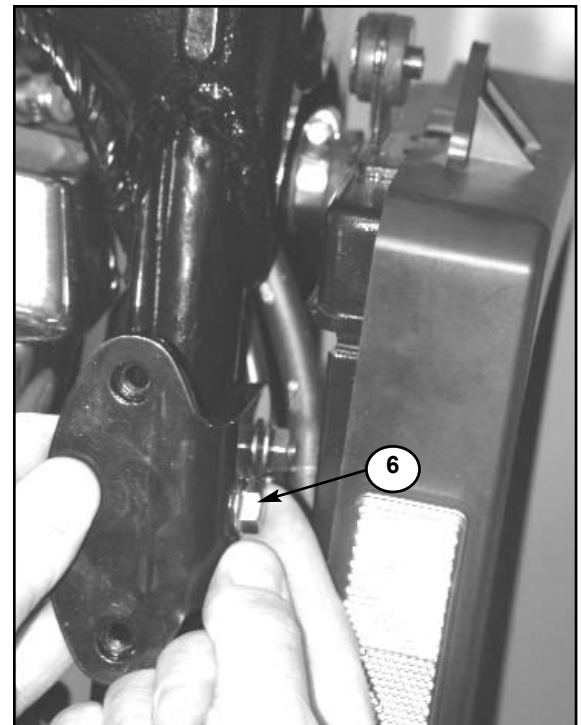

Figure 2

5. Remove the two lower frame mounting bolts on the right side of the foot peg (14mm Socket.) These bolts will be re-used.

6. Install the right side of the Highway Bar (exhaust side) first. Start out by mounting the bar to the outside portion of the foot peg assembly using the stock bolts and leaving them loose until the upper bracket is in place. (14mm Socket and Wrench.) Do not fully tighten at this time. **Figure 3.**

7. Align the holes at the upper mount point of the Highway Bar with the holes in the Frame Bracket. Install with supplied M8 x 20 Bolts (6mm Hex Key.) Adjust "U" Bolt Assembly as needed. Do not fully tighten M8 x 20 Bolts.

8. Repeat procedure 1-7 on Left side of motorcycle.

Tighten Fasteners

Lower Mount Point

9. Tighten all 4 Bolts (left and right side) at the lower mount point to specified torque in your service manual (14mm Socket.)

Upper Mount Point

10. Tighten all M8 x 20 Bolts (left and right side) at the upper mount point to 14 ft.lbs (6mm Hex Key.)

11. Tighten the 4 Whizlock Nuts firmly (1/2" wrench, open ended.)

12. Reinstall the radiator mount bolt and tighten to specified torque (10mm Socket).

MAINTENANCE / CAUTION

The high quality chrome finish of your National Cycle Chrome Highway Bar can be maintained with any quality chrome cleaner and / or polish applied with a soft cloth.

Check hardware for tightness regularly. Never ride with loose mounting hardware. Check to be sure your Highway Bar does not contact any part of the motorcycle at a full turn left and right. Correct any problem before using the motorcycle.

Upper Mount
Points
M8 x 20 Bolts.



Figure 3

Lower Mount Points use Stock Bolts
Mount to Outside Portion of the foot
peg assembly.