

Attention



Special notes and cautionary measures which can prevent damage to the accessory or motorcycle.

Note



Tips for facilitation of operation, control and adjustment, as well as maintenance work.

PARTS LIST FOR N7033

<u>Part</u>	<u>Description</u>	<u>Qty.</u>
70-710095-000	Rear of Rear Fender	1
BAG #588		
42-423050-000	Nut, Nylok	2
49-490531-000	Washer	2
55-568216-000	Screw, M5	2

Thank you for purchasing a National Cycle product.

PREPARATION

1. Position motorcycle securely on its stand or a work stand.
2. Clean the fender thoroughly.
3. Cover the area of the fender where the Fender Tip will mount with a thin layer of masking tape. Make certain the tape is smooth.

INSTALLATION of REAR FENDER TIP

1. Carefully, position the Rear Fender Tip on the fender, make sure the Tip is centered on the fender. **Figure 1**
3. Mark the hole locations with the marking pen. **Figure 2**
4. Remove the Fender Tip.
5. To avoid the drill slipping on the fender, use the Center Punch to make an impression at the center of your mark. Drill holes through the fender at the marks. **Figure 3**

 **Due to close clearances between front fender and tire, place block of wood between the fender and the tire to avoid tire damage. Figure 3**

6. Remove the masking tape.
7. Position the Fender Tip, and squeeze fender toward tip. Insert the Screws from the outside. Install the Washers and Nuts to the inside. Tighten securely. **Figure 4**

MAINTENANCE

Clean and polish with a chrome cleaner/polish. Check tightness of the nuts regularly.

TOOLS REQUIRED:

- Masking Tape
- Marking Pen
- Small Wood Block 1/2" Thick (not shown)
- Center Punch
- Power Drill with 7/32" Drill Bit
- 5/16" Wrench
- No. 2 Phillips Screwdriver



Note: Stock installation photos used.

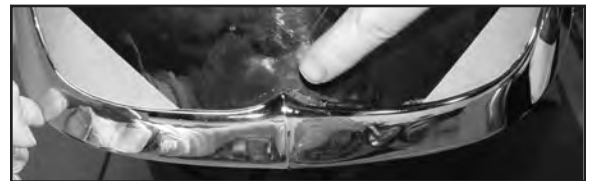

Figure 1



Figure 2

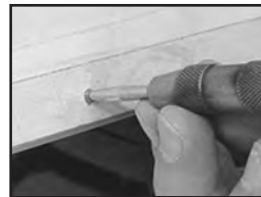

Figure 3

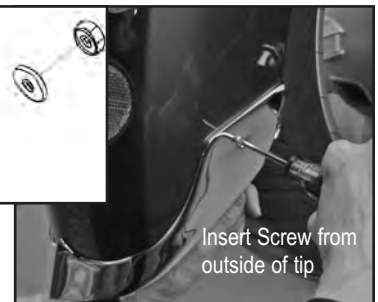
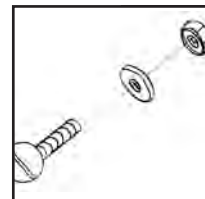
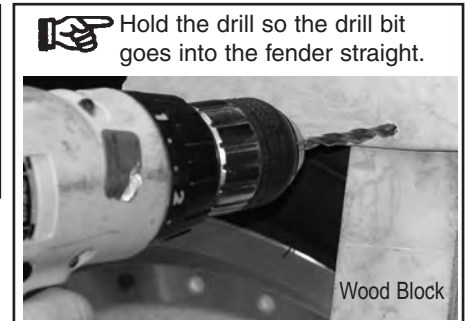

Figure 4