

**TOOLS REQUIRED:**

- Masking Tape
- Marking Pen
- Small Wood Block 1/2" Thick (not shown)
- Center Punch
- Power Drill with 7/32" Drill Bit
- 8mm Wrench
- No. 2 Phillips Screwdriver



Part No.	Description	Qty.
<b>N7015 Fender Tips</b>		
70-710059-000	Front of Front	1
70-710060-000	Rear of Front	1
<b>N7030 Fender Tips</b>		
70-710084F-000	Front of Front	1
70-710084R-000	Rear of Front	1

**Bag No. 448**

42-423050-000	Nut, M5	4
49-490531-000	Washer	4
55-568216-000	Screw, M5-0.8 x 16	4

**PREPARATION:**

1. Position motorcycle securely on its stand or a work stand.
2. Clean the fender thoroughly.

**INSTALLATION**

1. Cover the area of the fender where the Fender Tip goes with a thin layer of masking tape. Make certain the tape is smooth. **Figure 1.**

2. Carefully, position the front Fender Tip on the fender, make sure the Tip is centered on the fender. **Note:** To ensure a good fit, the Fender Tip is designed so that the fender will open up slightly and be pulled toward the Tip. **First, center and position the Tip, and with two hands firmly squeeze the fender against the side of the Tip while a friend marks the drill location. Figure 2 and 6**

3. Mark the hole locations with the marking pen. **Figure 3.**

4. Remove the Fender Tip.

5. To avoid the drill slipping on the fender, use the Center Punch to make an impression at the center of your mark. Drill holes through the fender at the marks. **Due to close clearances between front fender and tire, place block of wood between the fender and the tire to avoid tire damage. Figure 4.**

6. Remove the masking tape before installing tip.

7. Position the Fender Tip and insert the Screws from the outside. Install the Washers and Nuts. Tighten securely. **Figure 5.**

**REAR OF FRONT FENDER**

8. Repeat steps 1-7 to install the Fender Tip to the rear of the front fender.

**MAINTENANCE** Clean and polish with a chrome cleaner/polish. Check tightness of the nuts regularly.



Figure 1



Figure 2



Figure 3

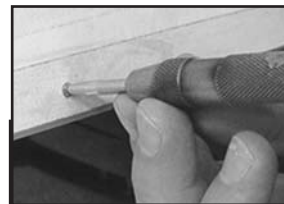

Figure 4

**Note:** Hold the drill so the drill bit goes into the fender straight.

Wood Block

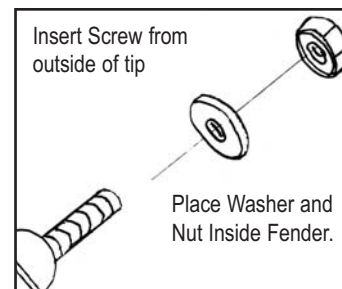

Figure 5

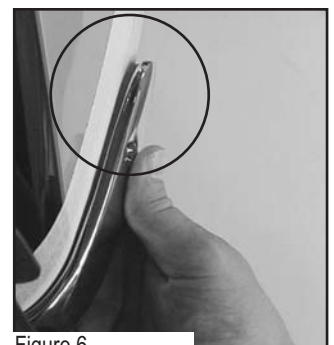

Figure 6

**INSTALLATION INSTRUCTION CAST FENDER TIP**  
**N7016 Rear Tip for Honda VT 750 Aero and**  
**N7031 Rear Tip for Yamaha XVS13A**

**TOOLS REQUIRED:**

- Masking Tape
- Marking Pen
- Center Punch
- Power Drill with 7/32" Drill Bit
- 8mm Wrench
- No. 2 Phillips Screwdriver



**Part No.**

**Description**

**Qty.**

**N7016**

70-710061-000 Rear of Rear 1

**N7031**

70-710085-000 Rear of Rear 1

**Bag No. 588**

42-423050-000 Nut, M5 2

55-568216-000 Screw, M5- 0.8 x 16 2

49-490531-000 Washer 2

**PREPARATION:**

1. Position motorcycle securely on its stand or a work stand.
2. Clean the fender thoroughly.

**INSTALLATION**

1. Cover the area of the fender where the Fender Tip goes with a thin layer of masking tape. Make certain the tape is smooth. **Figure 1.**

2. Carefully, position the Rear Fender Tip on the fender, make sure the Tip is centered on the fender. **Figure 1.**

**Note: For a good fit to the fender, the tip is designed so the fender will open up slightly and pull toward the Tip. Have a friend mark the hole while you firmly hold both sides and squeeze the fender to the tip.**

3. Have a friend mark the hole locations with the marking pen. **Figure 1.**

4. Remove the Fender Tip.

5. To avoid the drill slipping on the fender, use the Center Punch and make an impression at the center of your mark. Drill holes through the fender at the punch. **Figure 2.**

6. Remove the masking tape.

7. Position the Fender Tip and insert the Screws from the outside.

8. Install the Washers and Nuts on the Screws and tighten securely. **Figure 3.**

**MAINTENANCE**

Clean and polish with a chrome cleaner/polish. Check tightness of the nuts regularly.

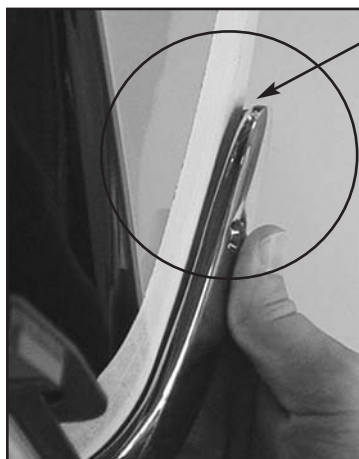

**Note:** To ensure a good fit, the Fender Tip is designed so that the fender will open up slightly and be pulled toward the Tip.

**First,** center and position the Tip and with two hands firmly squeeze the fender against the side of the Tip while a friend marks the drill location.



Figure 1. Tape Fender, Position Fender Tip, Mark Fender

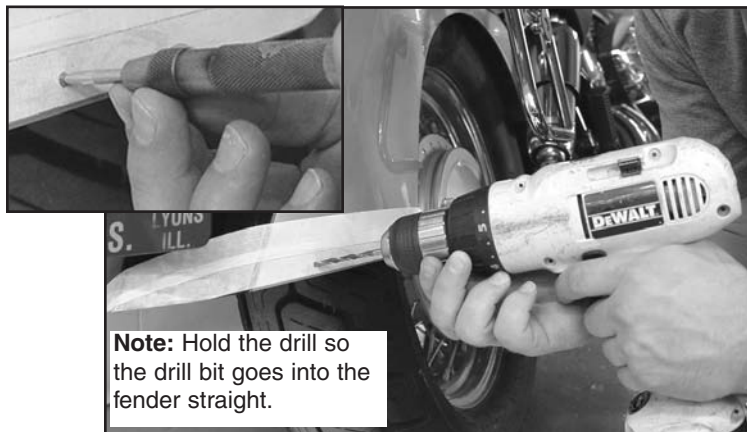

Figure 2.

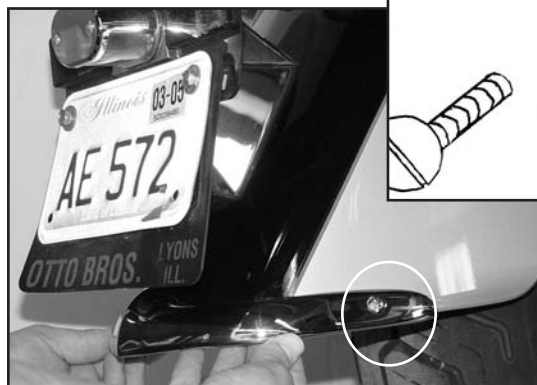
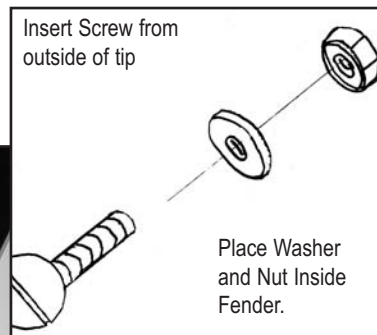

Figure 3.