

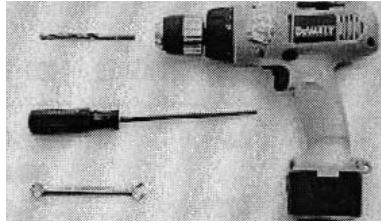

INSTALLATION INSTRUCTION
CAST FENDER TIP for Kawasaki VN2000
N7011 Two Piece Front; Front of Front and Rear of Front
and N7012 Rear Fender (Page 2).

TOOLS REQUIRED:

- Masking Tape
- Marking Pen
- Small Wood Block 1/2" Thick



- Power Drill with 7/32" Drill Bit
- 8mm Wrench
- No. 2 Phillips Screwdriver

PARTS LIST:

Part No.	Description	Qty.
70-710057F-000	Front of Front	1
70-710057R-000	Rear of Front	1

Bag No. 446

42-423050-000	Nut, M5	4
55-568212-000	Screw, M5-8 x 12	4

PREPARATION:

1. Position motorcycle securely on its stand or a work stand.
2. Clean the fender thoroughly.

INSTALLATION

1. Cover the area of the fender where the Fender Tip goes with a thin layer of masking tape. Make certain the tape is smooth. **Figure 1.**
2. Carefully, position the front Fender Tip on the fender, make sure the Tip is centered on the fender. **Figure 2.**
3. Mark the hole locations with the marking pen. **Figure 3.**
4. Remove the Fender Tip.
5. Drill holes through the fender at the marks. **Due to close clearances between front fender and tire, place block of wood between the fender and the tire to avoid tire damage. Figure 4.**
6. Remove the masking tape.
7. Position the Fender Tip and insert the screws from the outside.
8. Install the nuts on the screws and tighten securely. **Figure 5.**
9. Repeat the above steps to install 70-710057R-000 Fender Tip to the **rear of the front fender.**

MAINTENANCE

Clean and polish with a chrome cleaner/polish. Check tightness of the nuts regularly.



Figure 1.



Figure 2.



Figure 3.



Figure 4.

Note: Hold the drill so the drill bit goes into the fender straight.

Wood Block

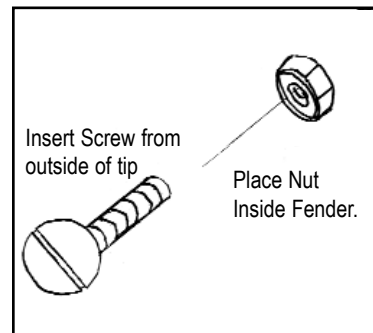

Figure 5.

Insert Screw from outside of tip

Place Nut Inside Fender.

INSTALLATION INSTRUCTION
CAST FENDER TIP for Kawasaki VN2000
N7012 Rear Fender Tip

TOOLS REQUIRED:

Masking Tape (Not shown)
 Marking Pen (Not shown)

Power Drill with 7/32" Drill Bit
 8mm Wrench
 No. 2 Phillips Screwdriver

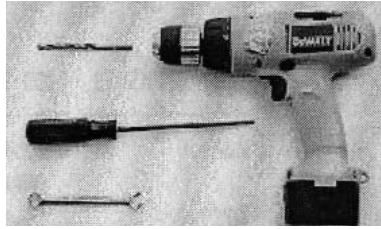

PARTS LIST:

Part No.	Description	Qty.
70-710058-000	Rear of Rear	1
Bag No. 447		
42-423050-000	Nut, M5	2
55-568212-000	Screw, M5-8 x 12	2

PREPARATION:

1. Position motorcycle securely on its stand or a work stand.
2. Clean the fender thoroughly.

INSTALLATION

1. Cover the area of the fender where the Fender Tip goes with a thin layer of masking tape. Make certain the tape is smooth. **Figure 1.**
2. Carefully, position the Rear Fender Tip on the fender, make sure the Tip is centered on the fender. **Figure 1.**
3. Mark the hole locations with the marking pen. **Figure 1.**
4. Remove the Fender Tip.
5. Drill holes through the fender at the marks. **Figure 2.**
6. Remove the masking tape.
7. Position the Fender Tip and insert the screws from the outside.
8. Install the nuts on the screws and tighten securely. **Figure 3.**

MAINTENANCE

Clean and polish with a chrome cleaner/polish. Check tightness of the nuts regularly.



Figure 1. Tape Fender, Position Fender Tip, Mark Fender

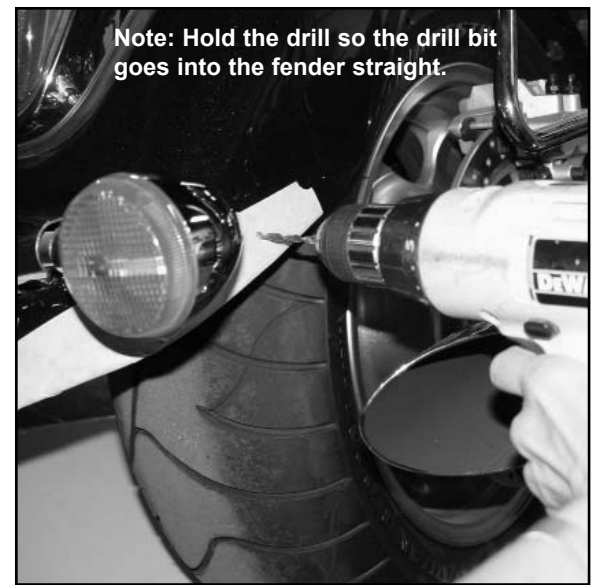

Figure 2.

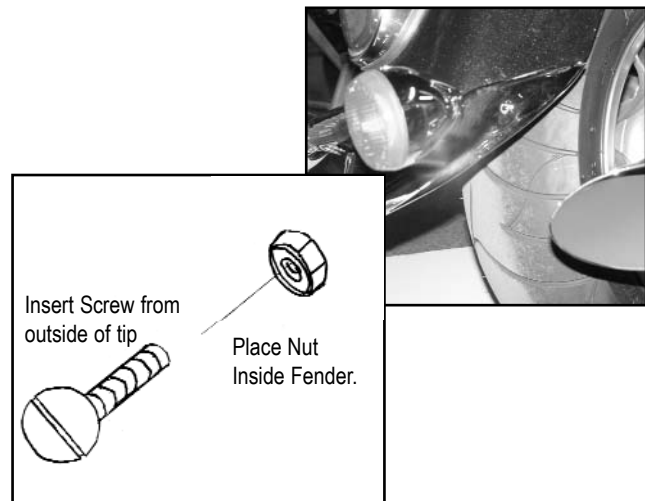

Figure 3.