

Thank you for purchasing a National Cycle® product. Please read these instructions carefully and thoroughly before beginning work. Dealers if installing this product for a customer please give them this manual. It contains information needed to properly maintain and use this product.

Report any missing parts directly to National Cycle, Inc. There is important code information located on the back of the the package that will be necessary when reporting missing parts.

Attention



Special notes and cautionary measures which can prevent damage to the accessory or motorcycle.

Note



Tips for facilitation of operation, control and adjustment, as well as maintenance.

PARTS LIST

Item	Part Number	Description	Qty.	Note
1		Wing Deflector, Dark Tint, Upper	2	Contained in N5107
2		Wing Deflector, Dark Tint, Left, Lower	1	Contained in N5107
3		Wing Deflector, Dark Tint, Right, Lower	1	Contained in N5107
1		Wing Deflector, Light Tint, Upper	2	Contained in N5109
2		Wing Deflector, Light Tint, LH Lower	1	Contained in N5109
3		Wing Deflector, Light Tint, RH Lower	1	Contained in N5109
4		Bracket, Left	1	
5		Bracket, Right	1	
6		Drill Bit	1	Used in Installation
		Template, Left and Right Side	1	Page 5 of Installation Manual

BAG#1006

7	55-585020-000	Screw, 4-20 x 1/4"	13	
8	49-490080-000	Washer M3	13	
9	75-762015-000	Washer, Neoprene	12	
10	34-340264-000	Stand-off	4	
11	51-516000-000	Screw, 10-32 x 3/8"	4	
12	75-766086-000	Circle, Mylar	6	

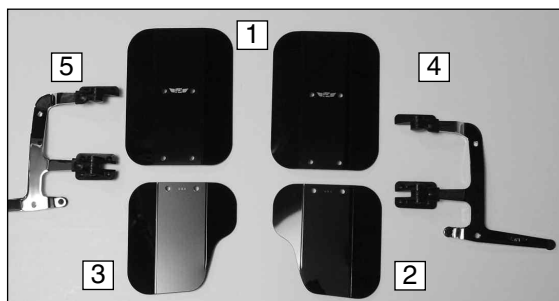
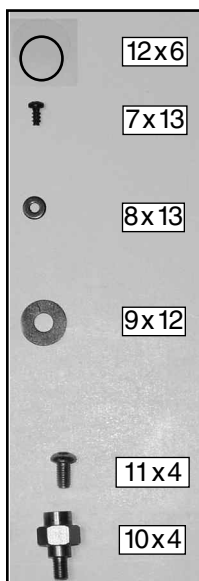

 Right and Left side of Motorcycle is determined while sitting on the bike.

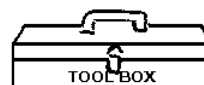

- 5mm Hex Key Wrench
- 1/2" Socket and Torque Wrench
- Thread Locker (Loctite 271® or equivalent)
- Scissor
- Tape
- Drill Press or Hand Drill, Not Shown
- Flat Piece of Wood (for use when drilling)
- 1/8" Hex Key Wrench
- #1 Phillips Screw Driver

PREPARATION AND DRILLING OF TRIM STRIP

1. Position motorcycle securely on center stand or side stand.
2. Carefully remove Right side trim piece (a). Start at the bottom of strip, pull strip from the inside edge towards the outside of the fairing gently lifting as you pull. As the bottom edge is released, work your way upward taking care not to break the retaining tabs. **Figure 1**



Figure 1

3. Remove Screws (b) (5mm Hex Key). **Figure 2**
4. Apply a small amount of Thread Lock to the threaded side of the Standoffs. Replace the screws removed in Step 3 with these threaded fasteners. Tighten securely. **4 ft/lb (5.4Nm) (1/2" Socket, Thread Locker) Figure 3**

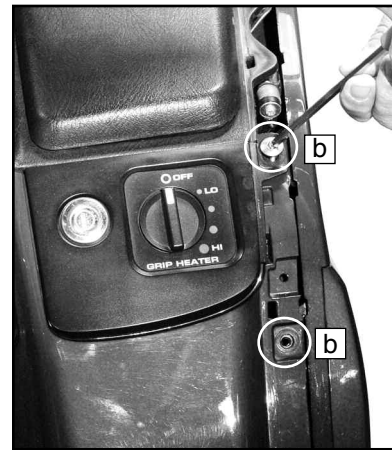

Figure 2

5. Cut Right Template from page 5. (Scissors) **Figure 4**
6. With markings on Template facing up, align Template between notches on inside of trim strip. Tape Template into position. (Tape) **Figure 5**

 **Before you drill, check position of template by holding trim piece into position on the right side of motorcycle.**

7. Make a pilot mark on strip at center of cross marks. (Drill Bit Provided) **Figure 5**

8. Carefully drill each hole using a slow speed. A drill press is preferred, however a hand drill can be used. Place the trim strip on a clean flat piece of wood for support while drilling. Use caution as required by the use of power equipment. Remove the paper template. (Drill Bit Provided and Drill) **Figure 5**

9. Repeat procedure on Left side of motorcycle.

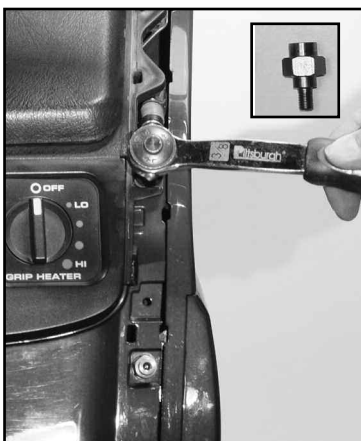

Figure 3

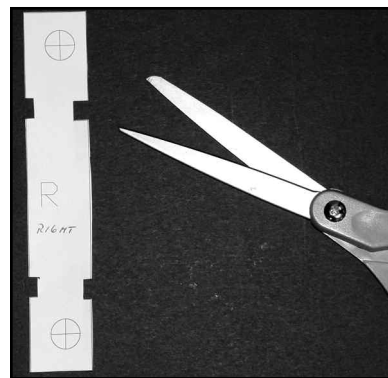

Figure 4

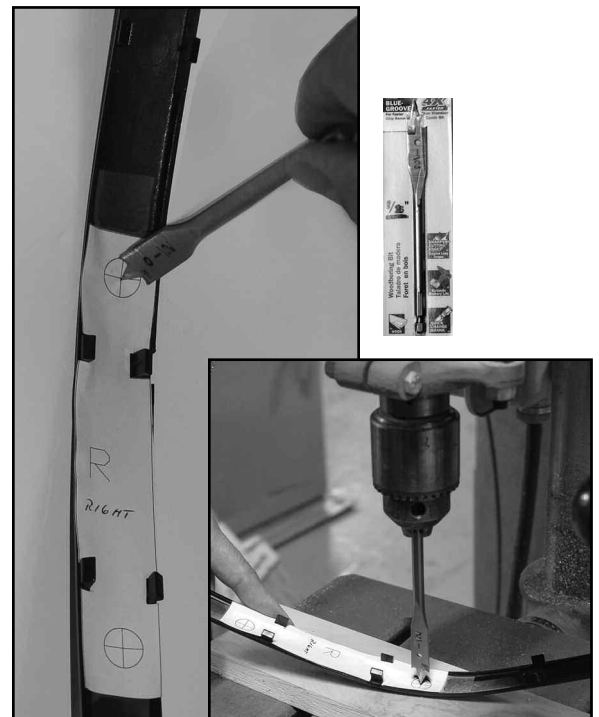

Figure 5

INSTALLATION OF BRACKET and WING DEFLECTORS

1. Replace the trim strips to the fairing working opposite of the way they were removed. Starting at the top push the top edge of the trim strip into the slot and work the outside edges strip into the notches and gently push in the back edges. Work your way down to the bottom of the trim strip. Holes in trim should align with standoffs. **Figure 6**

2. Install Right Bracket with 3/8" Screws. (1/8" Hex Key) **Figure 7**

3. Position Swivel Ratchet so studs face toward rider. **Figure 7**

4. Install Neoprene Washers on studs. **Figure 8**

5. Use a Washer and a 1/4" Screw to attach Upper and Lower Deflectors to Swivel Ratchet. (Phillips Screw Driver) **Figure 9 and 10**

6. Tighten Screws firmly, do not over-tighten. (Phillips Screw Driver) **6 in/lb (.7Nm)**

7. Repeat procedure on Left side of motorcycle.

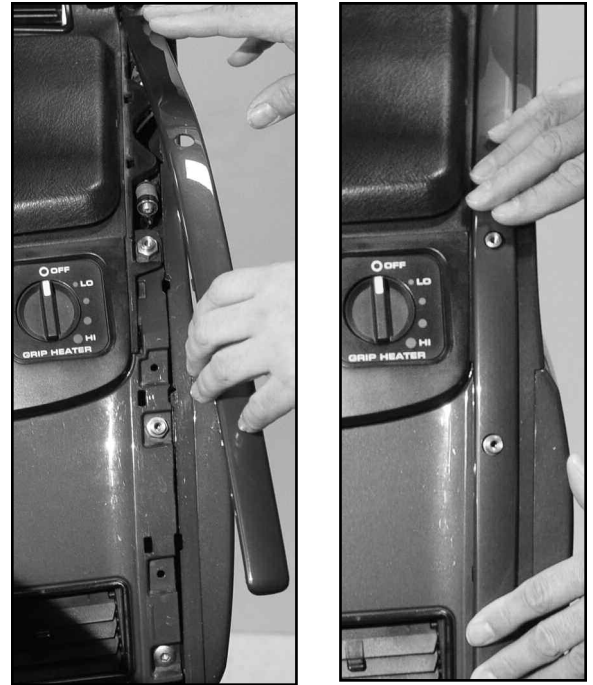

Figure 6

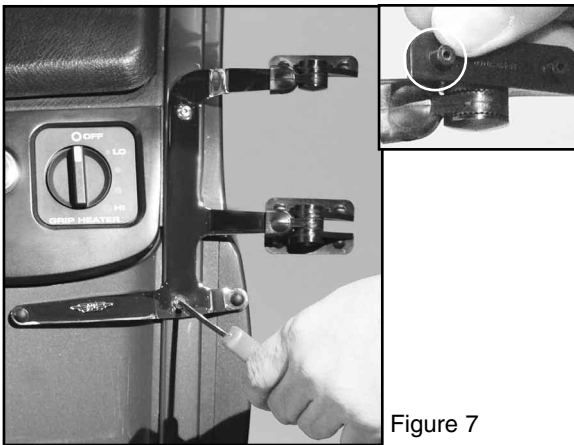

Figure 7

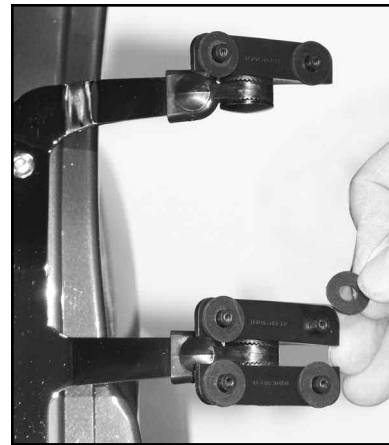

Figure 8

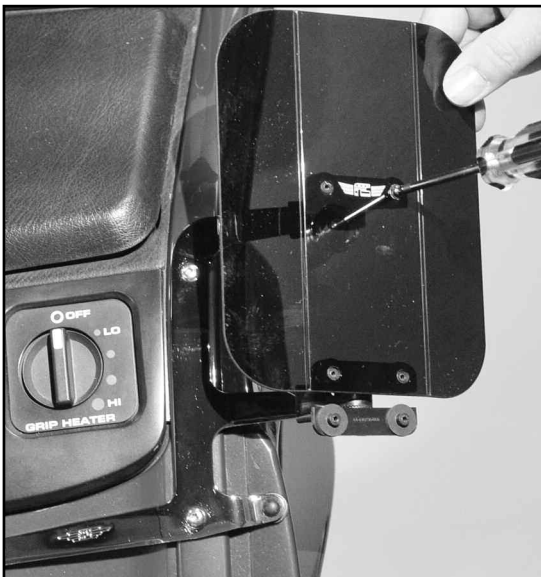



Figure 9



Figure 10

CHECK CLEARANCES

1. Refer to USING YOUR WING DEFLECTORS below and, if desired, place the mylar disks over the contact points on the fairing where the deflectors touch. **Figure 11**

 **Gently turn handle bar left and right to full fork lock to assure that no interference occurs between the Wing Deflector and any part of the motorcycle or other accessory mounted to the motorcycle. Make adjustments or remove accessory as necessary.**

USING YOUR WING DEFLECTORS™

1. In cold and or wet weather close deflectors up to fairing for maximum wind and rain deflection.
2. In moderate to hot weather open deflectors for desired air flow. Closing lower deflectors in hot weather can help deflect hot air from the radiators away.
3. For ultimate performance use Wing Deflectors™ in conjunction with our mirror mounted deflectors and VStream® wind-shield.



Figure 11

MAINTENANCE

Cleaning: Wash with a clean soft cloth, plenty of warm water and, if necessary, a non-abrasive soap such as dishwashing. Do not allow brake fluid, alcohol, or strong solvents to contact the plastic. National Cycle Windshield Wash Part number N1401 is recommended for everyday cleaning. Product is supplied with a handy travel size container and rag for easy storage on the motorcycle.



National Cycle 3-Year Limited Warranty

National Cycle hereby warrants to the original registered owner of a National Cycle polycarbonate product for a period of three years from the date of purchase against breakage. This limited warranty is expressly limited to the replacement of the polycarbonate deflectors. This limited warranty does not include scratches, coating fail-

ure, cosmetic wear and tear, replacement of hardware, or any consequential damages or expenses including labor cost of installation, removal and/or replacement, inconvenience, inbound freight expenses or damage to any other component of the motorcycle or any other accessories. Certain chemicals, generally known as acidic hydrocarbons, are known to cause polycarbonate damage and will not be covered under this limited warranty. Please refer to the cleaning instructions supplied.

WARNING

Never ride your motorcycle with loose accessory mounting hardware. Check the hardware for tightness regularly.

Today's motorcycles are built with enough frame rigidity to withstand the moderate loads imposed on them by the foreseeable addition of an accessory. If the accessory(ies) adversely affects your motorcycle's stability, immediately remove the accessory(ies). Do not ride a motorcycle that exhibits unsafe handling traits.

Have experienced service personnel correct any problem before riding with the accessory(ies) installed. For further questions concerning handling problems associated with an accessory(ies), contact your dealer, motorcycle manufacturer, or accessory manufacturer.

Use this guide to verify your printed template for exact 100% scaling.

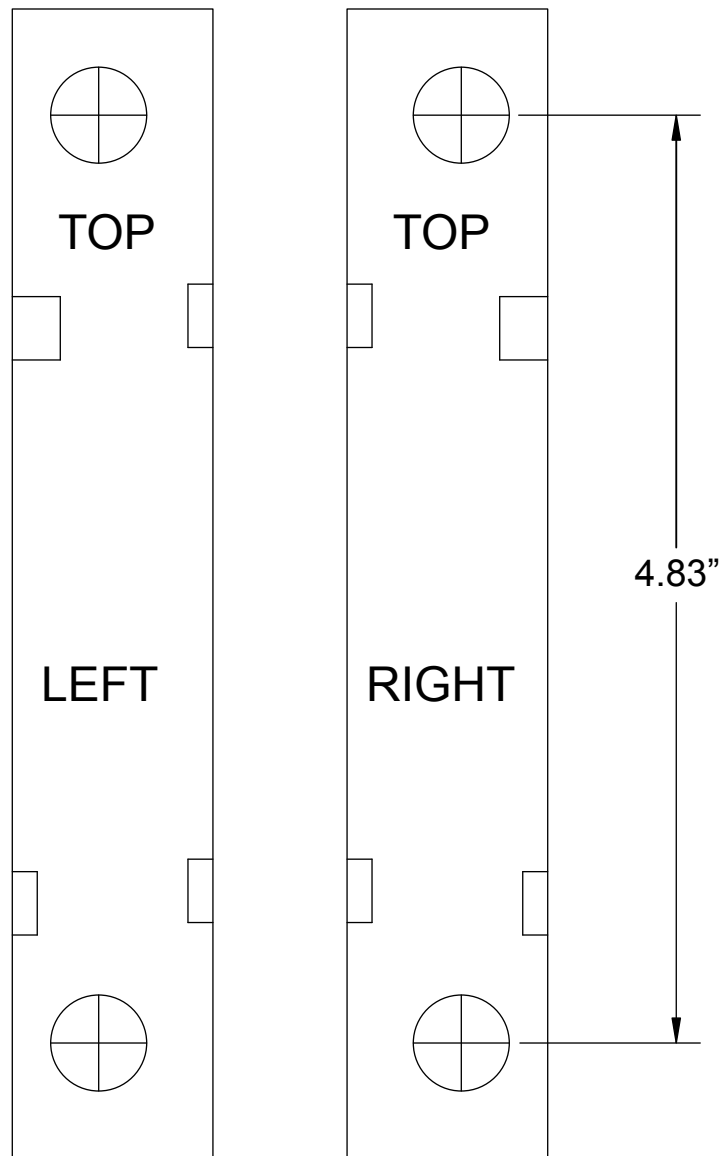
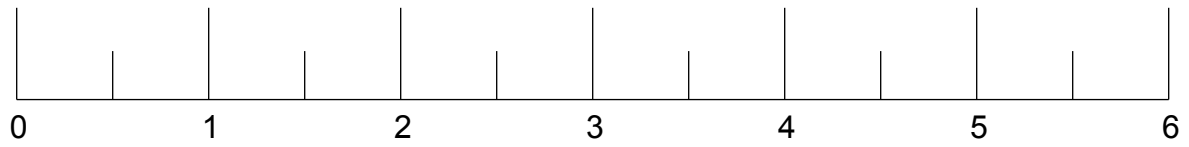

Find out more about windshields & fairings we have.