

Description:	Wiper Kit for UTV Windshield, Wash'n'Wipe™ 3D Full Size, N30006	Model:	Honda Pioneer 1000
Part Number:	N30006-WK	Installation Time:	60 min

Thank you for purchasing a National Cycle product. Read these instructions carefully and thoroughly before beginning work. Dealers, if installing this windshield for a customer, please give them this manual. It contains information needed to properly maintain and use this product.



Attention:
Special notes and cautionary measures which can prevent damage to the accessory or vehicle.



Note:
Tips for facilitation of operation, control and adjustment, as well as maintenance work.

PREPARATION

This Kit has been carefully packed and inspected at the factory. Report any missing part directly to National Cycle, Inc. along with the Bag No. and Date on outside of the Carton.

Carefully unpack the Kit, sort the parts, and make sure you have everything required to complete the installation to the vehicle.

TOOL LIST

Flat Blade Screwdriver
X-Acto® Knife, or similar
Marker
Masking Tape
Wire Cutters
Power Drill with 3/4" (19mm) hole saw, or similar
Small Drill Bit (1/8") (3mm) for pilot hole
Power Drill with 3/8" (9.5mm) drill bit
#2 or #3 Phillips Screw Driver or Phillips Bit for Drill

For Wiper Unit

Torque wrench, 3 – 16 ft-lbs [4-22 N-m]
Socket and/or wrench set

Parts List

Item	Part No.	Description	Qty.	Notes and Tools
1	80-875150-000	Motor Assembly	1	
2	80-875153-000	Arm, 14" (35cm)	1	Replacement Arm No. N30911
3	80-875155-000	Blade, 16" (40cm), Silicone	1	After Installation, Remove Protective Cover Replacement Blade No. N30901
4	44-442523-000	Reservoir and Pump Assembly	1	
5	37-373694-000	Bracket, Tank Hanger	1	
BAG#1324 Page 3				
6	80-830326-000	Wire Harness with Switch	1	
7	80-875156-000	Kit, Spindle Hardware	1	Doga Reference, 100.6469.09.00
8	80-875157-000	Kit, Stud Hardware	1	Doga Reference, 100.6470.09.00
9	44-447167-000	Grommet, Small, 5/8" (15.24mm) OD	1	Flat Blade Screwdriver
10	44-441927-000	Check Valve	1	
11	44-448726-000	Zip-Tie, 7.5" (19.05cm)	6	Wire Cutter
12	55-562600-000	Screw, #10-32, SS	2	Flat Blade Screwdriver
13	49-490543-000	Washer, Flat, SS	2	
14	42-450024-000	Nut, Hex, #10-32, Nylok	2	
15	5207	Wellnut	2	
16	55-581009-000	Screw, 10-32 x .875 SS	2	Phillips Screwdriver
17	44-449372-000	Clamp, Wrap Around, 1.50" (3.81cm)	1	
18	75-764022-000	Clamp Spacer, .75 x 6.0 x .125	1	
19	44-449380-000	Pin, grommet retaining	1	
20	44-447159-000	Grommet, Large	1	
21	44-448705-000	Clamp, Cable	1	
22	55-563131-000	Screw, #12 x 1.25" SS	1	Phillips Screwdriver
23	75-766830-000	Gasket, L= 54.75" (139cm)	1	
24	75-766831-000	Gasket, L= 26.5" (67cm)	1	

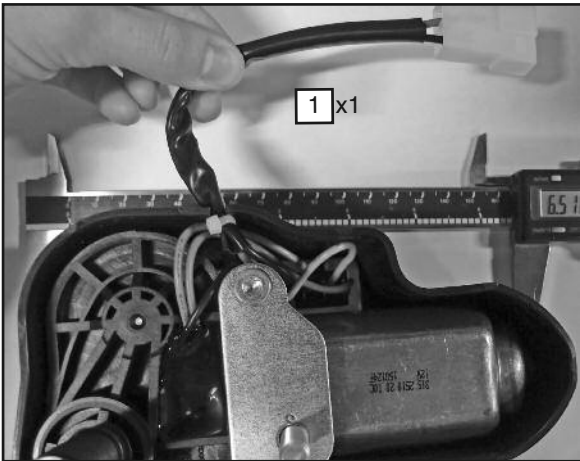

1 x1

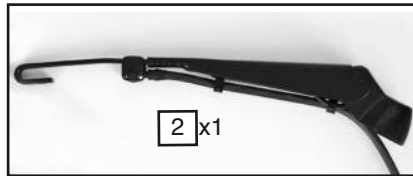

2 x1

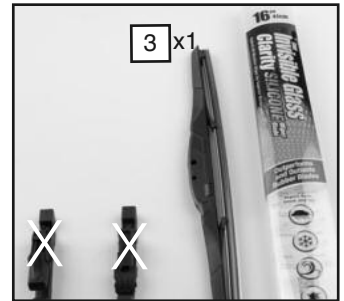

3 x1



4 x1

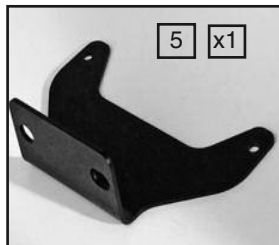

5 x1

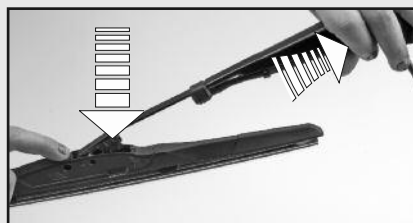
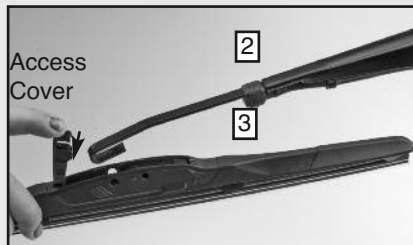

ASSEMBLY OF WIPER BLADE TO ARM

Open the small access cover on the Wiper Blade (3).

Join the end of the Wiper Arm (2) to the Wiper Blade (3). Place the J-hook of the Arm over the Blade's plastic mounting clip until it clicks and locks into place. Close the small access cover.

WIRE HARNESS

6 x1

c Pump Switch for Wash
Mounts to Dash Inside Cab

a Battery Connections Black-Negative, Red-Positive

d Motor Connector and
Fluid Hose
Installs to Motor

e Grommet,
Seals 3/4' Hole

b Pump Connector and Fluid Hose
Installs to Fluid Reservoir/Pump

7 x1 Spindle Kit



8 x1 Stud Kit



9 x1



10 x1

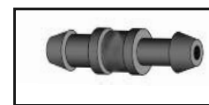

11 x6



12 x2
13 x2
14 x2

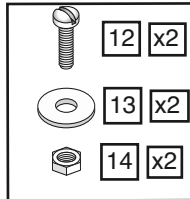

15 x2
16 x2

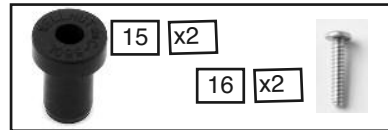

17 x1 21 x1 18 x1



23 x1



24 x1



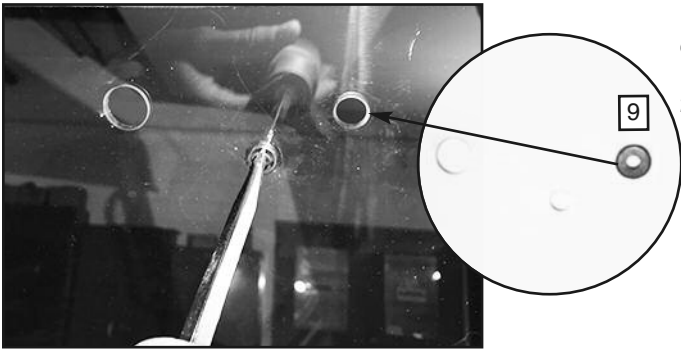

Fig 01

PREPARE WINDSHIELD FOR WIPER MOTOR

1. From the inside of the windshield, push out the three Plugs in the top center of Windshield. **Fig. 01 (Flat Blade Screwdriver)**

2. Install grommet (9) into the hole shown. **Fig. 01**

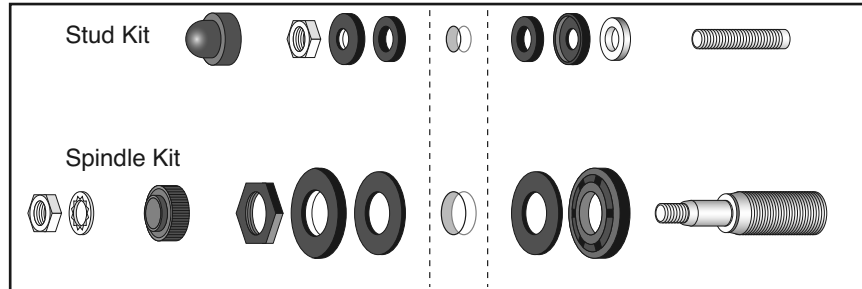

Fig 02

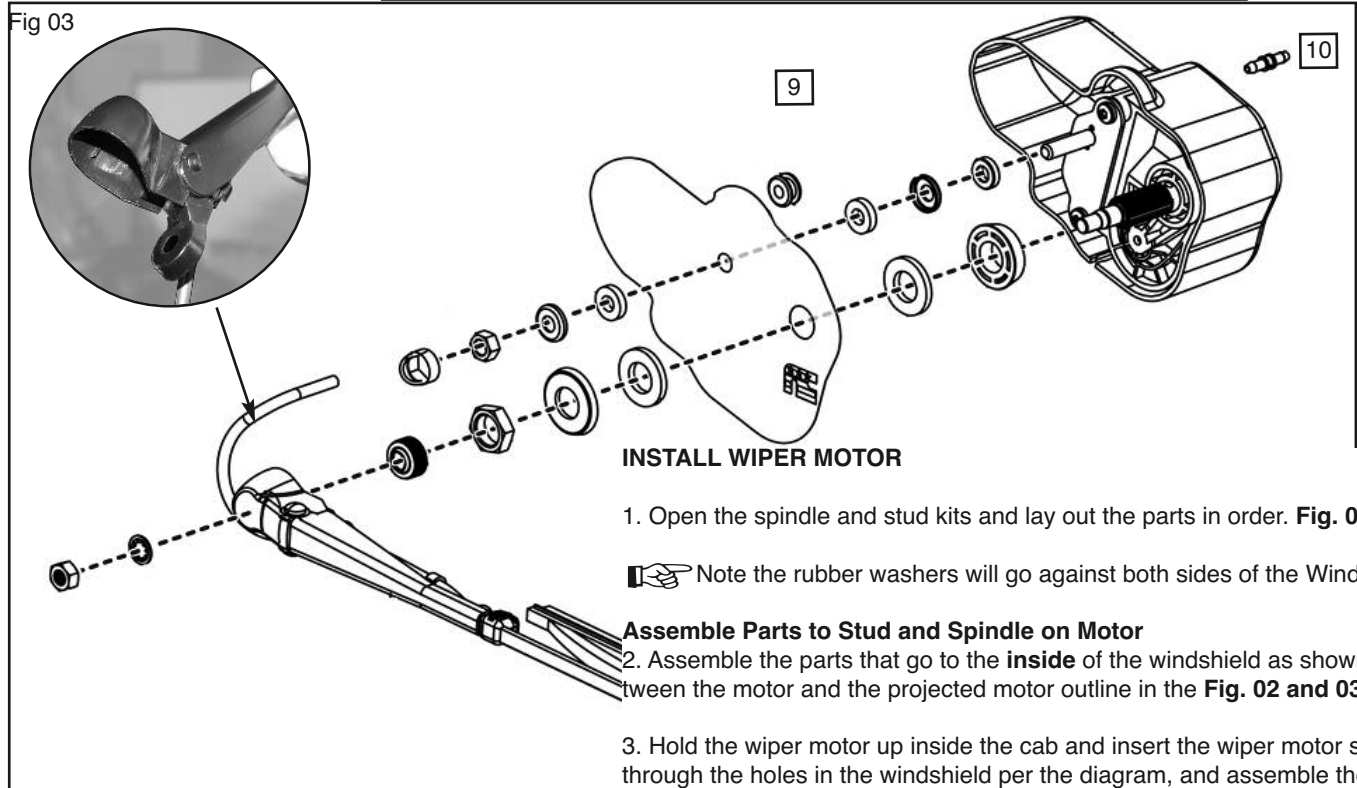

Fig 03

INSTALL WIPER MOTOR

1. Open the spindle and stud kits and lay out the parts in order. **Fig. 02**

Note the rubber washers will go against both sides of the Windshield.

Assemble Parts to Stud and Spindle on Motor

2. Assemble the parts that go to the **inside** of the windshield as shown between the motor and the projected motor outline in the **Fig. 02 and 03**

3. Hold the wiper motor up inside the cab and insert the wiper motor shafts through the holes in the windshield per the diagram, and assemble the remaining kit hardware located outside of the Windshield. **Fig. 02 and 03**

4. The nut on the spindle (larger) shaft needs to be torqued to 4.5 ft-lbs [6 N-m]. **(Torque Wrench)**

5. The nut on the stud (smaller) shaft needs to be torqued to 3 ft-lbs [4 N-m]. **(Torque Wrench)**

WIPER ARM

6. Assemble the wiper arm (so that it is horizontal on the driver's side), then install its lock washer and nut. **Hold the Wiper Arm still while tightening the nut.** Torque to 16 ft-lbs [22 N-m]. **Fig. 04 (Torque Wrench)**

7. Close the cover over the nut.



Fig 04

INSTALL GASKETS TO WINDSHIELD

 Gasket(s) are applied to the outside surface of the Windshield.

 Finished installation view, Fig.04. Proceed with installation instructions below.

1. Start at the spindle and measure a point 13.25" (33.65cm) to the left and right. Mark these points with tape.

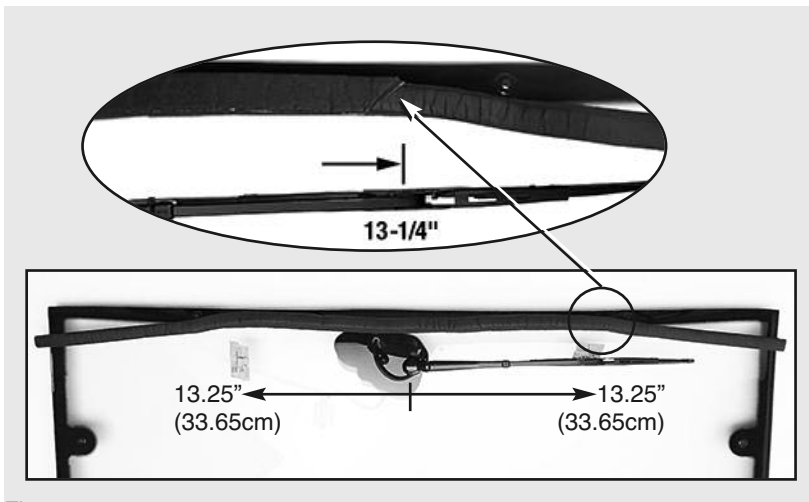

Fig 05



Fig 06



Fig 07

Apple Long Gasket (22)

2. Measure 2" (5cm) down from top edge. This is where you will start the gasket. **Fig.06**

3. Peel back the premask from one end of the long gasket (22). Install gasket from the 2" mark to the 13.25" mark stopping at the center of the gradient. **Fig.06 and 07**

4. Continue installation following the center of gradient to the 13.25" mark and ending at the 2" mark on the opposite side. **Fig.07**

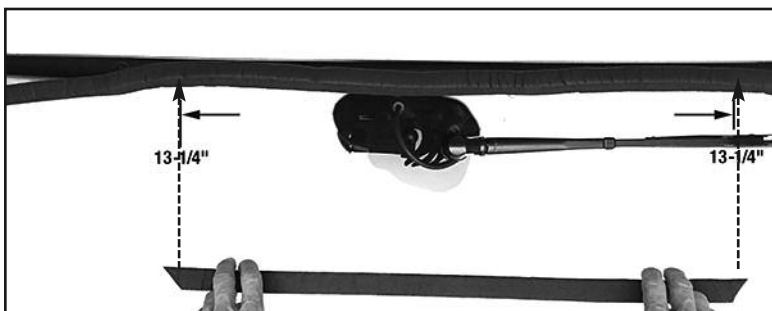

Fig 08

5. Remove the premask from the short Gasket (23). Install the short Gasket (23) on the top of the long Gasket (22) between the 13.25" marks. **Fig.08**

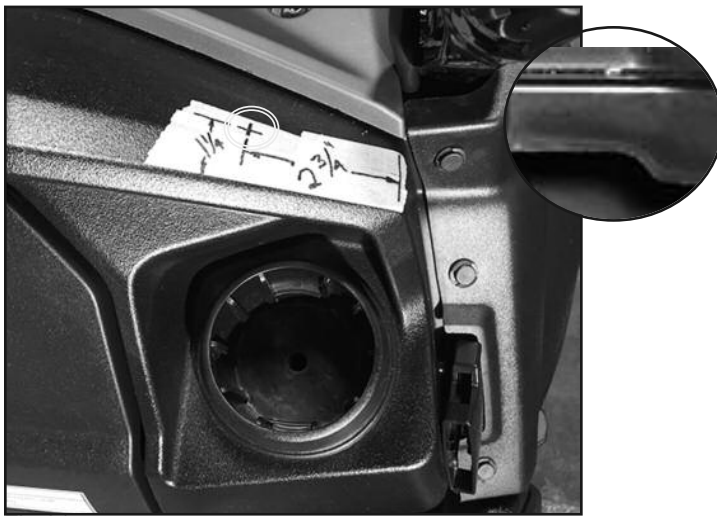

Fig 01

PREPARE THE VEHICLE FOR WIRING DRILL THE PASSWAY 3/4" HOLE

1. Near the front, right side, frame post, measure a point 2.75" (69.8mm) from the right edge and 1.25" (31.7mm) forward of the dash. Mark that location (as indicated with the circle in Fig.01), for center of the drill hole.

Fig.01 (Tape and Marker)

2. Insert a step drill bit into your drill as shown (or 3/4 hole saw) and drill a 3/4" (19mm) hole in the body cover at the location.

Fig.01 (Power Drill and 3/4" (19mm) Hole Saw)

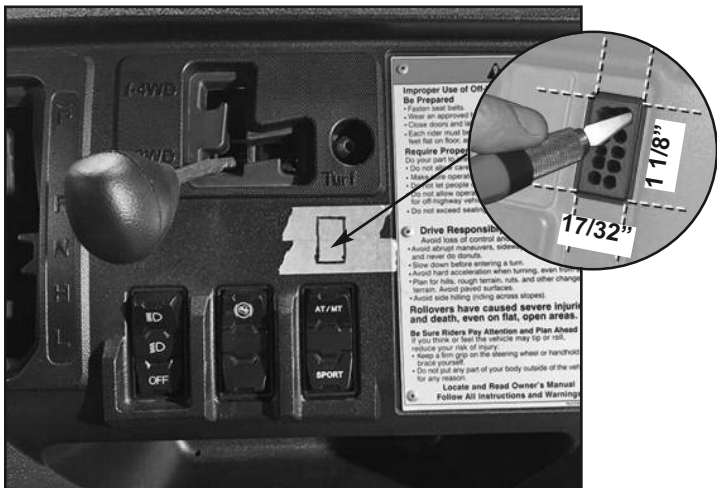

Fig 02

CUT THE PUMP SWITCH HOLE

The installation of the Pump Switch on this vehicle is to the right of the gear shift lever as indicated in Fig.02.

⚠ Use care when cutting hole, avoid over cutting.

3. Scribe or draw a 17/32" x 1 1/8" (13.5mm x 28.5mm) guide in this location. **Fig.02 (Scribe or Marker)**

4. Using a drill, drill some holes in the plastic cover to serve as starting holes for cutting. Then use your X-Acto® knife to cut out the cover's face to the edges, do not over cut. **Fig.02 (Drill, 3mm Drill Bit, Knife)**



Fig 03

INSTALL FLUID RESERVOIR BRACKET TO RESERVOIR

5. Use Screw (12), Washer (13) and Nut (14) to Mount the Bracket (5) to Fluid Reservoir (4) at 2 places. **Fig.03 (Flat Blade Screw Driver, Box Wrench)**

PREPARE THE VEHICLE FOR WIRING RESERVOIR/PUMP ASSEMBLY

6. Move to under the hood. The installation of the Reservoir on this vehicle is in the accessory compartment under the front hood. Locate this area. **Fig.04**

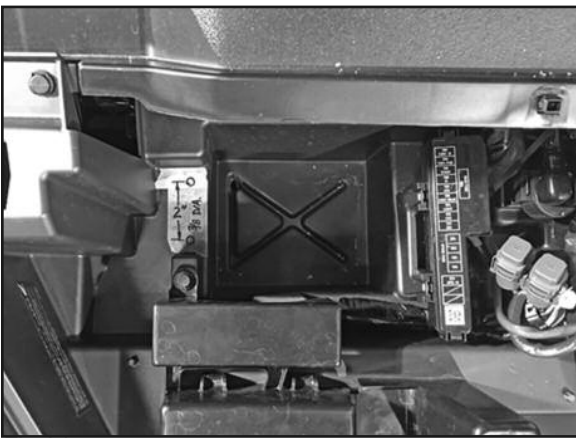

Fig 04

7. Place the Reservoir Assembly into the vehicle as shown. Scribe or mark the center of the drill hole locators. Remove Reservoir Assembly. **Fig.05**



Fig 05

8. Drill a 3/8" hole at marked locations. **Fig.06 (Drill with 3/8" drill bit)**



Fig 06

WIRE HARNESS INSTALLATION MOTOR CONNECTOR AND FLUID HOSE

9. Locate the Motor Connector and Fluid Hose section (d) of the Wire Harness. Tape ends together. **Fig.07**

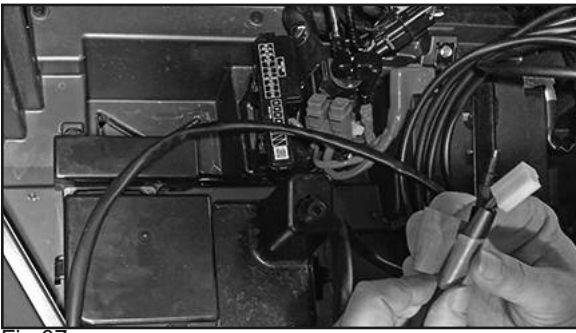



Fig 07

10. Route terminus of Motor Connector (d) up to the hole drilled in the right side of vehicle. **Fig.08**

 **Follow the Frame Tube pulling enough length through the 3/4" (19mm) hole so terminus of Motor Connector (d) reaches 4-5" (10-12cm) past the half way point of the upper frame tube. This is where the Wash'N'Wipe Motor will be located.**

11. Use the 5/8" Rubber Grommet (e) attached to the wire harness to plug the hole. **Fig.08, inset**



Fig 08

ROCKER SWITCH TO DASH

12. Locate the section of Wire Harness (c) that terminates in the Pump Switch. Temporarily remove the Pump Switch. Tape ends together, and thread the wiring toward the hole you cut in the dash. **Fig 09**

13. Thread the Wire End (c) through the hole. Reattach the Pump Switch to the two Nylon Pin Connectors (polarity doesn't matter) and then push the Pump Switch into the cutout. **Fig.09**

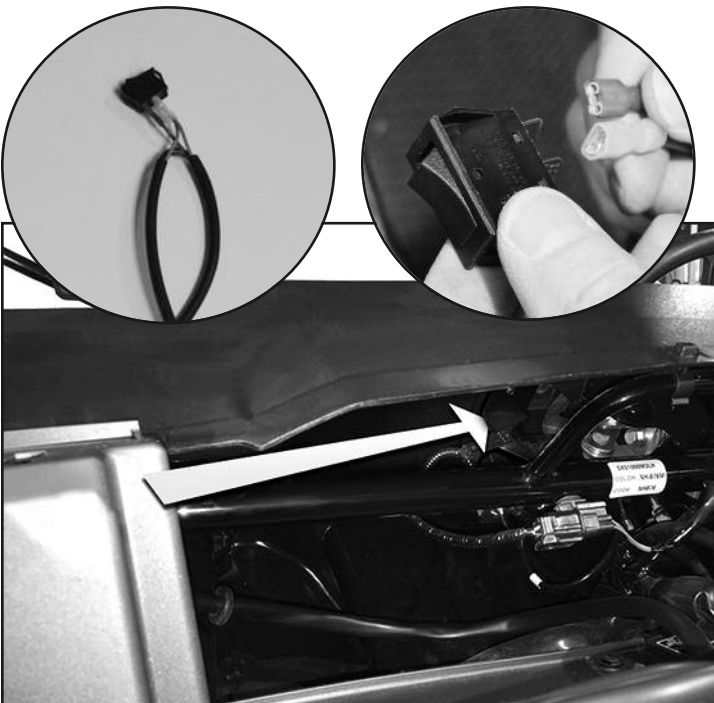

Fig 09

STORE EXCESS WIRE HARNESS

14. Inside the front compartment, coil the excess wire harness leaving loose enough length of the Battery Terminus (a) and Pump (b). **Fig.10**



Fig 10

PUMP CONNECTOR AND FLUID HOSE TERMINUS

15. Take Pump Connector and Fluid Hose section (b) of the Wire Harness and locate the terminus of the Rubber Hose and the Large Nylon 2-Pin Electrical Connector with red and black wires.

16. Fold the Pump Connector section against the Rubber Hose section, as shown. Secure the two sheaths with a Zip-Tie (11) and trim the excess tie. **Fig.11 (Wire Cutters)**

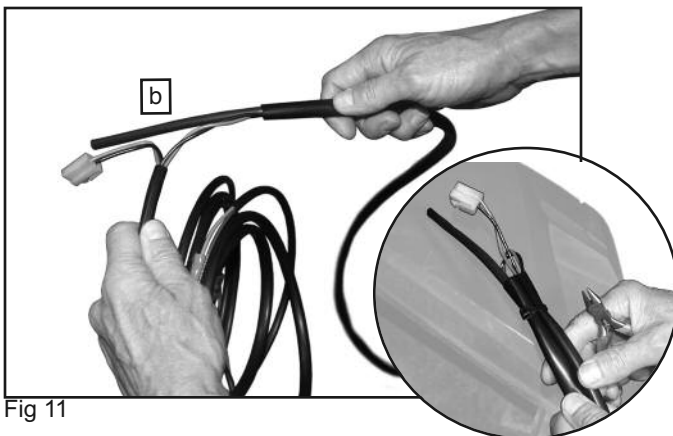

Fig 11

17. Connect the Rubber Hose to the bottom of the Reservoir's Electrical Pump.

Fig.12

18. Push the Nylon Quick-Connector onto the two pins on top of the Reservoir's Electrical Pump.

Fig.12

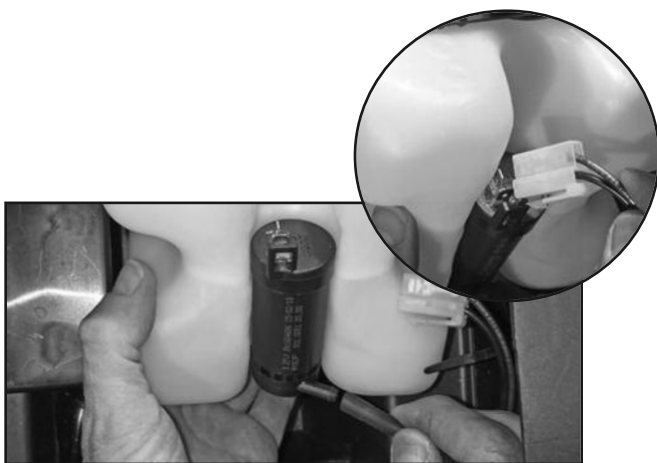

Fig 12

19. Install the Reservoir/Bracket assembly into the vehicle with the Wellnuts (15) and Screws (16) **Fig.13 (Phillips Screw Driver)**

 Insert wellnuts through holes in reservoir brackets and accessory compartment before inserting screws.



Fig 13

**WIRE HARNESS ROUTING
BATTERY TERMINUS**

20. Loosen the negative terminal nut of the vehicle's battery, with an Adjustable wrench. Slip the Brass Open Ring Connector under the negative terminal nut and tighten securely. Repeat for the positive terminal.

Fig.14 (Adjustable Wrench)

21. Secure Wire Harness to Hose with a Zip Tie. **Fig.14**

22. Check that the Wire Harness is coiled and secured.

SECURE TERMINUS d TO TOP FRAME TUBE

23. Use the parts shown in Illustration A to support Wire Harness to Top Frame Tube. Do not fully tighten.

**(Phillips Screwdriver or Power Drill on low setting)
Illustration A, Fig.15**

WINDSHIELD INSTALLATION

24. Place Windshield on vehicle with bottom gasket on hood of vehicle. **Fig.16**

25. Use the Hardware Assembly provide with the Windshield to install shield to vehicle. While installing the windshield Clamps tuck Wire Harness between Clamp and Windshield. **Illustration A**

Place Spacing Washer between Grommets and Clamps **Illustration A**

Start Machine Screws but do not tighten

26. Secure terminus d, end of Wire Harness to Loop Clamp. **Fig.16**

27. Check that the Windshield is centered from the front of the vehicle and the bottom gasket fits snugly.

28. Tighten Machine Screws in Clamps.



Fig 14

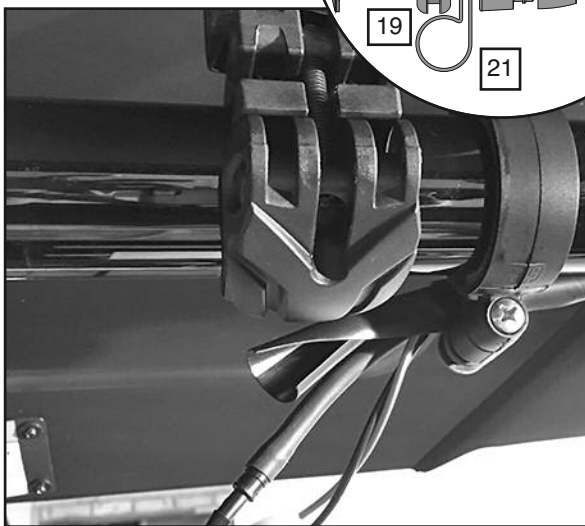
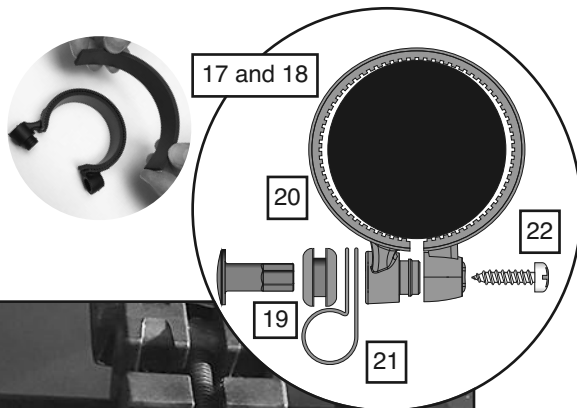

Fig 15



Fig 16

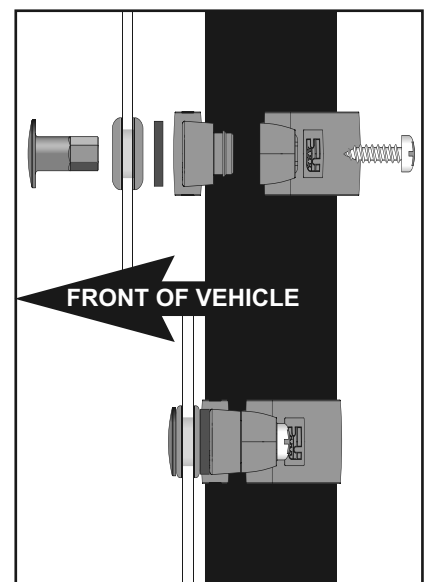



Illustration A

FINALIZE CONNECTIONS TO WIPER

29. Check that the Wiper Arm Fluid Hose is threaded through the Grommet in windshield. If it is not, do this now. **Fig.17**

30. Connect the Wiper Motor Power and Fluid Hose. **Fig.17**

 A little moisture on the Fluid Hose end will make them join easier.

31. Tuck Motor Connector behind Motor assembly.

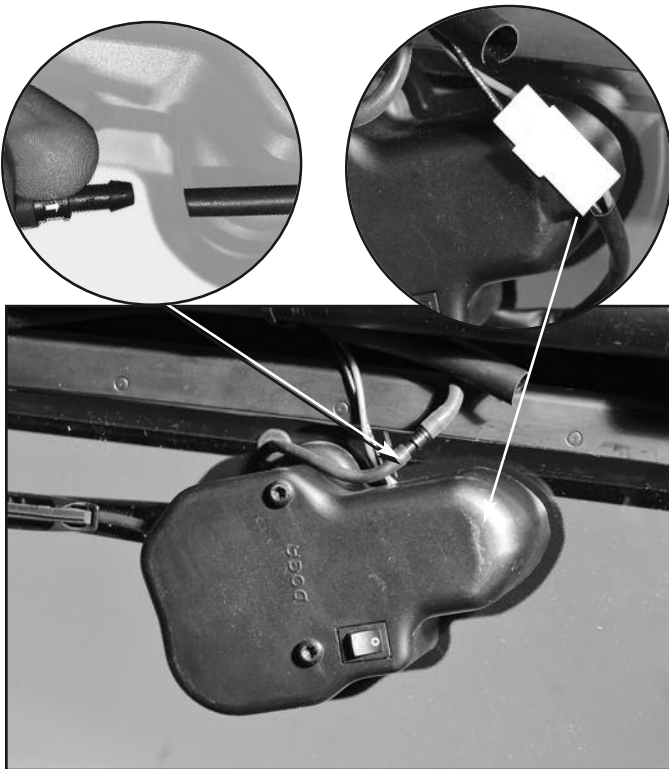

Fig 17

FILL THE FLUID RESERVOIR

32. Fill the Reservoir (9) inside the vehicle's cab with plain water during warm weather and glycol-based automotive windshield washer fluid in freezing weather.

33. **DO NOT** run the pump dry. Minimum amount of fluid to maintain in the Reservoir is:

12 oz. (.35L) or to a depth of 1 1/2" (38mm)



Minimum depth of 1 1/2" -----

Enjoy Your New Wash'n'Wipe™ Windshield!

WINDSHIELD WIPER OPERATION



The Wiper is intended for use with the wash cycle or during rain. DO NOT Wipe a dry windshield.

DO NOT run the Pump without fluid.

The Wiper Motor has a on/off Rocker Switch as shown. Turn the switch on and verify that the Wiper works as expected.

The dash panel Pump Switch installed controls the fluid spray. Momentarily hold the Switch in the on position to spray water from the Wiper Arm. It should spray in four separate directions.

WIPER ARM AND BLADE

Your Wash'n'Wipe Windshield is equipped with a quality silicone Wiper Blade. Replacement Wiper Blades are available from your local dealer.

REPLACING THE WIPER BLADE AND ARM

Join the end of the Wiper Arm (6) to the Wiper Blade (7). Place the J-hook of the Arm over the Blade's plastic mounting clip until it clicks and locks into place.

Fig.18

Swivel up the mount cover of the Wiper Arm as shown and then mount the Wiper Arm over the Motor's Spindle.

Fig.19

Once the Wiper Arm is on the Spindle, install the Internal Tooth Lock Washer and Small Mounting Nut. Use a torque wrench to tighten the Small Mounting Nut to 16 foot-pounds (22Nm). Then swivel the mount cover of the Wiper Arm back to its closed position.

Fig.20 (Torque Wrench)

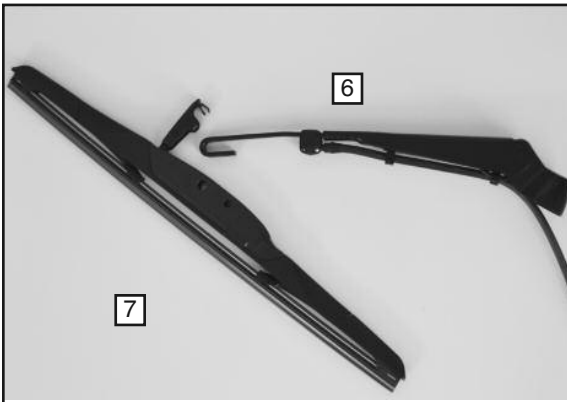

Fig 18



Fig 19



Fig 20



CLEANING AND MAINTENANCE

To clean the screen, wash with a clean soft cloth, plenty of warm water and if necessary, a non-abrasive soap such as dishwashing liquid. Flannel or soft chamois make good cleaning cloths. **Paint, glue residue or grease removal:** Moisten cotton with naphtha or turpentine followed by a wash as above.

National Cycle **Shield Wash™** (N1401-01) makes a good daily cleaner and comes with a handy travel size bottle. Shield Wash is safe for all windshields and helmet visors.

Do not clean polycarbonate in hot sun or high temperatures. Do not clean the screen with glass cleaners.

Do not allow brake fluid, alcohol, or strong solvents to contact the screen.

RAIN REPELLENT

Do not use rain protective products made for glass. We recommend National Cycle's **RainZip®** (N1410-01) to help shed water in rainy weather.

WARNING

Never operate your vehicle with loose accessory mounting hardware. Check the hardware for tightness regularly.

UTVs are built with enough frame rigidity to withstand the moderate loads imposed on them by the foreseeable addition of an accessory(ies). If an accessory(ies) adversely affects your vehicle's stability, immediately remove the accessory(ies). Do not operate a vehicle that exhibits unsafe handling traits.

Have experienced service personnel correct any problem before driving with the accessory(ies) installed. For further questions concerning handling problems associated with an accessory(ies), contact your dealer, UTV manufacturer, or accessory manufacturer.

CAUTION: Do not clean polycarbonate in hot sun or high temperatures. Do not clean the screen with glass cleaners. Certain chemicals, generally known as acidic hydrocarbons, are known to cause polycarbonate damage. Do not allow brake fluid, alcohol, or strong solvents to contact the screen.

CAUTION: Do not use rain protective products made for glass. We recommend National Cycle's **RainZip®** (N1410-01) to help shed water in rainy weather.

CAUTION: Always face windshield forward (in direction of travel) while carrying on truck or trailer.