



**Installation and Owner's Manual  
N2710, N2711 Gladiator Windshield,  
Two-Piece Handlebar Mount  
for Harley-Davidson Motorcycles**

Thank you for purchasing a National Cycle® product. Please read these instructions carefully and thoroughly before beginning work. Dealers if installing this windshield for a customer please give them this manual. It contains information needed to properly maintain and use this product.

**Attention**



Special notes and cautionary measures which can prevent damage to the accessory or motorcycle.

**Note**



Tips for facilitation of operation, control and adjustment, as well as maintenance.

Parts List				Notes
Item	Part Number	Description	Qty.	
1	N2710	Chrome, Light Tint	1	One Gladiator Windshield Assembly
1	N2711	Chrome, Dark Tint	1	
	Bag #1028			
2	49-495316-000	Bushing .551 L	4	
3	51-511314-000	Screw, 5/16-18 x 1.75	4	T40 Torx Wrench

**TOOLS REQUIRED**

- 1/4" Allen Key
- T40 Torx Wrench
- 7/16" Box Wrench



**MAINTENANCE:** Wash with a clean soft cloth, plenty of warm water and, if necessary, a non-abrasive soap such as dishwashing liquid. Flannel or soft chamois make good cleaning cloths. Do not allow brake fluid, alcohol, or strong solvents to contact the screen.

National Cycle Windshield Wash Part number N1401 is a good everyday cleaner.

**PREPARATION**

1. Position the motorcycle securely on its stand.

Cover the front fender and fuel tank with a cloth to avoid scratches.



Go to **INSTALLATION, PAGE 2**

**WARNING**

Never ride your motorcycle with loose accessory mounting hardware. Check the hardware for tightness regularly.

Today's motorcycles are built with enough frame rigidity to withstand the moderate loads imposed on them by the foreseeable addition of an accessory(ies). If an accessory(ies) adversely affects your motorcycle's stability, immediately remove the accessory(ies). Do not ride a motorcycle that exhibits unsafe handling traits.

Have experienced service personnel correct any problem before riding with the accessory(ies) installed. For further questions concerning handling problems associated with an accessory(ies), contact your dealer, motorcycle manufacturer, or accessory manufacturer.



**National Cycle 3-Year Limited Warranty**

National Cycle hereby warrants to the original registered owner of a National Cycle polycarbonate windshield for a period of three years from the date of purchase against breakage. This limited warranty is expressly limited to the replacement of the polycarbonate windscreen. This limited warranty does not include scratches, coating failure, cosmetic wear and tear, replacement of hardware, or any consequential damages or expenses including labor cost of

installation, removal and/or replacement, inconvenience, inbound freight expenses or damage to any other component of the motorcycle or any other accessories. Certain chemicals, generally known as acidic hydrocarbons, are known to cause polycarbonate damage and will not be covered under this limited warranty. Please refer to the cleaning instructions supplied with all National Cycle windshields.

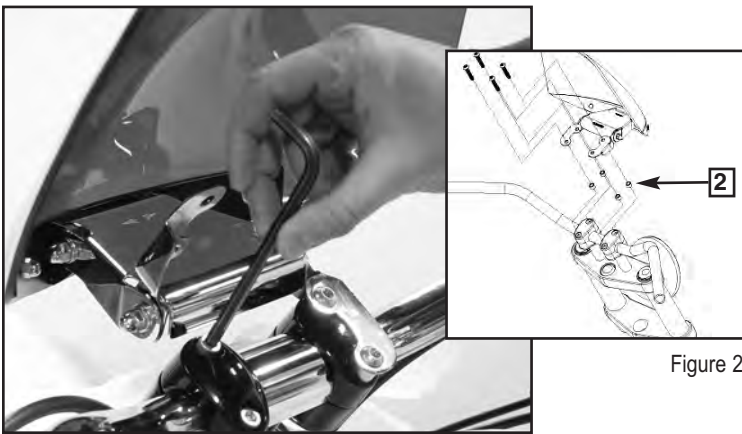

Figure 1



Figure 3

## INSTALLATION



To keep the handlebars in adjustment during installation, install one side at a time.

1. Remove the stock bolts that hold the top clamp from one side. **(1/4" Allen Wrench) Figure 1**
2. Place one bushing in each hole. **Figure 2 and 3**
3. Install the Gladiator Clamp with supplied screws. **(T40 Torx Wrench) Figure 4**
4. Repeat on opposite side.
5. Tighten the four screws holding top clamps securely (17 ft-lb or 23 Nm). **(T40 Torx Wrench) Figure 5**
6. Adjust shield to desired position. Tighten Cap Nuts securely (72 in-lb or 8 Nm). **(7/16" Box Wrench) Figure 6**



Figure 4



Figure 5

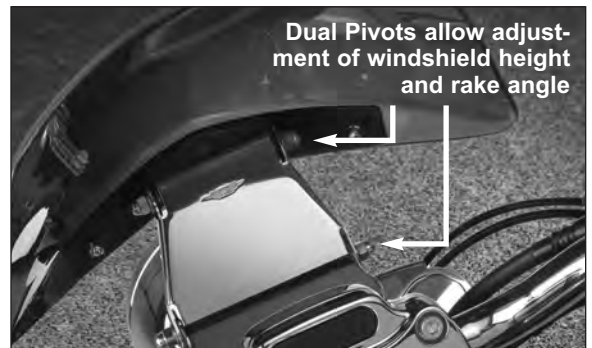
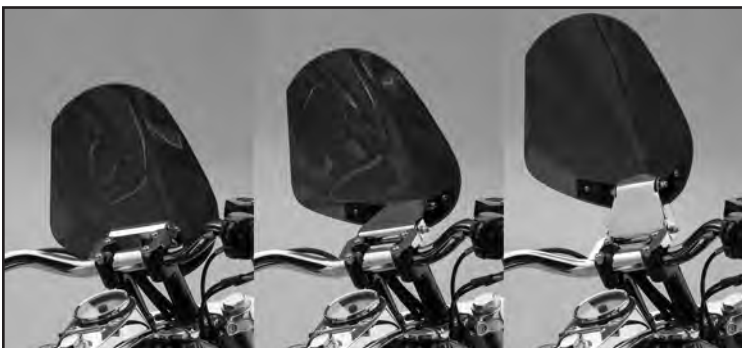

Figure 6