



Quantum® Hardcoated Polycarbonate  
 VStream® Windscreen for:  
 Kawasaki Z900  
 N20130, Low Dark Tint  
 N20131, Mid Light Tint  
 N20132, Tall Clear



Thank you for purchasing a National Cycle product. Read these instructions carefully and thoroughly before beginning work. Dealers, if installing this windscreen for a customer, please give them this manual upon completion. It contains information needed to properly maintain and use this product.



**Attention:**

Special notes and cautionary measures which can prevent damage to the accessory or motorcycle.



**Note:**

Tips for facilitation of operation, control and adjustment, as well as maintenance work.

**CONTENTS OF KIT**

Item	Description	Part No.	Qty.
(1)	VStream® Windscreen		1
BAG#1319			
(2)	Bushing Tophat	49-495290-000	4
(3)	Bushing Black	49-495287-000	4
(4)	Grommet	44-447350-000	4
(5)	Cap, Trim, Black	34-346048-000	4
(6)	Screw, SS, M5 x 45	51-514142-000	4

**TOOLS REQUIRED**

- 3mm Hex Wrench
- Clear Tape (scotch tape)
- Pointed Tool (to puncture hole in tape)
- Masking or Painters Tape

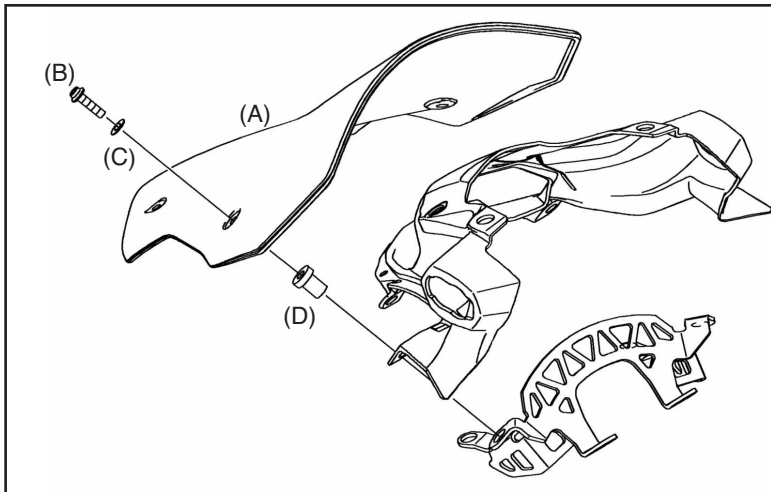
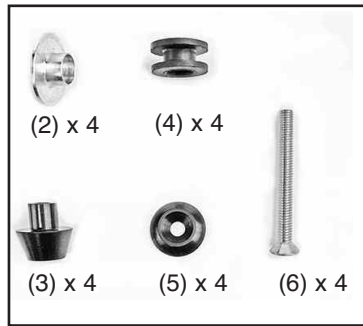
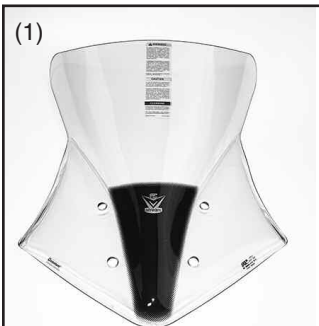

Illustration a.

**PREPARATION**

1. Position motorcycle securely on its stand.
2. Remove the OEM Cowl (A) by removing:  
**(3mm Hex Wrench) Illustration a.**  
 Screw (B)  
 Washer (C)  
 Nut (D)



Washer (D) and Screw (B) will **not** be used in the final installation.

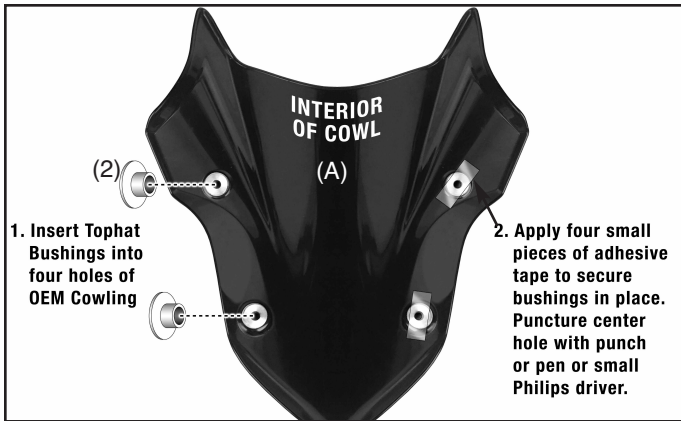

Figure 1

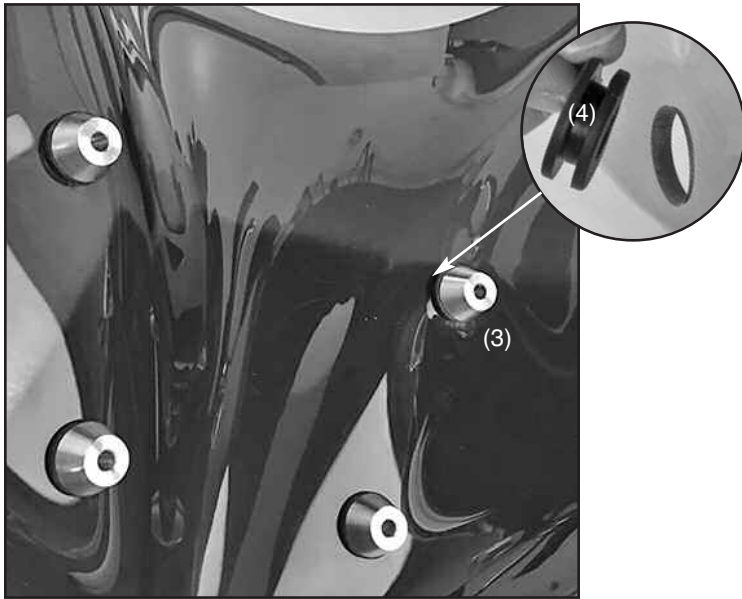

Figure 2 (Bushings in Kit are Black)



Figure 3

Use OEM screw (B) to align holes

## INSTALLATION

1. To the **interior** of the OEM cowl (A), insert a Bushing (2) into each hole. **Figure 1**

2. Apply a small amount of tape over Bushing. Puncture a hole into tape. (**Tape and Sharp Tool**) **Figure 1**

### Prepare VStream Windshield for Installation

3. Insert a Grommet (4) into each hole of VStream Windshield. **Figure 2**

4. To the **inside** of the Windshield insert four Bushings (3). **Figure 2**

5. Make four screw assemblies using one each: Trim Cap (5) M5 Screw (6) **Figure 4**

### Position Cowl (A) to Motorcycle

6. Position OEM cowl (A) onto motorcycle. Insert black washer (C) into holes. Use the OEM screw (B) to align the cowl. Hold cowl in place with Painters Tape while the VStream Windshield is installed over top of cowl. (Masking Tape) **Figure 3**

### Install VStream Windshield to Cowl

7. Using the four screw assemblies, install the VStream Windshield onto motorcycle over top of cowl. (**3mm Hex Wrench**) **Figure 4**

Tighten screws firmly. **Do not overtighten. Do not use threadlocker.**

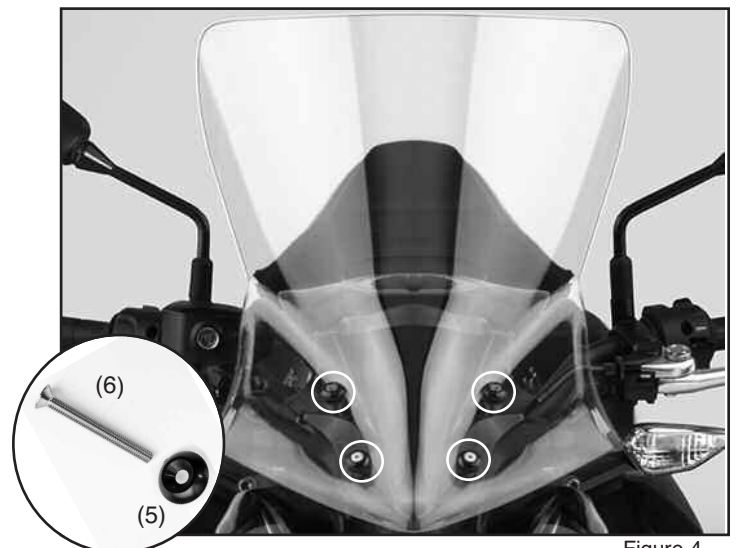

Figure 4



## CLEANING AND MAINTENANCE

To clean the screen, wash with a clean soft cloth and plenty of warm water and, if necessary, a non-abrasive soap such as dishwashing liquid. Flannel or soft chambray make good cleaning cloths. **Paint, glue residue or grease removal:** Moisten cotton wad with naphtha or turpentine followed by a wash as above.

National Cycle **Shield Wash™** (N1401-01) makes a good daily cleaner and comes with a handy travel-size bottle. Shield Wash is safe for all windshields and helmet visors.

Do not clean polycarbonate in hot sun or high temperatures. Do not clean the screen with household glass cleaners.

Do not allow brake fluid, alcohol, or strong solvents to contact the screen.

## RAIN REPELLENT

Do not use rain protective products made for glass. We recommend National Cycle's **RainZip®** (N1410-01) to keep your windscreen clear in rainy weather.

*VStream® Windscreen Patent no. 7,387,328*

## WARNING

Never ride your motorcycle with loose accessory mounting hardware. Check the hardware for tightness regularly.

Today's motorcycles are built with enough frame rigidity to withstand the moderate loads imposed on them by the foreseeable addition of an accessory(ies). If an accessory(ies) adversely affects your motorcycle's stability, immediately remove the accessory(ies). Do not ride a motorcycle that exhibits unsafe handling traits.

Have experienced service personnel correct any problem before riding with the accessory(ies) installed. For further questions concerning handling problems associated with an accessory(ies), contact your dealer, motorcycle manufacturer, or accessory manufacturer.

**Sunlight reflected off the inside curvature of the windscreen can, at certain times of the day, cause extreme heat buildup on the motorcycle's instruments and possibly even melt them. Exercise care in parking to avoid this. Park your motorcycle facing the sun, or place an opaque object over the instruments and dash panel.**