

**QuickSet 4<sup>TM</sup> Mount Kit Q301 and Q302 for installation with SwitchBlade Windshields: 2-UP<sup>TM</sup> Shorty<sup>TM</sup> or Deflector<sup>TM</sup>**

**Dealers:** If installing the QuickSet 4 mount kit for a customer please give them this manual. It contains information needed to properly maintain and use this product.

**The QuickSet 4<sup>TM</sup> mount kit** will allow you to mount any of the three styles of SwitchBlade windshields to the motorcycle this kit is installed on. Contact your dealer or National Cycle for complete information for all three SwitchBlade Windshields: 2-Up<sup>TM</sup>, Shorty<sup>TM</sup>, and Deflector<sup>TM</sup> *All Patents Pending*

**Attention**



Special notes and cautionary measures which can prevent damage to the accessory or motorcycle.

**Note:**



Tips for facilitation of operation, control and adjustment, as well as maintenance work.

**Parts List Q301 For VN1600A**

INDEX	PART NO.	DESCRIPTION	QTY.
1	37-372240-000	Bracket Assembly* Left, VN1600A	1
2	37-372241-000	Bracket Assembly* Right VN1600A	1

\*The lower spools are pre-assembled to the bracket and properly tightened.

**BAG 562**

3	34-340503-000	Roller Cap Bushing, 8mm Polished	2
4	34-340510-000	Spool, Upper, QS4, Assembled	2

**BAG 563**

5	51-516415-000	Screw, Button HS, M8-1.25 x 16	2
6	51-514342-000	Screw, Flat HS M8 x 40	2
7	49-495734-000	Bushing, .625 O x 22 L	2

**Parts List Q302 For VN2000**

INDEX	PART NO.	DESCRIPTION	QTY.
8	37-372242-000	Bracket Assembly* Left, VN2000	1
9	37-372243-000	Bracket Assembly* Right VN2000	1

\*The lower spools are pre-assembled to the bracket and properly tightened.

**BAG 562**

3	34-340503-000	Roller Cap Bushing, 8mm Polished	2
4	34-340510-000	Spool, Upper, QS4, Assembled	2

**BAG 564**

5	51-516415-000	Screw, Button HS, M8-1.25 x 16	2
6	51-514342-000	Screw, Flat HS M8 x 40	2
10	49-495570-000	Bushing, .75 O x .25 L	4

**PREPARATION**

- Proper tightening of this assembly is critical. Use a Torque Wrench!
- Follow this procedure! Correct assembly of this kit will provide years of reliable service.
- Position the motorcycle securely on its stand or a work stand. Cover the front fender and fuel tank with a suitable cloth to avoid scratches from dropped tools.



- 1, Hex Key Wrench, 5mm
- 1, Torque Wrench that accurately measures 15 ft. lbs. pounds.

**Parts photo applies to Q301 and Q302**

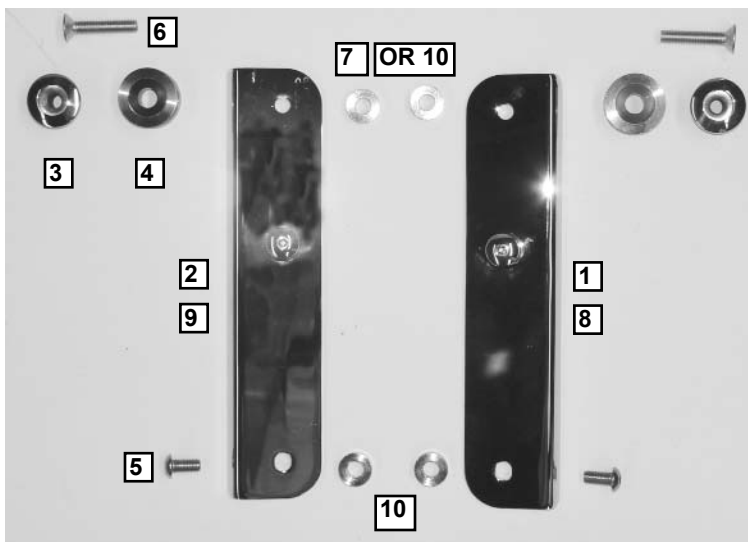
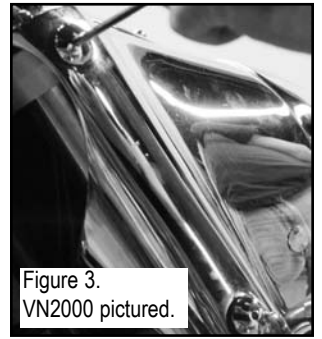
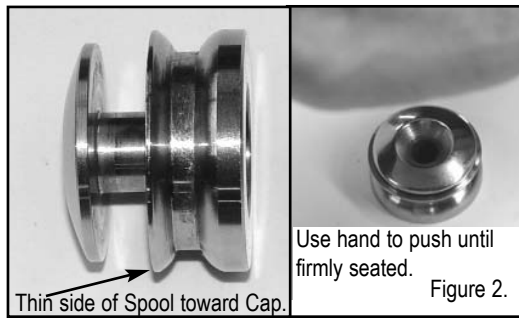

Figure 1.

### INSTALLATION Q301 and Q302

1. Push the Roller Cap Bushing (3) into the large Upper Spool (4) so the thin side of the Spool is near the head of the Roller Cap Bushing. **Figure 2.**

2. Remove the upper and lower, 8mm stock screws from the right side of the fork. (**5mm Hex Key**). **Figure 3.**



#### KIT Q301 to VN1600 only

3. Assemble the Right Side Bracket (2) with bent edge of Bracket toward rear as shown in **figure 4 (5mm Hex Key).**



#### KIT Q302 to VN2000 only

4. Assemble the Right Side Bracket (9) with bent edge of Bracket toward rear as shown in **figure 5 (5mm Hex Key).**

### INSTALLATION Q301 and Q302

5. Repeat steps 1 through 4 on the other fork.

6. Tighten the top and bottom M8 Screws to 15 FT/LBS. (21 Nm) (180 IN/LBS).



**Figure 6 (Torque Wrench).**



The small lower spools are pre-assembled to the bracket and properly tightened using thread lock. **Do not adjust.**

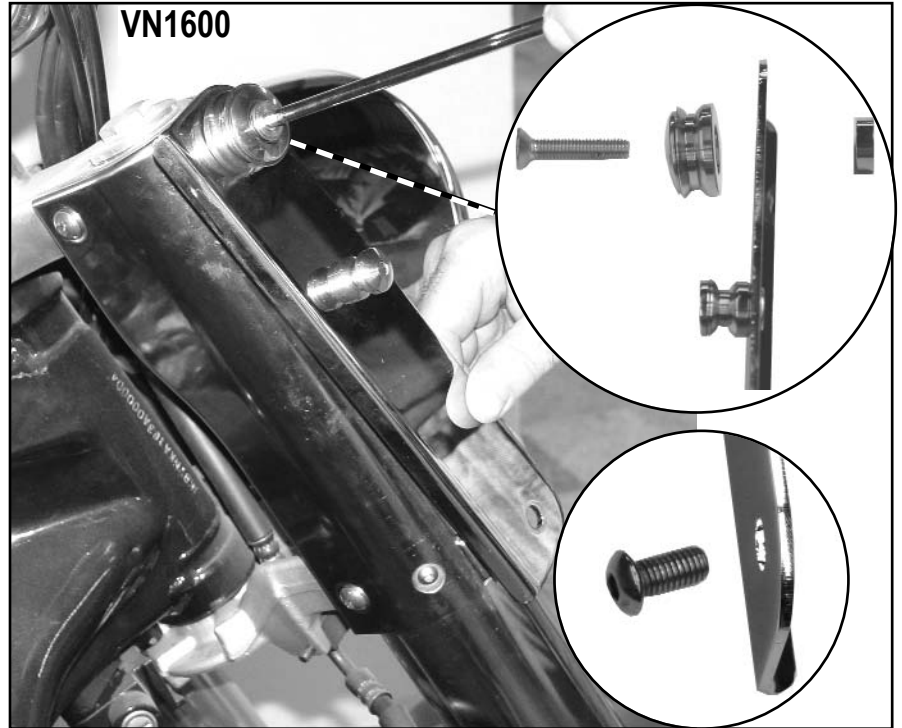

Figure 4

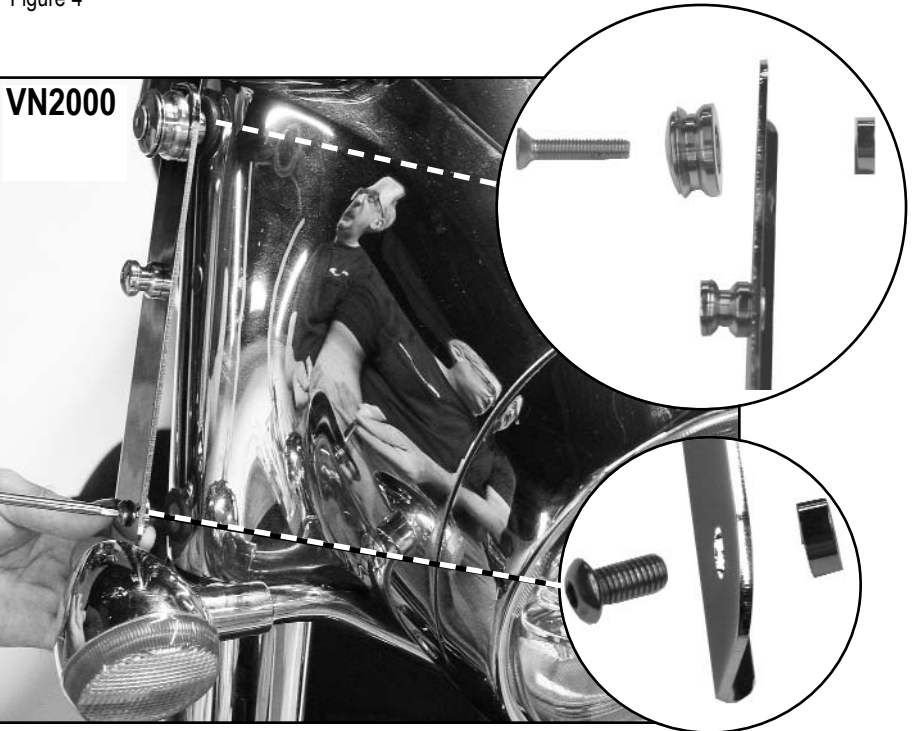

Figure 5

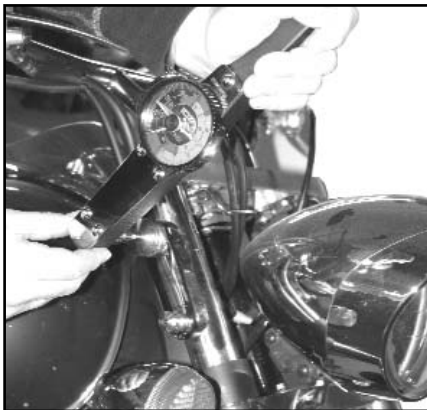

Figure 6