

Letric Lighting Co.

MOTORCYCLE LIGHTING

www.namzccp.com

NAMZ Custom Cycle Products, Inc

1440 Ulmer Avenue
Oreland, PA 19075

Technical Support is available Monday-Friday, 9am-5pm EST via email at tech@namzccp.com or call us at 1-877-277-NAMZ.

Part Number: LLC-DB7-YC



Fitment: DB7-YC Dual 7" Road Glide Headlamp complete with black powder-coated aluminum bracket, stainless steel hardware & 100% plug-n-play wiring harness. The aggressive look captured with (1) clear lens LED (running light) and (1) yellow lens LED (both work on high beam) boasting over 8000 lumens per LED. Simple to install and built to last.

This product is intended: (Off-road use only) This aggressive "Euro" style headlamp assembly comes with everything you need for the installation. Intended to fit all 2015-Up Road Glide models, this headlight is guaranteed to increase rider visibility. The DB7 offers 8000-lumens on the clear low beam and the same on the yellow high beam! Aluminum construction with poly-carbonate lenses, sealed wiring and lens gaskets keep the moisture out. Powder-coated brackets & stainless steel hardware make the install simple and keep the performance look you are after while the plug-n-play wiring harness is designed with service in mind and to fit perfectly. Where the brightest ideas come from!™

What is included in this kit?

- (1) DB7 Duel LED Headlamp
- (1) Pre-installed powder-coated bracket assembly
- (2) Springs
- (2) Ny-lock 1/4" x 20 stainless steel nuts
- (2) 1/4" x 20 x 1.25" stainless steel socket head bolts
- (2) 1/4" ID x .75" long stainless steel spacers
- (1) Complete plug-n-play wiring harness
- (1) Cable tie

Recommended Tools:

- T25 Torx Bit
- T15 Torx Bit
- 1/8" Allen Head Socket
- 3/16" Allen Head Socket

WARNING!

This product should be installed by a professional motorcycle technician or reputable shop/ dealership.

Improper installation may result in loss of Headlamp / Turn signal functions.

1. Remove seat and disconnect the negative battery cable.
2. Remove the four windscreen bolts using 1/8" Allen Head, and set aside.
3. Carefully, remove speaker pod lids and upper fairing bolts, located under speaker pod lids. and lower fairing bolt using T25 Torx.
4. Using the 3/16" Allen Head remove turn signal mounting bolts. Use appropriate precautions here as the outer fairing is not no longer attached to the motorcycle. Disconnect the turn signal connectors, and carefully set the fairing aside in an area it will not be damaged.
5. Remove stock headlamp using 3/16" Allen Head. Two of the bolts are located on the top of the light and two below. **(NOTE: You will reuse (2) of these bolts.)**
6. Disconnect headlamp connector by gently prying the locking tab up and pulling the connectors apart.
7. Install included top mount using the top two OEM mounting holes, both OEM allen bolts and a drop of blue thread lock, **PIC-1**. Be sure the (2) pre-installed allen screws/springs and filler panel are on the top as seen in **PIC-2**.
8. Following your OEM service manual, remove the dash and the fuel tank to access the wiring harness tray. Using a razor knife, carefully cut the tape around the tray in order to remove the tray top. Route the wiring harness through the (left/clutch side, **PIC-3**) fairing mount along the bikes wiring harness, into the tray (**PIC-3A**) and out the bottom onto the battery as seen in **PIC-4**. **(Be sure to secure the wiring away from any moving parts!)**
9. Once the wiring harness is routed securely, use the included cable tie to fasten the relay packs under the right side radio bracket as seen in **PIC-5**. Be sure it is clear of the light when mounted.
10. As seen in **PIC-6**, connect the DB7 headlight connection to the bikes OEM headlight connector.
11. Also connect the (2) 2-position Deutsch connectors, clear being low-beam and both for high-beam. **PIC-7** For reference, yellow wire is low beam (clear lamp) and white wire is high beam (both lamps) in case you remove the labels.
12. Remove the (2) ny-lock nuts off of the top mount while securing the filler panel in place, **PIC-8**. Now slide the DB7 light assembly onto the (2) mounting studs, compressing the adjustment springs while hand tightening the ny-lock nuts back into place, **PIC-9**.
13. Locate the bottom filler panel, (2) 3/4" stainless spacers and (2) stainless 1/4 x 20 x 1.25" bolts that come with our kit. Be sure to use a drop of thread lock on the beginning of each bolt, secure the filler panel behind the light bracket, place the spacers behind the filler panel and install each bolt, **PIC-10** and **PIC-11**.
(continued)

Letric Lighting Co.

MOTORCYCLE LIGHTING

www.namzccp.com

NAMZ Custom Cycle Products, Inc

1440 Ulmer Avenue
Oreland, PA 19075

Technical Support is available Monday-Friday, 9am-5pm EST via email at tech@namzccp.com or call us at 1-877-277-NAMZ.

14. With the filler panel in place and both bottom bolts tightened, remove (1) hand tightened ny-lock nut at a time on the top of the headlight mount and place a drop of blue thread lock on each nut before reinstalling. Tighten the ny-lock nuts at least until the bolt comes through the nylon insert and be sure to get the desired projection of the headlight based on your suspension height, rake or trail. The springs will provide the needed tension and allow for proper adjustment.
15. We suggest removing the metal tab that was installed on top of the OEM headlamp using a pry tool as shown in **PIC-13**. Once removed, simply tuck the wiring on the top left side of your new DB7 light for easy access.

16. Connect the RED power wire to the 12+ positive side of the battery and tighten accordingly. Be sure to route the fuse holder in front of the battery for easy access when needed.
17. Place the black ground onto the battery bolt, reconnect the bikes ground wire and tighten accordingly.
18. NOTE: This light is designed for off-road/racing use only. The clear lamp is intended to be on for low-beam and both lamps will be on for high-beam.
19. Turn the bike on and check functionality.
20. Reinstall outer fairing and turn signals in reverse order, referring to service manual for torque specifications.

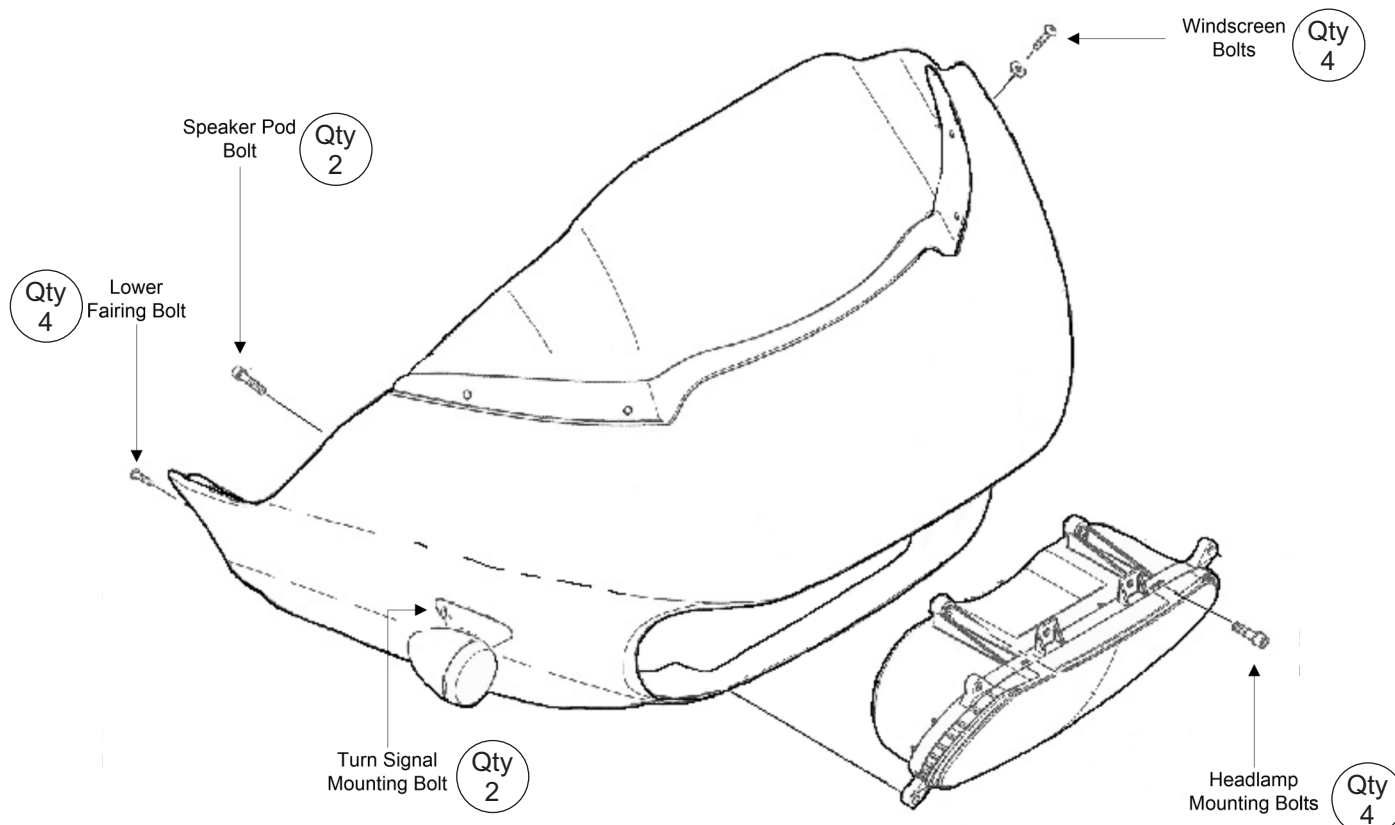

Letric Lighting Co.

MOTORCYCLE LIGHTING

www.namzccp.com

NAMZ Custom Cycle Products, Inc

1440 Ulmer Avenue
Oreland, PA 19075

Technical Support is available Monday-Friday, 9am-5pm EST via email at tech@namzccp.com or call us at 1-877-277-NAMZ.



PIC-3A

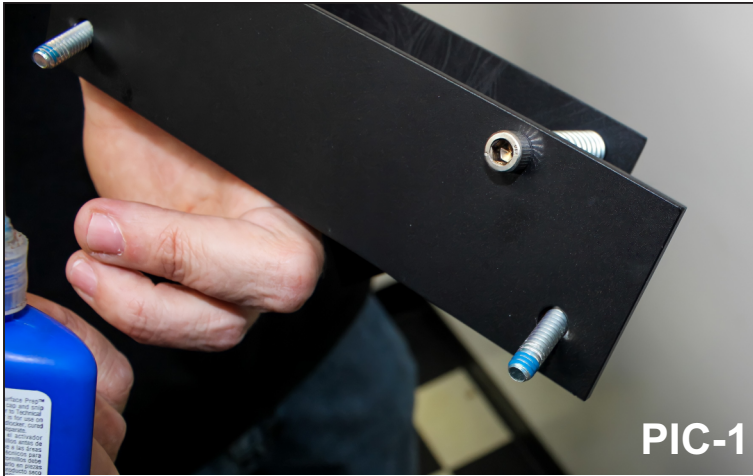

PIC-1



PIC-4

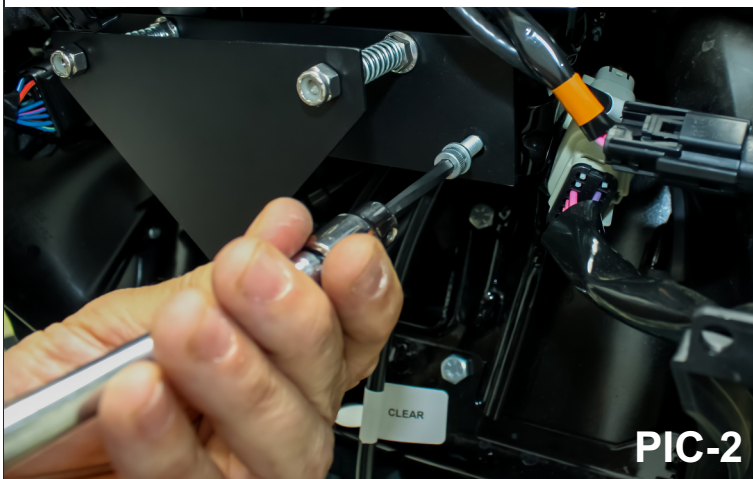

PIC-2

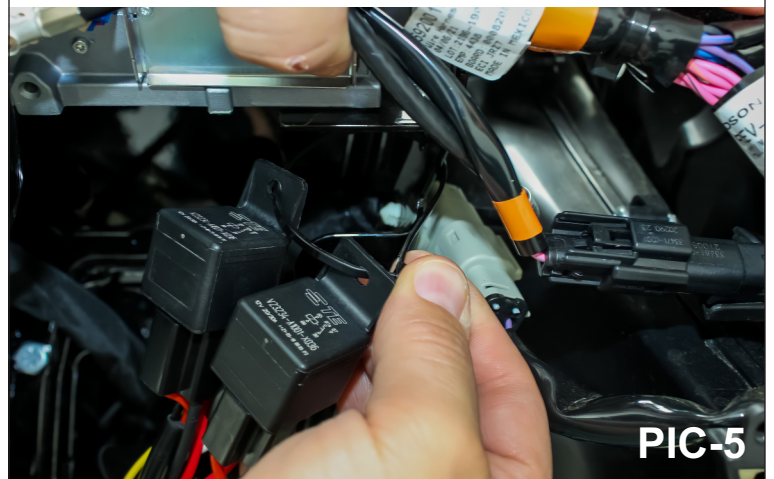

PIC-5

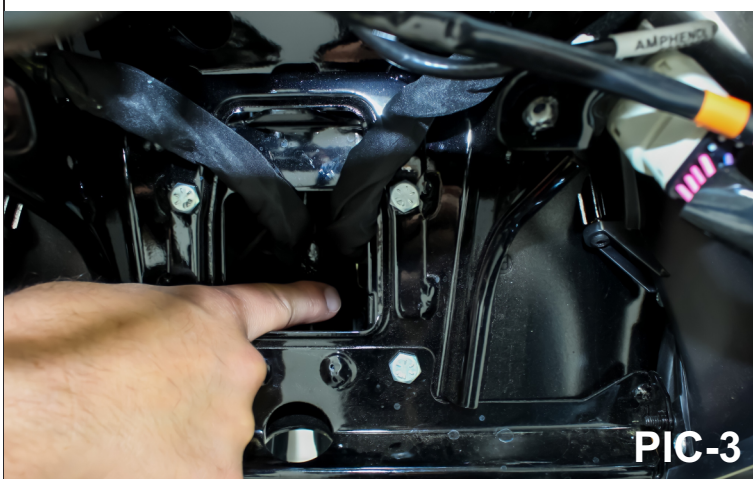

PIC-3



PIC-6

Letric Lighting Co.

MOTORCYCLE LIGHTING

www.namzccp.com

NAMZ Custom Cycle Products, Inc

1440 Ulmer Avenue
Oreland, PA 19075

Technical Support is available Monday-Friday, 9am-5pm EST via email at tech@namzccp.com or call us at 1-877-277-NAMZ.

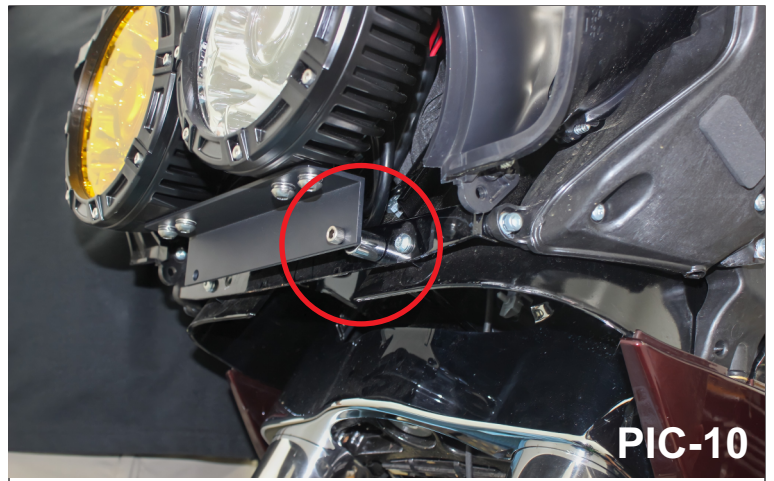

PIC-10

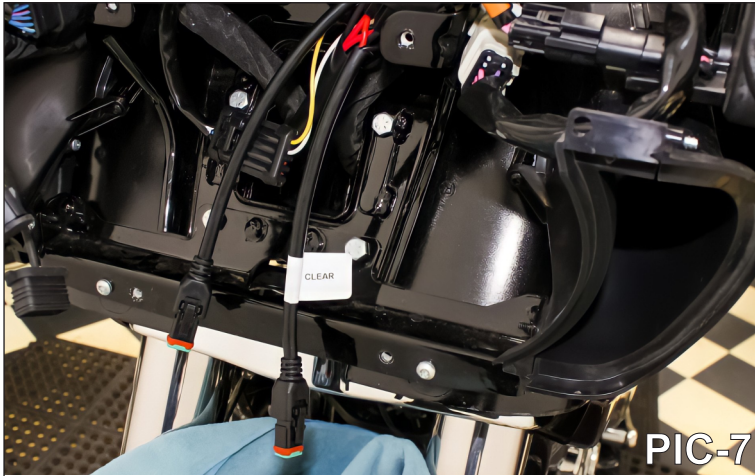

PIC-7



PIC-11

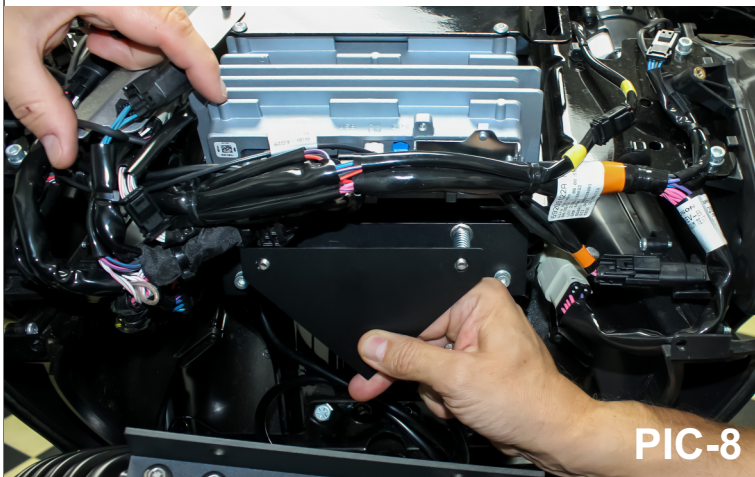

PIC-8

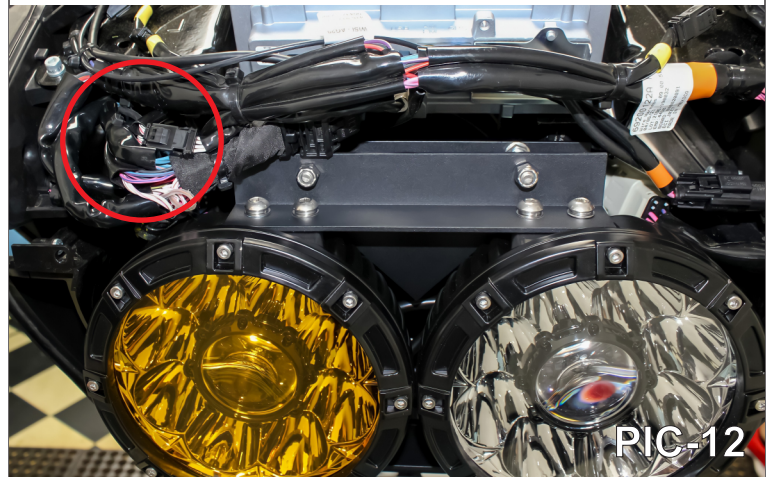

PIC-12

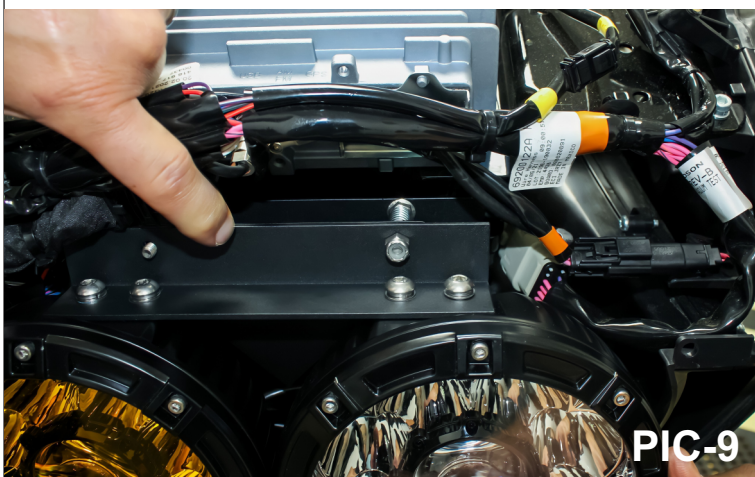

PIC-9



PIC-13