



Mounting Suggestions: Yamaha Bolt 2013-14 Spring Solo Kit

Hardware included: Mustang Front Mounting Bracket, Seat Mounting Bracket and Spring Bracket
(2) Chrome Washers, (2) Fender Washers,
(2) Flat Nylon Washers, (5) 1/4"-20x5/8" Phillips Screws
(2) 6mm Allen Screws, (1) 1/4"-28x2-1/4" Hex Screw,
(1) 1/4"-28 Nylock Nut
See page 5 for diagram

Tools needed: Phillips Screwdriver, 10mm Nut Driver
6mm Allen Wrench, 7/16" Socket, 7/16" Wrench

Optional Pouch



Installation of Spring Solo Kit:



Hook the top of the optional pouch to the back edge of the mounting plate.



Now insert the 1/4"-20 x 1/2" Phillips screw through the hole in the plate and the pouch.



Then put the black nylon washer followed by the acorn nut onto the screw and tighten with a 7/16" socket.

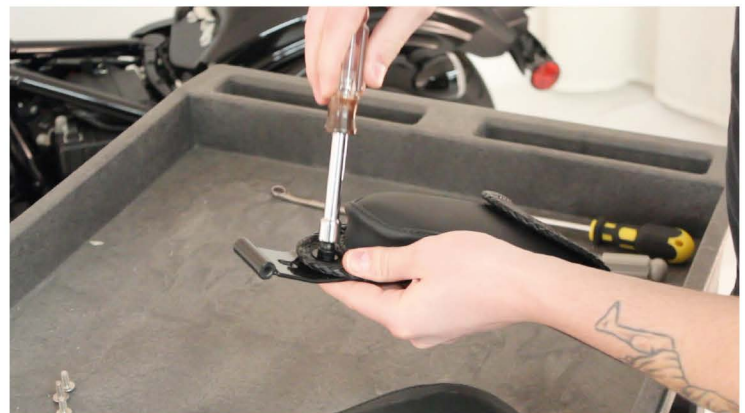



On the underside of your solo seat there are three 1/4"-20 mounting locations.



Line up the three holes in the mounting plate with the holes on your seat.



Using three 1/4"-20 x 5/8" screws, attach the plate to the seat starting with the two rear locations.

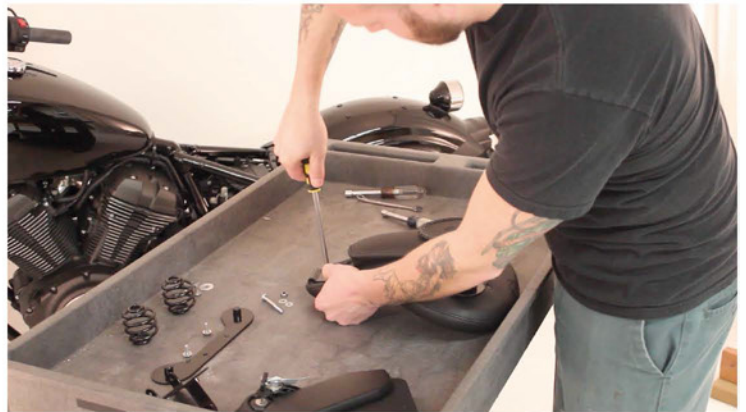
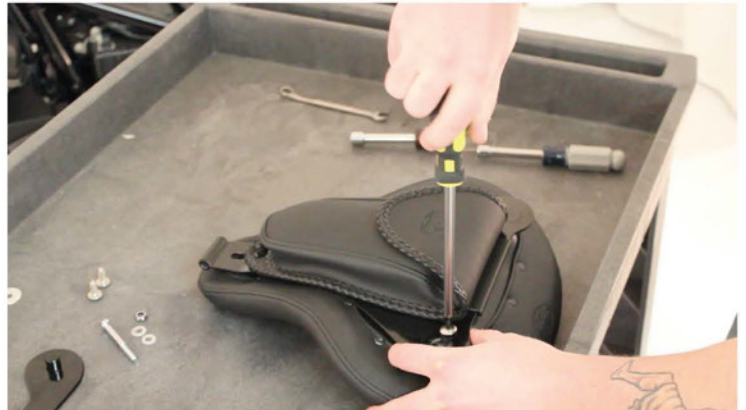

Using a fender washer and a 1/4"-20 x 5/8" Phillips screw, attach the first seat spring to the mounting plate.



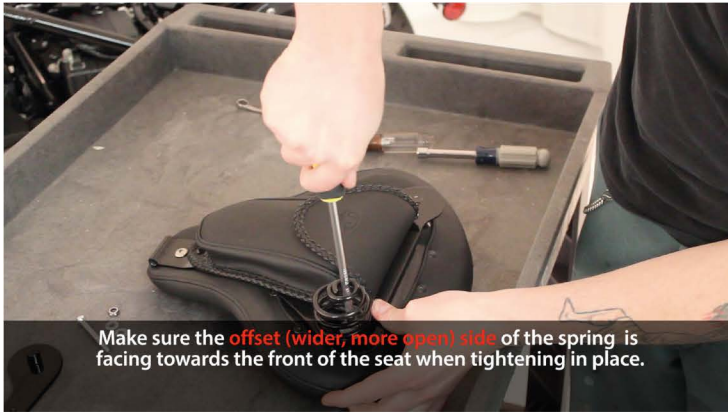

Make sure the **offset (wider, more open) side** of the spring is facing towards the front of the seat when tightening in place.



Repeat for the second spring.



Offset

Offset

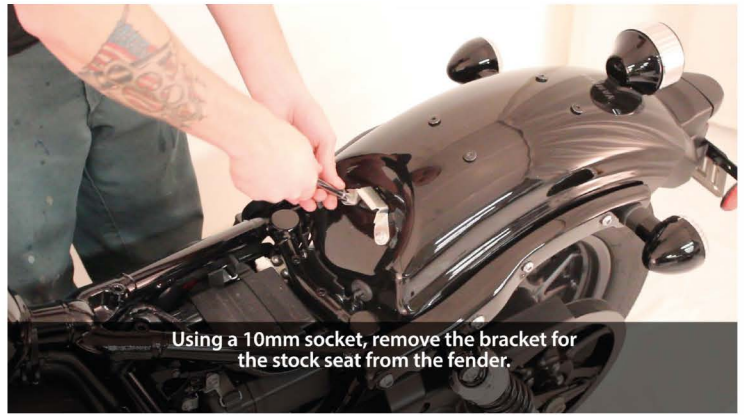

Using a 10mm socket, remove the bracket for the stock seat from the fender.

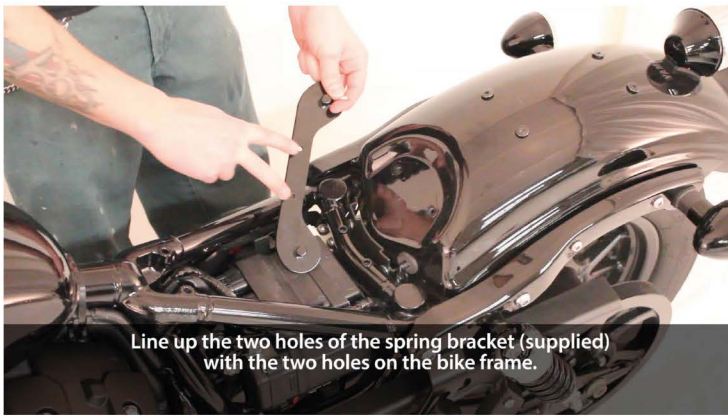

Line up the two holes of the spring bracket (supplied) with the two holes on the bike frame.

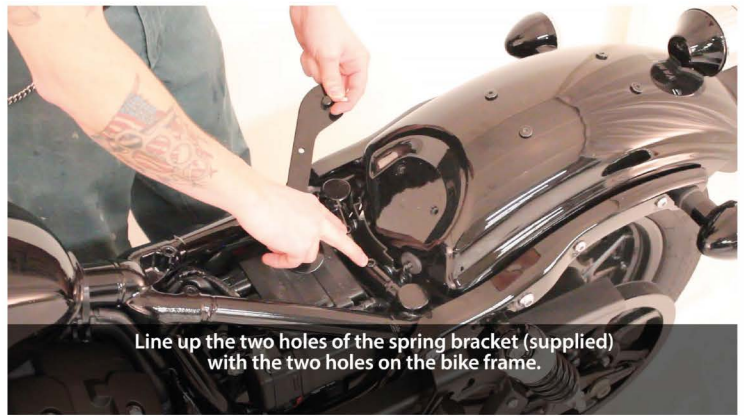

Line up the two holes of the spring bracket (supplied) with the two holes on the bike frame.

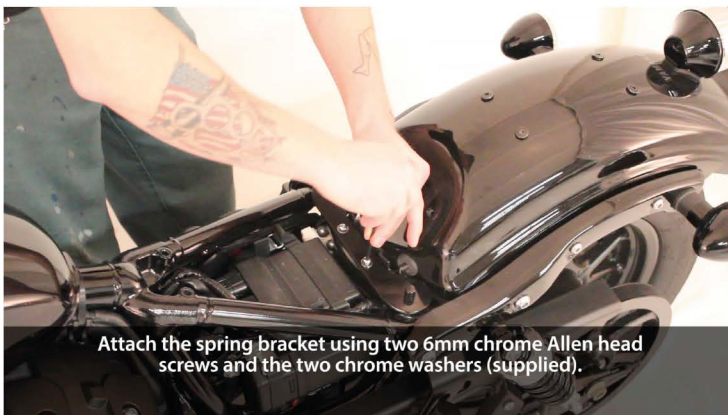

Attach the spring bracket using two 6mm chrome Allen head screws and the two chrome washers (supplied).

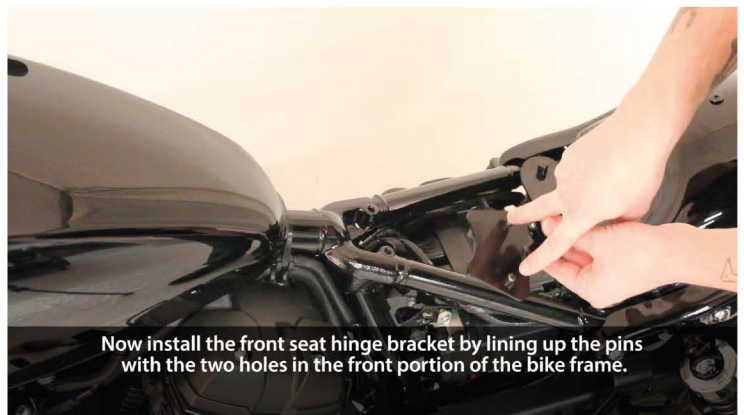

Now install the front seat hinge bracket by lining up the pins with the two holes in the front portion of the bike frame.





Now install the front seat hinge bracket by lining up the pins with the two holes in the front portion of the bike frame.



Tap the bracket into place; it should be a snug fit.



Using the screw from your stock seat, tighten the bracket using a 10mm socket.



Position nose of seat into front seat hinge bracket as shown.



As you slide the 1/4"-28 x 2-1/4" hex cap screw through the bracket, position a white nylon washer on each side of the nose of the seat mounting plate.



Tighten the 1/4"-20 nylock nut onto the screw using a 7/16" socket and wrench.



Carefully flip up your seat making sure there is clearance between the seat springs and your fender.



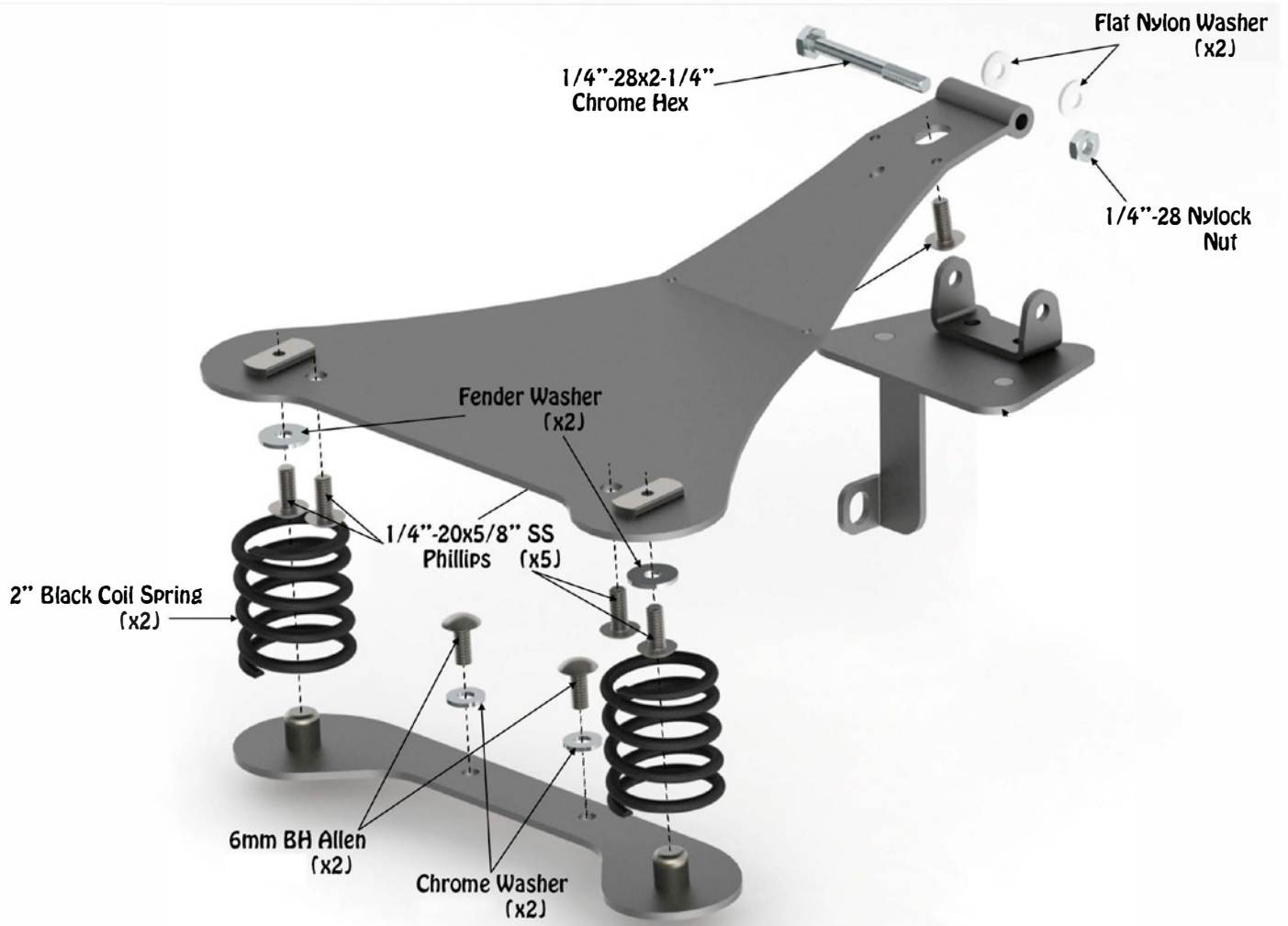
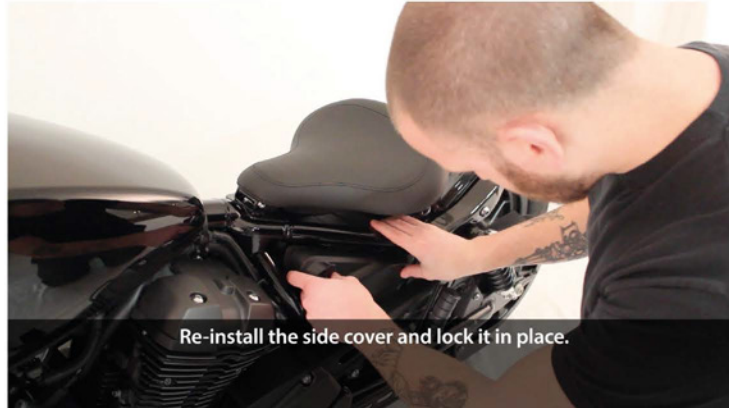

Enjoy the comfort and custom look of your new Mustang seat!



Buy quality motorcycle seats & backrests in our online store.