



## **INSTALLATION INSTRUCTIONS**

# **KAWASAKI Versys 650/1000 2017- [T &VT]**

© by MRA-Klement GmbH – 08/2018 4025066164189

# INSTALLATION INSTRUCTIONS

## *Kawasaki Versys 650/1000 17-*

*Thank you for buying a MRA Windshield.*

*Read this manual carefully and check the parts list for completeness before you begin. We recommend that you have your screen fitted by an authorised workshop.*

Number	Article	Article No..	Required tools
1	MRA windscreen	---	Allen key 3mm and 4mm
2	M5 X 20 MM OVAL-HEAD SCREW	10673	Flat-tip screwdriver
2	M5 X 16 MM OVAL-HEAD SCREW BLACK	10554	Spanner 8 mm
4	12 X 5 X 0.5 MM WASHER PLASTIC	10635	
2	3 MM SPACER SLEEVE	10872	
2	6 MM SPACER SLEEVE	11038	
4	O-ring 4.5 X 1.5	10992	
4	5.3 MM WASHER BLACK	10999	

**!We highly recommend that the mounting is done by two people!**

### **Mounting the windscreen on the motorcycle:**

1. Place the motorcycle on a flat surface.
2. Set the original windscreen to the highest position.
3. Now remove the cover caps from the knurled nuts with a flat-tip screwdriver (P 1).
4. Unscrew the 5 mm Allen screws and hold the knurled nuts firmly in place (P 1).
5. Unscrew the knurled nut one after the other by turning them to the left – please take care to ensure that no parts fall off, and that you hold the windscreen firmly in place.
6. Now remove the original holding plate from the original windscreen (P 2).
7. Now mount the original holding plate onto the MRA windscreen.

#### **ATTENTION:**

M5 X 20 mm screws and the 6 mm spacer sleeve is used in the upper holes.

Please use the M5 X 16 screws with the 3 mm spacer sleeve in the lower holes (P 3, P 4, P 5). Use the provided O-Ring as a mounting aid (P 6).

**IMPORTANT:** lay out the oval / oblong piece of nylon on the motorbike beneath the MRA windscreen before mounting. (P 7 and P 8).

8. Now mount the MRA windscreen on the motorbike (reassemble holding parts in reverse order) (P 9). Ensure that the two pieces of nylon are not crushed during the mounting.

**After installation, check that all of the screws are tight; tighten them up if necessary. Repeat this at regular intervals. Clean the screen with water, neutral soap and a sponge. Do not use solvents, alcohol or spirits to clean the screen as they will damage it.**



**P 1**



**P 2**



**P 3**



5,3MM SCHEIBE  
SCHWARZ  
(washer black)

5,3mm Scheibe schwarz,  
(washer black)

**P 4**



**P 5**



**P 6**



P 7



P 8

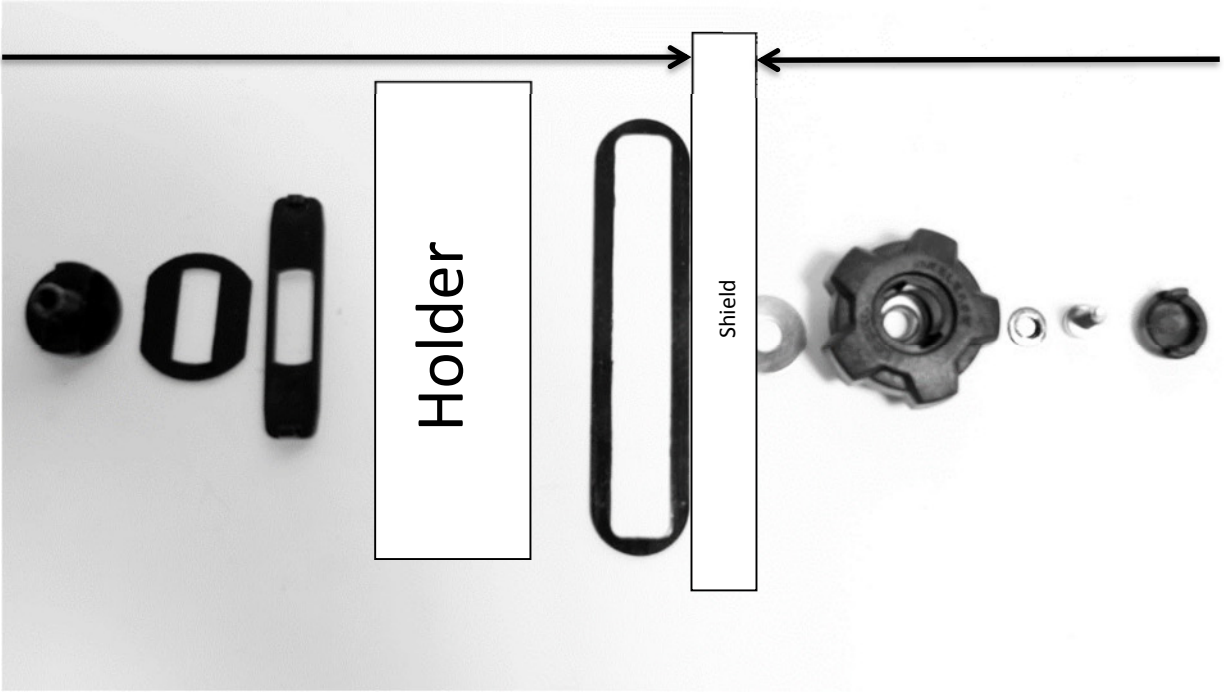

P 9



## **INSTALLATION INSTRUCTIONS**

# **KAWASAKI Versys 650/1000 2017- [0]**

© by MRA-Klement GmbH – 08/2018 4025066164165



## INSTALLATION INSTRUCTIONS

### *Kawasaki Versys 650/1000 17-*

*Thank you for buying a MRA Windshield.*

*Read this manual carefully and check the parts list for completeness before you begin. We recommend that you have your screen fitted by an authorised workshop.*

Number	Article	Article No..	Required tools
1	MRA windscreen	---	Allen key 3mm and 4mm
4	M5 X 16 MM OVAL-HEAD SCREW BLACK	10554	Flat-tip screwdriver Gr. 2
4	12 X 5 X 0.5 MM WASHER PLASTIC	10635	Spanner 8 mm
4	3 MM SPACER SLEEVE	10872	
4	5.3 MM WASHER BLACK	10999	

#### **Removing the original windscreen:**

1. Place the motorcycle on a flat surface.
2. Pull out the knurled nuts cover caps (P 1).
3. Now remove the screws and washers with the 4 mm Allen key (P 1).
4. Loosen and remove the knurled nuts and washers by turning them to the left (P 1).
5. Now remove the windscreen from the holder.  
INFO: Make sure that you do not lose the two plastic washers.
6. Now remove the holding plate from the original windscreen.

#### **Mounting the MRA windscreen:**

7. Insert the provided M5x16mm oval-head screws with the plastic washers into the holes on the MRA screen.
8. Now insert the 3 mm spacer sleeves into the holding plate from behind, as shown in pictures 2,3 and 4, and push the 5 mm steel washers onto the oval-head screw and then fit the original M5 cap nuts. Now tighten the screws.
9. Mount the MRA windscreen to your motorbike again and tighten all four screws.

**After installation, check that all of the screws are tight; tighten them up if necessary. Repeat this at regular intervals. Clean the screen with water, neutral soap and a sponge. Do not use solvents, alcohol or spirits to clean the screen as they will damage it.**



P 1

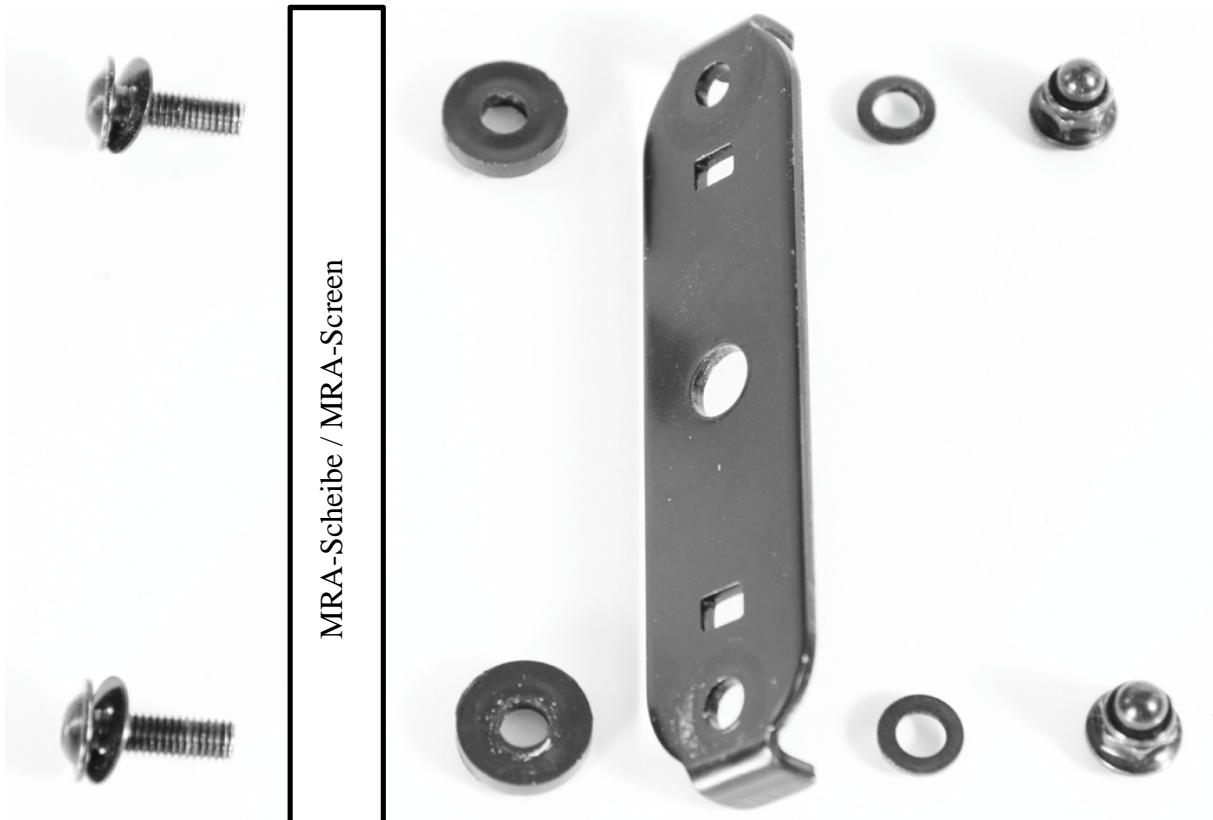

P 2

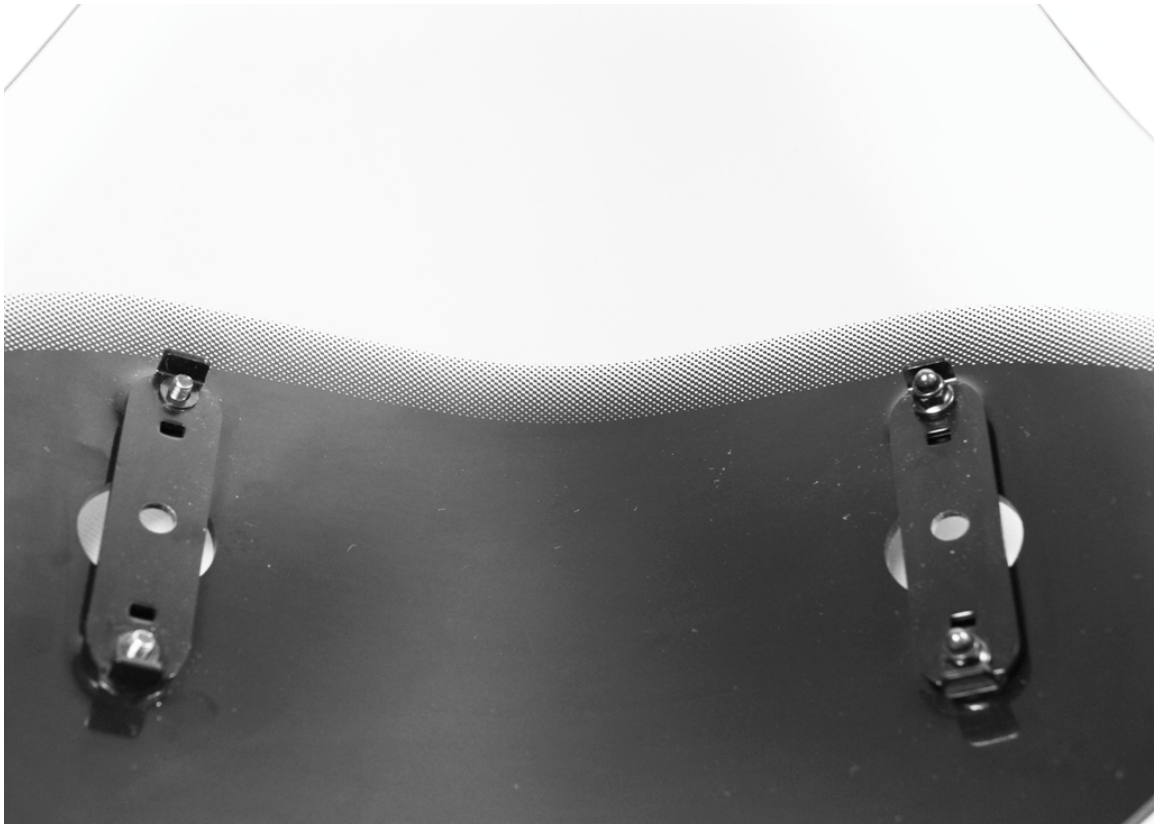

**P 3**



**P 4**

# Functional Description

## *Variotouringscreen VT*

Thank you for purchasing a Variotouringscreen. Please carefully read these instructions. You will get the most out of the adjustable spoiler if you thoroughly understand its features.

The spoiler serves to reduce air pressure on the rider's helmet and upper body without causing disturbing air turbulence.

The spoiler has six different positions, enabling the rider to make adjustments to suit his needs.

The higher the spoiler is set, the more air will flow between the spoiler and the windscreen.

The airflow speed is reduced by means of the angle that opens in the direction of the rider, thereby providing at higher speeds the same relaxed atmosphere that a rider experiences at slow speeds.

- Raise the spoiler by manually pressing (Fig. 1) or pulling (Fig. 2) it upward, parallel to the windscreen.
- To make the spoiler flatter, push it downward in the direction of travel. (Fig. 3)

While adjusting the spoiler, make sure that it remains in the same position to the right and left.

**Attention!** Never attempt to adjust the spoiler while riding. The distraction will greatly increase the risk of accident!

### **VARIOTOURINGSCREEN FOR NAKED-BIKES:**

- Recommended installation angle: 40-50°
- Recommended installation position: 10 - 20 mm gap to lamp.

*Figure 1*



*Figure 2*



*Figure 3*

