



Installation instructions for part BT-HD01

# BT-HD01 Harley Davidson Bluetooth Audio Streaming Interface 2006-2013

## FEATURES

- Adds Bluetooth audio streaming to the factory radio
- Can be operated with the handlebar controls
- Will play/pause with ignition on/off
- Will show up on the factory radio as HDBT

## INTERFACE COMPONENTS

- BT-HD01 interface • BT-HD01 harness • 4' Waterproof USB cable

## APPLICATIONS

<b>HARLEY DAVIDSON (with Advanced Radio)</b>	Street Glide	2006-2013
Electra Glide	2006-2013	Road Glide
		2006-2013

## TOOLS REQUIRED

- Wire cutter • Crimp tool • Solder gun • Tape • Torx driver
- Connectors (example: butt-connectors, bell caps, etc.)

## Table of Contents

Pre-Installation ..... 2

Fairing Disassembly ..... 3-4

Connections to be made ..... 5

Installing the BT-HD01 ..... 6

Pairing the BT-HD01 ..... 6

Operation ..... 6

**CAUTION!** All accessories and switches must be connected before cycling the ignition. Also, do not remove the factory radio with the key in the on position, or while the vehicle is running.



**BT-HD01**

## **Pre-Installation**

**Attention:** *Before beginning the installation, check the current software version of the radio following the steps below. This product will not work on models with software versions lower than V8.250.*

- Turn the radio on and activate the FM source.
- Turn the ignition key switch to the off position.
- Press and hold any (2) soft buttons on the radio, and then turn the ignition key switch to the on position. The soft buttons are the numbered buttons on the radio.
- Continue holding the (2) soft buttons until “Diag Test” is displayed on the radio screen, and then let go.
- Press the soft key button “4” labeled “Software” on the radio screen.
- The radio screen will then show the current software version. If you do not have V8.250 or higher, please contact Harley Davidson in regards with how to update the radio. Please do not contact Axxess/Metra for any questions pertaining to updating the radio.
- If the radio has V8.250 or higher software, press the soft button “6” to exit the diagnostic mode.

## Fairing Disassembly

### FLH/Batwing models:

1. Cover the front fender.
2. Remove (2) T-27 Torx bolts from inner fairing (under mirrors) (Figure A, step 2)
3. Remove (2) T-27 Torx bolts from outer edges of inner fairing near the fork tubes (facing forward) (Figure A, step 3)
4. Remove (3) T-27 Torx bolts from bottom edge of windshield. (Figure A, step 4)

**Note:** Windshield and fairing will be loose once these screws are removed. Use extreme caution not to damage fairing or windshield.

5. Remove windshield taking caution that the outer fairing is loose.
6. Lift away and unplug headlight to remove outer fairing. (Figure B)

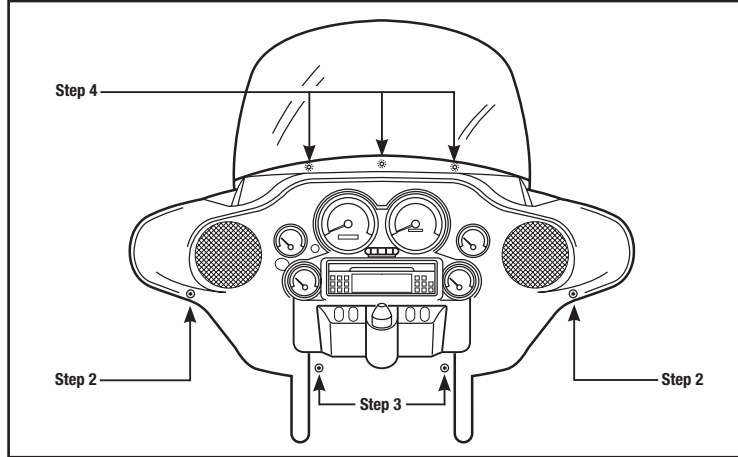

(Figure A)

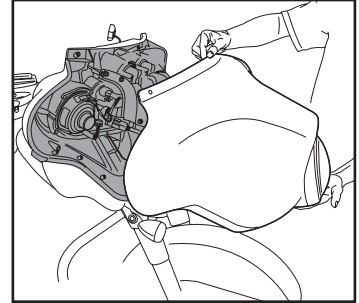

(Figure B)

## Fairing Disassembly

### Roadglide/Sharknose models

1. Loosen (6) T-25 Torx bolts from bottom, middle and top of left and right sides of the inner fairing. (Figure A)
2. Use a 1/2" socket or box wrench to remove the (2) acorn nuts that hold each turn signal at the lower fairing. Let the signals hang loose. (Figure B)
3. Lift away the fairing, unplug the headlights and remove.

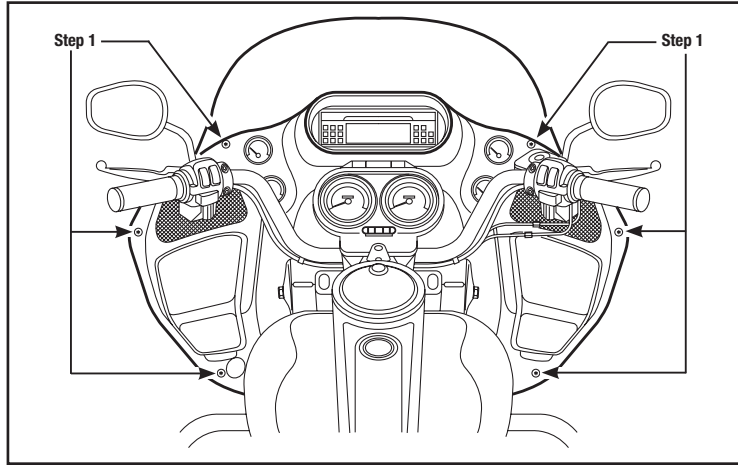

(Figure A)

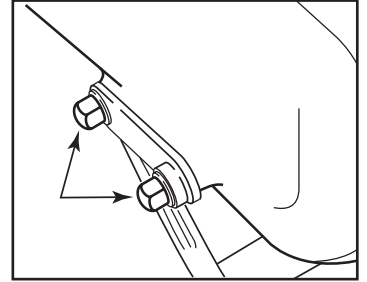

(Figure B)

## Connections to be made

- Remove the 35-pin connector from the radio. This is the larger connector of the (2) connectors in the radio. If there isn't a 35-pin connector in the radio, proceed to the next step.
- Connect the male end of the BT-HD01 harness into the radio.
- Connect the female end of the BT-HD01 harness into the factory connector in the vehicle. If there wasn't a 35-pin connector in the radio, skip this step.
- The following (2) wires connect to the 23-pin radio connector. This is the smaller connector of the (2) connectors in the radio. The factory connector has the pin cavity locations stamped onto it.
- Connect the **Black** wire from the BT-HD01 harness to the wire located in pin-19 of the 23-pin radio connector.
- Connect the **Red** wire from the BT-HD01 harness to the wire located in pin-20 of the 23-pin radio connector.

**Note:** The BT-HD01 can operate in two different modes: CD mode (default) or SAT mode. If you have a factory iPod interface installed and desire to keep it, change the BT-HD01 to SAT mode. To do this you will need to cut the **Grey** loop wire coming out of the BT-HD01, and then switch the 3-pin audio wire connection to the SAT setting.

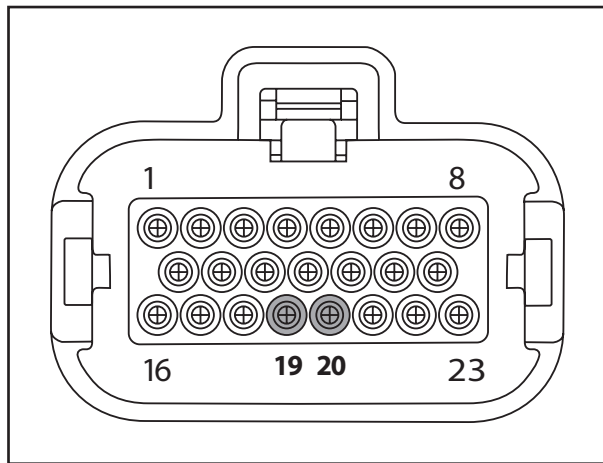

*This is the wire view of the connector*



BT-HD01

## Installing the BT-HD01

- Remove (3) Torx screws from the radio. (Figure A)
- Attach the BT-HD01 to the radio, then reinstall the (3) Torx screws, securing the BT-HD01 to the radio.
- If the 4' waterproof USB cable is desired to be used, route the USB cable out from the lower fairing to the desired location. The USB cable is designed to be mounted with a hole drilled into the fairing, if so desired.
- Reassemble the fairing in reverse order of disassembly.

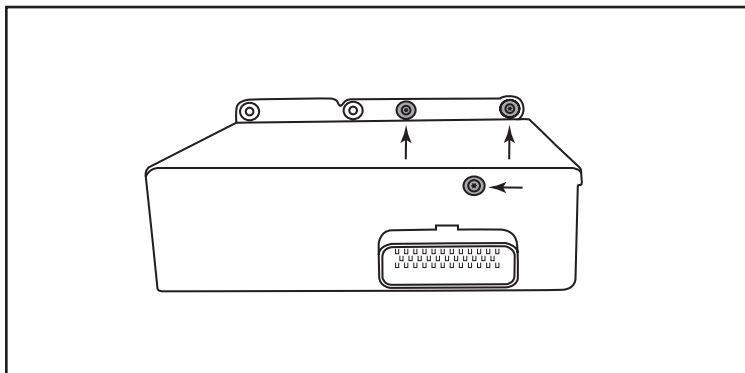

## Pairing the BT-HD01

- Turn the ignition key switch to the on position, and then turn on the radio. There will be a new option on the radio screen titled “HDBT”.
- Select this option, and then select “Pair”.
- On the Bluetooth device search for “HDBT”, and then pair to the BT-HD01.

## Operation

### Handlebar controls

- The UP and DN buttons will operate next/previous song, if applicable.
- The MODE SEL. button will cycle through the available sources.

### Radio controls

- The soft buttons 1-6 will allow you to access the following features:  
Pair (1), Play/Pause (2), Random (3), Next (4)

**Note:** After 5 seconds with no buttons being pressed, the radio will default to the main screen.

**Note:** The BT-HD01 supports full text on the radio screen from most streaming apps, pending the Bluetooth device supports AD2P.