



INSTALLATION INSTRUCTIONS FOR PART 99-9700

APPLICATIONS

Harley-Davidson Street Glide, Electra Glide, Ultra and Limited models 2014-up 99-9700

KIT FEATURES

- ISO DIN radio provision
- Included interface and LCD info screen



KIT COMPONENTS

- A) Radio housing • B) Brackets • C) LCD display • D) LCD back plate
- E) (10) #8 x 3/8" Phillips screws • Axxess interface (*not shown*)

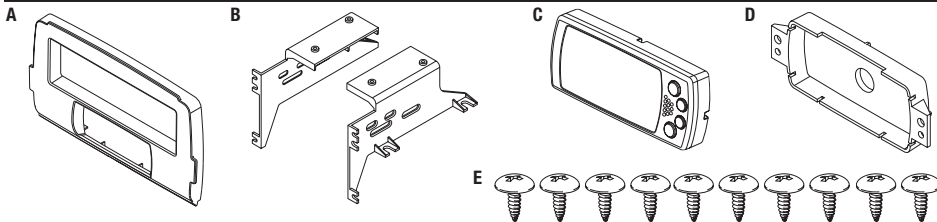

WIRING & ANTENNA CONNECTIONS (sold separately)

Wiring Harness: • Included interface

Antenna Adapter: • 40-EU10 Handle bar controls: • ASWC-1

TOOLS REQUIRED

- Panel removal tool • Phillips screwdriver
- Torx screwdrivers • Allen wrenches

CAUTION: Metra recommends disconnecting the negative battery terminal before beginning any installation. All accessories, switches, and especially air bag indicator lights must be plugged in before reconnecting the battery or cycling the ignition.

NOTE: Refer to the instructions included with the aftermarket radio.

Fairing Disassembly

1. Remove (4) T-27 from inner fairing. (Figure A)
2. Remove (3) T-27 from windshield (caution not to drop the outer fairing or windshield). (Figure B)
3. Remove outer fairing, unplugging the headlight. (Figure C)
4. Remove (2) T-27 to remove the fairing vent and remove the vent. (Figure D)

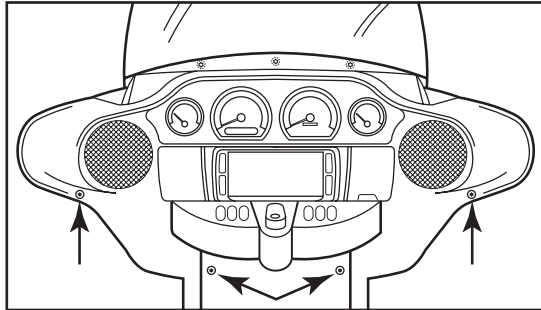

(Figure A)

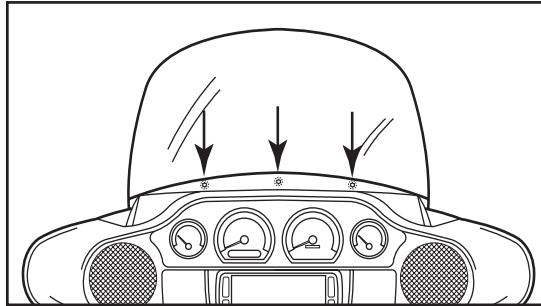

(Figure B)

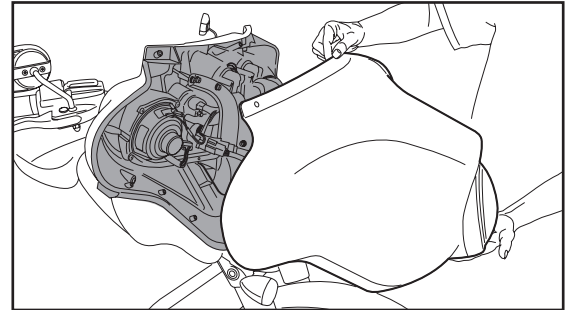

(Figure C)

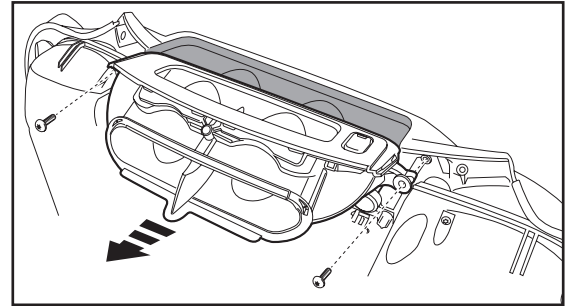

(Figure D)

Fairing Disassembly

5. Remove (11) screws from metal bracket above radio: (Figure E)
 - 5.1 (2) T-27 shared with gauge cluster and a third T-27 to remove the gauge cluster in step 7.
 - 5.2 (4) 5/32" Allen head facing outward.
 - 5.3 (4) T-25 from top of radio bracket.
 - 5.4 (1) T-25 shared with storage pocket.
6. Remove radio bracket. (Figure E)
7. Remove gauge cluster. (Figure E)

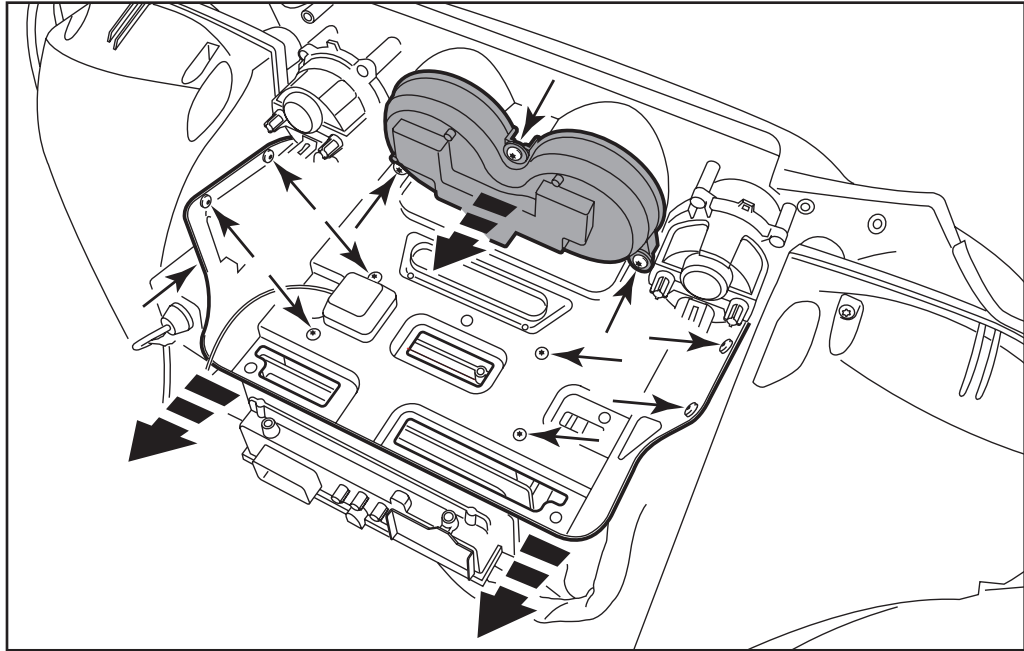

(Figure E)

Fairing Disassembly

8. Remove (4) 3/16 Allen-head bolts from sides of radio. (Figure F)
9. Slide radio out toward front of bike. (Figure F)

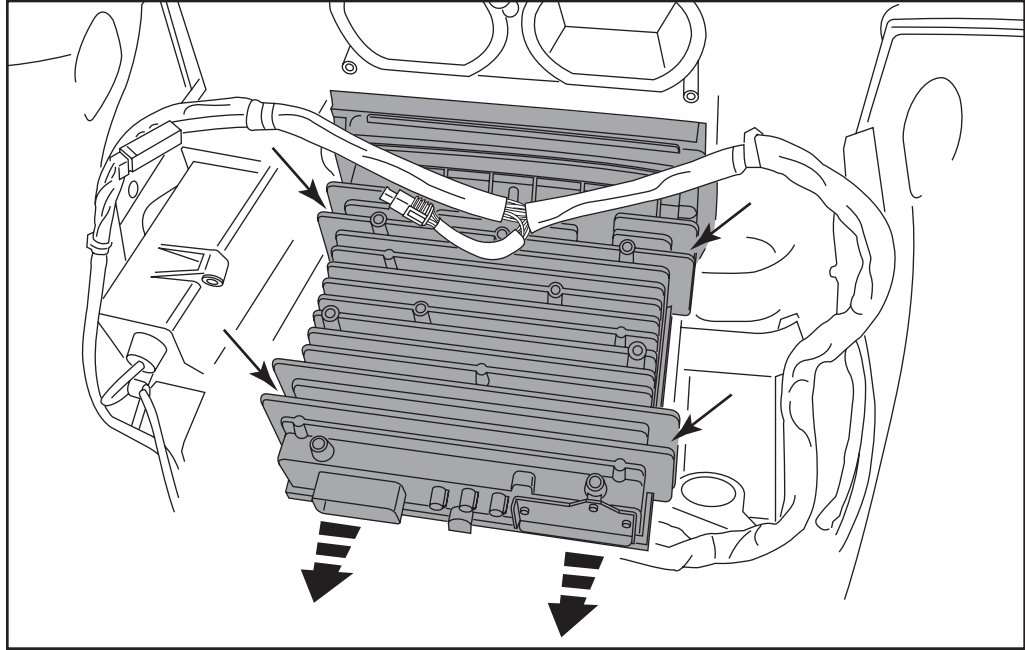

(Figure F)



99-9700

Kit Assembly

ISO DIN radio provision

1. Connect the radio brackets to the radio housing trim panel with the (4) #8 x 3/8" Phillips screws supplied. (Figure A)
2. Slide the radio into the assembly and secure with screws supplied with the radio. (Figure B)
3. Insert LCD into radio housing, route cable through back plate and mount the back plate using the (2) supplied #8 x 3/8" screws. (Figure C)
4. Locate the factory wiring harness and antenna plug in the dash. Refer to the interface wiring instructions on pages 6-7.
5. Mount the new radio assembly from the back of the inner fairing and reassemble fairing in reverse order of disassembly. Use the supplied #8 x 3/8" screws to secure the factory radio bracket and bracket assembly of the kit.

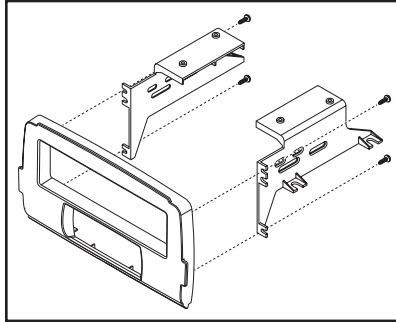

(Figure A)

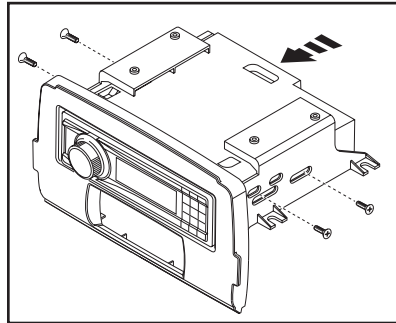

(Figure B)

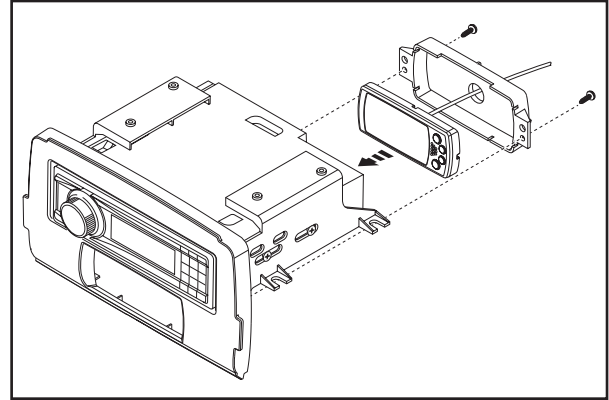

(Figure C)



99-9700

Axxess Interface Installation

FEATURES

- Provides accessory power (12-volt 10-amp)
- High level speaker input
- Retains balance and fade
- Micro “B” USB updatable
- Retains EITMS status
- Prewired ASWC-1 harness included (ASWC-1 sold separately)

INTERFACE COMPONENTS

- 99-9700 interface
- 99-9700 harness

TOOLS REQUIRED

- Cutting tool • Crimping tool • Tape
- Connectors (example: butt-connectors, bell caps, etc.)

Connections to be made

From the 99-9700 harness to the aftermarket radio:

- Connect the **Black** wire to the ground wire.
- Connect the **Yellow** wire to the battery wire.
- Connect the **Red** wire to the accessory wire.
- Connect the **Orange** wire to the illumination wire. (If the aftermarket radio has no illumination wire, tape off the **Orange** wire).
- Connect the **White** wire to the left front positive speaker output.
- Connect the **White/Black** wire to the left front negative speaker output.
- Connect the **Gray** wire to the right front positive speaker output.
- Connect the **Gray/Black** wire to the right front negative speaker output.
- Connect the **Green** wire to the left rear positive speaker output.
- Connect the **Green/Black** wire to the left rear negative speaker output.
- Connect the **Purple** wire to the right rear positive speaker output.
- Connect the **Purple/Black** wire to the right rear negative output

From the 12-pin pre-wired ASWC-1 harness to the aftermarket radio:

- This harness is to be used in conjunction with the optional ASWC-1 (*not included*) to retain handlebar controls. If the ASWC-1 is not being used, disregard this harness. If it will be used, please refer to the ASWC-1 instructions for radio connections and programming.

Note: *Disregard the harness that comes with the ASWC-1*



99-9700

Installing the Interface

- Connect the 99-9700 harness into the interface.
- Connect the 99-9700 harness into the vehicles wiring harness.
- With all connections completed, reconnect the negative battery terminal.
- Initialize the interface by turning the ignition on for 30-seconds, then turn the ignition back off, then back on again.

Note: If using the ASWC-1, connect it after you initialize the 99-9700, with the key in the off position.

LCD Operation

The included LCD screen provides oil pressure and EITMS status.

See bike owner's manual for more information.

Plug the interface in to the factory plug and then plug the DIN cable connecting the LCD screen.

Main menu options:

- **Red BL** - Adjusts the RED backlighting of the LCD (ranges from 1 to 32)
- **Blue BL** - Adjusts the BLUE backlighting of the LCD (ranges from 1 to 32)
- **Green BL** - Adjusts the GREEN backlighting of the LCD (ranges from 1 to 32)
- **Contrast** - Adjusts the contrast of the LCD (ranges from 1 to 100)
- **Reset** - Resets color back to default settings

Arrow up - Toggles "up" through menu options

Arrow down - Toggles "down" through menu options

Return/ESC - Return you to the previous menu

Enter - Enter current menu option