



# INSTALLATION INSTRUCTIONS

## LEGACY SLIP ON

### MINIMUM REQUIRED TOOLS:



1/2", 9/16", 10mm,  
WRENCHES



10mm,  
1/2", 9/16"  
SOCKETS  
AND RATCHET



TORQUE  
WRENCH

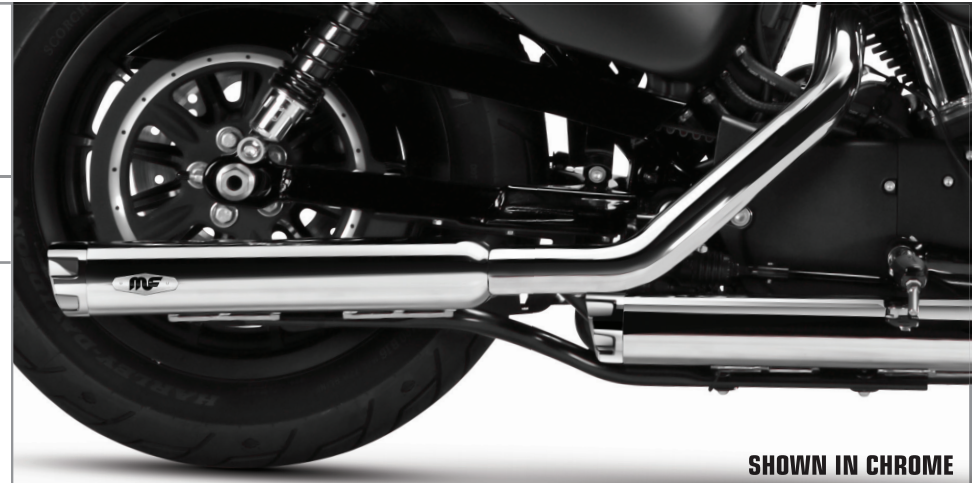

SHOWN IN CHROME

### INCLUDED HARDWARE:

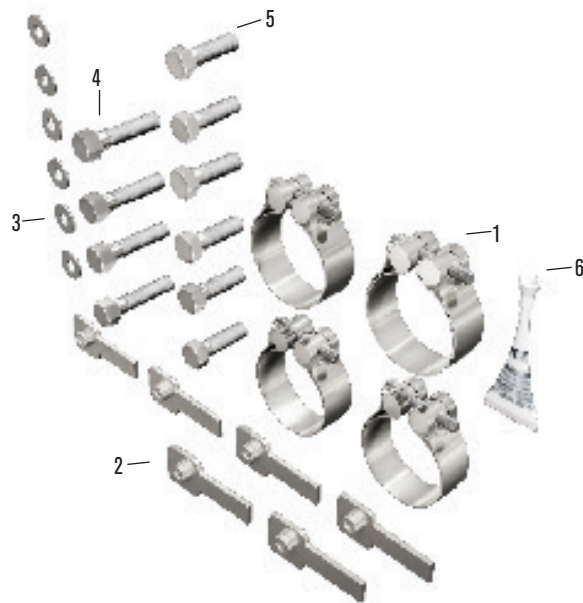

- 1. (4) MUFFLER CLAMP 1.75 IN.
- 2. (6) ASST. NUT PLATE 1/4-20
- 3. (6) WASHER FLAT 1/4
- 4. (4) BOLT HEX 1/4-20 X 1.00
- 5. (6) BOLT HEX 1/4-20 X 0.75
- 6. (1) THREADLOCKER

- CHROME PART # 7200101
- BLACK PART # 7200102



- 1. (2) MUFFLER
- 2. (2) ADAPTER



## IMPORTANT INFORMATION

1. Register your new product.
2. When installing new MagnaFlow exhaust systems, be sure your hands are clean and free of oil, lotion or similar products. After installation is completed and before starting the motorcycle, thoroughly clear the new exhaust system with a clean, soft cloth and cleaning solvent that leaves no residue. Debris, residue or fingerprints left on the system may cause damage to the finish. Damage or discoloration to finish is not covered by warranty.
3. MagnaFlow advises replacing worn or damaged gaskets.
4. Make sure there are no exhaust leaks at the junctions and connecting points of the exhaust pipes and/or mufflers, or at the cylinder.
5. Leaks due to improper installation may cause the engine to overheat. This may cause discoloration.

Maximize your motorcycles performance and efficiency by complementing your new MagnaFlow exhaust system with a fuel tuner management system and or EFI remapping. Remapping is suggested to optimize performance while reducing the possibility of damage to your motor or new exhaust system.

NOTICE: MagnaFlow makes every effort to design exhaust systems which enhance the riding experience. However, due to restraints on some models, tolerances, ground and or cornering clearance may not improve and in some cases may be reduced. Adjustments to the motorcycle not listed here may be required for proper fitment. Be sure to carefully follow all installation instructions.

**DISCLAIMER: NOT LEGAL FOR SALE OR USE IN CALIFORNIA ON ANY POLLUTION CONTROLLED MOTOR VEHICLES.**

Some part numbers not available in California. The California Air Resources Board (CARB) does not permit the use of aftermarket emission-related part(s) that alter the performance of OEM emission-related devices unless CARB has issued an Executive Order. Check Federal, State and local laws for compliance.

Platforms, model names and descriptions including but not limited to Dyna®, Softail®, Sportster®, Touring®, Fat Boy®, Road Glide®, Heritage® and Harley® are registered trademarks of The Harley-Davidson Motor Company®, Milwaukee, WI, U.S.A.

### CALIFORNIA EMISSIONS NOTICE

Some part numbers are not legal for sale or use in California. The California Air Resources Board (CARB) does not permit the use of aftermarket emission-related part(s) that alter the performance of OEM emission-related devices unless CARB has issued an Executive Order, other than on racing vehicles on closed courses. Check your local laws and manufacturer's information.

In California, the sale and installation of motorcycle aftermarket exhaust parts that may have the potential to impact emissions are regulated by the California Air Resources Board (CARB). The sale, installation and use of emissions related aftermarket exhaust parts on motorcycles is prohibited unless the exhaust part is either an OEM "replacement part" as defined by the state of California, or is specifically permitted for use by an Executive Order issued by CARB.

#### (1) Replacement Parts

Replacement Parts are aftermarket parts that are functionally identical to the stock OEM part they are intended to replace, and therefore do not adversely impact emissions when installed and in use. Replacement Parts are permitted for sale, installation and use on motorcycles used on or off the public highways in California. For motorcycles, these parts fall in to two categories:

### CALIFORNIA EMISSIONS NOTICE (CONT.)

\* No emission control - If the motorcycle's stock exhaust system does not contain any emission control components, then an aftermarket exhaust part is a Replacement Part and no EO is required.

\* Upstream emission control devise. If the motorcycle's stock exhaust system contains a catalytic converter, then an aftermarket exhaust part positioned downstream from the catalytic converter (i.e. cat-back) is a Replacement Part as long as it does not remove, replace or adversely affect any emission control equipment originally attached to the stock exhaust system.

#### (2) Executive Order Parts

All exhaust parts that incorporate or impact any emission control devise require a CARB issued Executive Order allowing the parts to be advertised, sold, offered for sale and installed in California, pursuant to specific application.

1. Locate and loosen the nut on the factory clamp at the inlet side of each muffler.
2. Remove the mounting bolts and washers attaching each muffler. For applications using a support bar that is only attached to the mufflers, please note the position of the bar as it will be necessary to re-attach it correctly during the installation.
3. Slide each muffler towards the rear of the bike to remove it from the head pipes.  
Note: Penetrating lubrication may be necessary to assist in the removal of the mufflers.

**PLEASE NOTE:**

This kit is designed to fit several years and models. Some applications may or may not require all of the hardware included in this kit. Please follow the steps below that reference your particular motorcycle.

For applications originally equipped with a cross exhaust tube that attaches to the mufflers.

1. Using the supplied muffler clamp, install one muffler adapters on each head pipe. Do not tighten the muffler clamp at this time to allow for adjustment. (Figure 1 and 2)

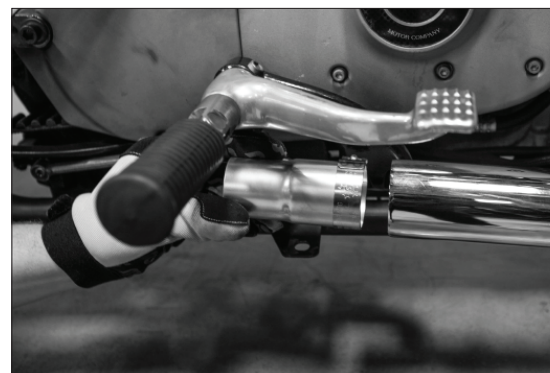

Fig. 1

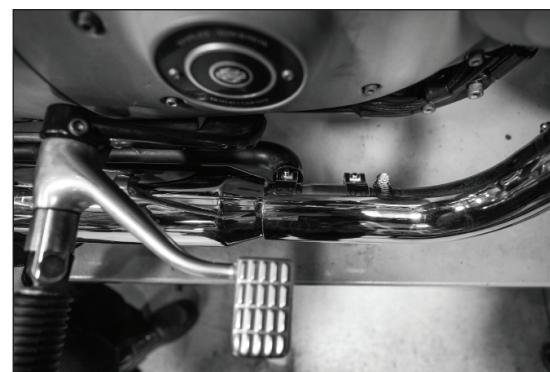

Fig. 2

2. Continue following the installation step.

**FOR ALL OTHER APPLICATIONS:**

1. Using one clamp for each muffler, install the clamp on the inlet side of each muffler.
2. Slide each muffler on to each head pipe or muffler adapter while aligning the mounting brackets with the support bar.
3. Insert the supplied nut plates into the muffler mounting brackets and attach the mufflers to the support bar using the supplied 1/4-20x3/4 inch bolts, washers, and threadlocker. For Dyna models, it will be necessary to use the 1/4-20x1 inch instead. Do not tighten at this time to allow for adjustment. (Figure 3)

**Fig. 3**

4. Align the mufflers correctly, and then tighten all of the mounting bolts. Next, tighten the muffler clamps to factory specifications.
5. Please reference item 2 on the important information page.

Note: Remapping the EFI unit is suggested to optimize performance while reducing the possibility of damage to your engine or new exhaust system.