



GIRDER SHIFT LINKAGE 9054

FITS: ALL '86-UP SOFTAIL MODELS (EX. '97-'99 FLSTS), '93-'02 FXDWG, AND ALL '80-UP TOURING MODELS (DRESSERS, ROAD KINGS, ROAD GLIDE).

PARTS INCLUDED

- 1 Girder Shift Linkage Assembly
- 1 Installation Instructions

Please read and understand entire instructions before starting installation.

THANK YOU FOR CHOOSING KÜRYAKYN!

IN ORDER TO PROTECT YOU AND OTHERS FROM POSSIBLE INJURY AND/OR PROPERTY DAMAGE OR LOSS, PLEASE PAY CLOSE ATTENTION TO ALL INSTRUCTIONS, WARNINGS, CAUTIONS AND ATTENTION NOTES REGARDING THE USE AND CARE OF THIS PRODUCT.

WARNING! THIS INDICATION ALERTS YOU TO THE FACT THAT IGNORING THE CONTENTS DESCRIBED HEREIN CAN RESULT IN POTENTIAL DEATH OR SERIOUS INJURY.

CAUTION! This indication alerts you to the fact that ignoring the contents described herein can result in potential injury or material damage.

ATTENTION! This indication alerts you to the fact that ignoring the contents described herein may negatively affect product performance and functionality.

NOTE: Installation shown on a 2006 Touring and 2007 Softail Deluxe; while representative of typical procedure, there may be minor differences when installed on other models.

TOOLS SUGGESTED

Set of open-end wrenches; set of hex wrenches.

STRICTLY OBSERVE THE FOLLOWING GUIDELINES IN ORDER TO USE THE PRODUCT PROPERLY AND AVOID POTENTIALLY DANGEROUS ACCIDENTS.

PROCEDURE

STEP 1 Read and understand all steps in the instructions before starting the installation. Park the motorcycle on a hard, level surface; turn off the ignition and allow the engine to cool.

WARNING! YOU WILL BE WORKING AROUND THE ENGINE AND EXHAUST SYSTEM DURING INSTALLATION. ENSURE THAT THE ENGINE AND EXHAUST SYSTEM HAVE FULLY COOLED TO PREVENT INJURY.

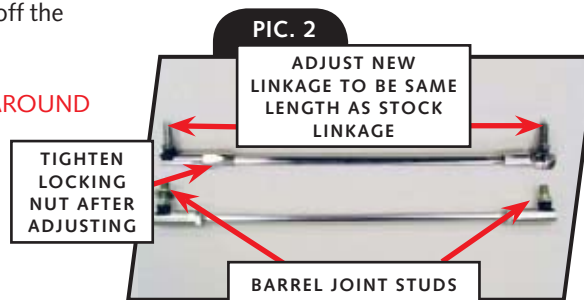
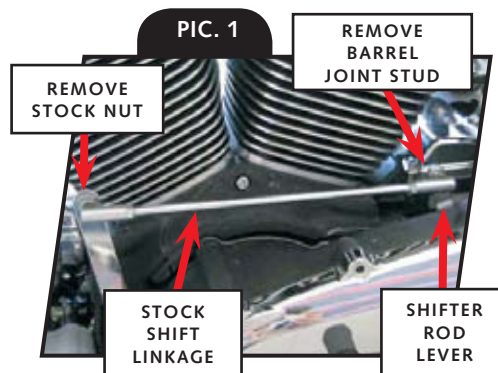

-cont.-

STEP 2 Remove stock shift linkage; set aside for later. See PIC. 1. (Touring Model shown)

STEP 3 Lay stock shift linkage and Girder Shift Linkage with the barrel joint studs across from each other. See PIC. 2. (Touring Model shown)

NOTE: On most Softtail Models, the front barrel joint stud faces outward and includes an acorn nut. (Softtail Model shown in PIC. 3)

STEP 4 Adjust new linkage to same length as stock linkage. Turn barrel joints in or out on the linkage threads to adjust. Tighten locking nut against barrel joint.

NOTE: Each threaded end of the Girder Shift Linkage must have at least three threads in the barrel joint hole. Skip to **STEP 10** if equal length cannot be attained; you will need to adjust the shift lever on the splined shaft before continuing with **STEP 6**.

STEP 5 Ensure that barrel joint studs are perpendicular to the shift shaft.

STEP 6 Install rear barrel joint stud into threaded hole in the shifter rod lever.

STEP 7 Install front barrel joint stud into the hole in the splined shaft lever; install nut and tighten. See PIC. 4 and PIC. 8.

STEP 8 Check for proper clearance and operation.

CAUTION! Ensure that the installation of this product does not interfere with the proper operation of the motorcycle before riding.

ATTENTION! It is the installer's responsibility to ensure that all of the fasteners (including pre-assembled) are tightened before operation of the motorcycle. Kuryakyn will not warranty components lost due to improper installation. Periodic maintenance may be required.

TO ADJUST THE SPLINED SHIFT LEVER:

STEP 9 Remove bolt from stock shifter lever. See PIC. 5.

STEP 10 Pull shifter lever off splined shaft. See PIC. 6.

STEP 11 Install the rear barrel joint stud in the shifter rod lever; rotate splined shaft lever to match up with the front barrel joint stud of the shift linkage. See PIC. 7.

STEP 12 Align the splined shaft lever in the location that allows the front barrel joint to be perpendicular to the shift linkage; gently reinstall shift lever onto splined shaft.

STEP 13 Position the shift lever on the splines to ensure proper clearance and operation. Install stock bolt and tighten. Because of the coarse adjustment provided by the splined shaft, you may need to go back and readjust the shift linkage barrel joints to achieve proper clearance and operation.

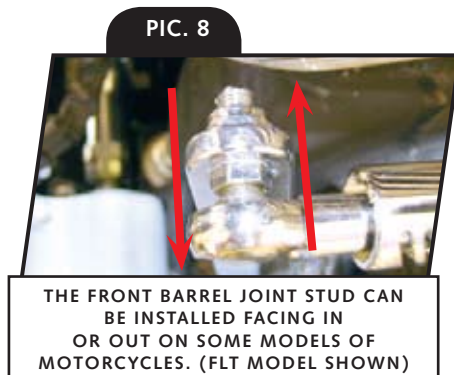
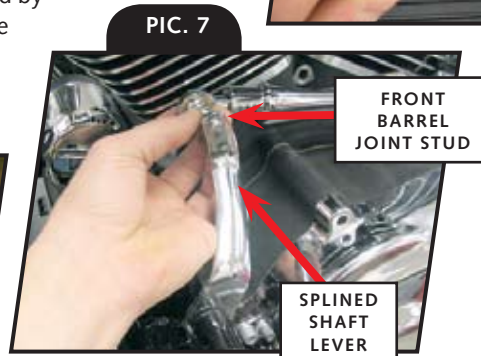
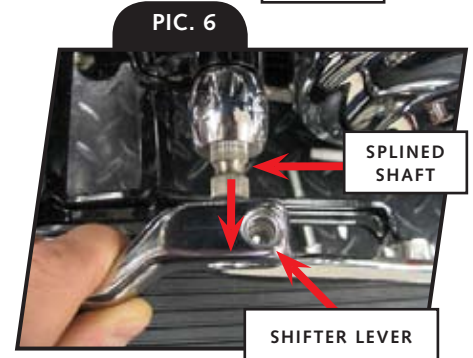
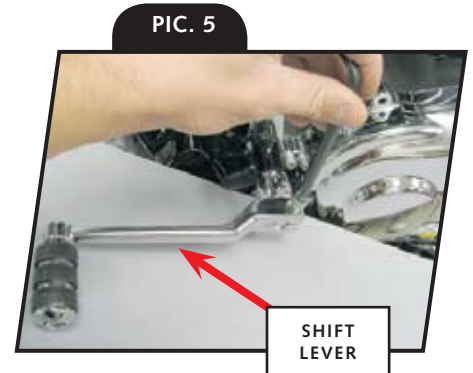
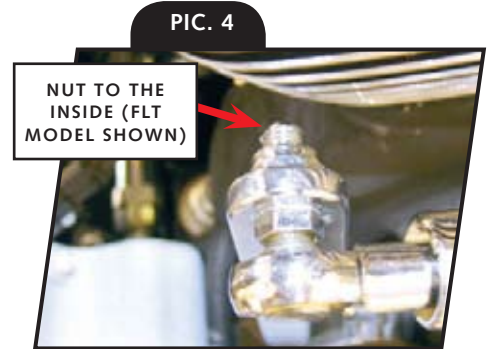
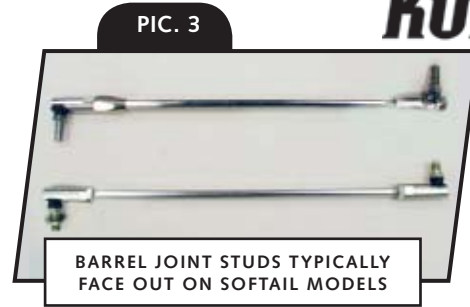

Ride On!