



**STARTER COVER**

**7847**

**FITS: '07-UP ROAD KING, ROAD GLIDE, AND STREET GLIDE (DOES NOT FIT SCREAMING EAGLE 110)**

**PARTS INCLUDED**

- 1 Starter Cover
- 1 Hardware Kit Including:
  - 2 M4 Narrow Washer
  - 2 M4 x .7 x 16mm Socket Head Cap Screw (SHCS)
- 1 Installation Instructions

*Please read and understand entire instructions before starting installation.*

**THANK YOU FOR CHOOSING KÜRYAKYN!**

**IN ORDER TO PROTECT YOU AND OTHERS FROM POSSIBLE INJURY AND/OR PROPERTY DAMAGE OR LOSS, PLEASE PAY CLOSE ATTENTION TO ALL INSTRUCTIONS, WARNINGS, CAUTIONS AND ATTENTION NOTES REGARDING THE USE AND CARE OF THIS PRODUCT.**

**WARNING!** THIS INDICATION ALERTS YOU TO THE FACT THAT IGNORING THE CONTENTS DESCRIBED HEREIN CAN RESULT IN POTENTIAL DEATH OR SERIOUS INJURY.

**TOOLS SUGGESTED**

Set of hex wrenches, combination wrenches or socket set and ratchet.

**STRICTLY OBSERVE THE FOLLOWING GUIDELINES IN ORDER TO USE THE PRODUCT PROPERLY AND AVOID POTENTIALLY DANGEROUS ACCIDENTS.**

**PROCEDURE**

**STEP 1** Park the motorcycle on a hard, level surface; turn off the ignition and allow the engine to cool.

**WARNING!** YOU WILL BE WORKING AROUND THE ENGINE AND EXHAUST SYSTEM DURING INSTALLATION. ENSURE THAT THE ENGINE AND EXHAUST SYSTEM HAVE FULLY COOLED TO PREVENT INJURY.

**STEP 2** Remove the stock chrome starter end cover (see PIC.1) save the screw it will be reused.

**STEP 3** Remove the top two solenoid cover screws shown in PIC.1.

**NOTE** There may be excess paint on the head of bolts that may need to be scraped off in order to remove

-cont.-

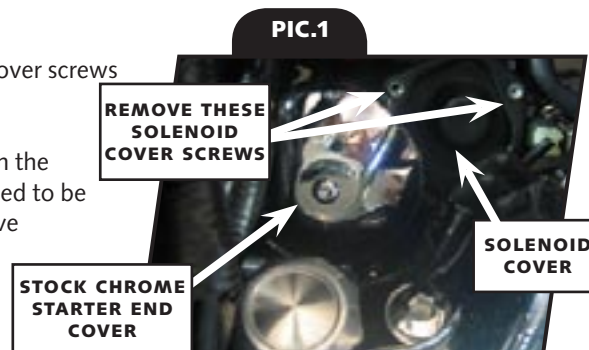

**STEP 4** Install the starter cover; line up the two holes with the holes in the solenoid cover and attach using the two M4 x .7 x 16mm SHCS screws and M4 washers.

**STEP 5** Reinstall the stock chrome starter end cover see [PIC.2](#).

**Kuryakyn**

*Ride On!*

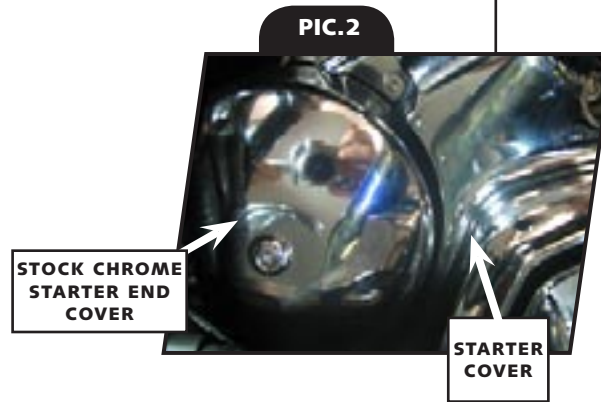

**PAGE**

**2**

**STARTER COVER** **INSTALLATION**