



TRI-LINE FUEL DOOR, CHROME

6968

Thank You For Choosing Kuryakyn!

Protect yourself and others from potential injury and property damage or loss. Pay close attention to all instructions, warnings, cautions, and notices regarding the installation, use, and care of this product.

NOTICE

This indication alerts you to the fact that ignoring the contents described herein may negatively affect product performance and functionality or damage the product itself or the product to which it is being attached.

ENSURE THAT THE FOLLOWING PARTS HAVE BEEN INCLUDED IN THE KIT:

- 1 Tri-Line Fuel Door
- 1 Installation Instructions

YOU WILL ALSO NEED:

Combination wrenches or nut drivers, and a 7/8" wrench.

NOTICE

These installation instructions contain important information. Ensure that the end user receives this copy and is aware of its importance for future use.

- STEP 1** Read and understand all steps in the instructions before starting the installation. Park the motorcycle on a hard, level surface and turn **IGN OFF**.

NOTICE

Avoid damage to the motorcycle. Protect painted surfaces with a soft cloth or blanket.

- STEP 2** Refer to **PIC 1**. Open the fuel door. Locate and remove the retaining nut that secures the lock mechanism; support the cover as the nut is removed.

Remove the lock mechanism from the fuel door; press the latch inward so it clears the opening; set it aside for now, it will be reused.

- STEP 3** Locate the hinge; remove the two screws, hinge, and fuel door.

Make note of the position of the hinge before removing it.

- STEP 4** Refer to **PIC 2**. Position the hinge on the Tri-Line Fuel Door as shown.

- STEP 5** Loosely secure the hinge to the Door with the two screws.

The hinge must be left loose enough to slide over the hinge pin on the motorcycle dash.

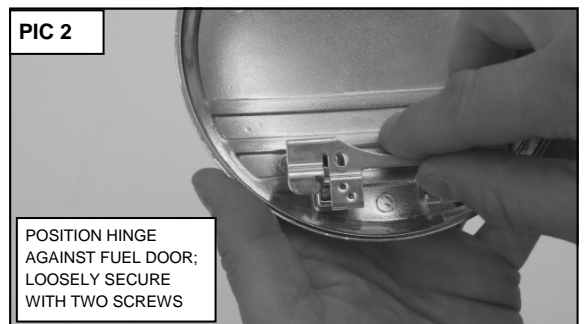
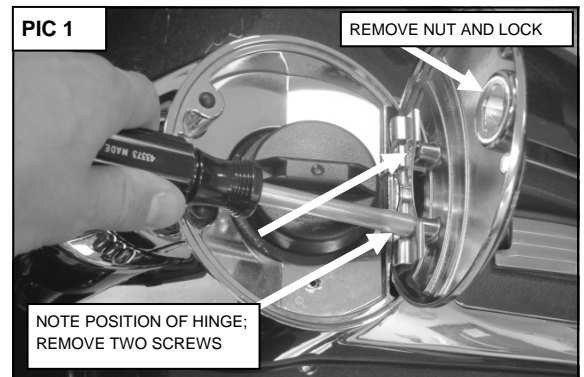



STEP 6 Refer to **PIC 3**. Carefully slide the Door assembly over the hinge pin.

STEP 7 Ensure that the hinge cups in the Door capture the hinge pin; align the hinge over the pin; tighten the screws.

STEP 8 Refer to **PIC 4**. Install the lock mechanism in the reverse order it was removed; ensure that the latch is aligned properly; tighten the nut. **Do not over tighten the nut.**

Loosen the nut and readjust the lock if the door does not remain closed when shut.

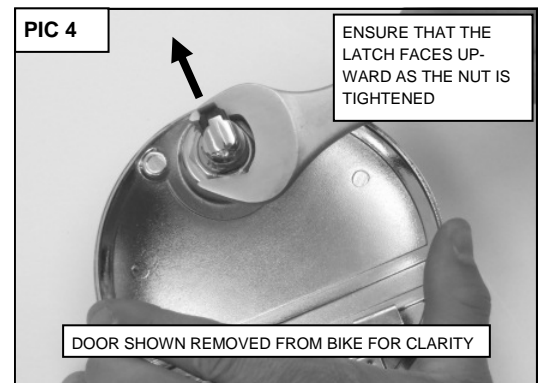
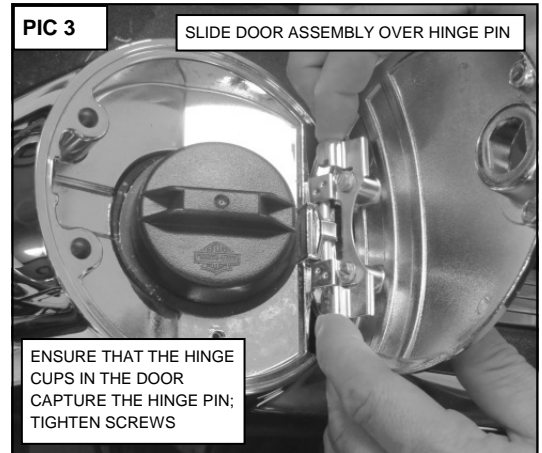

NOTICE

It is the end user's responsibility to ensure that all fasteners (including pre-assembled) are tightened before operation of the motorcycle. Kuryakyn will not provide warranty coverage on products or components lost or damaged due to improper installation or lack of maintenance. Periodic inspection and maintenance are required on all fasteners.