





PREMIUM ISO GRIPS with CONTOURED THROTTLE BOSS —CABLE

6342

THANK YOU FOR CHOOSING KÜRYAKYN!

PROTECT YOURSELF AND OTHERS FROM POSSIBLE INJURY AND PROPERTY DAMAGE OR LOSS. PAY CLOSE ATTENTION TO ALL INSTRUCTIONS, WARNINGS, CAUTIONS, AND NOTICES REGARDING THE INSTALLATION, USE, AND CARE OF THIS PRODUCT.

 WARNING	THIS INDICATION ALERTS YOU TO THE FACT THAT IGNORING THE CONTENTS DESCRIBED HEREIN CAN RESULT IN POTENTIAL DEATH OR SERIOUS INJURY.
 CAUTION	This indication alerts you to the fact that ignoring the contents described herein can result in minor or moderate potential injury.
 NOTICE	This indication alerts you to the fact that ignoring the contents described herein may negatively affect product performance and functionality or damage the product itself or the product to which it is being attached.

MAKE SURE THE FOLLOWING PARTS HAVE BEEN INCLUDED IN THE KIT:

- 1 Right Premium ISO Grip with Contoured Throttle Boss
- 1 Left Premium ISO Grip
- 1 Adhesive
- 1 Installation instructions

TOOLS SUGGESTED:

Set of Torx wrenches, set of hex wrenches, 80-100 grit sandpaper, ammonia based cleaner (Windex), and a clean rag

 **NOTICE** These installation instructions contain important information. Ensure that the end user receives this copy and is aware of its importance for future reference.

A factory service manual may be helpful in performing this installation. Do not attempt to perform this installation and consult a trained technician if you are not confident in your ability to complete all of the steps in these instructions.

STEP 1 Read and understand all steps in the instructions before starting the installation. Park the motorcycle on a hard, level surface and turn off the ignition.

BRAKE SIDE PROCEDURE:

STEP 2 Refer to **PIC 1**. Roll or slide the rubber throttle cable adjustment covers to gain access to the adjusters.

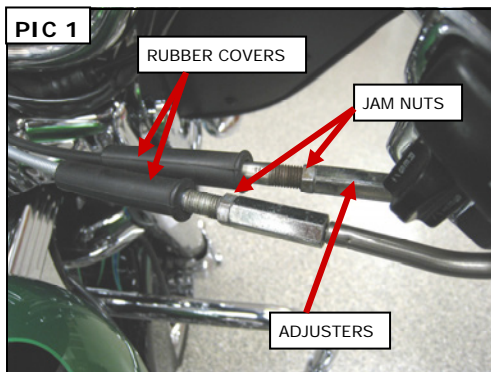

-cont.-

STEP 3 Refer to **PIC 1 on PAGE 1**. Loosen the jam nuts on the adjusters on both cables; turn the jam nuts and adjusters until the throttle control is at its loosest point.

STEP 4 Refer to **PIC 2**. Separate the brake-side switch housing by removing the two Torx screws; set them aside, they will be re-used. You may also have to loosen the screws on the brake clamp to separate the switch housing halves.

STEP 5 Refer to **PIC 3**. Lift up on the rear cable where it fits into the throttle sleeve; this will provide enough slack in the cable to remove the cable end and brass ferrule from the throttle sleeve. **Be careful not to lose the brass ferrules; they are not permanently attached to the cables.**

STEP 6 Repeat **STEP 5** for the other cable.

STEP 7 Slide the stock grip/throttle sleeve assembly off the handlebar. Set it aside.

STEP 8 Slide the new ISO Grip onto the handlebar. Install the throttle cables in the reverse order they were removed in **STEPS 5 and 6**.

NOTE: **Ensure that the throttle cables have been properly lubricated and do not show signs of wear before reassembly.**

STEP 9 Re-assemble the switch housing halves and secure them with the screws removed in **STEP 4**. Tighten the screws on the brake clamp if they were loosened in **STEP 4**.

STEP 10 Adjust the throttle cables and tighten the jam nuts. **Ensure proper throttle cable adjustment and throttle operation before riding the motorcycle.** Refer to your model owners' manual or service manual for more information.

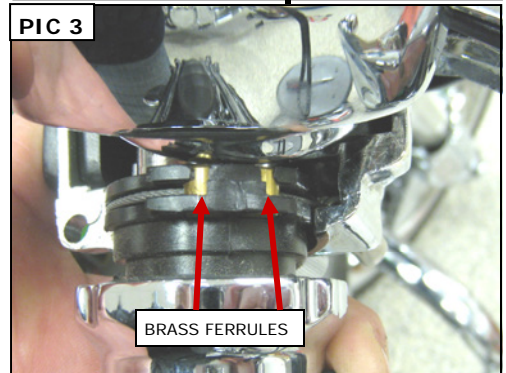
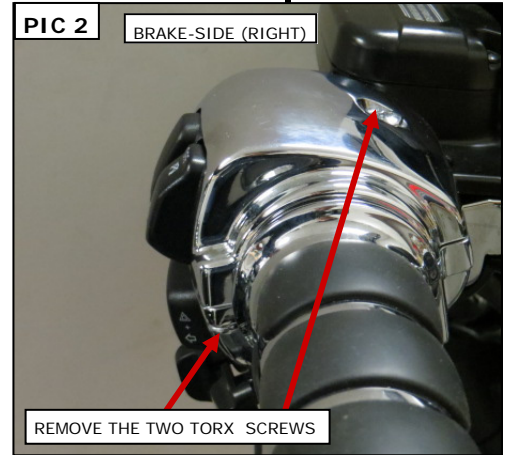

ROTATE THROTTLE AND CHECK THAT IT MOVES FREELY AND RETURNS TO CLOSED BEFORE STARTING BIKE. FAILURE TO PROPERLY ADJUST THE THROTTLE CABLES COULD RESULT IN LOSS OF CONTROL CAUSING SERIOUS INJURY OR DEATH.

CLUTCH SIDE PROCEDURE:

STEP 11 Separate the clutch-side switch housings by removing the two Torx screws; set them aside, they will be re-used. You may also have to loosen the clutch control clamp to allow the switch halves to separate.

STEP 12 Remove the clutch side grip. A sharp knife may be used to cut the grip lengthwise allowing you to "peel" the stock grip from the handlebar.

STEP 13 Prepare the clutch-side handlebar for proper adhesion by sanding the surface with 80-100 grit sandpaper or emery cloth. Remove all glue and rubber residue from the handlebar.

STEP 14 With an ammonia based cleaner (Windex) and a clean rag, remove any contaminants from the handlebar and the inside of the grip.

-cont.-

NOTE: Determine the desired orientation of the clutch-side grip **BEFORE** gluing and installing.

The adhesive supplied sets up **ALMOST INSTANTLY** in the absence of air. There is enough time to slide the grip into place, but **ONCE IT STOPS MOVING, IT CANNOT BE ADJUSTED.**

STEP 16 Open the supplied tube of adhesive and squeeze all of the glue onto the inner side walls of the clutch-side grip. Rotating the grip while applying the glue will help distribute it evenly. Make sure you get the glue all the way to the end of the rubber insert in the grip.

STEP 17 In one smooth motion, slide the grip onto the handlebar and into position. Rotate it back and forth slightly as you slide it on to help distribute the glue evenly and keep the grip from “plowing” the glue up against the switch housing. **You must work quickly to get the desired position before the glue dries. (Approx. 6 seconds).**

STEP 18 Once in place, squeeze the grip firmly to press the rubber against the bar and hold for 15 seconds. Allow at least 30 minutes to cure before operating the motorcycle. **Ensure proper operation and clearance BEFORE operating the motorcycle.**

STEP 19 Re-assemble the switch housing halves and secure them with the screws removed in **STEP 11**. Tighten the clutch control clamp if it was loosened in **STEP 11**.

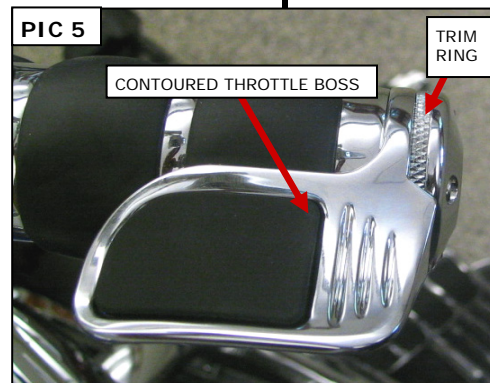
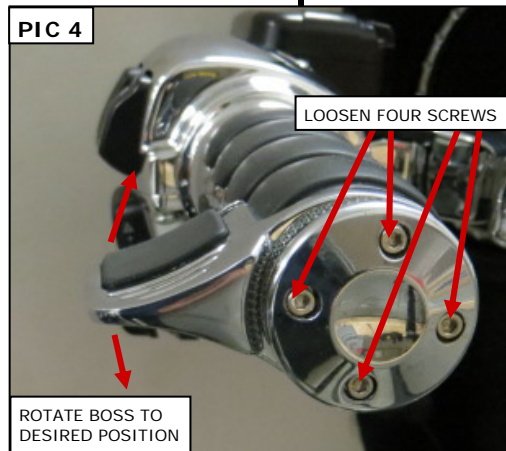

ROTATE THROTTLE AND CHECK THAT IT MOVES FREELY AND RETURNS TO CLOSED BEFORE STARTING BIKE. FAILURE OF THE THROTTLE TO PROPERLY RETURN COULD RESULT IN LOSS OF CONTROL CAUSING SERIOUS INJURY OR DEATH.



Ensure that the installation of this product does not interfere with the proper operation of the motorcycle before riding.



It is the end user’s responsibility to ensure that all of the fasteners (including pre-assembled) are tightened before operation of the motorcycle. Kuryakyn will not provide warranty coverage on products or components lost due to improper installation or lack of maintenance. Periodic inspection and maintenance are required on all fasteners.

THROTTLE BOSS ADJUSTMENT PROCEDURE:

STEP 20 Refer to **PICs 4 and 5**. Loosen the socket head cap screws in the end of the grip.

STEP 21 Refer to **PICs 4 and 5**. Adjust the position of the throttle boss as desired and retighten the screws; **do not over tighten the screws.**

Ride On!