

INSTALLATION INSTRUCTIONS

HEX MIRRORS, CHROME

5918

THANK YOU FOR CHOOSING KURYAKYN!

Protect yourself and others from possible injury and property damage or loss. Pay close attention to all instructions, warnings, cautions, and notices regarding the installation, use, and care of this product.

WARNING THIS INDICATION ALERTS YOU TO THE FACT THAT IGNORING THE CONTENTS DESCRIBED HEREIN CAN RESULT IN POTENTIAL DEATH OR SERIOUS INJURY.

CAUTION THIS INDICATION ALERTS YOU TO THE FACT THAT IGNORING THE CONTENTS DESCRIBED HEREIN CAN RESULT IN MINOR OR MODERATE POTENTIAL INJURY.

NOTICE THIS INDICATION ALERTS YOU TO THE FACT THAT IGNORING THE CONTENTS DESCRIBED HEREIN MAY NEGATIVELY AFFECT PRODUCT PERFORMANCE AND FUNCTIONALITY OR DAMAGE THE PRODUCT ITSELF OR THE PRODUCT TO WHICH IT IS BEING ATTACHED.

ENSURE THAT THE FOLLOWING PARTS HAVE BEEN INCLUDED IN THE KIT:

- | | | | |
|---|--------------|---|--------------------------------------|
| 1 | Left Mirror | 1 | Hardware Kit, containing: |
| 1 | Right Mirror | 2 | 5-16-18X 1.5" Socket Head Cap Screws |
| | | 2 | 5-16-18 X 2" Socket Head Cap Screws |
| | | 2 | Double Ended Threaded Studs |
| | | 2 | 5/16 Split Lock Washers |
| | | 2 | 5/16 Internal Tooth Lock Washers |

YOU WILL ALSO NEED:

Hex wrench set, combination wrench set, Red Loctite

NOTICE THESE INSTALLATION INSTRUCTIONS CONTAIN IMPORTANT INFORMATION. ENSURE THE END USER RECEIVES THIS COPY AND IS AWARE OF ITS IMPORTANCE FOR FUTURE USE.

STEP 1 Read and understand all steps in the instructions before starting the installation. Park the motorcycle on a hard, level surface and turn off the ignition. Let motorcycle cool.

Note: Mirror adapters (sold separately) are required for installation on metric cruisers.

NOTICE AVOID DAMAGE TO THE MOTORCYCLE. PROTECT PAINTED SURFACES WITH A SOFT CLOTH OR BLANKET.

NOTICE ENSURE THAT THE POSITION OF THE MIRROR AND STEM DO NOT INTERFERE WITH THE OPERATION OF THE MOTORCYCLE HAND CONTROLS.

NOTICE IT IS THE INSTALLER'S RESPONSIBILITY TO ENSURE THAT ALL OF THE FASTENERS (INCLUDING PRE-ASSEMBLED) ARE TIGHTENED BEFORE OPERATION OF THE MOTORCYCLE. KURYAKYN WILL NOT PROVIDE WARRANTY COVERAGE ON PRODUCTS OR COMPONENTS LOST DUE TO IMPROPER INSTALLATION OR LACK OF MAINTENANCE. PERIODIC INSPECTION AND MAINTENANCE ARE REQUIRED ON ALL FASTENERS

STEP 2 Remove existing mirrors from controls; set them aside, they will not be reused.

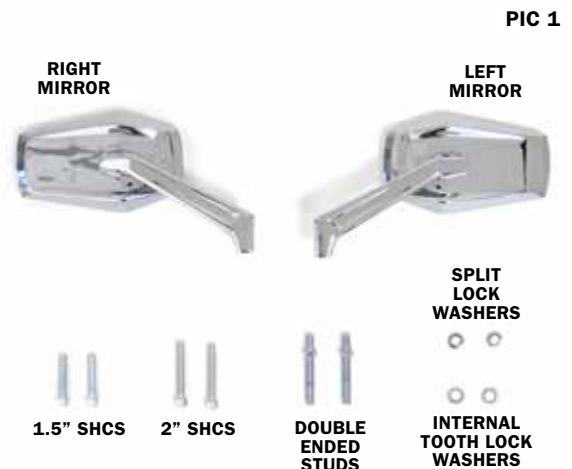

INSTALLATION INSTRUCTIONS

HEX MIRRORS, CHROME

5918

-CONTINUED-

MOUNTING WITH SINGLE SCREW

- STEP 3** Determine which of the included socket head cap screws from the hardware kit will provide maximum thread engagement in the mirror stem without bottoming out. Apply a small amount of Red Loctite to the screws that will be used.
- STEP 4** Refer to FIG 1. Place a split lock washer over the socket head cap screw and insert it in the hole in the hand control.
- STEP 5** Place an internal lock washer over the protruding end of the cap screw.
- STEP 6** While holding the mirror in place, thread the socket head cap screw into the bottom of the mirror stem.
- STEP 7** Adjust the position of the mirror stem for visibility and clearance; tighten the socket head cap screw.
- STEP 8** Repeat steps 3 through 7 for the opposite side.

FIG 1

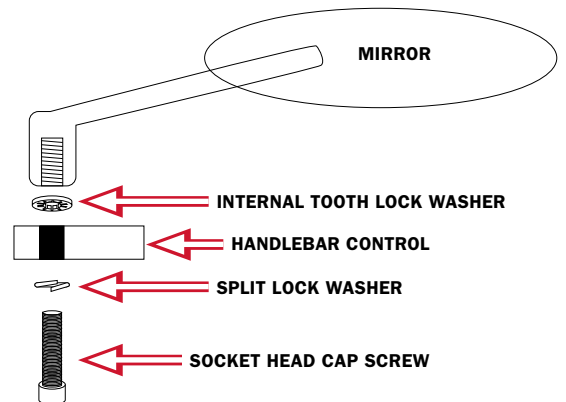

H-D WITH BOTTOM MOUNTED TURN SIGNALS



CAUTION

REMOVING THE RETAINER NUT AND/OR THE BALL STUD CLAMP IN THE NEXT STEP WILL RELEASE THE TURN SIGNALS FROM THE HAND CONTROLS. SECURE THE TURN SIGNALS TO PREVENT DAMAGE OR INJURY.

FIG 2

- STEP 9** Refer to FIG 2. Starting on the right (brake) side. Loosen and remove the retainer nut and ball stud clamp.
- STEP 10** Remove the stock mirror; hold the stock turn signal to prevent it from being damaged.
- STEP 11** Refer to FIG 2. Locate a provided double end stud. Apply a small amount of Red Loctite to the shorter side of the stud. Screw the short side of the double ended stud into the new mirror stem and fully tighten.
- STEP 12** Refer to FIG 2. Place an internal lock washer over the long end of one of the double-ended studs; insert the assembly into the mirror stem hole in the hand control.
- STEP 13** Refer to FIG 2. Place a split lock washer over the protruding end of the double-ended stud and thread the retainer nut onto the stud.
- STEP 14** Adjust the position of the mirror stem for visibility and clearance; tighten the retaining nut.
- STEP 15** Install the ball stud clamp onto the retainer nut; adjust the turn signal and tighten the clamp.
- STEP 16** Repeat steps 9 through 15 for the left side.
- STEP 17** Adjust the mirrors for proper view before riding the motorcycle.

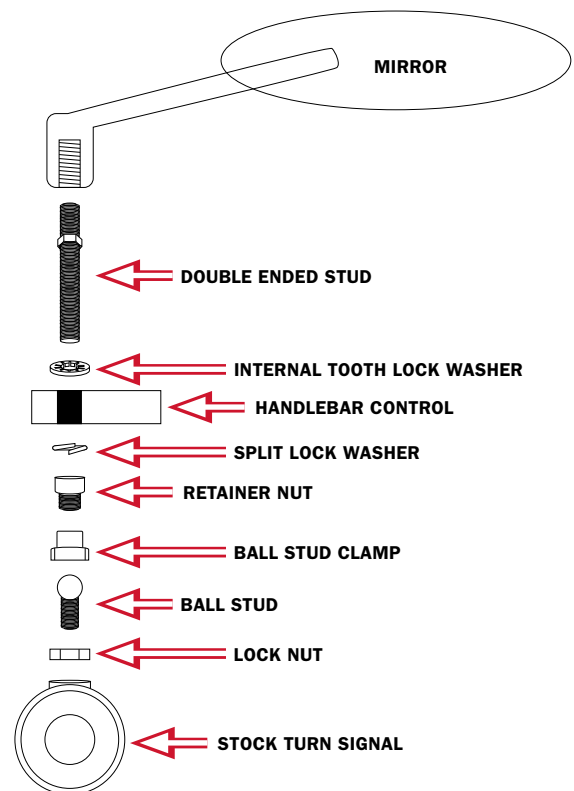



INSTALLATION INSTRUCTIONS

HEX MIRRORS, CHROME

5918

-CONTINUED-

NOTICE

IT IS THE INSTALLER'S RESPONSIBILITY TO ENSURE THAT ALL OF THE FASTENERS (INCLUDING PRE-ASSEMBLED) ARE TIGHTENED BEFORE OPERATION OF THE MOTORCYCLE. KURYAKYN WILL NOT PROVIDE WARRANTY COVERAGE ON PRODUCTS OR COMPONENTS LOST DUE TO IMPROPER INSTALLATION OR LACK OF MAINTENANCE. PERIODIC INSPECTION AND MAINTENANCE ARE REQUIRED ON ALL FASTENERS.