

## INSTALLATION INSTRUCTIONS

### SPEAR DRIVER FLOORBOARD INSERTS FOR INDIAN, CHROME

5650

#### THANK YOU FOR CHOOSING KURYAKYN!

Protect yourself and others from possible injury and property damage or loss. Pay close attention to all instructions, warnings, cautions, and notices regarding the installation, use, and care of this product.

**WARNING** THIS INDICATION ALERTS YOU TO THE FACT THAT IGNORING THE CONTENTS DESCRIBED HEREIN CAN RESULT IN POTENTIAL DEATH OR SERIOUS INJURY.

**CAUTION** THIS INDICATION ALERTS YOU TO THE FACT THAT IGNORING THE CONTENTS DESCRIBED HEREIN CAN RESULT IN MINOR OR MODERATE POTENTIAL INJURY.

**NOTICE** THIS INDICATION ALERTS YOU TO THE FACT THAT IGNORING THE CONTENTS DESCRIBED HEREIN MAY NEGATIVELY AFFECT PRODUCT PERFORMANCE AND FUNCTIONALITY OR DAMAGE THE PRODUCT ITSELF OR THE PRODUCT TO WHICH IT IS BEING ATTACHED.

#### ENSURE THAT THE FOLLOWING PARTS HAVE BEEN INCLUDED IN THE KIT:

- |   |                          |   |                                       |
|---|--------------------------|---|---------------------------------------|
| 1 | Spear Floorboard Inserts | 1 | Hardware Kit, containing:             |
|   |                          | 4 | Spacers                               |
|   |                          | 4 | M10 x 1.5 x 40 Socket Head Cap Screws |

#### YOU WILL ALSO NEED:

Pliers, hex bit sockets and a ratchet, FT LBS (NM) torque wrench, dish soap

**NOTICE** THESE INSTALLATION INSTRUCTIONS CONTAIN IMPORTANT INFORMATION. ENSURE THE END USER RECEIVES THIS COPY AND IS AWARE OF ITS IMPORTANCE FOR FUTURE USE.

**STEP 1** Read and understand all steps in the instructions before starting the installation. Park the motorcycle on a hard, level surface and turn off the ignition. Let motorcycle cool. Remove main fuse.

**WARNING** THE END USER'S SAFETY DEPENDS UPON PROPER INSTALLATION OF THIS PRODUCT. IF A STEP IN THESE INSTRUCTIONS IS NOT WITHIN YOUR CAPABILITIES OR YOU DO NOT HAVE THE CORRECT TOOLS, HAVE YOUR DEALER PERFORM THE PROCEDURE. IMPROPER INSTALLATION OF THIS PRODUCT COULD RESULT IN DEATH OR SERIOUS INJURY.

ACCIDENTAL VEHICLE START-UP COULD CAUSE DEATH OR SERIOUS INJURY, REMOVE THE MAIN FUSE BEFORE PROCEEDING.

**STEP 2** Refer to PIC 1. Pry the existing rubber floorboard pad out; it will not be reused. Repeat for the other side.

**STEP 3** Refer to PIC 2. Locate two of the included Spacers and Screws. Loosen the two screws holding the bracket mount. Remove one of the existing screws, slide a Spacer in between the mount and frame and begin threading a provided screw into the hole.

**STEP 4** Remove the other screw and slide a Spacer in between the mount and frame; install provided screw.

**STEP 5** Tighten both screws and torque them to 35 FT LBS (47.5 NM).

**STEP 6** Repeat STEPS 3 through 5 for the other side.

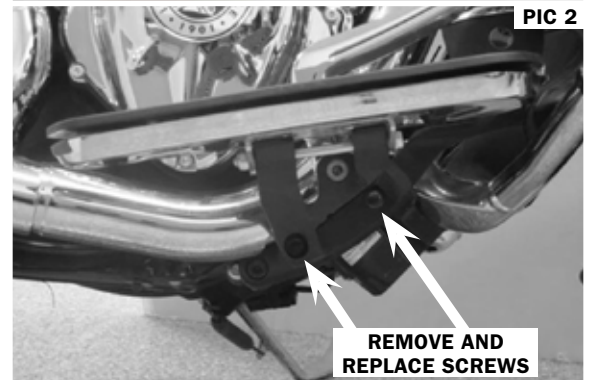

## INSTALLATION INSTRUCTIONS

### SPEAR DRIVER FLOORBOARD INSERTS FOR INDIAN, CHROME

5650

-CONTINUED-

- STEP 7** Locate one (1) of the included Spear Floorboard Inserts; apply dish soap to the isolator flanges to ease installation; align the four (4) isolators over the existing floorboard pan.
- STEP 8** Refer to PIC 3 and 4. Press downward on the Insert; GENTLY pull the four (4) isolator flanges through the bottom of the floorboard pan; ensure that the flanges have been completely pulled through the hole.
- Repeat for the other side.
- STEP 9** Reinstall the main fuse. Ensure that the new Inserts do not interfere with the operation of the motorcycle before riding.

#### NOTICE

IT IS THE INSTALLER'S RESPONSIBILITY TO ENSURE THAT ALL OF THE FASTENERS (INCLUDING PRE-ASSEMBLED) ARE TIGHTENED BEFORE OPERATION OF THE MOTORCYCLE. KURYAKYN WILL NOT PROVIDE WARRANTY COVERAGE ON PRODUCTS OR COMPONENTS LOST DUE TO IMPROPER INSTALLATION OR LACK OF MAINTENANCE. PERIODIC INSPECTION AND MAINTENANCE ARE REQUIRED ON ALL FASTENERS.

