



STILETTO FOOTPEGS-MALE MOUNT

4475

PARTS INCLUDED

- 1 Left Stiletto Peg with Male Mount
- 1 Right Stiletto Peg with Male Mount
- 1 Installation Instructions

Please read and understand entire instructions before starting installation.

THANK YOU FOR CHOOSING KÜRYAKYN!

IN ORDER TO PROTECT YOU AND OTHERS FROM POSSIBLE INJURY AND/OR PROPERTY DAMAGE OR LOSS, PLEASE PAY CLOSE ATTENTION TO ALL INSTRUCTIONS, WARNINGS, CAUTIONS AND NOTICES REGARDING THE USE AND CARE OF THIS PRODUCT.

WARNING	THIS INDICATION ALERTS YOU TO THE FACT THAT IGNORING THE CONTENTS DESCRIBED HEREIN CAN RESULT IN POTENTIAL DEATH OR SERIOUS INJURY.
NOTICE	This indication alerts you to the fact that ignoring the contents described herein may negatively affect product performance and functionality.

NOTICE	IF INSTALLING THIS PRODUCT FOR ANOTHER PARTY, PLEASE MAKE SURE THEY RECEIVE THIS COPY OF THE INSTALLATION INSTRUCTIONS SO THEY ARE AWARE OF THE IMPORTANT INFORMATION CONTAINED IN THEM.
---------------	---

TOOLS SUGGESTED

Set of Combination Wrenches, Set of Hex Wrenches

STRICTLY OBSERVE THE FOLLOWING GUIDELINES IN ORDER TO USE THE PRODUCT PROPERLY AND AVOID POTENTIALLY DANGEROUS ACCIDENTS.

STEP 1 Read and understand all steps in the instructions before starting the installation. Park the motorcycle on a hard, level surface and turn off the ignition. Let cool.

NOTE: Optional domed end caps are available to replace the pointed end caps. (Sold separately)

WARNING	YOU WILL BE WORKING AROUND THE ENGINE AND EXHAUST SYSTEM DURING INSTALLATION. ENSURE THAT THE ENGINE AND EXHAUST SYSTEM HAVE FULLY COOLED TO PREVENT INJURY.
----------------	---

WARNING	A FACTORY SERVICE MANUAL WILL BE HELPFUL IN PERFORMING THIS INSTALLATION. DO NOT ATTEMPT TO PERFORM THIS INSTALLATION IF YOU ARE NOT CONFIDENT IN YOUR ABILITY TO COMPLETE ALL OF THE STEPS IN THE PROCEDURE; CONSULT A TRAINED TECHNICIAN. IMPROPER INSTALLATION COULD RESULT IN SERIOUS INJURY OR DEATH.
----------------	---

STEP 2 Remove the stock peg from the clevis. Pay attention to any spacers or washers installed between the male mount and the clevis, it may be helpful later. Set this hardware aside, it will be reused.

-cont.-

NOTE: PIC 1 shows the correct orientation of the left and right (sitting on bike) peg.

STEP 3 Install the new peg using any spacers or washers removed in Step 2. Line up the new peg mount hole with the hole in the clevis.



STEP 4 Secure the peg in the clevis using OEM hardware removed in Step 2. Check that the peg is installed correctly and is able to fold upward.

⚠ WARNING FOOTPEGS MUST BE INSTALLED SO THEY WILL FOLD UPWARD AND REARWARD IF HIT BY ANY OBJECT. FAILURE TO ADJUST THE FOOTPEGS TO OPERATE IN THIS MANNER COULD RESULT IN SERIOUS INJURY OR DEATH.

STEP 5 Repeat Steps 2 through 4 for the other peg.

⚠ WARNING EVEN IF THE STILETTO PEGS APPEAR TO BE POSITIONED CORRECTLY, YOU MUST COMPLETE THE FOLLOWING STEPS. IT IS IMPERATIVE THE 5/16"–18 X 2" SOCKET HEAD CAP SCREWS (FIG 1-D) ARE TIGHTENED SECURELY SO THE PEGS CANNOT ROTATE OR FALL OFF DURING WHILE IN USE. FAILURE TO DO SO COULD RESULT IN SERIOUS INJURY OR DEATH.

ADJUSTING THE POSITION OF THE FOOTPEG:

STEP 6 With a hex wrench, remove the #5–40 x 3/8" socket head cap screws, FIG 1-A, pointed end cap, FIG 1-B, and knurled trim ring, FIG 1-C from one of the Stiletto Pegs. Remove the end rubber from the peg body, FIG 1-F, to expose the 5/16"–18 x 2" socket head cap screw FIG 1-D.

STEP 7 With a long hex socket, loosen the 5/16"–18 x 2" socket head cap screw. Adjust the angle of the peg so the rider's or passenger's foot rests squarely on the rubber pads when seated on the motorcycle. Securely tighten the 5/16"–18 x 2" socket head cap screw once the adjustment is complete.

⚠ WARNING CHECK TO MAKE SURE THAT THERE IS PROPER GROUND CLEARANCE WHEN CORNERING. LOSS OF CONTROL OF THE MOTORCYCLE AND SERIOUS INJURY MAY OCCUR IF THE FOOTPEG IS NOT POSITIONED PROPERLY. REPOSITION THE FOOTPEG IF NECESSARY SO THAT THERE IS ADEQUATE CORNERING CLEARANCE.

STEP 8 Reinstall end rubber, knurled trim ring, end cap, and the #5–40 x 3/8" socket head cap screws.

STEP 9 Repeat STEP 6 through STEP 8 for the other Peg.

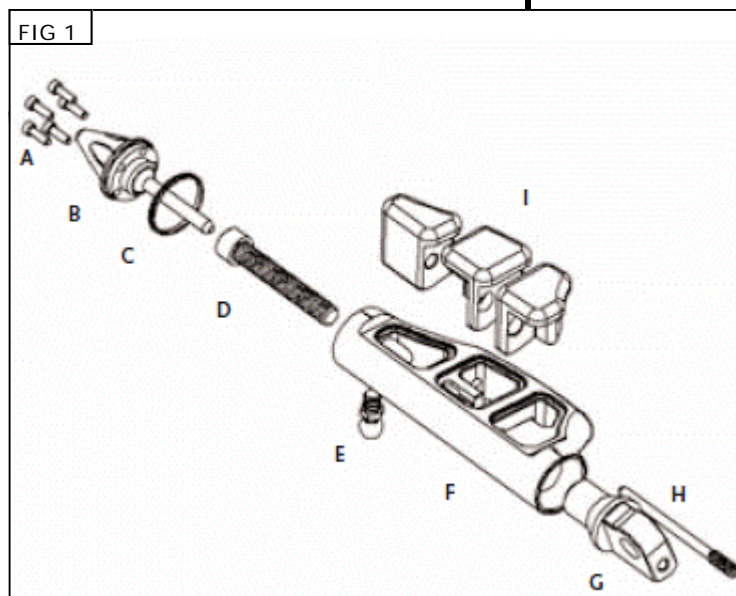

NOTICE It is the installer's responsibility to ensure that all of the fasteners (including pre-assembled) are tightened before operation of the motorcycle. Kuryakyn will not provide warranty coverage on products or components lost due to improper installation or lack of maintenance. Periodic inspection and maintenance are required on all fasteners.

Ride On!