



PILOT PEGS WITH STIRRUPS 4428

FITS: '84-UP H-D BIG TWIN, 91-UP XL'S 'USING MALE MOUNT PEGS

PARTS INCLUDED

- 1 Left Pilot Peg w/ Stirrup Assembly
- 1 Right Pilot Peg w/ Stirrup Assembly
- 1 Installation Instructions

Please read and understand entire instructions before starting installation.

THANK YOU FOR CHOOSING KÜRYAKYN!

PLEASE NOTE

It is the installers' responsibility to make sure all fasteners (including pre-assembled) are tightened before operation of motorcycle. Kuryakyn will not warranty components that are lost due to improper installation. Periodic maintenance may be required.

TOOLS SUGGESTED

Allen wrenches, adjustable wrench or 1 1/8" wrench.

ATTENTION! A factory service manual may be helpful in performing this installation. Do not attempt to perform this installation if you are not confident in your ability to complete all steps in the procedure; consult a trained technician.

CAUTION! Prevent potential serious injuries! Be sure all fasteners are secure before riding and that the new components do not interfere with the proper operation of the shift or brake.

PROCEDURE

STEP 1 Remove the existing foot peg; save the mounting hardware.

STEP 2 Install the Pilot Peg with Stirrup Assembly using the existing hardware. See PIC.1. Be sure to install the D-washer(s) between the peg adapter and the clevis. Tighten nut.

TO ADJUST THE POSITION OF THE STIRRUP ARM:

STEP 3 On the foot peg, loosen the front two screws. Remove the top plastic pad. See PIC.2.

STEP 4 Remove brass fastener. Pull only upper rubber pad off of peg. See PIC.1.

-cont.-

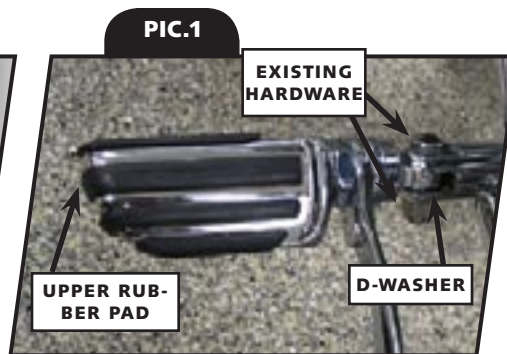
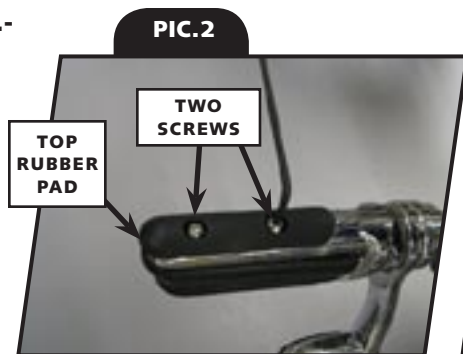

STEP 5 Loosen internal fastener enough to allow access with a wrench to the large nut securing the splined section of the stirrup arm. See [PIC.3](#).

STEP 6 Loosen large nut enough to disengage splines. Adjust stirrup arm for clearance and comfort. See [PIC.4](#) and [PIC.5](#). Retighten large nut.

STEP 7 Adjust Pilot peg for comfort; retighten internal fastener.

STEP 8 Reinstall upper rubber pad and secure with the brass fastener.

STEP 9 Reinstall top plastic pad and secure with the two screws.

STEP 10 Repeat STEP 1 through STEP 9 for the opposite side.

REPLACING THE RUBBER PADS ON THE STIRRUP:

STEP 11 Remove the two set screws in the bottom of each stirrup. See [PIC.6](#).

STEP 12 Remove the old rubber pads and replace with new rubber pads.

STEP 13 Install the set screws and secure.

REPLACING THE PADS ON THE FOOT PEG:

STEP 14 Remove the two screws on the top of each foot peg. See [PIC.6](#).

STEP 15 Remove the old top plastic pad.

STEP 16 Remove brass fastener; pull out old rubber and plastic pads.

STEP 17 Replace the rubber pads.

STEP 18 Replace bottom plastic pad; secure with brass fastener.

STEP 19 Replace top plastic pad; secure with two screws.

PIC.3

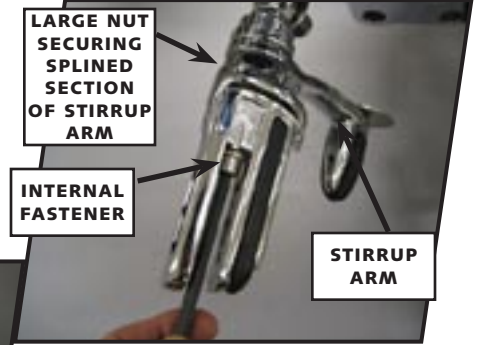

PIC.4

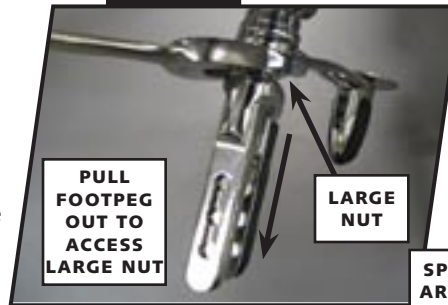

PIC.5



PIC.6

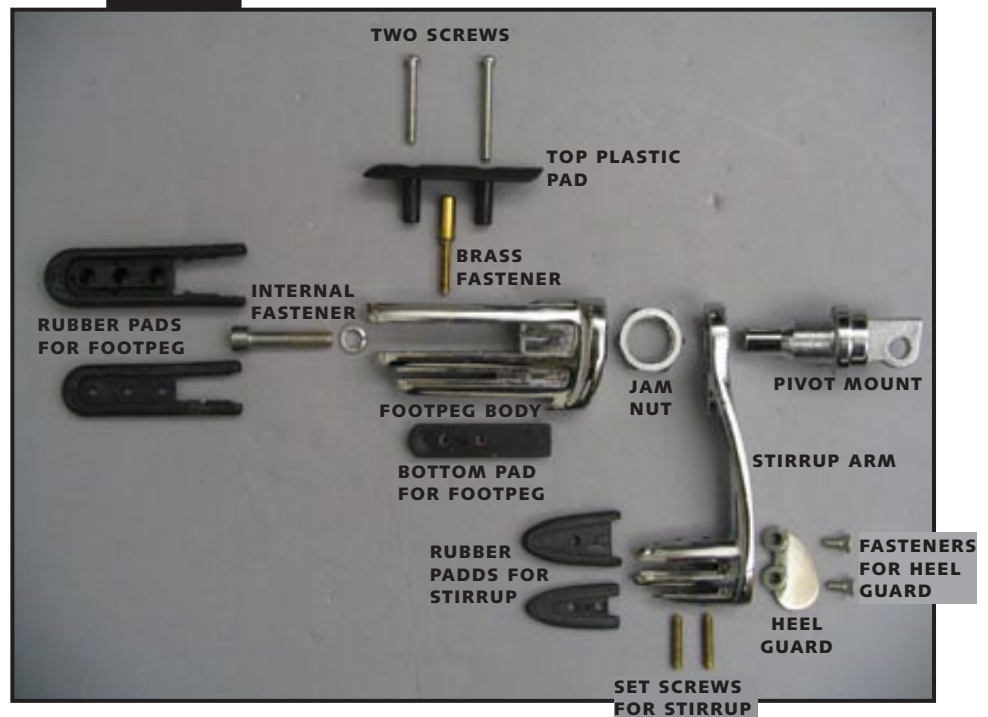

Ride On!