



FLAMIN' SHIFT PEG

4418

FITS: ALL H-D SHIFT LEVERS - NOT FOR USE WITH KURYAKYN XL FWD CONTROL (P/N 9077, 9078, 9080 AND 9081)

PARTS INCLUDED

- 1 Flamin' Shift Peg
- 1 5/16-24 x 1 Hex Head Cap Screw
- 1 Installation Instructions

Please read and understand entire instructions before starting installation.

THANK YOU FOR CHOOSING KÜRYAKYN!

IN ORDER TO PROTECT YOU AND OTHERS FROM POSSIBLE INJURY AND/OR PROPERTY DAMAGE OR LOSS, PLEASE PAY CLOSE ATTENTION TO ALL INSTRUCTIONS, WARNINGS, CAUTIONS AND ATTENTION NOTES REGARDING THE USE AND CARE OF THIS PRODUCT.

CAUTION! This indication alerts you to the fact that ignoring the contents described herein can result in potential injury or material damage.

ATTENTION! This indication alerts you to the fact that ignoring the contents described herein may negatively affect product performance and functionality.

TOOLS SUGGESTED

Combination wrenches, large pliers and a clean rag.

STRICTLY OBSERVE THE FOLLOWING GUIDELINES IN ORDER TO USE THE PRODUCT PROPERLY AND AVOID POTENTIALLY DANGEROUS ACCIDENTS.

PROCEDURE

STEP 1 Read and understand all steps in the instructions before starting the installation. Park the motorcycle on a hard, level surface and turn off the ignition.

STEP 2 Remove the existing shift peg. Use large pliers to grab the stock peg; turn the peg counter-clockwise to remove (PIC. 1). The shift lever has been removed from the bike for clarity, it is not necessary to remove the entire lever.

STEP 3 Thread the 5/16-24 HHCS into the shift lever until it is all the way through the threaded portion of the lever.

STEP 4 Thread the Flamin' Shift Peg onto the 5/16-24 HHCS as shown in PIC. 2.

STEP 5 Adjust the position of the Flamin' Shift Peg for comfort and then tighten the 5/16-24 HHCS. Wrap a clean rag over the Flamin' Shift Peg and hold it with the large pliers while you tighten the 5/16-24 HHCS to prevent the peg from turning.

-cont.-

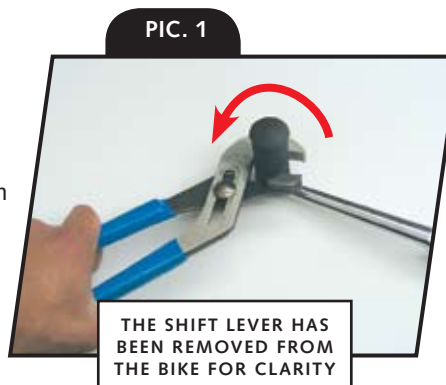

CAUTION! Avoid damage to the motorcycle. Protect chrome surfaces with a soft cloth or blanket.

ATTENTION! It is the installer's responsibility to ensure that all of the fasteners (including pre-assembled) are tightened before operation of the motorcycle. Kuryakyn will not warranty components lost due to improper installation. Periodic maintenance may be required.

Kuryakyn[®]

CAUTION! Ensure that the installation of this product does not interfere with the proper operation of the motorcycle before riding.

Ride On!

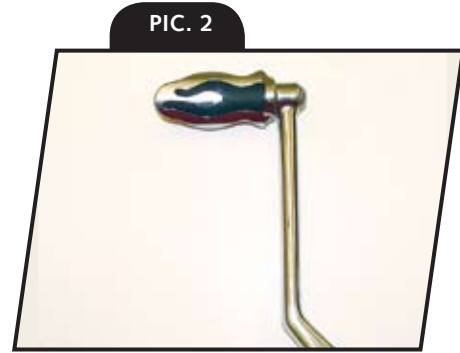

PAGE
2

FLAMIN' SHIFT PEG **INSTALLATION**

Buy quality motorcycle foot controls and pegs in our online store.