



### WINDSHIELD CENTER TRIM FOR ROAD GLIDE, CHROME

2634

#### Thank You For Choosing Küryakyn!

Protect yourself and others from potential injury and property damage or loss. Pay close attention to all instructions, warnings, cautions, and notices regarding the installation, use, and care of this product.

#### **WARNING**

THIS INDICATION ALERTS YOU TO THE FACT THAT IGNORING THE CONTENTS DESCRIBED HEREIN CAN RESULT IN POTENTIAL DEATH OR SERIOUS INJURY.

#### **NOTICE**

This indication alerts you to the fact that ignoring the contents described herein may negatively affect product performance and functionality or damage the product itself or the product to which it is being attached.

#### ENSURE THAT THE FOLLOWING PARTS HAVE BEEN INCLUDED IN THE KIT:

- 1 Windshield Center Trim
- 1 Installation Instructions

#### YOU WILL ALSO NEED:

Phillipshead screwdriver, warm, soapy water and clean rag

- STEP 1** Read and understand all steps in the instructions before starting the installation. Park the motorcycle on a hard, level surface and turn **IGN OFF**.

#### **NOTICE**

These installation instructions contain important information. Ensure that the end user receives this copy and is aware of its importance for future use.

- STEP 2** Remove the existing screws that secure the windshield to the outer fairing; save them, they will be reused. Set the fairing on a soft, clean work surface.

- STEP 3** Refer to **PIC 1**. Using warm, soapy water and a clean rag, remove all dirt and debris from the installation area; rinse and allow the area to dry completely.

Clean the windshield with warm, soapy water; rinse and allow to dry completely.

- STEP 4** Refer to **PIC 2**. Press the channel of the Trim onto the windshield; ensure that it is centered.

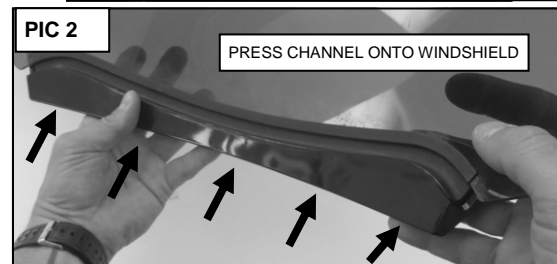
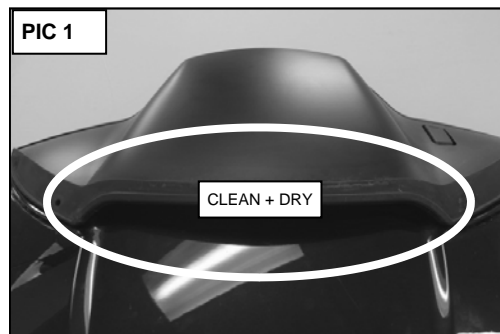



- STEP 5** Refer to **PIC 3**. “Hook” the edge of the Trim over the rubber gasket; press the Trim/windshield assembly into place over the rubber gasket.
- STEP 6** Ensure that the Trim remains engaged on the gasket; align the holes and secure the windshield with the existing screws. Do not over tighten screws.
- STEP 7** Lift upward on the lower edge of the Trim to confirm that it has been “captured” by the windshield and gasket before riding.

