



**TECH-CONNECT with CHROME PERCH MOUNT**

**1788**

**PARTS INCLUDED**

- 1 Standard Tech-Connect Device Holder
- 1 Perch Mount—Chrome
- 1 Thin Foam Pad
- 1 Perch Mount Kit
  - 2 1/4-20 x 2" Button Socket Cap Screws
  - 2 1/4-20 x 2-1/4" Button Socket Cap Screws
  - 2 M6 x 1.0 x 55mm Button Socket Cap Screws
  - 2 Washers
  - 2 Spacers
- 1 Universal Handlebar Accessory Mount Kit
  - 4 6" Black Nylon Cable Ties
  - 1 Anti-Seize Packet
- 1 Hardware Kit
  - 2 Shim Washers
  - 1 5/16" Split Lock Washer
  - 1 Thumb Nut
- 1 Installation Instructions

*Please read and understand entire instructions before starting installation.*

**THANK YOU FOR CHOOSING KÜRYAKYN!**

**IN ORDER TO PROTECT YOU AND OTHERS FROM POSSIBLE INJURY AND/OR PROPERTY DAMAGE OR LOSS, PLEASE PAY CLOSE ATTENTION TO ALL INSTRUCTIONS, WARNINGS, CAUTIONS AND NOTICES REGARDING THE USE AND CARE OF THIS PRODUCT.**

<b>⚠ WARNING</b>	<b>THIS INDICATION ALERTS YOU TO THE FACT THAT IGNORING THE CONTENTS DESCRIBED HEREIN CAN RESULT IN POTENTIAL DEATH OR SERIOUS INJURY.</b>
<b>NOTICE</b>	This indication alerts you to the fact that ignoring the contents described herein may negatively affect product performance and functionality or damage the product itself or the product to which it is being attached.
<b>⚠ CAUTION</b>	This indication alerts you to the fact that ignoring the contents described herein can result in minor or moderate potential injury.

**TOOLS SUGGESTED**

Set of Hex Wrenches (Standard and/or Metric depending on motorcycle), Pliers, Set of Torx Wrenches (for H-D installations)

**STRICTLY OBSERVE THE FOLLOWING GUIDELINES IN ORDER TO USE THE PRODUCT PROPERLY AND AVOID POTENTIALLY DANGEROUS ACCIDENTS.**

**NOTICE**

**IF INSTALLING THIS PRODUCT FOR ANOTHER PARTY, PLEASE MAKE SURE THEY RECEIVE THIS COPY OF THE INSTALLATION INSTRUCTIONS SO THEY ARE AWARE OF THE IMPORTANT INFORMATION CONTAINED IN THEM.**

**STEP 1** Read and understand all steps in the instructions before starting the installation. Park the motorcycle on a hard, level surface and turn off the ignition.

**NOTE:** For devices measuring 1-5/8" to 3-5/8" wide.

**CAUTION** Ensure that the installation of this product does not interfere with the proper operation of the motorcycle before riding.

**NOTICE** Avoid damage to the motorcycle. Protect painted surfaces with a soft cloth or blanket.

**NOTICE** It is the installer's responsibility to ensure that there is adequate clearance between the Tech-Connect and any painted surfaces. Küryakyn is not responsible for any damage due to inadequate clearance.

**NOTICE** Be aware of any cables/wires that could potentially be pinched or crushed while using this product.

**STEP 2** Place a clean, soft blanket over the gas tank to protect the paint.

**STEP 3** Select either the clutch or brake perch for mounting the arm. When mounted, the arm will usually point towards the center of the bike. Remove the bottom screw securing the clutch or brake perch halves as shown in PIC 1; this will not be used again.

**STEP 4** Locate the correct screw, either the metric or standard, by comparing threads on the included screws to the threads from the screw that were removed. The 1/4"-20 x 2-1/4" screws are generally used on older H-D motorcycles, the 1/4"-20 X 2" screws on newer H-D's and the M6 X 1.0 X 55mm on Metric bikes.

**NOTICE** Use the supplied anti-seize for fasteners; this will prevent galling and make future removal of fasteners easier.

**STEP 5** As shown in PIC 2, place the washer over the screw, then insert through the perch mount arm and place the spacer over the screw then add a dab of anti-seize to the screw end.

**STEP 6** As shown in PIC 3, place the arm, screw, washer and spacer on the perch and start the screw, finger tighten for now.

**STEP 7** Remove the upper screw securing the perch mounting halves; it will not be used again. PIC 3

**STEP 8** Rotate the arm up into position and install the screw, washer, and spacer, while using a dab of anti-seize as in STEP 5. PIC 3

**STEP 9** Tighten both of the screws securely.

**STEP 10** Install the Accessory Mount Plate to the perch mount by inserting the metal shaft through the hole in the perch mount. The hex flats on the metal shaft will line up with the hex flats in the hole. Secure the Accessory Mount Plate with the included 1/4" flat washer, then the 1/4" lock washer, then the Thumb nut. PIC 4. Tighten securely.

**STEP 11** Turn the handlebars in both directions to their full stop position and ensure that there is clearance between the mounting plate/accessory and the gas tank, dash and other accessories.

**WARNING** ENSURE THAT THERE IS CLEARANCE AT ALL POINTS WHEN THE HANDLEBARS ARE TURNED, INSUFFICIENT CLEARANCE MAY CAUSE DAMAGE TO THE MOTORCYCLE OR CAN CAUSE LOSS OF CONTROL THAT COULD RESULT IN SEVERE INJURY OR DEATH.

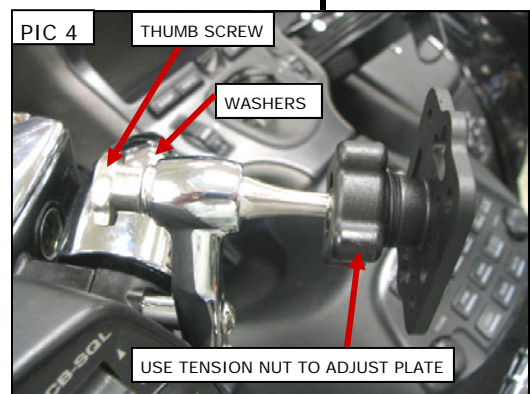
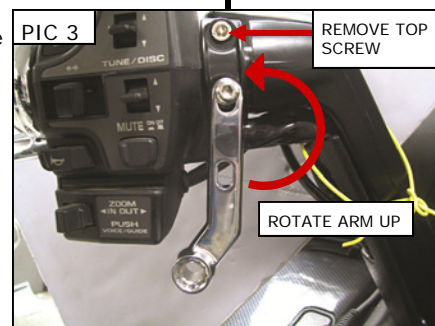
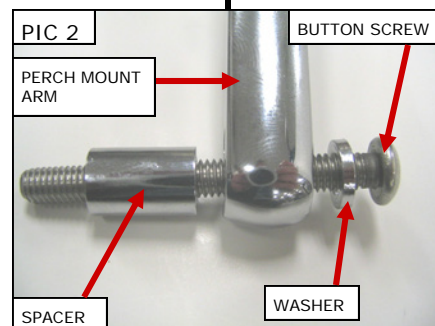
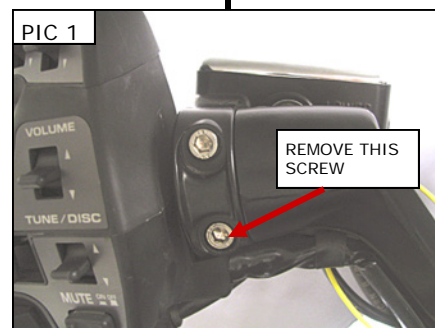

-cont.-

**WARNING** TO PREVENT POSSIBLE LOSS OF CONTROL, WHICH COULD RESULT IN POSSIBLE INJURY OR DEATH, WE DO NOT RECOMMEND REMOVING, REPLACING OR ADJUSTING THE DEVICE ON THE ACCESSORY MOUNT PLATE WHILE RIDING THE MOTORCYCLE.

**NOTICE** It is the installer's responsibility to ensure that all of the fasteners (including pre-assembled) are tightened before operation of the motorcycle. Küryakyn will not provide warranty coverage on products or components lost due to improper installation or lack of maintenance. Periodic inspection and maintenance are required on all fasteners.

**USING THE TECH-CONNECT HOLDER**

**STEP 1** Turn the knobs counter-clockwise until the sides are separated from the center section. PIC 5. Peel the narrow pieces of foam off the backing paper, center them in the inset portion of the sides and apply them to the sides of the holder. Peel the wide piece of foam from the backing paper, center it in the inset portion in the center and apply it to the center of the holder. PIC 5

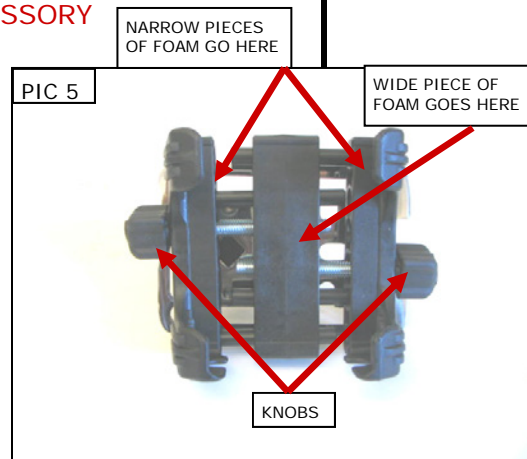

**STEP 2** Turn the knobs on the outside of the Tech-Connect (PIC 5) counter clockwise until your device will fit in between the arms. Turn the knobs clockwise to close the arms around the device. There is a locking detent under the knobs to hold them in place once they come in contact with the device. **DO NOT over-tighten the knobs. Tightening them too tight will not allow you to loosen them with your fingers.** Periodically check the tightness of the mobile device in the Tech-Connect.

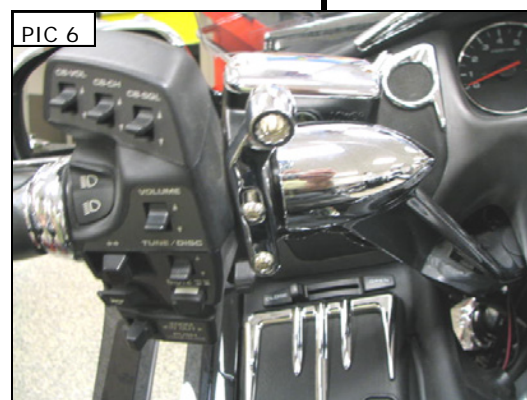

**NOTE:** For best results keep "L" shaped foot portion of the Tech-Connect Holder on the bottom of the device. Keep the device holding support arms centered on the mounting plate.

**STEP 3** To remove the Tech-Connect Holder from the bike for storage, simply remove the Thumb Nut and washers from the Tech-Connect Holder and remove the plate from the mount. PIC 6

**STEP 4** To replace the Tech-Connect Holder on the Perch Mount, insert the metal shaft through the hole in the perch mount. The hex flats on the metal shaft will line up with the hex flats in the hole. Secure the Tech-Connect Holder with the included 1/4" flat washer, then the 1/4" lock washer, then the Thumb nut. PIC 4 Tighten securely.

**STEP 5** To adjust the angle of the Tech-Connect Holder, loosen the tensioning nut, adjust the Tech-Connect Holder to the desired position and tighten the tension nut. PIC 4 The tension nut will allow you to keep the Tech-Connect Holder in the same position or, with a little less tension, allow you to move the Accessory Mount Plate on the swivel ball.

**WARNING** DO NOT ATTEMPT TO OPERATE OR REMOVE THE MOBILE DEVICE FROM THE HOLDER WHILE OPERATING THE MOTORCYCLE.

**NOTICE** Ensure that the Mobile Device is secure in the Tech-Connect Holder. Küryakyn is not responsible for any Device that is stolen or damaged from use in this Holder or from the Holder not being properly secured to the motorcycle. It is the installer's responsibility to ensure that all of the fasteners (including pre-assembled) are tightened before operation of the motorcycle. Küryakyn will not issue a warranty on components lost due to improper installation. Periodic inspection and maintenance are required on all fasteners.

**NOTICE** Motorcycling can be done in a harsh environment. Make sure your Mobile Device is appropriate for this application.

*Ride On!*