



UNIVERSAL DRINK HOLDER

1463

PARTS INCLUDED

- 1 Drink Ring with Stainless Steel Mug
- 1 Perch Mount Arm
- 1 Anti-Seize Packet
- 1 Perch Mount Kit Containing:
  - 2 1/4"-20 x 2" Button Socket Cap Screws
  - 2 1/4"-20 x 2-1/4" Button Socket Cap Screws
  - 2 M6 x 1.0 x 55mm Button Socket Cap Screws
  - 2 Washers
  - 2 Spacers
- 1 Hardware Kit Containing:
  - 2 Shims
  - 1 Thumb Nut
  - 1 5/16" Split Lock Washer
- 1 Installation Instructions

Please read and understand entire instructions before starting installation.

THANK YOU FOR CHOOSING KÜRYAKYN!

IN ORDER TO PROTECT YOU AND OTHERS FROM POSSIBLE INJURY AND/OR PROPERTY DAMAGE OR LOSS, PLEASE PAY CLOSE ATTENTION TO ALL INSTRUCTIONS, WARNINGS, CAUTIONS AND NOTICES REGARDING THE USE AND CARE OF THIS PRODUCT.

<b>WARNING</b>	THIS INDICATION ALERTS YOU TO THE FACT THAT IGNORING THE CONTENTS DESCRIBED HEREIN CAN RESULT IN POTENTIAL DEATH OR SERIOUS INJURY.
<b>NOTICE</b>	This indication alerts you to the fact that ignoring the contents described herein may negatively affect product performance and functionality or damage the product itself or the product it is being attached to.
<b>CAUTION</b>	This indication alerts you to the fact that ignoring the contents described herein can result in potential injury.

TOOLS SUGGESTED

Set of Combination Wrenches, Set of Hex Wrenches, Set of Torx Wrenches, Adjustable Wrench

STRICTLY OBSERVE THE FOLLOWING GUIDELINES IN ORDER TO USE THE PRODUCT PROPERLY AND AVOID POTENTIALLY DANGEROUS ACCIDENTS.

<b>NOTICE</b>	<b>IF INSTALLING THIS PRODUCT FOR ANOTHER PARTY, PLEASE MAKE SURE THEY RECEIVE THIS COPY OF THE INSTALLATION INSTRUCTIONS SO THEY ARE AWARE OF THE IMPORTANT INFORMATION CONTAINED IN THEM.</b>
---------------	---

**STEP 1** Read and understand all steps in the instructions before starting the installation. Park the motorcycle on a hard, level surface and turn off the ignition.

**NOTE:** Intended to hold the included Stainless Steel Mug. Universal fitment for Clutch or Brake Perch Mounting Bolts vertical spacing center to center at 1-1/8" to 1-11/16" apart.

**CAUTION** Ensure that the installation of this product does not interfere with the proper operation of the motorcycle before riding.

**NOTICE** Avoid damage to the motorcycle. Protect painted surfaces with a soft cloth or blanket.

**NOTICE** It is the installer's responsibility to ensure that there is adequate clearance between the Drink Holder and any painted surfaces. Küryakyn is not responsible for any damage due to inadequate clearance.

**NOTICE** Be aware of any cables/wires that could potentially be pinched or crushed while using this product.

**STEP 2** Place a clean, soft blanket over the gas tank to protect the paint.

**STEP 3** Select either the clutch or brake perch for mounting the arm. The arm will usually point towards the center of the bike. Remove the bottom screw securing the clutch or brake perch halves as shown in PIC 1; this will not be used again.

**STEP 4** Identify the correct screw, either the metric or standard, by comparing threads on the included screws to the threads from the screws that were removed. The 1/4"-20 x 2-1/4" screws are generally used on older H-D motorcycles, the 1/4"-20 X 2" screws on newer Harleys and the M6 X 1.0 X 55mm on Metric bikes.

**NOTICE** Use the supplied anti-seize for fasteners; this will prevent galling and make future removal of fasteners easier.

**STEP 5** As shown in PIC 2, place the washer over the screw, then insert through the perch mount arm and place the spacer over the screw then add a dab of anti-seize to the screw end.

**STEP 6** As shown in PIC 3, place the arm, screw, washer and spacer on the perch and start the screw, finger tighten the screw.

**STEP 7** Remove the upper screw securing the perch mounting halves; it will not be used again. PIC 3

**STEP 8** Rotate the arm up into position and install the screw, washer, and spacer, while using a dab of anti-seize as in STEP 5. PIC 3

**STEP 9** Tighten both of the screws securely.

**STEP 10** To mount the Universal Drink Ring, place the stud through the mounting arm, place one of the shims and the flat washer over the protruding end (PIC 4). Apply anti-seize to the threaded portion of the stud and secure with the thumb nut.

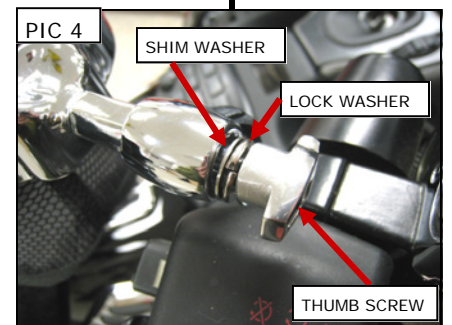
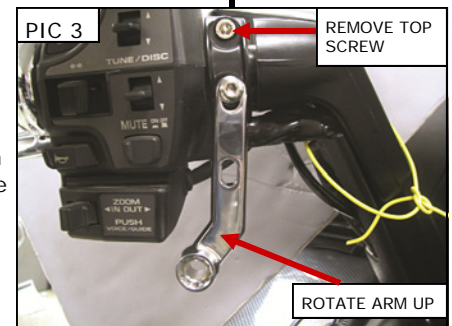
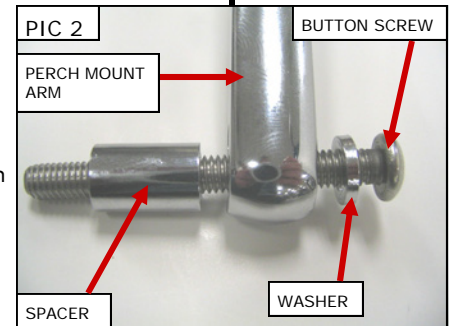
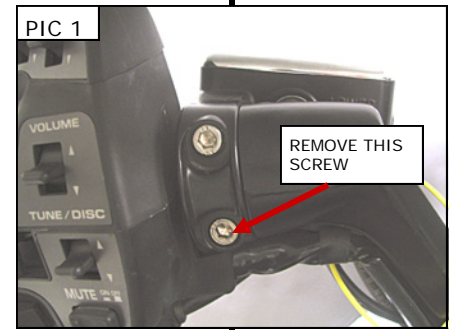

**STEP 11** Turn the handlebars in both directions to their full stop position and ensure that there is clearance between the Universal Drink Ring with the Stainless Steel Mug in it and the gas tank, dash and other accessories.

**WARNING** ENSURE THAT THERE IS CLEARANCE AT ALL POINTS WHEN THE HANDLEBARS ARE TURNED, INSUFFICIENT CLEARANCE MAY CAUSE DAMAGE TO THE MOTORCYCLE OR CAN CAUSE LOSS OF CONTROL THAT COULD RESULT IN SEVERE INJURY OR DEATH.

**STEP 12** Tighten all hardware.

**WARNING** TO PREVENT POSSIBLE LOSS OF CONTROL, WHICH COULD RESULT IN A POSSIBLE INJURY OR DEATH, WE DO NOT RECOMMEND REMOVING AND REPLACING THE MUG IN THE RING WHILE RIDING THE MOTORCYCLE.

**NOTICE** Do not overload the Passenger Pouch with excessive weight.

**NOTICE** The adjustability of the Drink Ring was not intended to prevent spills.

**NOTICE** Ensure that the Drink Ring is secure on the Mount and that the Mount is secure on the motorcycle. Küryakyn is not responsible for any belongings that are stolen or damaged from use of this Drink Ring/Mug or from the Drink Ring/Mug or Mount not being properly secured to the motorcycle. It is the installer's responsibility to ensure that all of the fasteners (including pre-assembled) are tightened before operation of the motorcycle. Küryakyn will not provide warranty coverage on products or components lost due to improper installation or lack of maintenance. Periodic inspection and maintenance are required on all fasteners.

*Ride On!*

PAGE

**3**

**UNIVERSAL DRINK HOLDER**

**INSTALLATION**