



ELLIPSE MIRRORS

1438

PARTS INCLUDED

- 1 Left Ellipse Mirror Assembly—Convex Glass
- 1 Right Ellipse Mirror Assembly—Convex Glass
- 1 Hardware Kit, Including:
 - 2 5/16"-18 X 1-1/2" Socket Head Cap Screws
 - 2 5/16"-18 X 2" Socket Head Cap Screws
 - 1 2.5mm Hex Key Wrench
 - 2 5/16" Split Lock Washers
 - 2 5/16" Internal Tooth Lock Washers
 - 2 Double End Threaded Studs
- 1 Installation Instructions

Please read and understand entire instructions before starting installation.

THANK YOU FOR CHOOSING KÜRYAKYN!

IN ORDER TO PROTECT YOU AND OTHERS FROM POSSIBLE INJURY AND/OR PROPERTY DAMAGE OR LOSS, PLEASE PAY CLOSE ATTENTION TO ALL INSTRUCTIONS, WARNINGS, CAUTIONS AND NOTICES REGARDING THE USE AND CARE OF THIS PRODUCT.

NOTICE	This indication alerts you to the fact that ignoring the contents described herein may negatively affect product performance and functionality.
CAUTION	This indication alerts you to the fact that ignoring the contents described herein can result in potential injury.

NOTICE	IF INSTALLING THIS PRODUCT FOR ANOTHER PARTY, PLEASE MAKE SURE THEY RECEIVE THIS COPY OF THE INSTALLATION INSTRUCTIONS SO THEY ARE AWARE OF THE IMPORTANT INFORMATION CONTAINED IN THEM.
---------------	---

TOOLS SUGGESTED

Set of Hex Wrenches, Set of Combination Wrenches

STRICTLY OBSERVE THE FOLLOWING GUIDELINES IN ORDER TO USE THE PRODUCT PROPERLY AND AVOID POTENTIALLY DANGEROUS ACCIDENTS.

ALL INSTALLATIONS

STEP 1 Read and understand all steps in the instructions before starting the installation. Park the motorcycle on a hard, level surface and turn off the ignition.

NOTE: The included 2.5mm Hex Wrench is used only in P/N 1428, 1430, 1437 & 1438 to adjust the swivel ball tension.

NOTE: Mirror adapters (sold separately) are required for installation on metric cruisers.

NOTICE	Avoid damage to the motorcycle. Protect painted surfaces with a soft cloth or blanket.
---------------	--

NOTICE

Ensure that the position of the mirror and stem DO NOT interfere with the operation of the motorcycle hand controls.

Küryakyn®

NOTICE

It is the installer's responsibility to ensure that all of the fasteners (including pre-assembled) are tightened before operation of the motorcycle. Küryakyn will not provide warranty coverage on products or components lost due to improper installation or lack of maintenance. Periodic inspection and maintenance are required on all fasteners

STEP 2 Remove the stock mirrors from controls; set them aside, they will not be re-used.

MOUNTING WITH SINGLE SCREW

STEP 3 Determine which of the included socket head cap screws from the hardware kit will provide maximum thread engagement in the mirror stem without bottoming out.

STEP 4 Place a split lock washer over the socket head cap screw and insert it in the hole in the hand control. FIG 1

STEP 5 Place an internal lock washer over the protruding end of the cap screw.

STEP 6 While holding the mirror in place, thread the socket head cap screw into the bottom of the mirror stem.

NOTE: Ensure that the setscrew in the mirror stem does not prevent the socket head cap screw from being installed fully. FIG 1

STEP 7 Adjust the position of the mirror stem for visibility and clearance; tighten the socket head cap screw and then the setscrew.

STEP 8 Repeat STEP 3 through STEP 7 for the opposite side.

STEP 9 Adjust the mirrors for proper view before riding the motorcycle.

H-D with Bottom Mounted Turn Signals—Right Side Procedure

CAUTION Removing the retainer nut and/or the ball stud clamp in the next Step will release the turn signals from the hand controls. Secure the turn signals to prevent damage or injury.

STEP 10 Loosen and remove the retainer nut and ball stud clamp shown in FIG 2

STEP 11 Remove the stock mirror; hold the stock turn signal to prevent it from being damaged.

-cont.-

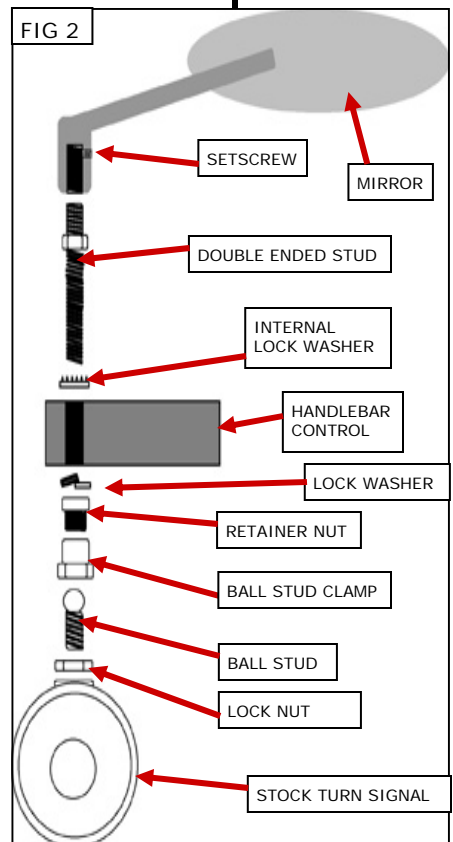
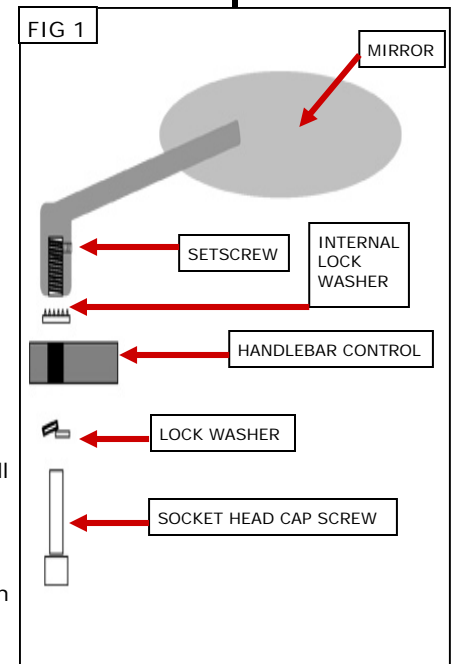

STEP 12 Screw a double ended stud into the new mirror stem; tighten and then tighten the set screw.
FIG 2

NOTE: Ensure that the setscrew in the mirror stem does not prevent the double ended stud from being installed fully. FIG 2

STEP 13 Place an internal lock washer over the long end of one of the double-ended studs; insert the assembly into the mirror stem hole in the hand control. FIG 2

STEP 14 Place a split lock washer over the protruding end of the double-ended stud and thread the retainer nut onto the stud. FIG 2

STEP 15 Adjust the position of the mirror stem for visibility and clearance; tighten the retaining nut.

STEP 16 Install the ball stud clamp onto the retainer nut; adjust the turn signal and tighten the clamp.

STEP 17 Repeat STEP 3 through STEP 7 for the LEFT SIDE.

STEP 18 Adjust the mirrors for proper view before riding the motorcycle.

ADJUST SWIVEL BALL TENSION

STEP 19 Remove the mirror head from the stem using an open end wrench on the flat on the end of the ball stud. PIC 1 Using the included hex wrench, remove the two fasteners from the back of the mirror cover; PIC 2 carefully remove the front bezel and mirror glass.

NOTE: Make sure the hex wrench is fully seated in the bolt before you try to loosen the two bolts. Improper fitting wrenches will strip the head on these bolts!

STEP 20 Turn the tension screws inside the mirror housing (PIC 3) to increase or decrease the tension on the ball joint. Turn the screws clockwise to increase tension; turn the screws counter-clockwise to decrease tension. Place a drop of light lube (WD-40) on ball. PIC 3

STEP 21 Replace the mirror glass and bezel to the back cover, secure with the two fasteners removed in Step 19.

STEP 22 Reinstall the mirror head to the stem.

STEP 23 Tighten all fasteners securely.

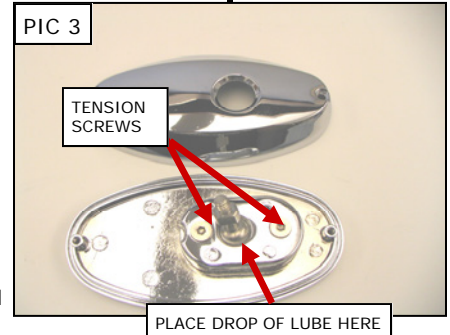
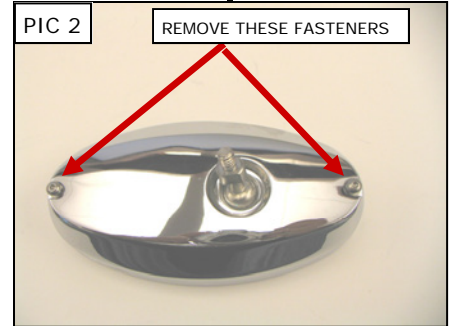
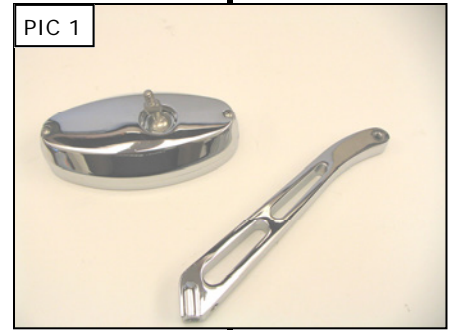

NOTICE

It is the installer's responsibility to ensure that all of the fasteners (including pre-assembled) are tightened before operation of the motorcycle. Kuryakyn will not provide warranty coverage on products or components lost due to improper installation or lack of maintenance. Periodic inspection and maintenance are required on all fasteners.

Ride On!