



AIRCHARGER®

HIGH-FLOW INTAKE KITS

INSTALLATION INSTRUCTIONS

63-1139
HARLEY DAVIDSON

TOOLS NEEDED:

- ratchet
- extension
- 7/16" socket
- 3/16" allen key
- 5/16" allen key
- 1/4" allen key
- t27 torx socket
- 1/8" allen key
- 7/16 wrench
- flat blade screwdriver

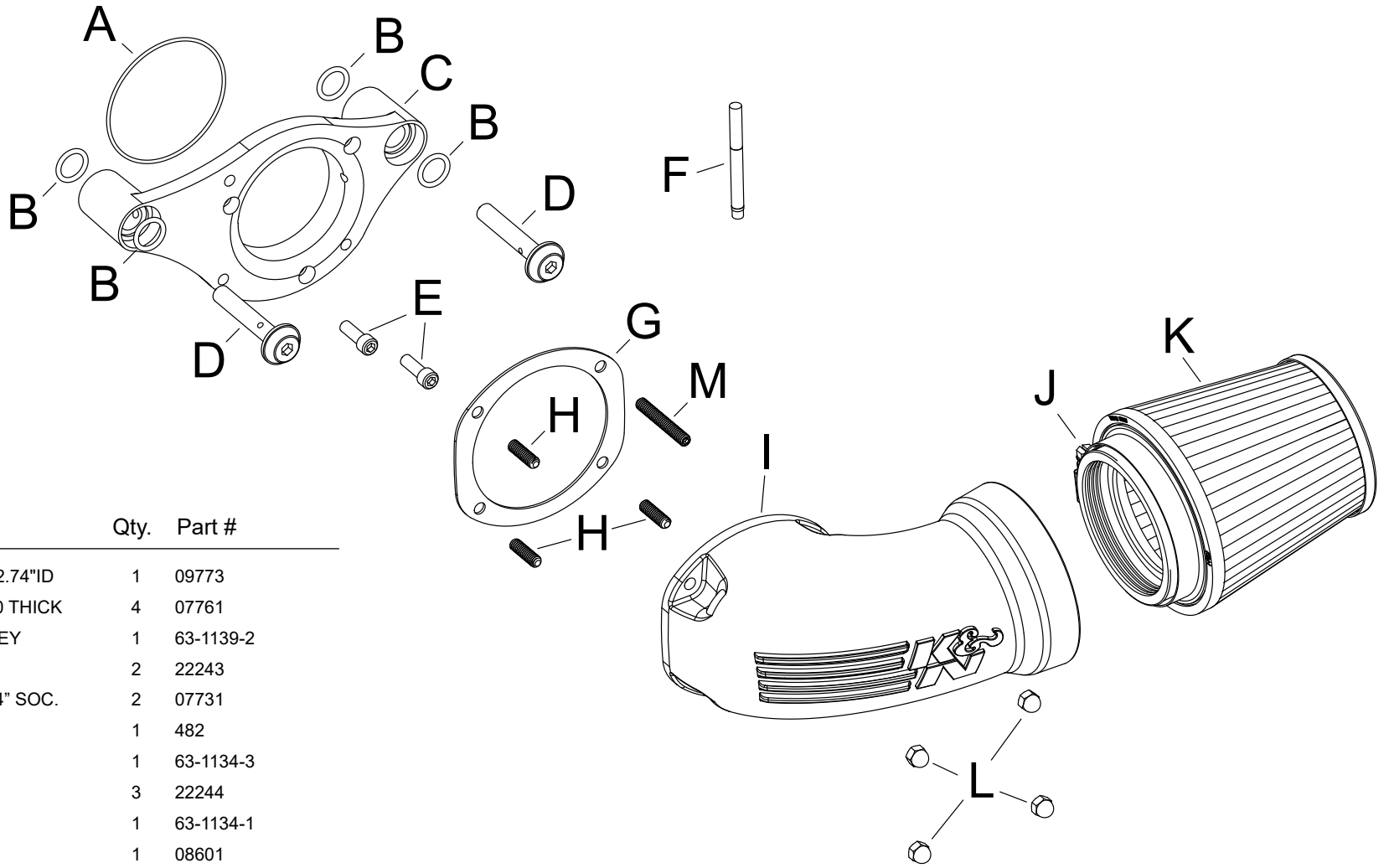

PARTS LIST:

Description	Qty.	Part #
A O-RING; 2.88"OD X 2.74"ID	1	09773
B O-RING; 9/16" ID, .10 THICK	4	07761
C BACK PLATE; HARLEY	1	63-1139-2
D BREATHER BOLT	2	22243
E SCREW; 1/4-20 X 3/4" SOC.	2	07731
F THREAD LOCKER	1	482
G GASKET; 63-1134	1	63-1134-3
H 7/8" SET SCREW	3	22244
I INTAKE TUBE	1	63-1134-1
J HOSE CLAMP #48	1	08601
K AIR FILTER	1	RE-5286
L CAP NUT	4	AIR-KITACORNNUT
M 1 3/4" SET SCREW	1	22245

NOTE: FAILURE TO FOLLOW INSTALLATION INSTRUCTIONS AND NOT USING THE PROVIDED HARDWARE MAY DAMAGE THE INTAKE TUBE, THROTTLE BODY AND ENGINE.

TO START:

1. Turn off the ignition and disconnect the negative battery cable.



2. Remove air filter cover bolt and air filter cover as shown.



3. Loosen the three air filter retaining bolts as shown.



4. Remove the air filter from the vehicle and disconnect the crankcase breather tubes.



5. Remove the two breather/air filter base mounting bolts as shown.



6. Remove the air filter base from the vehicle as shown.

NOTE: K&N Engineering, Inc. recommends that customers do not discard the factory air intake components.



7. Install three of the o rings provided onto the back side of the K&N® back plate as shown. A small amount of grease maybe used to hold the o rings in place.



8. Install the remaining two o rings onto the front of the back plate as shown. Install the three provided studs with thread locker positioned into the back plate.



9. Install the long stud as shown 1/2" down. Note; apply one drop of thread locker onto stud.



10. Using the two provided crankcase breather bolts; install the back plate onto the vehicle. Do not tighten bolts at this time. Then secure with the two other bolts provided. Tighten all bolts at this time. **NOTE: Apply one drop of the provided thread locker onto the bolts.**



11. Install the K&N® intake tube with the gasket and provided hardware.

NOTE: Apply one drop of the provided thread locker onto the studs.



12. Install the K&N® air filter onto the intake tube and secure with the provided hose clamp.

12. Reconnect the vehicle's negative battery cable. Double check to make sure everything is tight and properly positioned before starting the vehicle.

13. It will be necessary for all K&N® high flow intake systems to be checked periodically for realignment, clearance and tightening of all connections. Failure to follow the above instructions or proper maintenance may void warranty.

ROAD TESTING:

1. Start the engine with the transmission in neutral or park, and the parking brake engaged. Listen for air leaks or odd noises. For air leaks secure hoses and connections. For odd noises, find cause and repair before proceeding. This kit will function identically to the factory system except for being louder and much more responsive.

2. Test drive the vehicle. Listen for odd noises or rattles and fix as necessary.

3. If road test is fine, you can now enjoy the added power and performance from your kit.

4. K&N Engineering, Inc., requires cleaning the intake system's air filter element every 100,000 miles. When used in dusty or off-road environments, our filters will require cleaning more often. We recommend that you visually inspect your filter once every 25,000 miles to determine if the screen is still visible. When the screen is no longer visible some place on the filter element, it is time to clean it. To clean and re-oil, purchase our filter Recharger® service kit, part number 99-5050 or 99-5000 and follow the easy instructions.