

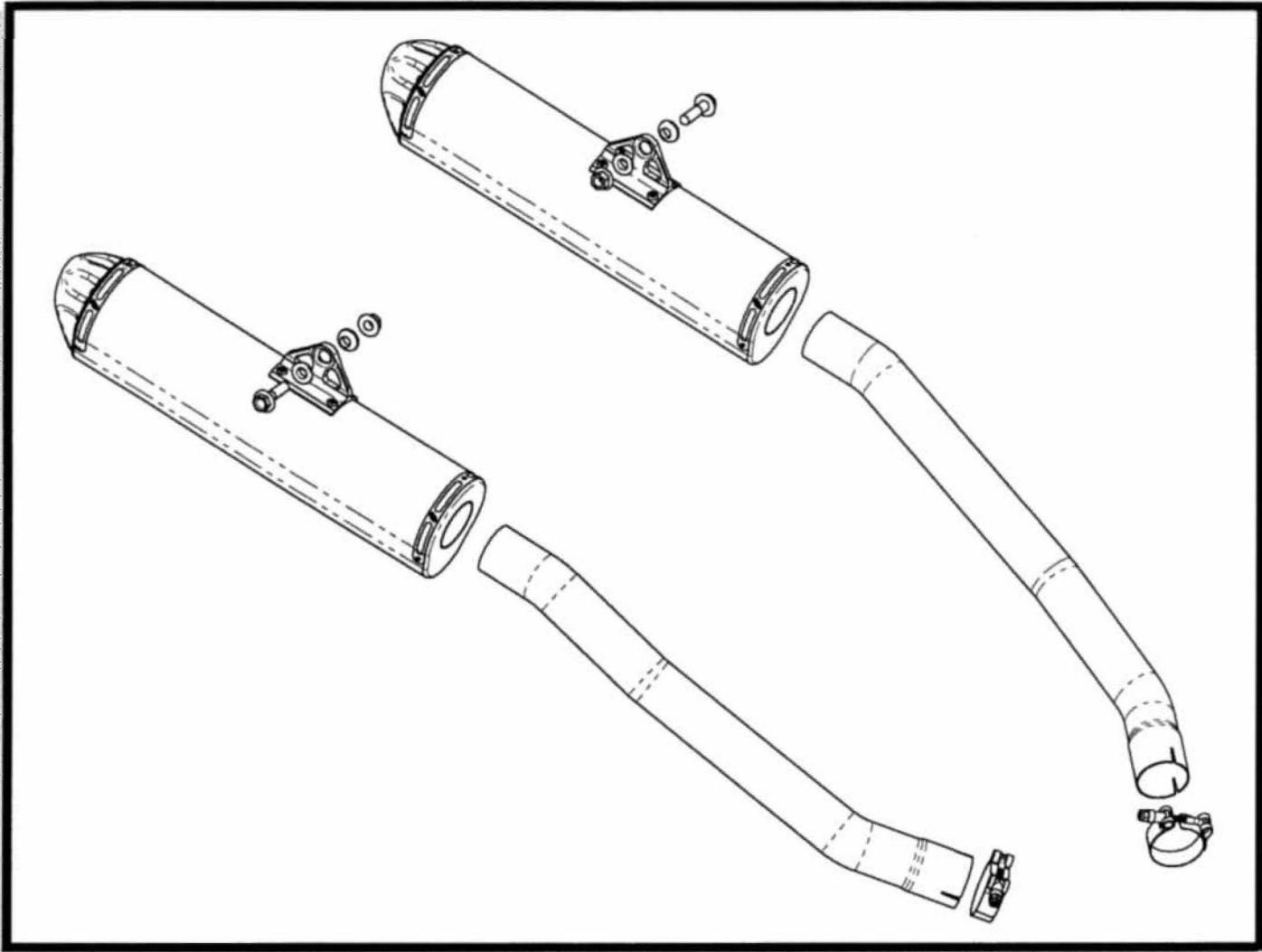

19-3020-123-02

SLIP-ON EXHAUST, SS/ALUMINUM

KAWASAKI ZX-14
2008



PARTS INCLUDED

Ref.	Part Number	Description	Qty
1)	00-200-00174	Aluminum Muffler Assembly - Right	1
2)	00-200-00175	Aluminum Muffler Assembly - Left	1
3)	02-06-44793	Midpipe Tube - Right	1
4)	02-06-44794	Midpipe Tube - Left	1
5)	04-18-42590	Muffler Bracket Spacer	4
6)	07-38-42063-35	T-bolt Clamp, #200-63	2
7)	01-5210125065-27	M10-1.25x65mm Hex Flange Head Cap Screw	2
8)	01-7410125-27	M10-1.25 Hex Flange Nut	2

08-50-43132 REV. A

19-3016-123-02

SLIP-ON EXHAUST, SS/ALUMINUM

KAWASAKI ZX-14
2006-07

TOOLS REQUIRED

Ref.	Description	Ref.	Description
1)	3/8" Drive Ratchet	4)	10mm Socket
2)	3" Extension	5)	12mm Socket
3)	8mm Socket	6)	13mm Deep Socket

INSTALLATION INSTRUCTIONS

- 1) Make sure the motorcycle is cool and place securely on a service lift or stand.
- 2) Loosen the stock right side "headpipe exit to midpipe" clamp bolt.
- 3) Remove the right side muffler mounting hardware. The stock washers will be retained.
- 4) Carefully slide the stock right side muffler assembly off of the motorcycle.

NOTE: If the stock gasket did not come off with the midpipe, it must be removed from the headpipe exit.
- 5) Place one provided t-bolt clamp onto the notched end of the new right side midpipe, and slide the midpipe over the right side headpipe outlet.
- 6) Slide the new right side muffler onto the midpipe outlet until it is fully seated.
- 7) Hold two provided muffler bracket spacers against the inside and outside of the muffler mounting bracket, and place the muffler mounting bracket against the outside passenger peg mount washer. Feed one supplied M10-1.25x65mm hex flange head bolt through the outer muffler bracket spacer, muffler mounting bracket, inner muffler mounting spacer, washer, and passenger peg mount. Secure the assembly using one supplied M10-1.25 hex flange nut. Do not fully tighten at this time.
- 8) Position the right side exhaust assembly so that it is the best possible location. Fully tighten the t-bolt clamp, then the muffler mounting bolt.
- 9) Repeat Step 2-8 for the left side installation.
- 10) Clean all fingerprints and grease from the new exhaust system. Start the motorcycle and check for any exhaust leaks.

PERFORMANCE DELIVERED!

Learn more about motorcycle parts on our website.