

**ROKKER® XXR**  
**6.71" Fairing Speaker Upgrade**  
**Kit for 2014-2019 Harley®**  
**StreetGlide/Ultra**

**#HCRK-6712TW-XXR**

**Installation**  
**Instructions**

## Product Overview

J&M's ROKKER XXR series 6.71" speakers designed as exact size component/replacements for the stock 6.5" Harley fairing speakers as installed on the 2014-2019 Harley StreetGlide, Ultra or Ultra Ltd.

Spec'd at 2 ohms impedance and 300 watts maximum input (175w RMS - 91db sensitivity), speakers provide the ultimate in raw audio power and include the new custom grills with built-in high-output tweeters.

Lightweight waterproof one-piece woven-fiber driver cone with super-rigid metal basket design.

High-density lite-weight Neodymium magnet structure, specially coated to maintain flux-strength integrity even at extreme operating temperatures.

High efficiency VENTED voice-coil for improved cooling when operating at high volume levels for extended periods.

Custom speaker grills with high-output tweeters for crystal clear sound at highway speeds.

Mounting hole pattern and spade electrical connections are exactly the same as the factory specification, this is a total plug-and-play no-modification solution complete with easy to follow installation instructions.

These are THE most powerful speakers you can buy for your Harley and they will perform extremely well when used with a medium to high-powered accessory amplifier.

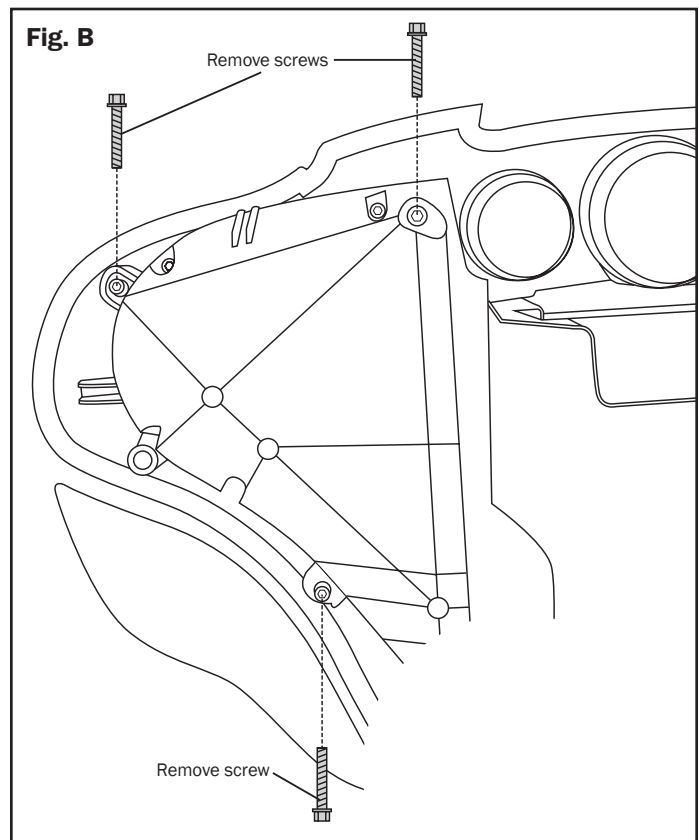
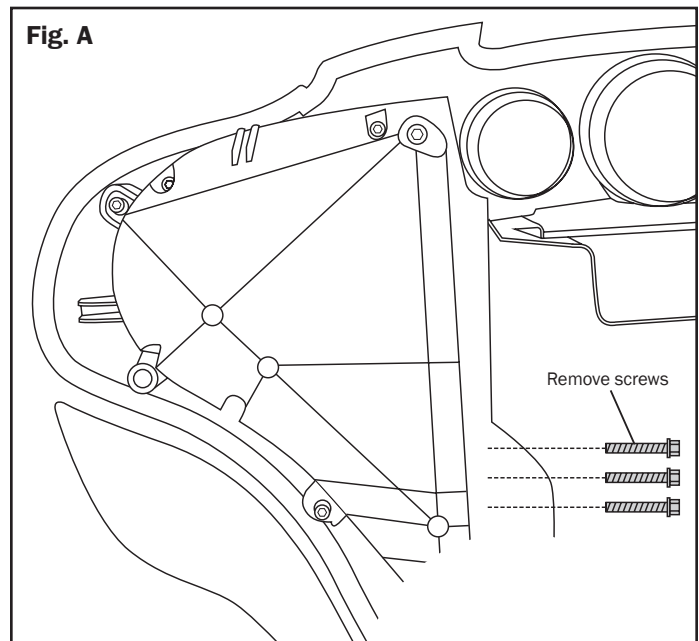
## Installation and Instructions

1. Remove the windshield and outer fairing clamshell completely.

**Important Note: If the bike is equipped with the Harley CB radio module, ensure that the CB module is removed before removing the applicable speaker pod assembly.**

### **RIGHT SPEAKER**

2. Remove the three 7/16 attachment screws from the inner bottom edge of the speaker pod. **(Figure A)**
3. Remove three 3/16 Allen head screws on the outside edges of the speaker pod. **(Figure B)**
4. Remove the two 5/32 Allen head screws from top edge of metal mounting tray. **(Figure C)**
5. Unplug the wire connection for the cigarette lighter socket from the speaker pod.
6. Remove the pod from the fairing.
7. Remove the speaker from the pod by removing the 4 retaining screws.
8. Unplug the speaker wires from the speaker and set aside.
9. Remove the stock grill from the inner fairing by removing the 3 attachment screws. **VERY IMPORTANT:** Discard these screws as they will not be used again. **(Figure D)**



10. Install the new 'J&M grills using the (3) #12 X 1/2" countersunk self-tapping screws provided, with the grill-mounted tweeter in the upright position. **VERY IMPORTANT:** Do Not use the stock Harley screws to attach the new 'J&M grills, or the speaker pods will not reinstall properly.

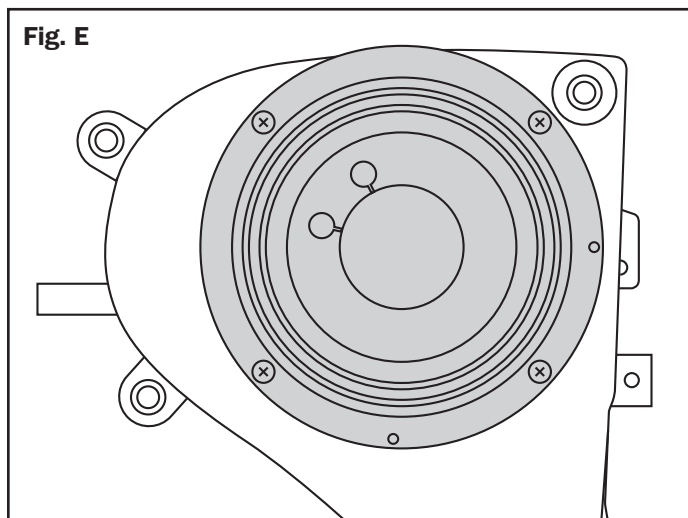
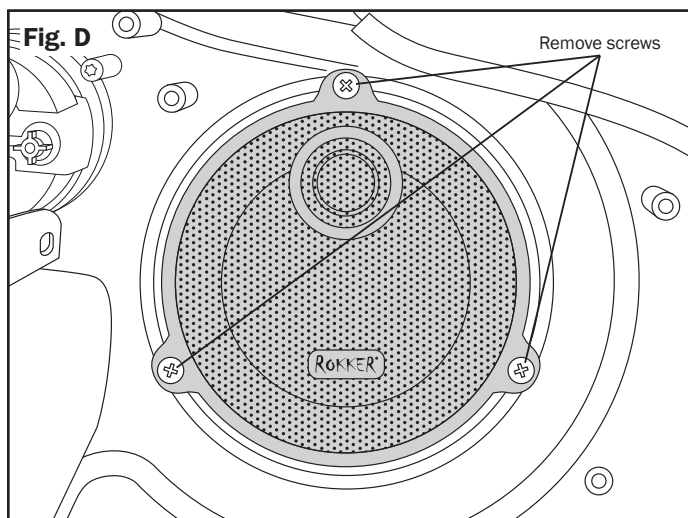
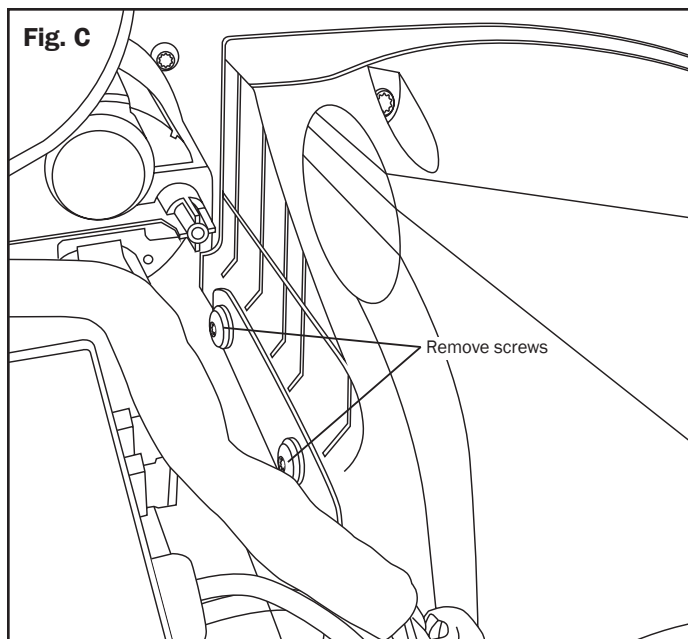
11. Install the new 6.71" ROKKER XXR speaker using the original speaker attachment screws; Ensure that the speaker is placed into the pod with the tweeter-wire exiting to the upper, outer corner. **(Figure E)**

12. Plug the tweeter wire from the main speaker into the corresponding plug on the backside of the grill. Then re-install the speaker pod assembly back into the fairing, paying close attention to pull the EXTRA tweeter wire length back out between the back side of the grill and front of the main speaker, so that this extra wire does not rattle against the main speaker cone when playing.

13. Repeat steps 2 through 12 for the opposite side speaker.

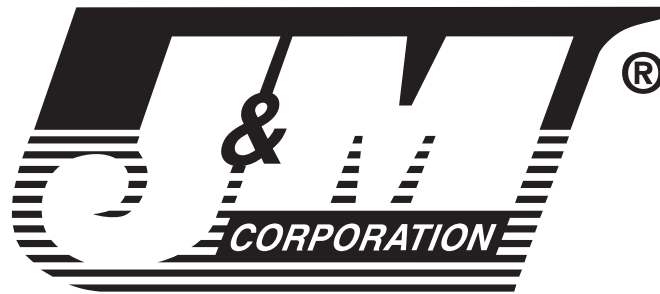
**Important Note: If the bike is equipped with the Harley CB radio module, ensure that the CB module is removed before removing the applicable speaker pod assembly.**

14. Test each speaker for proper operation before reassembling the fairing.



Thank you for the confidence you have shown in J&M Corporation by purchasing one of our innovative products.





**200w Performance Series  
2-CH Amplifier Kit For 2014-19  
Harley® Street Glide/Ultra/Ultra  
LTD. Fairing**

**#JMAA-2000HC14**

**Installation  
and Operation  
Instructions**

## Product Description

J&M Performance Series 2-ch 200w fairing speaker amplifier kit for 2014-2019 Harley® StreetGlide or Ultra with stock Harley 4.3 Std, 6.5GT or new GTS touch-screen radio, NO SPECIAL FLASH needed.

Full range class D audio amplifier, spec'd at 100watts RMS per channel X2, (200w total) into 2-ohm load @ 14.4vdc.

Amplifier mounts to custom made stainless steel 2-piece bracket system, to provide solid and secure mounting inside the StreetGlide or Ultra fairing and is dialed in for this specific speaker configuration. (Updated amplifier gain/frequency settings as of 09-15/2018)

Custom made plug-n-play wiring harnesses are included, along with heavy gauge power/ground wires for the fused battery connection, all necessary mounting hardware & complete installation/operation instructions.

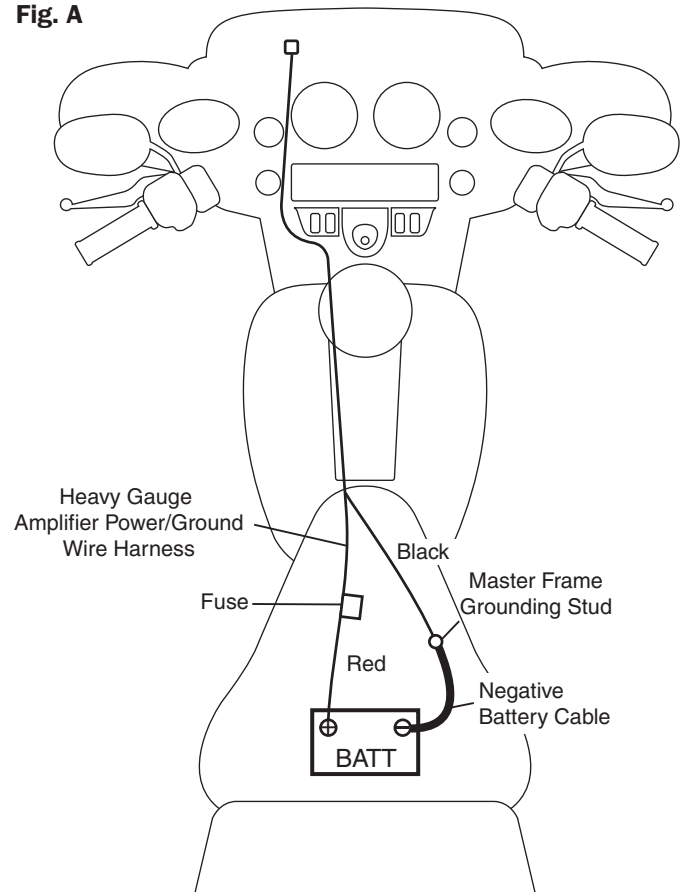
Amplifier itself measures 6 1/2" X 4 3/4" X 1 3/4".

## Installation Instructions

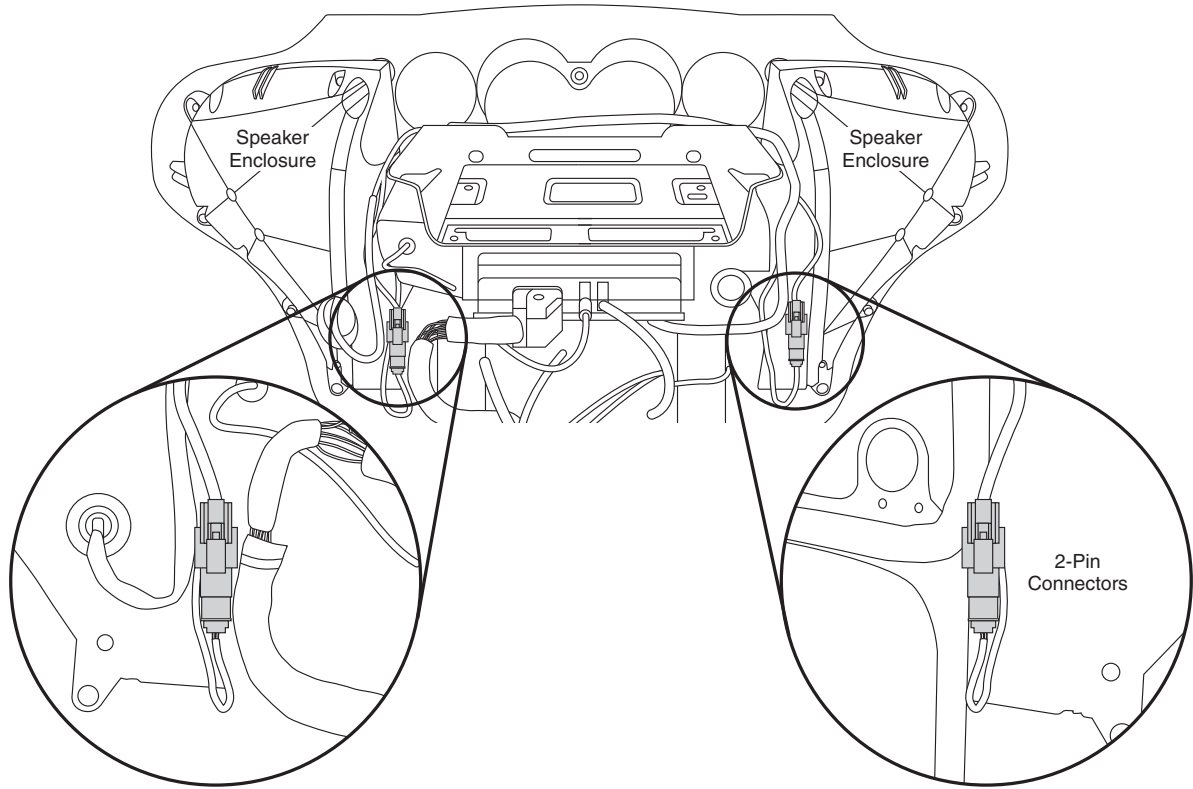
1. Remove the windshield, outer fairing shell, vent below windshield, fuel tank and seat.
2. Remove and replace the stock metal tray above the radio with the J&M Amplifier mounting tray by removing the 4 screws holding the tray to the radio, the 4 screws holding the tray to the speaker enclosures, and 2 screws holding the tray to the gauge assembly. Place the J&M Amplifier mounting tray in place of the stock tray and secure with the screws removed from the stock tray. **(Figure B)**
3. Mount Amplifier to the J&M Amplifier mounting plate with the 4 screws provided. The 2 shorter screws go toward the gauges.
4. By following the factory wiring harness, route the amplifier power harness from the fairing, under the fuel tank, and on to the battery. (removal of the fuel tank is required )
5. After first disconnecting the negative battery cable from the battery, connect the positive (red) lead from the amplifier power harness directly to the positive post of the battery. Then connect the negative (black) lead from the power harness to the same bolt/stud on the frame that the negative battery cable is connected to. Then reconnect the negative battery cable to the battery. **(Figure A)** Do not connect the negative (black) lead from the amplifier to the negative post of the battery.
6. Make speaker and Amplifier connections per diagram. **(Figure B, C and D)**

**Important Programing Note:** The amplifier gain & frequency response adjustments have been pre-set at our factory for this specific Harley Davidson audio system application, using speakers with an impedance of 2-ohms, to provide maximum performance at highway speeds. Should speaker impedance load change, alternate adjustments can be made by removing the small sticker that is placed over the amplifier's input gain control screw.

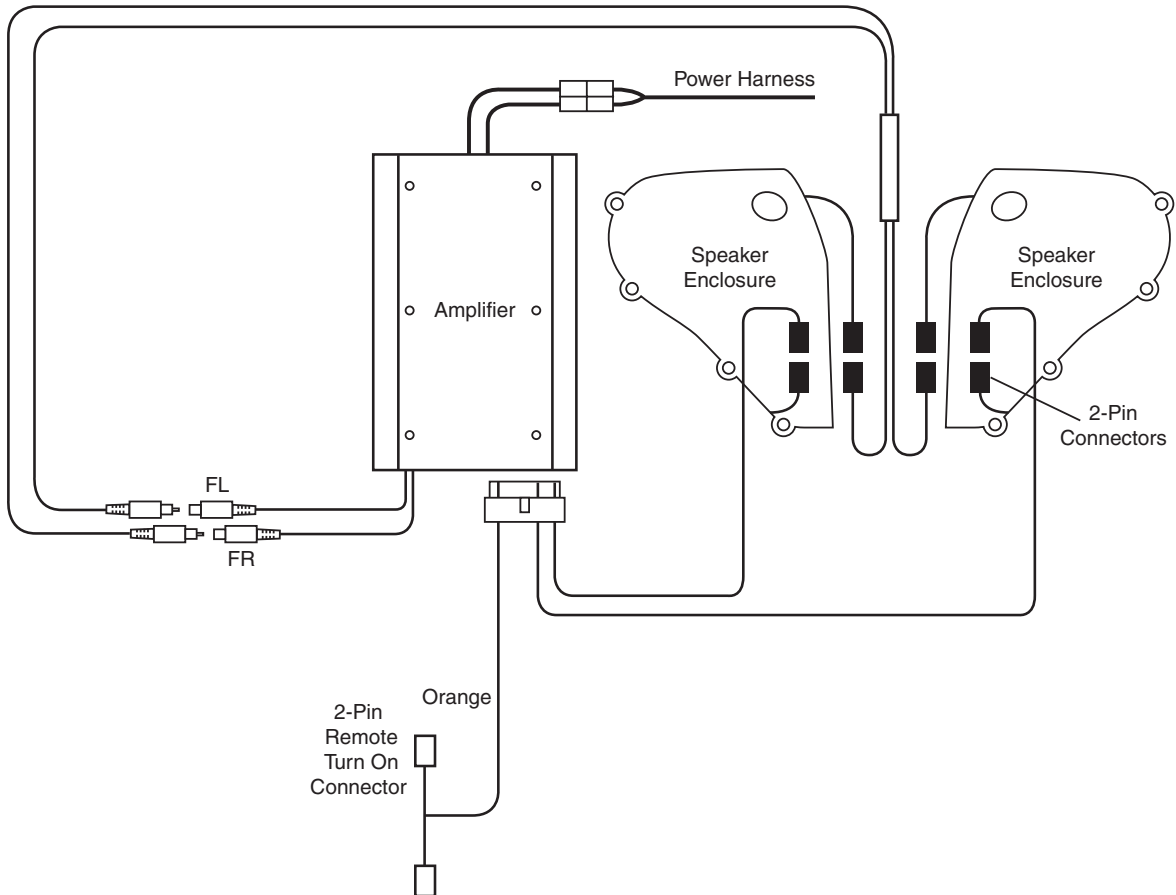
Fig. A

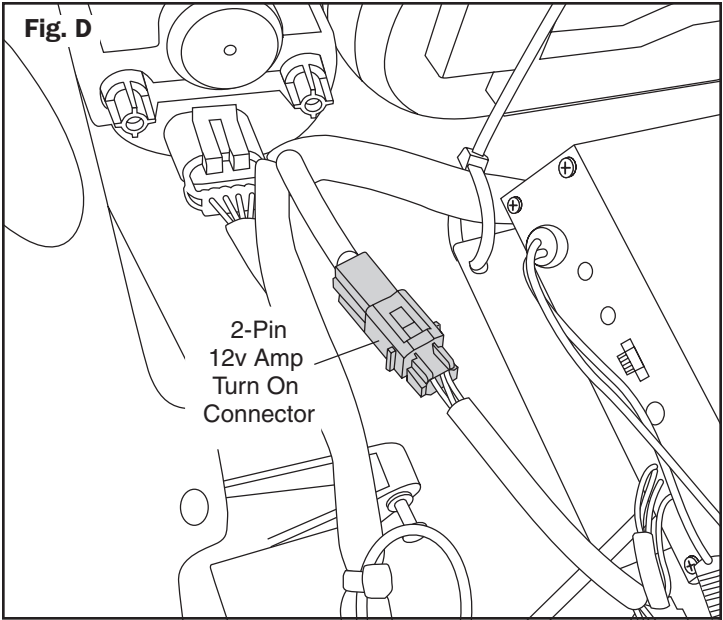


**Fig. B**



**Fig. C**





**Specifications**

<b>J&amp;M Performance Series 200w RMS</b>			
<b>Full Range Class D Amplifier</b>			
Output Power (RMS) @ 1% THD 1000Hz 14.4V		S/N Ratio	>88dB
Stereo @ 2ohms	2 x 100 watts RMS Continuous	Separation	
Frequency Response -3dB	20Hz - 20kHz Capable	Input Sensitivity	.35V - 3.9V
		Input Impedance	20K

Thank you for the confidence you have shown in J&M Corporation by purchasing one of our innovative products.

