



**ROKKER® XXRP 700w Amplifier
Kit For 2014-2019 Harley®
Ultra/Ultra Ltd. Fairing**

#JAMP-700HC14-ULP

**Installation
and Operation
Instructions**

Product Description

This new J&M ROKKER® XXRP DSP controlled 4-channel 700 watt RMS fairing/rear speaker amplifier kit has been designed specifically for use on the 2014-2019 Harley® Ultra or Ultra Ltd. (NOT for CVO) with the stock Harley infotainment radio (NO radio FLASH required).

The specific green-band plug-n-play RCA input harnesses included with this amplifier kit, take the 4-channels of audio signal available from the Ultra/Ltd. version of the Harley Infotainment radio and provides 4 separate channels of amplification at 175 watts RMS continuous power per-channel into a 2 or 4-ohm speaker load. (Manually selectable on the amplifier itself for a 2-ohm or 4-ohm speaker load)

This is a full range class D digital amplifier properly shielded against RF interference into the AM or FM stereo radio bands.

The ROKKER XXRP amplifier uses advanced digital switching power supply technology to dramatically reduce the 12v current demands on the motorcycle electrical system, compared to other brand amplifiers in this power range.

Amplifier mounts to the custom made stainless steel 2-piece bracket system, to provide solid and secure mounting inside the Ultra fairing, in addition to blocking amplifier heat from being transferred to the radio.

These new ROKKER XXRP series amplifiers are fully programmable thru the internal digital signal processor (DSP) and come out of the box already dialed in for this specific Ultra/Ltd. speaker configuration, to provide maximum highway performance from your Harley Davidson audio system.

Should you wish to alter these DSP settings using the internal programming dongle already built into this new amplifier, (USB computer connection cable also included with this amplifier kit) all of our specific custom amplifier programs are now available as a consumer download from the J&M website.

Also included are our custom made heavy-gauge power and ground wires used for the fused battery & frame connections, along with all necessary mounting hardware & complete installation/operation instructions.

Installation Instructions

1. Remove the windshield, outer fairing shell, vent below windshield, fuel tank and seat.
2. Remove and replace the stock metal tray above the radio with the J&M Amplifier mounting tray by removing the 4 screws holding the tray to the radio, 4 screws holding the tray to the speaker enclosures, and 2 screws holding the tray to the gauge assembly. Place the J&M Amplifier mounting tray in place of the stock tray and secure with the screws removed from the stock tray. **(Figure B)**
3. Mount Amplifier to the J&M Amplifier mounting plate with the 4 screws provided. The 2 shorter screws go toward the gauges.
4. By following the factory wiring harness, route the amplifier power harness from the fairing, under the fuel tank, and on to the battery. (removal of the fuel tank is required)
5. After first disconnecting the negative battery cable from the battery, connect the positive (red) lead from the amplifier power harness directly to the positive post of the battery. Then connect the negative (black) lead from the power harness to the same bolt/stud on the frame that the negative battery cable is connected to. Then reconnect the negative battery cable to the battery. **(Figure A)** Do not connect the negative (black) lead from the amplifier to the negative post of the battery.
6. By following the factory wiring harness, route the rear speaker harness from the fairing, under the fuel tank, past the battery along the frame and then follow the speaker wires going to the 16 pin connector in front of the Tour-Pak. **(Figure A and D)**
7. Make speaker and Amplifier connections per diagram. **(Figure B, C, D, and E)**

Fig. A

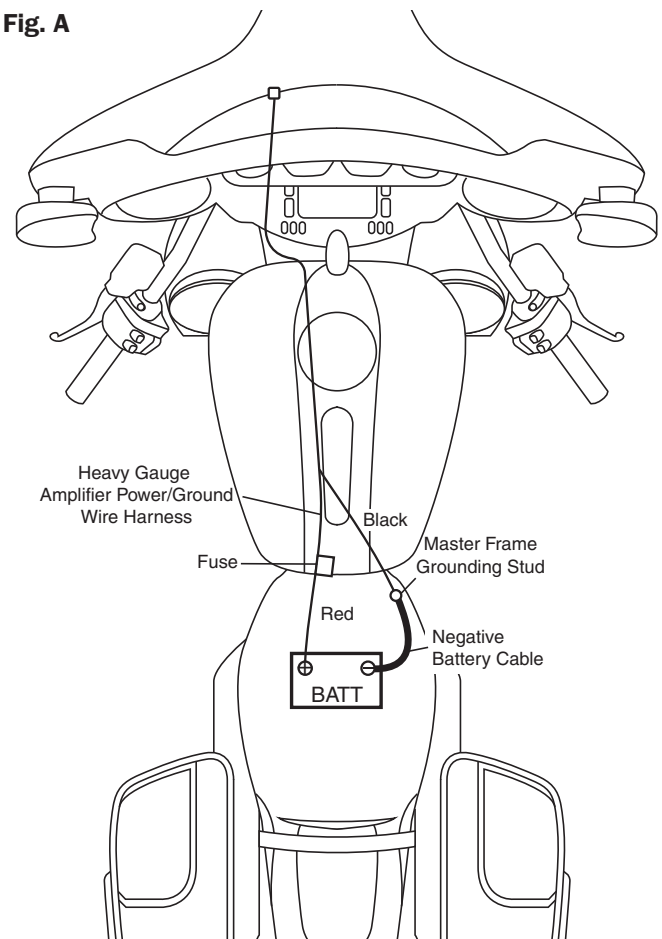

Important Programing Note: The amplifier gain & frequency response adjustments have been pre-programed at our factory for this specific Harley Davidson audio system application, using speakers with an impedance of 2-ohms, to provide maximum performance at highway speeds. Should speaker impedance change, an alternate software programing package will need to be downloaded & flashed to the digital signal processor inside the amplifier. This programming service is available direct from J&M Corporation in Tucson AZ USA.

Fig. B

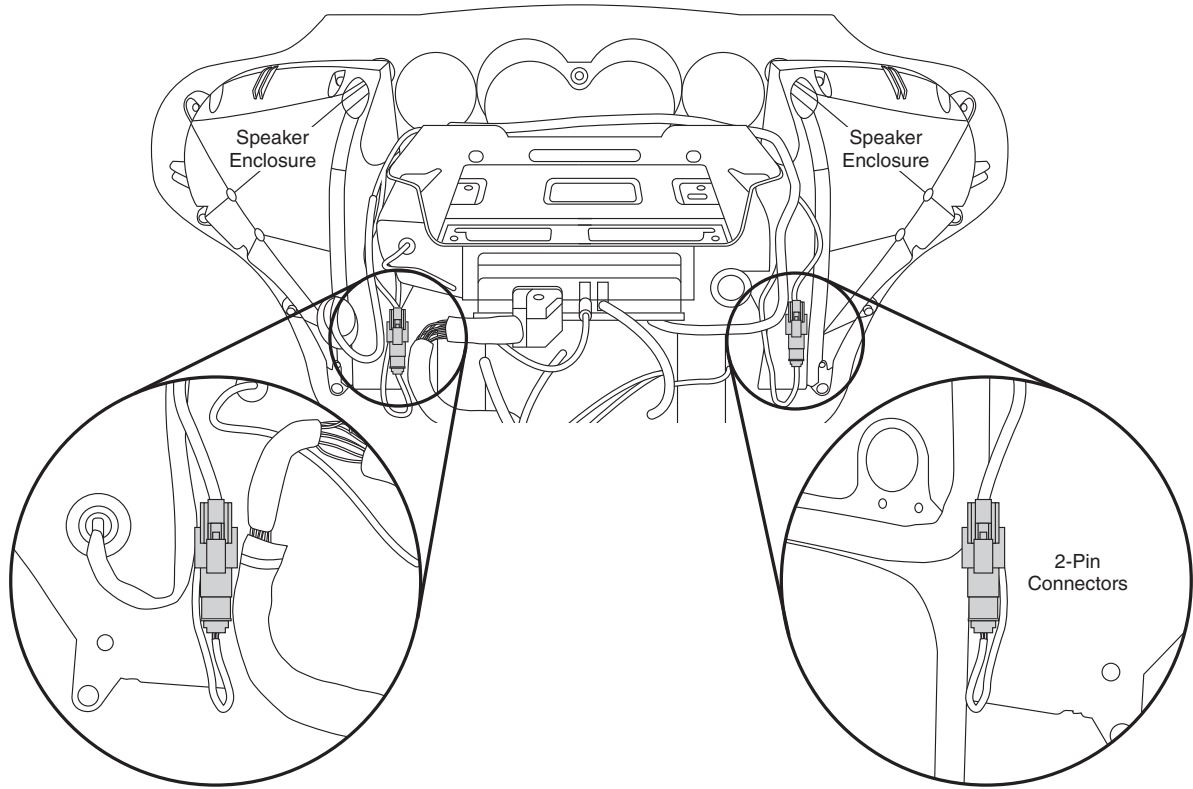
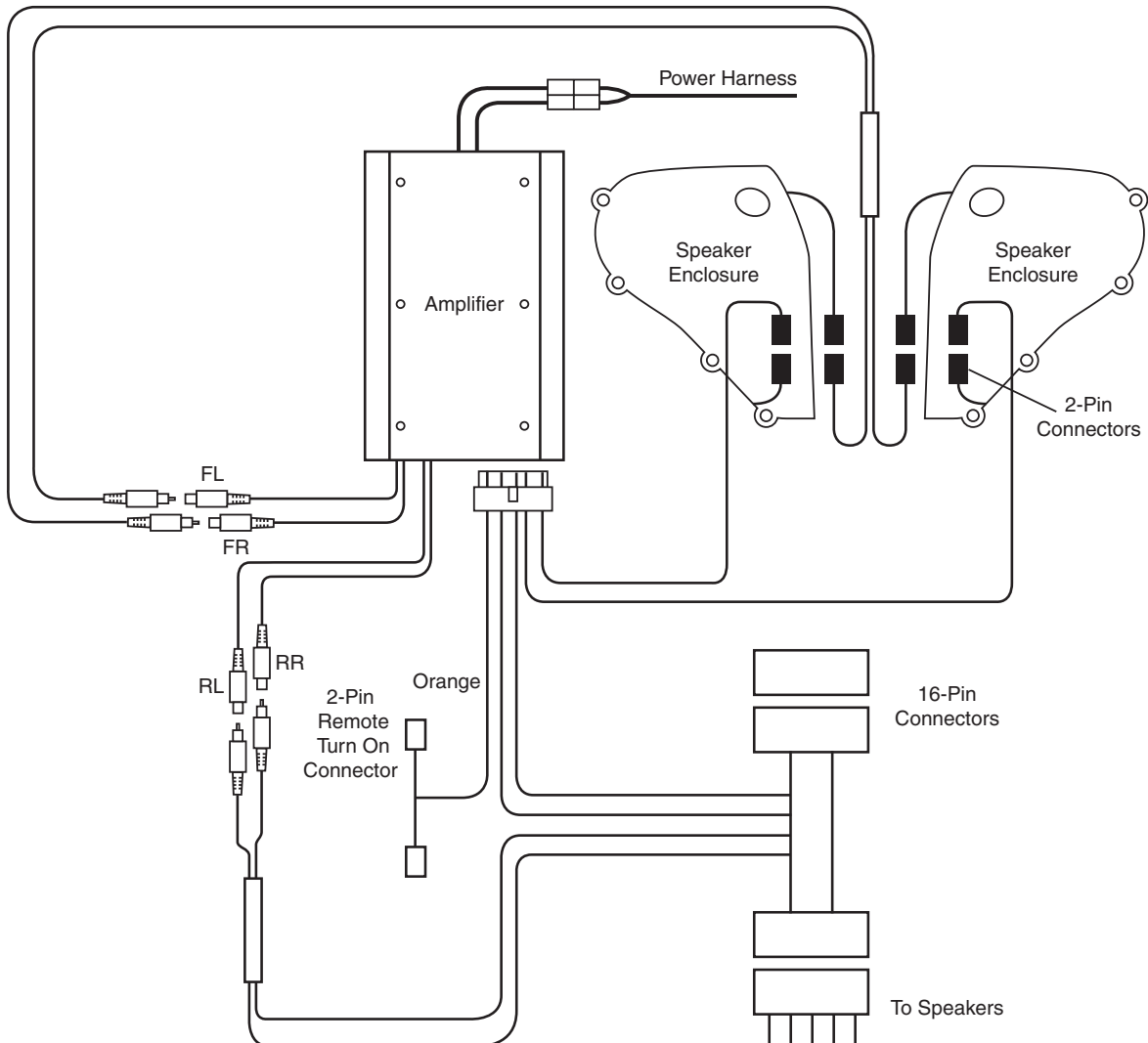
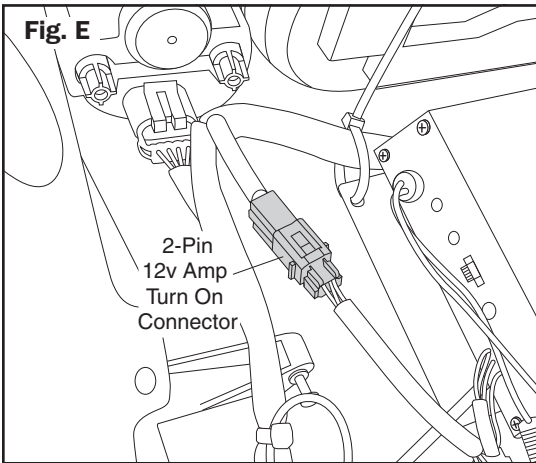
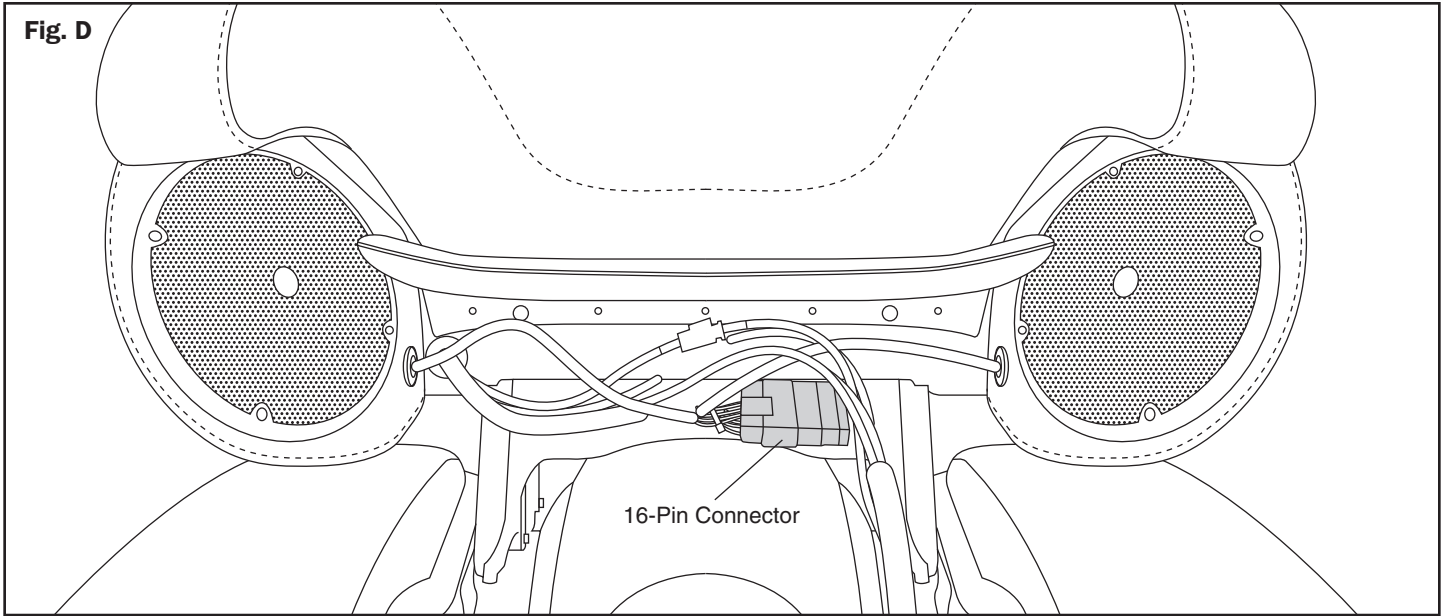

Fig. C





Specifications

ROKKER® XXRP 700			
Full Range Class D Amplifier			
Output Power (RMS) @ 1% THD 1000Hz 14.4V CEA 2006		S/NRatio	>90dB
Stereo @ 4ohms	4 x 175 Watts – 700w RMS Total	Separation	>74dB
Stereo @ 2ohms	4 x 175 Watts – 700w RMS Total	Input Sensitivity	.35V - 3.9V
Frequency Response -3dB	1Hz - 69kHz Capable	Input Impedance	47.5K

Thank you for the confidence you have shown in J&M Corporation by purchasing one of our innovative products.

