

**350W ROKKER® XXR Amplifier  
Kit For 2014-19 Harley® Street  
Glide/Ultra/Ultra LTD. Fairing**

**#JAMP-350HC14**

**Installation  
and Operation  
Instructions**

## Product Description

2-ch 350w fairing speaker amplifier kit for 2014-2019 Harley® StreetGlide or Ultra with stock Harley 4.3 Std, 6.5GT or new GTS touch-screen radio, NO SPECIAL FLASH needed.

Full range class D audio amplifier, spec'd at 175watts RMS per channel X2, (350w total) into 2-ohm load @ 14.4vdc.

Amplifier mounts to custom made stainless steel 2-piece bracket system, to provide solid and secure mounting inside the StreetGlide or Ultra fairing.

ROKKER XXR amplifiers are dialed in for this specific StreetGlide/Ultra speaker configuration, to provide maximum

highway performance. (Updated amplifier gain/frequency settings as of 09-15/2018)

Custom made plug-n-play wiring harnesses are included, along with heavy gauge power/ground wires for the fused battery connection, all necessary mounting hardware & complete installation/operation instructions.

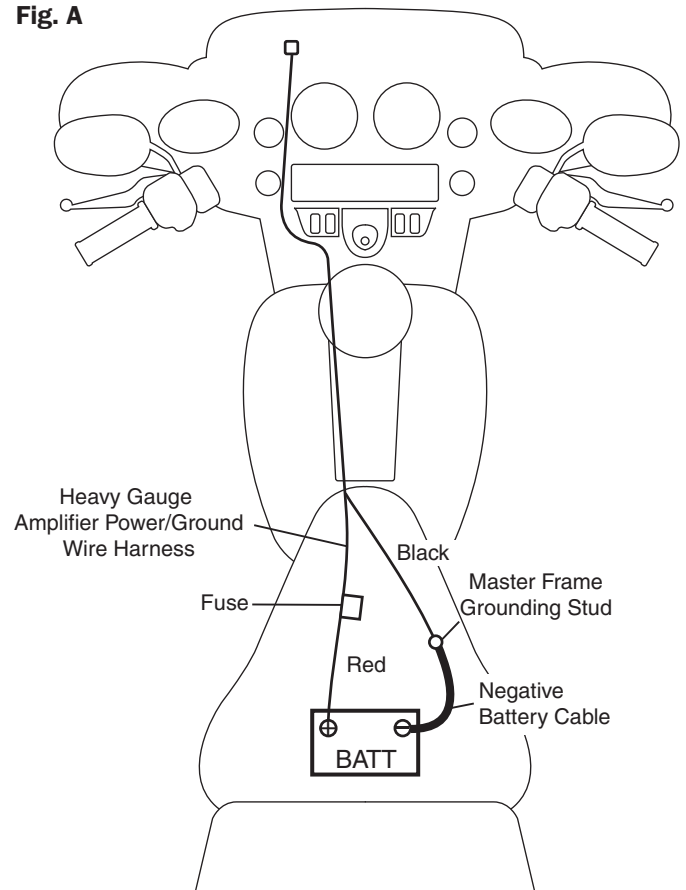
Amplifier itself measures 7 ¼" X 4 ¾" X 1 ¾".

## Installation Instructions

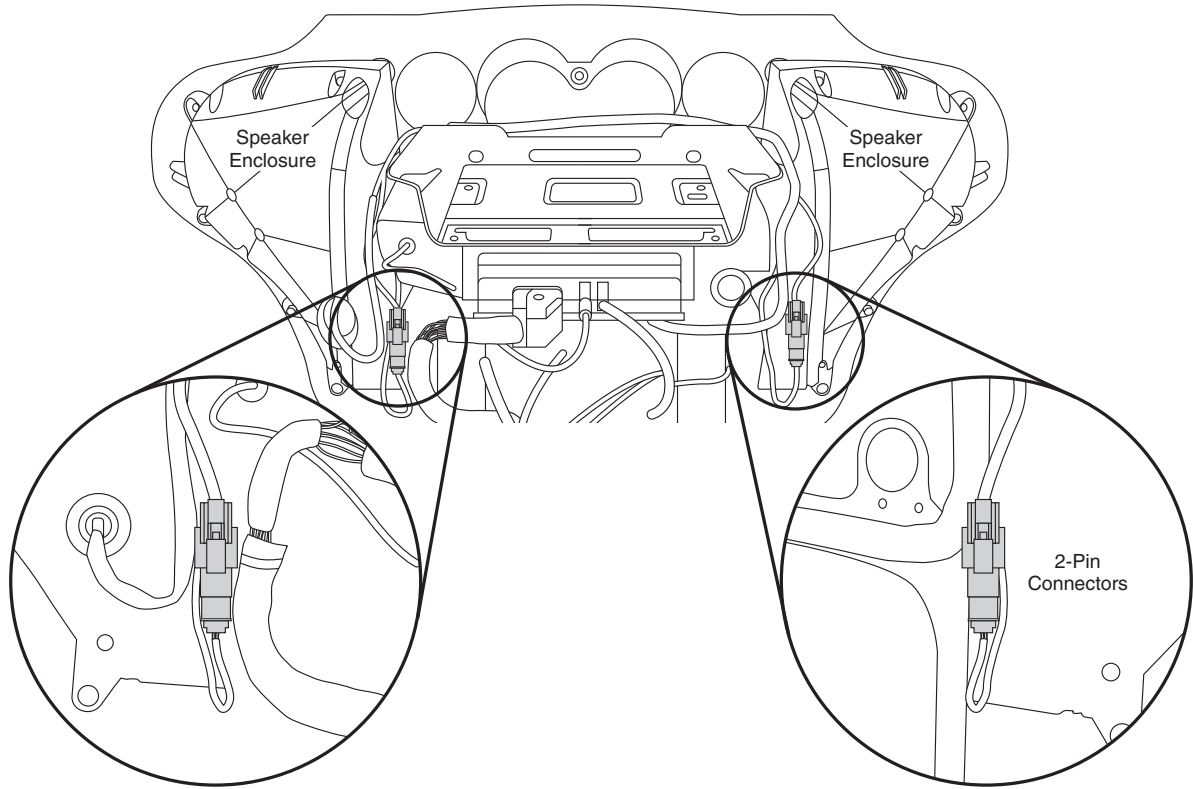
1. Remove the windshield, outer fairing shell, vent below windshield, fuel tank and seat.
2. Remove and replace the stock metal tray above the radio with the J&M Amplifier mounting tray by removing the 4 screws holding the tray to the radio, the 4 screws holding the tray to the speaker enclosures, and 2 screws holding the tray to the gauge assembly. Place the J&M Amplifier mounting tray in place of the stock tray and secure with the screws removed from the stock tray. **(Figure B)**
3. Mount Amplifier to the J&M Amplifier mounting plate with the 4 screws provided. The 2 shorter screws go toward the gauges.
4. By following the factory wiring harness, route the amplifier power harness from the fairing, under the fuel tank, and on to the battery. (removal of the fuel tank is required )
5. After first disconnecting the negative battery cable from the battery, connect the positive (red) lead from the amplifier power harness directly to the positive post of the battery. Then connect the negative (black) lead from the power harness to the same bolt/stud on the frame that the negative battery cable is connected to. Then reconnect the negative battery cable to the battery. **(Figure A)** Do not connect the negative (black) lead from the amplifier to the negative post of the battery.
6. Make speaker and Amplifier connections per diagram. **(Figure B, C and D)**

**Important Programing Note:** The amplifier gain & frequency response adjustments have been pre-set at our factory for this specific Harley Davidson audio system application, using speakers with an impedance of 2-ohms, to provide maximum performance at highway speeds. Should speaker impedance load change, alternate adjustments can be made by removing the small sticker that is placed over the amplifier's input gain control screw.

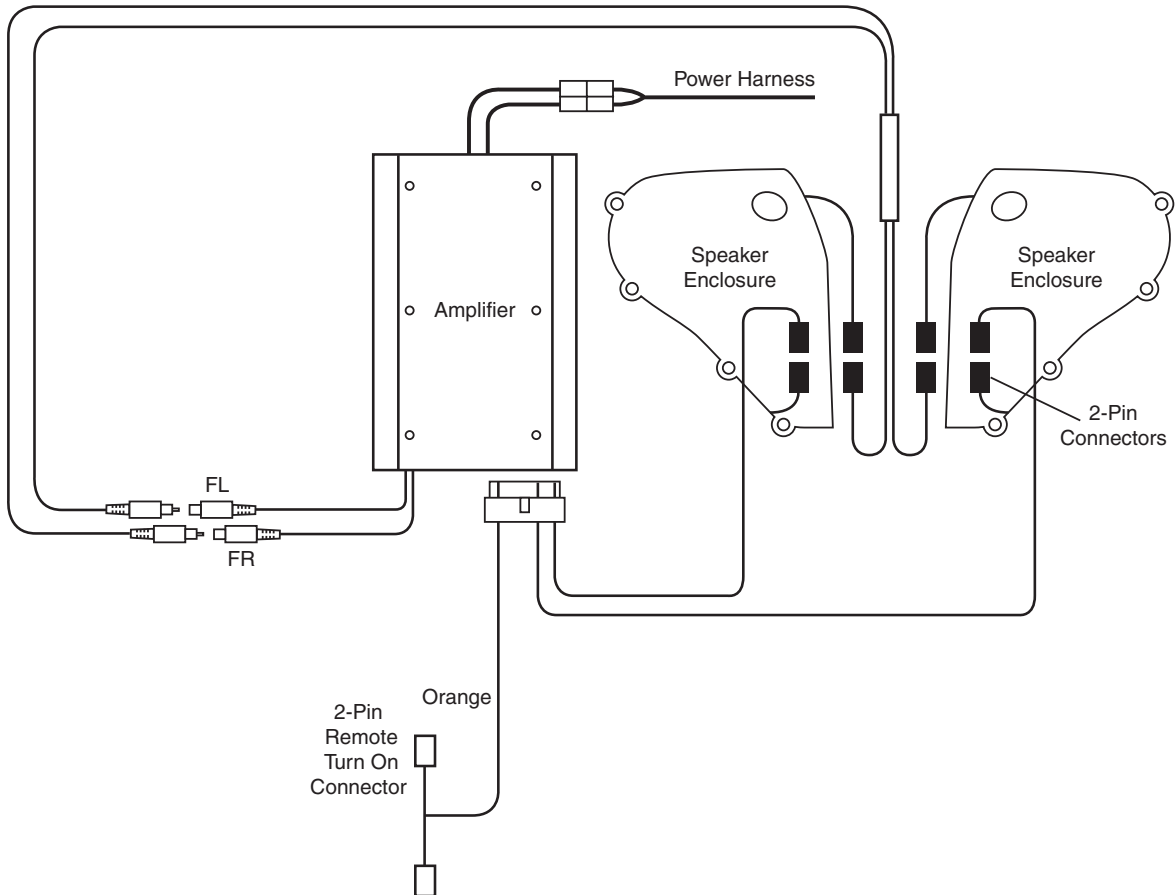
Fig. A

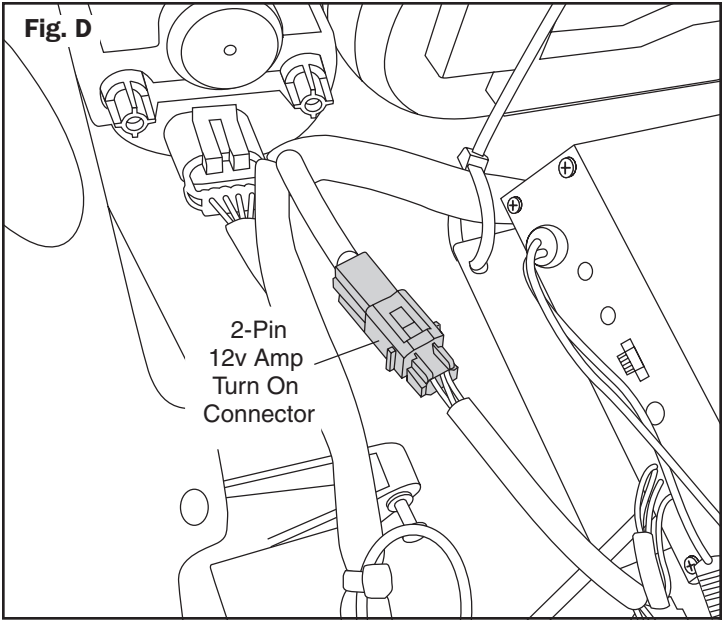


**Fig. B**



**Fig. C**





**Specifications**

<b>ROKKER® XXR 350w RMS</b>			
<b>Full Range Class D Amplifier</b>			
Output Power (RMS) @ 1% THD 1000Hz 14.4V		S/N Ratio	>88dB
Stereo @ 2ohms	2 x 175 watts RMS Continuous	Separation	
Frequency Response -3dB	20Hz - 31kHz Capable	Input Sensitivity	.35V - 3.9V
		Input Impedance	20K

Thank you for the confidence you have shown in J&M Corporation by purchasing one of our innovative products.

