



FEY-15R3-K

Parts List:

- Fender Eliminator Bracket 1
- 6 x 20 mm Allen Bolts 4

Fender Eliminator 2015 Yamaha YZF-R3

<<<<<< IT IS RECOMMENDED THAT THIS PRODUCT BE INSTALLED BY A QUALIFIED TECHNICIAN >>>>>>

- 1) Remove the passenger seat.
- 2) Remove the two 5mm allen head bolts holding down the center plastic cover between the two seats. Then you will be able to remove the cover. **Photo 1.**



Photo 1

- 3) Remove the two 8mm head bolts holding down the front seat, then remove the seat.
- 4) Remove the storage tray by releasing the two Phillips head rivets located on the sides of the storage tray.
- 5) Locate and unplug the three plugs coming out of the stock fender.
- 6) Remove the air deflector wing by removing the 4 phillips head rivets under the rear fender.
- 7) To remove the lower fender support and wire cover, you will need to remove the four phillips head screws and six 4mm allen head bolts. **Photo 2.**

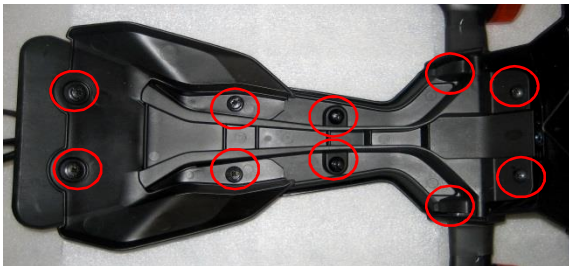

Photo 2

- 8) Remove the four 10mm head lock nuts from the rear fender assembly. Be sure to hold the fender to prevent it from falling once the nuts are removed. **Photo 3**

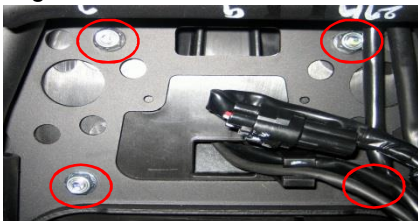

Photo 3

- 9) The Graves fender eliminator is set up with turn signal mounts attached which will accommodate the stock turn signals.

* Moving the turn signal mounts to the outermost hole position will allow the use of the Graves flush mount marker lights. (Graves Part Number TS401C1)

** If you are using a taillight integrated kit you can remove the turn signal brackets.

- 10) If using the stock turn signals, remove them from the rear fender by removing the 2 plastic signal retainers at the mounting point of the signals. Carefully remove the signals from their mounting holes.
- 11) Re-install the stock signals in the reverse sequence.
- 12) After the turn signals have been installed, feed the turn signal wires through the center hole of the Graves fender eliminator bracket.
- 13) Using the supplied button head allen bolts, install the fender eliminator bracket to the motorcycle. Secure with the stock 10mm head lock nuts.
- 14) In the reverse sequence, plug in the turn signals, re-install the center plastic cover and the seats.



The purchaser releases Graves Motorsports, Inc. from all liabilities pertaining to the installation and use of purchased parts. Purchaser recognizes that any alteration and/or modifications to the vehicle may increase the risk of injury or accident. **This product is intended for Closed Course Competition Use Only** and may render the vehicle illegal for use on public roads.

When it comes to quality motorcycle frames & body, Graves Motorsports is the brand you can depend on.