



Q705.001
2002-2005 Bombardier
650 Quest
Stage 1

For mildly tuned machines using the stock airbox with stock or aftermarket filter. May also be used with a good aftermarket exhaust system.

<i>Parts List</i>		
1	Main Jet	DJ140
1	Main Jet	DJ142
1	Main Jet	DJ144
1	Main Jet	DJ146
1	Main Jet	DJ148
1	Main Jet	DJ150
1	Main Jet	DJ155
1	Fuel Needle	DNO709
1	Slide Spring	DSP027
1	Needle Spring	DSP77
1	Adjusting Washer	DW0001
1	E-Clip	DE0001

STAGE ONE INSTRUCTIONS

1. Remove vacuum slide from carb. Remove stock needle & spacers, noting order of assembly (Fig.A).
2. Install Dynojet needle on groove #4 for applications below 5000 feet, groove #3 for above 5000 feet, using all stock spacers (Fig.A). Install the Dynojet slide spring (DSP027) in place of the stock slide spring. **NOTE:** The DSP77 spring does not have to be used, it is supplied in case the stock spring is misplaced. The Dynojet washer (DW0001) does not need to be installed at this time, it is for half step adjustments. After installing the slides in the carbs be sure to check slide movement manually before air box installation.
3. Remove stock main jet and replace with Dynojet main jet provided. Use the DJ146 below 3000 feet, DJ144 from 3000 to 6000 feet and DJ142 above 6000 feet. When using an aftermarket exhaust with a high flow baffle, Use the DJ150 below 3000 feet, DJ148 from 3000 to 6000 feet and the DJ146 above 6000 feet.
4. Locate the Fuel Mixture Screw (Fig.B). Using a flat blade screwdriver, turn the mixture screw clockwise until it seats, then turn out 1.5 turns, 1 turn above 5000 feet.

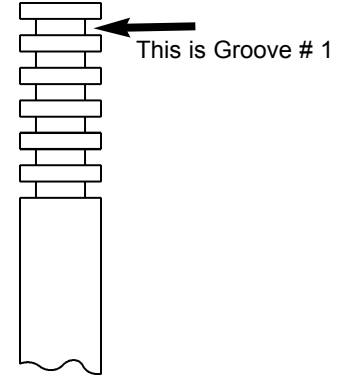

Fig.A

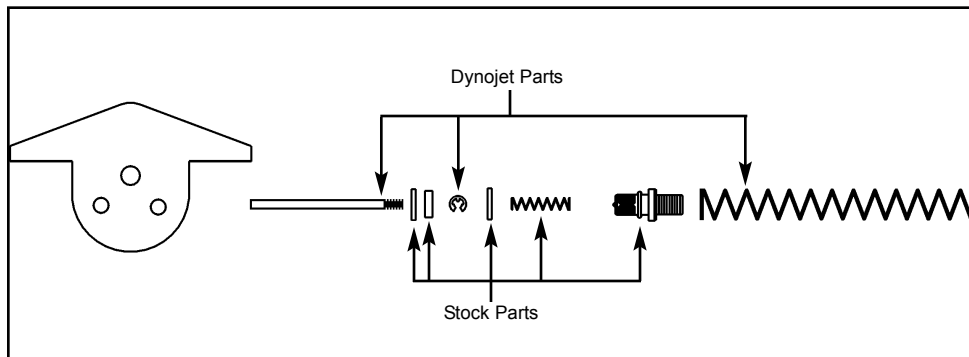

Fig.B

