



**Q316.001**  
**2005~2008 Suzuki**  
**LT-Z400**

**Stage 1&2**

**Stage 1**

For mildly tuned machines using the stock airbox with stock or aftermarket filter.  
May also be used with a good aftermarket exhaust system.

**Stage 2**

For mildly tuned machines using the stock airbox with the lid removed and stock  
or aftermarket filter. Should also be used with a good aftermarket exhaust system.

<b>Parts List</b>		
1	Main Jet	DJ118
1	Main Jet	DJ122
1	Main Jet	DJ126
1	Main Jet	DJ130
1	Main Jet	DJ134
1	Main Jet	DJ146
1	Main Jet	DJ150
1	Main Jet	DJ155
1	Main Jet	DJ160
1	Main Jet	DJ165
1	Main Jet	DJ170
1	Fuel Needle	DNO712
1	Adjusting Washer	DW0001
1	E-Clip	DE0001
1	Needle Spring	DSP77
1	Plug Drill	DD 5/32
1	Screw	DS0001

## STAGE ONE INSTRUCTIONS

1. Remove vacuum slide from carb. Remove stock needle & spacers, noting order of assembly (Fig.A).
2. Install Dynojet needle on groove #3 for applications below 5000 feet, groove #2 for above 5000 feet, using all stock spacers (Fig.A). **NOTE: The DSP77 spring does not have to be used, it is supplied in case the stock spring is misplaced.** The Dynojet washer (DW0001) does not need to be installed at this time, it is for half step adjustments. After installing the slide in the carb be sure to check slide movement manually before airbox installation.
3. Remove stock main jet and replace with Dynojet main jet provided. Use the DJ126 below 3000 feet, DJ122 from 3000 to 6000 feet and DJ118 above 6000 feet. When using an aftermarket exhaust with a high flow baffle, use the DJ130 below 3000 feet, DJ126 from 3000 to 6000 feet and the DJ122 above 6000 feet.
4. Locate the Fuel Mixture Screw (Fig.B). If you see a screw head at Fig.B then proceed to the adjusting procedure. With the 5/32 drill bit provided carefully drill through the plug. **NOTE: The mixture screw is directly underneath this plug, be ready to pull back on the drill the instant you break through.** Use the screw provided to secure and remove this plug. Carefully turn the mixture screw clockwise until lightly seated, then turn out 3.5 turns, 3 turns above 5000 feet.

## STAGE TWO INSTRUCTIONS

1. Remove the airbox lid.
2. Remove vacuum slide from carb. Remove stock needle & spacers, noting order of assembly (Fig.A).
3. Install Dynojet needle on groove #3 for applications below 5000 feet, groove #2 for above 5000 feet, using all stock spacers (Fig.A). **NOTE: The DSP77 spring does not have to be used, it is supplied in case the stock spring is misplaced.** The Dynojet washer (DW0001) does not need to be installed at this time, it is for half step adjustments. After installing the slide in the carb be sure to check slide movement manually before airbox installation.
4. Remove stock main jet and replace with Dynojet main jet provided. Use the DJ155 below 3000 feet, DJ150 from 3000 to 6000 feet and DJ146 above 6000 feet. When using an aftermarket exhaust with a high flow baffle, use the DJ160 below 3000 feet, DJ155 from 3000 to 6000 feet and the DJ150 above 6000 feet.
5. Locate the Fuel Mixture Screw (Fig.B). If you see a screw head at Fig.B then proceed to the adjusting procedure. With the 5/32 drill bit provided carefully drill through the plug. **NOTE: The mixture screw is directly underneath this plug, be ready to pull back on the drill the instant you break through.** Use the screw provided to secure and remove this plug. Carefully turn the mixture screw clockwise until lightly seated, then turn out 3.5 turns, 3 turns above 5000 feet.

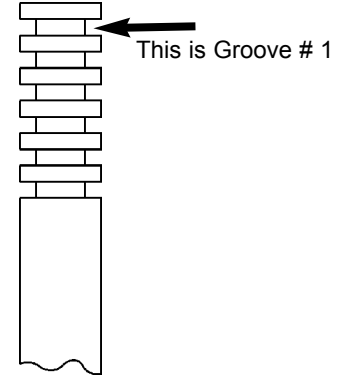

Fig.A

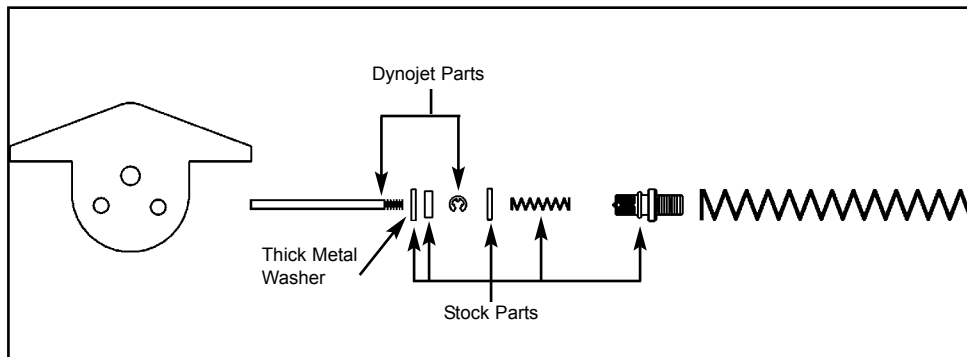

Fig.B

