



Fender Eliminator Kit
P/N: 670-5620
675-5620

Kit Contents

Part Number	Description	Quantity	Part Number	Description	Quantity
99-FE-670-5620	Fender Brackets	2	Locknuts	6mm Locknut	2
99-HB-6x16	BH 6x16 Bolt	2	99-Wash6x15	6x15mm Washer	2
99-HB-6x12	BH 6x12 Bolt	4	99-Wash6x12	6x12mm Washer	6

1. Remove the passenger seat.



2. Remove the driver's seat.



In order to remove the stock fender, the turn signal and plate light connectors will need to be unplugged. The connectors are located in the right side tail section. In order to unplug the connectors, the right side tail section body work will need to be removed.

3. Remove the plastic tank cover on the right side. The tank cover is locked on by two body clips (Step 1 and Step 2), Velcro (Step 3) and then slid into place (Step 4). Start with where the plastic tank cover meets the tail section cowling. Unplug the body clip (Step 1). Unplug the next body clip located in the lower center part of the plastic cover (Step 2). Undo the Velcro (Step 3). Once both clips have been removed and the Velcro has been undone, slide the plastic cover to the left and off the bike (Step 4).



4. Remove the top screws tail section body work screws on the left side.

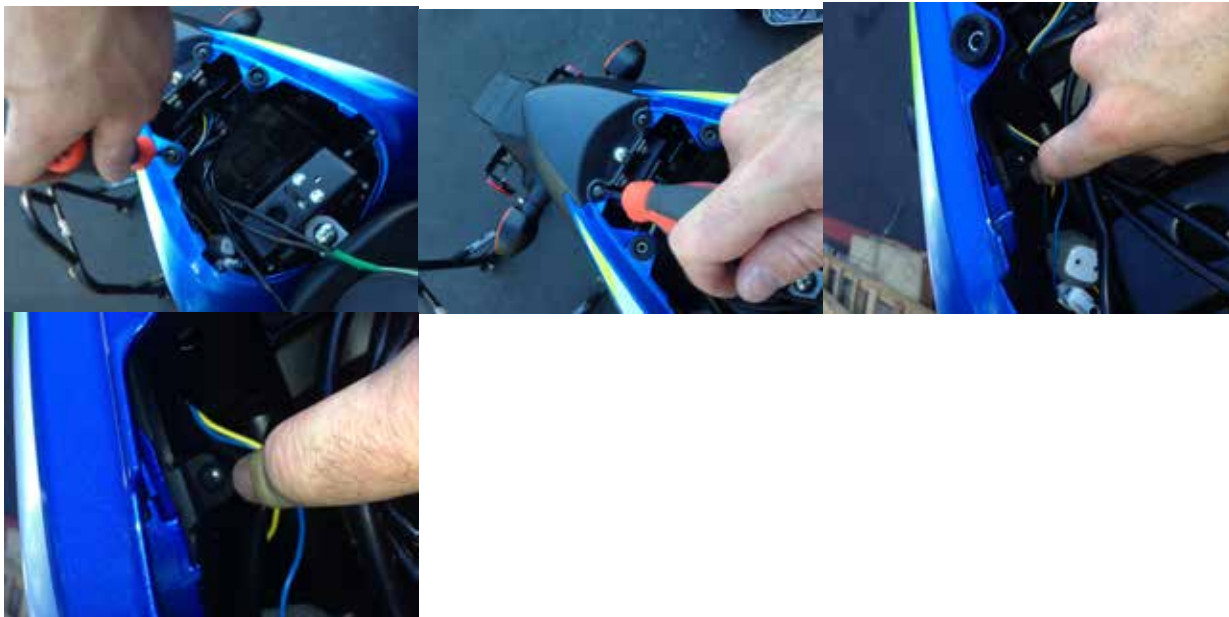

5. Remove the right side tail section by un snapping and sliding the tail section bodywork toward the front of the bike.



6. Undo the plastic tie holding the turn signal wires to the frame of the bike.



7. Follow the turn signal and plate wires to the harness and unplug them. Black is the right signal and Grey is left.

8. Remove the stock fender by removing the 4 bolts holding it in place from underneath the tail section.



9. Mount the DMP base plate using the two supplied 6x1.0x12 button head bolts and two 6x12 (smaller) washers. Use medium thread locker on these bolts.



10. Mount the DMP license plate bracket using the two 6x1.0x16 button head bolts and two 6x12 (smaller) washers.



11. Install the desired turn signals and plate lights. We recommend using DMP turn signals to complete the install.

THE STEPS 12-14 ARE FOR 675-5620.

12. Mount the DMP turn signals (900-0070) to the plate. Feed the turn signal wires through the center hole of the DMP fender eliminator. Plug the turn signal wires into the DMP wire extenders (900-0124). Properly route the wiring. Plug the DMP OEM connectors (900-0122) into the stock turn signal connectors (Black is for the Right signal and Grey is for the Left signal).



13. Mount your license plate using the two DMP plate lights (900-2042) and hardware. Feed the wires through the center hole of the DMP fender eliminator. We prefer to use the stock plate light connector and wires. Cut the stock plate wires on the fender as close as you can (for the most slack) to the plate light. Splice together the stock turn signal wires and plate wires using the butt connectors supplied in the kit (white is the positive lead and black is the negative). Plug in the OEM plate light connector to the harness.
14. Double check all your connections. Turn the bike on and double check your signals and plate lights.
15. Repeat steps 1-6 in reverse to complete install.

670-5620



675-5620



Feel the difference with DMP.

Shop for other license plates & frames on our website.