



PRODUCT FEATURES:

- Retains handle bar mounted radio controls (if equipped).
- Plug and Play. No wire cutting to the OEM harness required.
- Siri Control and Android Control Voice Control function (if aftermarket radio supports these features).

NOTE:

For 2 speaker systems only.

PARTS INCLUDED:



HBRHD-61A MODULE



HBRHD-61A Harness



SWC Cable

INSTALLATION DIAGRAM:

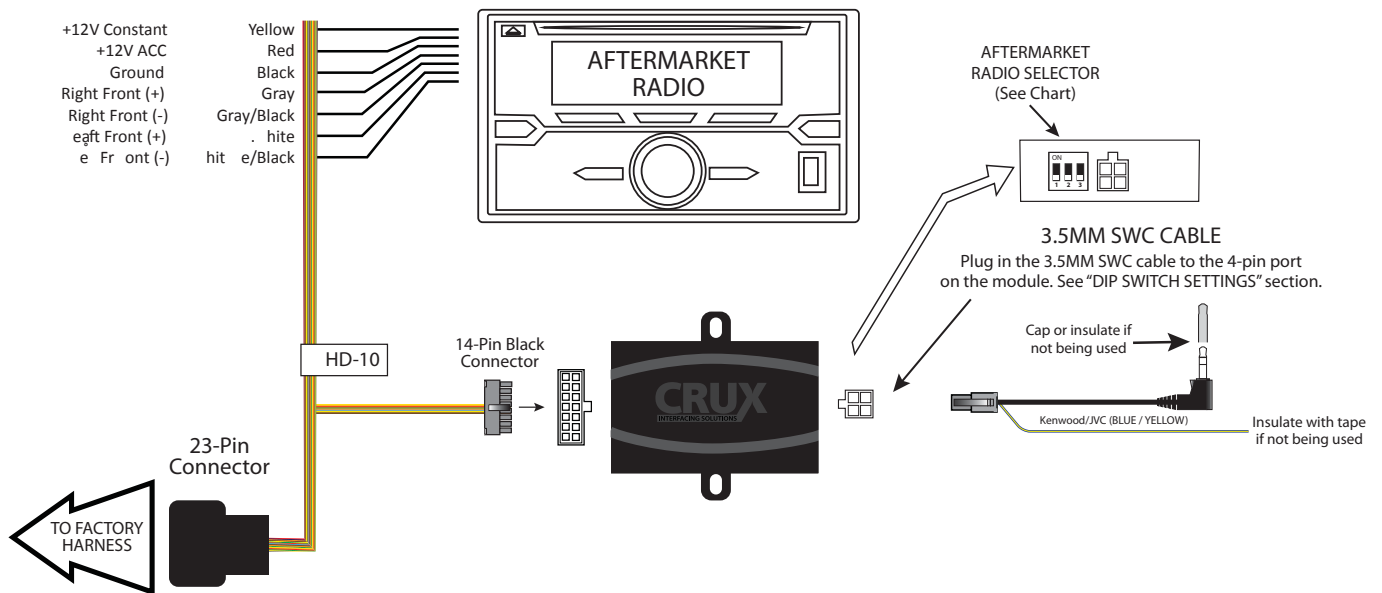



DIP SWITCH SETTINGS:

AFTERMARKET RADIO DIP SWITCH SETTINGS:

RADIO BRAND:	DIP#:	1	2	3
Atoto, Dual, Fahrenheit, Jensen		OFF	ON	ON
Pioneer, Power Acoustik, Soundstream		OFF	ON	ON
Blaupunkt, Most off-brand Radio		OFF	ON	ON
Alpine		OFF	OFF	OFF
Clarion		ON	ON	OFF
Kenwood		ON	ON	ON
JVC		ON	OFF	ON
Boss, Old Sony		ON	OFF	OFF
New Sony		OFF	ON	OFF

SWC MODULE
DIP SWITCH



NOTE: For Atoto, Blaupunkt, Dual, Fahrenheit, Power Acoustik, Soundstream, and most off-brand radios, check the aftermarket radio's manual to see if the SWC buttons need to be programmed.

3.5MM SWC CABLE

Plug in the 3.5MM to 4-Pin SWC cable to the SWC module.

NOTE: Insulate the Blue/Yellow wire or 3.5mm plug if not being used.

HANDLE BAR CONTROL FUNCTIONS:

Left Handle Bar Controls



Right Handle Bar Controls



VEHICLE APPLICATIONS:

HARLEY DAVIDSON	
1998 - 2013	Road Glide / FLTR
1998 - 2013	Street Glide / FLHX / FHLT