

Items Supplied >

- 1 - Sissy Bar w/ Pad & Interchangeable Chrome Insert
- 2 - Mount Brackets (Left/Right)
- 4 - 3/8-16 x 1¼ Buttonhead Bolts
- 4 - Spacers
- 4 - M8 x 20mm Buttonhead Bolts

Application(s) >

HARLEY	
FLSTF	2007-2013
FXST/S/B	2006-2013

Instruction Manual >

602-1251 / 602-1301

Page 1 of 1

Read all instructions carefully before installing your new Cobra® product!

1. Remove and discard the (2) 3/8 bolts/washers from the right side fender rail. Do NOT remove the chrome fender rail.
2. Install right sissybar mounting bracket (part # facing inward) by inserting (2) supplied 3/8-16 x 1¼ buttonhead bolts through the sissy bar mount bracket, supplied spacers, chrome fender rail and into the fender nut plates. **DO NOT TIGHTEN AT THIS TIME.**
3. Repeat Steps 1 & 2 on left side.
4. Install the sissy bar between the brackets using the four (4) supplied M8 x 20mm button head bolts.
5. Align sissy bar and torque all bolts to their appropriate values.

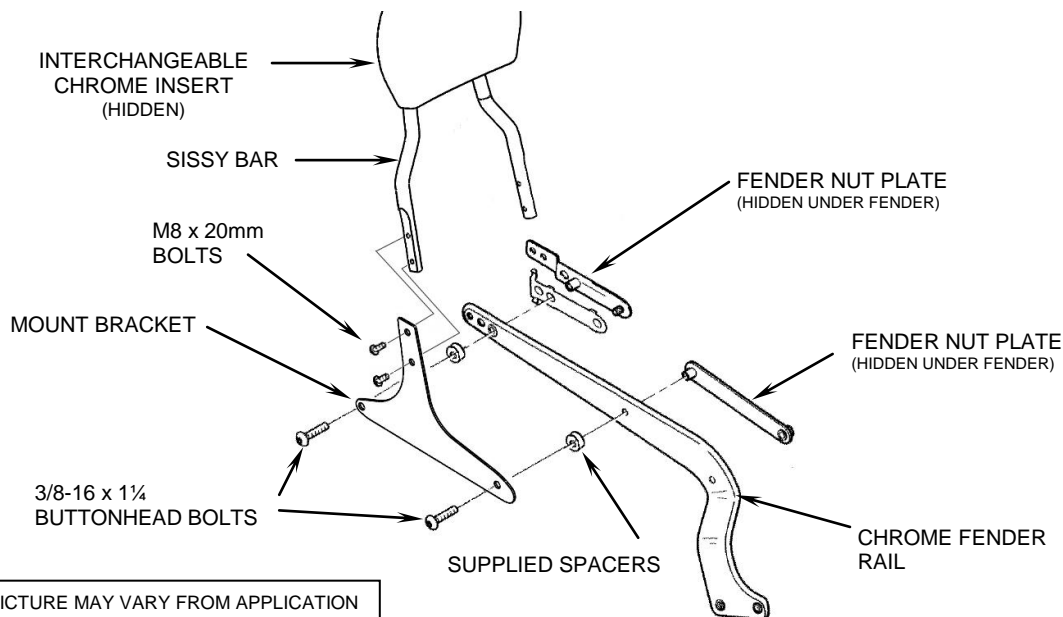

FIGURE 1
(RIGHT SIDE SHOWN)

* Cobra® recommends you always wear a helmet while riding. Please never operate your motorcycle while under the influence of alcohol and/or drugs. Enjoy the new look of your motorcycle and please ride safely.

DOCUMENT NO. 0017 REV. B

10/10

Anything's Possible®