

Items Supplied >

- 1 - Front & Rear Exhaust Assembly
- 1 - Front & Rear Heat Shield w/clamps
- 1 - Exhaust Mounting Bracket
- 1 - Regulator Bracket
- 5 - 5/16" x 5/8" Hex Bolt
- 1 - M10 Bolt; 1 - M10 Nyloc Nut
- 2 - Slider Brackets
- 2 - Billet Exhaust Tips; 2 - 1/4" x 3/8" Buttonhead Bolts
- 1 - Black Plastic Plug

Application(s) >

HONDA VTX1300C/R/S 03-09

Instruction Manual >

1630

Page 1 of 2

Read all instructions carefully and completely before installing your new exhaust system

1. Remove your stock exhaust system and stock exhaust mount. Remove regulator from stock exhaust bracket and save the bolts. Make sure to leave the wiring harness connected. Mount the regulator to the supplied regulator bracket as shown in Figure 1.

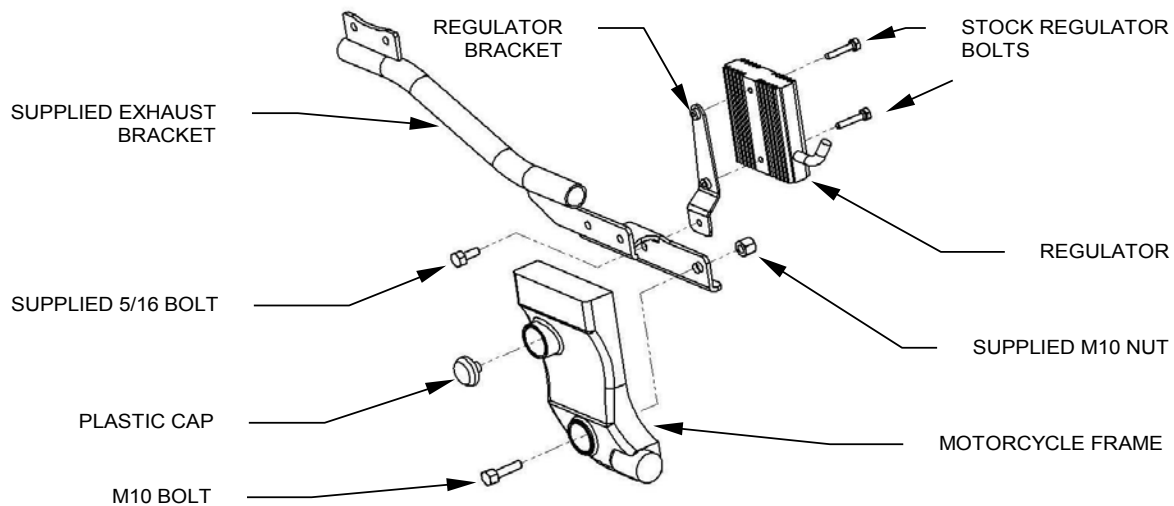

FIGURE 1

2. Loosen the right footpeg/floorboard assembly to help provide installation clearance for the front headpipe.
3. Remove the exhaust mount bracket from the box and mount to the inside of the frame using the 10 mm bolt and nut as shown in (Figure 1), do not tighten completely at this time. Bolt the regulator assembly to the exhaust bar mount bracket using the supplied 5/16" bolt, (see Figure 1.)
4. **PRIOR TO INSTALLATION, MAKE SURE THE STOCK HEADPIPE GASKETS ARE IN GOOD CONDITION. IF THERE IS ANY DOUBT AS TO THEIR CONDITION, REPLACE THEM WITH NEW ONES.** Remove the front pipe assembly from the box and mount to the cylinder head using stock acorn nuts, place the slider bracket on the inside of the pipe bracket, so that the pressed nuts are facing to the outward side of the pipe. Secure the assembly to the mounting bracket, by inserting 2 of the supplied 5/16" bolts through the mounting bracket, pipe bracket and then slider bracket; do not tighten completely at this time.

* **Cobra® recommends you always wear a helmet while riding. Please never operate your motorcycle while under the influence of alcohol and/or drugs. Enjoy the new look of your motorcycle and please ride safely.**

5. Now, mount the rear pipe assembly on the cylinder head using the stock acorn nuts. Place the slider bracket on the inside of the pipe bracket, so that the pressed nuts are facing to the outward side of the pipe. Secure the assembly to the mounting bracket, by inserting 2 of the supplied 5/16" bolts through the mounting bracket, pipe bracket and then slider bracket; do not tighten completely at this time.
6. Adjust both front and rear pipes to be level and parallel. Tighten the acorn nuts on the cylinder heads and then the 5/16" bolts on the bracket. Next, tighten the 10 mm bolt and nyloc nut securing the exhaust bar mount bracket to the frame.
7. Unscrew the hose clamps and feed the tail end of the clamp through the clips on the inside of the heat shields. The screw end of the hose clamp should be accessible for tightening but not visible when the heat shields are mounted to the pipes.
8. To install the front heatshield, first slide the rear portion of the heatshield over the muffler, continue to slowly slide it forward pushing the front of the shield gently into place between the frame and motor (Hint: Spread the hose clamps apart slightly to make it easier to slide them over the muffler assembly and head pipes). Snug the heatshield clamps but **DO NOT TIGHTEN**.
9. Install the rear heatshield the same way as the front heatshield.
10. Install one billet tip on each heatshield. Fasten the tips with the supplied 1/4-20 screws making sure they snug up against the heatshield leaving no gap between the tip and heatshield when tightened. **If it is difficult to slide the tips into the heatshields loosen the clamps on the heatshield, failure to do this may cause damage to the chrome tips.**
11. Tighten the clamps on the heatshields making sure the ends of the shields are even.
12. Reinstall the right front footpeg/floorboard assembly and tighten bolts to factory specifications.
13. Make sure all the hardware (brackets, headpipes, heatshields, mufflers and tips) have been tightened appropriately before starting your motorcycle.

Important:

It is recommended with the installation of the new Cobra exhaust that your motorcycle be re-jetted with a Cobra Jet Kit, available from Cobra: Part Number, 92-1279. Before starting your engine remove all fingerprints from chrome with a quality wax or chrome polish. Failure to do so can cause discoloration. Due to fluctuations in carburetor settings, timing, etc., Cobra Engineering does not warrant against chrome discoloration.

California does not allow the use of aftermarket exhaust systems that remove original equipment catalysts, (except for racing use only) unless the Air Resources Board has issued an Executive Order for that system.